



# Harper

## Assessment Property Record Card for Tax Year 2026

Data provided by SHAYLYN WEDER County Assessor

Date 02/06/2026  
 Time 05:57:06  
 Page 1

Assessment Data					Primary Image																																																											
<b>Account</b> 300000376 <b>Parcel ID</b> 0000-03-25N-23W-1-002-00 <b>Cadastral ID</b> 0000-25N-23W-03-1-002-00 <b>Property Type</b> REAL - Real Property <b>Property Class</b> RR VI Area 4 <b>Tax Area</b> 104 - J-5-FORT SUPPLY <b>Name ID</b> 12508 ALEXANDER, TONY T. & DONNA SUE ALEXANDER  18872 E 23 RD LAVERNE OK 73848-0000  <b>Parcel Location</b> <b>Situs</b> 23 RD E <b>Subdivision</b> <b>Lot/Block</b> / <b>Parcel Size</b> 1.24 - Acres <b>Sec/Twn/Rng</b> 3 / 25 / 23 / 1 <b>Neighborhood</b> 1000 - COUNTY <b>School District</b> J-5-FS - J-5-FORT SUPPLY (Woodward)					<p style="text-align: right; font-size: small;">0000-03-25N-23W-1-002-00 0376 4/9/22</p>																																																											
<b>Legal Description</b> Lat/Long: 36.73875209 -99.81878976 SEC. 3-25-23 TRACT IN NW4NW4 OF LOT 1 BOOK 567 PAGE 846																																																																
<b>Exemptions</b>					<b>Building Permits</b>																																																											
<table border="1"> <thead> <tr> <th>Code</th> <th>Type</th> <th>Active</th> <th>Maximum</th> <th>Exemption</th> </tr> </thead> <tbody> <tr> <td> </td> <td> </td> <td> </td> <td> </td> <td> </td> </tr> </tbody> </table>					Code	Type	Active	Maximum	Exemption						<table border="1"> <thead> <tr> <th>Number</th> <th>Description</th> <th>Opened</th> <th>Closed</th> <th>Amount</th> </tr> </thead> <tbody> <tr> <td> </td> <td> </td> <td> </td> <td> </td> <td> </td> </tr> </tbody> </table>					Number	Description	Opened	Closed	Amount																																								
Code	Type	Active	Maximum	Exemption																																																												
Number	Description	Opened	Closed	Amount																																																												
<b>Parcel Valuation</b>					<b>Sale History</b>																																																											
<table border="1"> <thead> <tr> <th>Source</th> <th>REAL</th> <th>Fair Cash</th> <th>Capped</th> <th>Asmnt Level</th> <th>Assessed</th> <th>Levy Rate</th> <th>66.830</th> <th>Current Tax</th> </tr> </thead> <tbody> <tr> <td>Remove Cap</td> <td> </td> <td>Land Value 5,180</td> <td>3,495</td> <td>12%</td> <td>419</td> <td>Assessed</td> <td>1,919</td> <td>128.25</td> </tr> <tr> <td>Year Frozen</td> <td> </td> <td>Improvements 19,996</td> <td>12,496</td> <td> </td> <td>1,500</td> <td>Penalty</td> <td>0</td> <td> </td> </tr> <tr> <td>Uncapped Value</td> <td>0</td> <td>Mobile Home 0</td> <td>0</td> <td> </td> <td>0</td> <td>Exemption</td> <td>0</td> <td>0.00</td> </tr> <tr> <td>TIF Project ID</td> <td>0</td> <td>Total Value 25,176</td> <td>15,991</td> <td> </td> <td>1,919</td> <td>Total Taxable</td> <td>1,919</td> <td>128.00</td> </tr> </tbody> </table>					Source	REAL	Fair Cash	Capped	Asmnt Level	Assessed	Levy Rate	66.830	Current Tax	Remove Cap		Land Value 5,180	3,495	12%	419	Assessed	1,919	128.25	Year Frozen		Improvements 19,996	12,496		1,500	Penalty	0		Uncapped Value	0	Mobile Home 0	0		0	Exemption	0	0.00	TIF Project ID	0	Total Value 25,176	15,991		1,919	Total Taxable	1,919	128.00	<table border="1"> <thead> <tr> <th>Bk/Pg</th> <th>Grantor</th> <th>Date</th> <th>Price</th> <th>Code</th> </tr> </thead> <tbody> <tr> <td> </td> <td> </td> <td> </td> <td> </td> <td> </td> </tr> </tbody> </table>					Bk/Pg	Grantor	Date	Price	Code					
Source	REAL	Fair Cash	Capped	Asmnt Level	Assessed	Levy Rate	66.830	Current Tax																																																								
Remove Cap		Land Value 5,180	3,495	12%	419	Assessed	1,919	128.25																																																								
Year Frozen		Improvements 19,996	12,496		1,500	Penalty	0																																																									
Uncapped Value	0	Mobile Home 0	0		0	Exemption	0	0.00																																																								
TIF Project ID	0	Total Value 25,176	15,991		1,919	Total Taxable	1,919	128.00																																																								
Bk/Pg	Grantor	Date	Price	Code																																																												
<b>Assessment History</b>																																																																
<b>Tax Year</b>	<b>Statement Number</b>	<b>Billed Owner</b>			<b>Tax Area</b>	<b>Total Value</b>	<b>Exemptions</b>	<b>Taxable Value</b>	<b>Billed Tax</b>																																																							
2025	2025-300000376	ALEXANDER, TONY T. &			104	25,176	0	1,827	122.00																																																							
2024	2024-300000376	ALEXANDER, TONY T. &			104	26,714	0	1,740	116.00																																																							
2023	2023-300000376	ALEXANDER, TONY T. &			104	24,645	0	1,658	111.00																																																							
2022	2022-300000376	ALEXANDER, TONY T. &			104	23,288	0	1,579	106.00																																																							
2021	2021-300000376	ALEXANDER, TONY T. AND			104	23,288	0	1,533	102.00																																																							
2020	2020-300000376	ALEXANDER, TONY T. AND			104	23,288	0	1,488	119.00																																																							
2019	2019-0000376	ALEXANDER, TONY T. AND			104	23,288		1,445	116.00																																																							
2018	2018-0000376	ALEXANDER, TONY T. AND			104	23,288		1,403	111.00																																																							
2017	2017-0000376	ALEXANDER, TONY T. AND			104	21,896		1,362	109.00																																																							
2016	2016-0000376	ALEXANDER, TONY T. AND			104	21,896		1,323	106.00																																																							
2015	2015-0000376	ALEXANDER, TONY T. AND			104	21,177		1,284	101.00																																																							
2014	2014-0000376	ALEXANDER, TONY T. AND			104	19,947		1,247	97.00																																																							
2013	2013-0000376	ALEXANDER, TONY T. AND			104	19,947		1,210	93.00																																																							



# Harper

## Assessment Property Record Card for Tax Year 2026

Data provided by SHAYLYN WEDER County Assessor

Date 02/06/2026  
 Time 05:57:06  
 Page 2

Lot Data	Acre - HomeSite and Tracts	Primary Image
Lot Size Lot Count Units Buildable Non-Ag Acres 1.24 Topography Street Access Utilities Amenities  Method Acre Base Lot Value 1.24 x 4,177.42 = 5,180 Factor Value Adjustments Lot Value 5,180		

Residential Data	
Type	1 Single Family Residence
Condition	3 - Average
Quality	3 - Average
Architecture	TRAD TRADITIONAL
Style	100% One Story
Exterior Wall	100% Asbestos Siding
Base/Total Area	1,020 / 1,020
Style	100% One Story
HVAC	100% Floor Furnace 1 Wall Air Conditioners (Cour
Roof Cover	2 Composition Roll
Area on Slab	1,020
Fixture/RghIn	5 /
Bed/F/H Bath	2 / 1.0 /
Basement Area	
Garage Type	
Remodel	
Year/Eff Age	1940 / 86

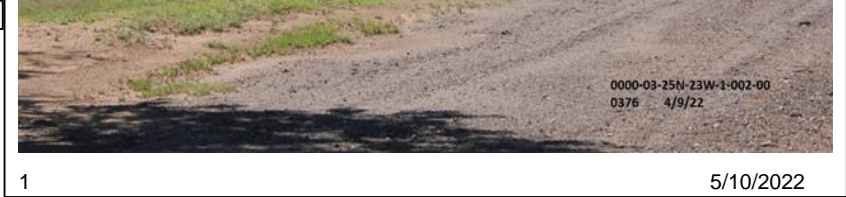

1 5/10/2022

GRM Approach	
GRM Code	
Gross Rent Indicated Value	

Multiple Regression	
MRA Code	
Adjusted R Indicated Value	

Direct Comparables	
Selection Model	DEFAULT DEFAULT SELECTION MODEL
Adjustment Model	DEFAULT DEFAULT ADJUSTMENTS TABLE
Comparables Indicated Value	

Cost Approach		Manual :	
Base Cost	88.97	Total Misc Impr	+ 549
Roofing Adj	+ 3.48	Garage Cost	+ 549
Subfloor Adj	+ -2.07	Total RCN	= 100,866
Heat/Cool Adj	+ 1.73	Depreciation ( 80%)	- 80,693
Plumbing Adj	+ 6.25	Lump Sums	+ 0
Basement Adj	+ 0.00	RCNLD	= 20,173
Adj Base Cost	= 98.35	Lot Value	+ 5,180
Total Area	x 1,020	Indicated Value	= 25,353
Adjusted Cost	= 100,317	Value Per SqFt	24.86

Value Reconciliation			
Selected Approach	Cost Approach		
Improvements	20,173		
Lot Value	5,180		
Indicated Value	25,353	24.86	Per SqFt
Agland Value			
Site Improvements			
Total Value	25,353	24.86	Total Value Per SqFt

Miscellaneous Improvements							
Code	Description	Sketch ID	Size	Year	Units	Unit Cost	Depr Value
PRCH	Slab Porch - Covered	106	6x4		24	22.87	549



Harper

Assessment Property Record Card for Tax Year 2026

Data provided by SHAYLYN WEDER County Assessor

Date 02/06/2026

Time 05:57:06

Page 3

Sketch Image

300000376

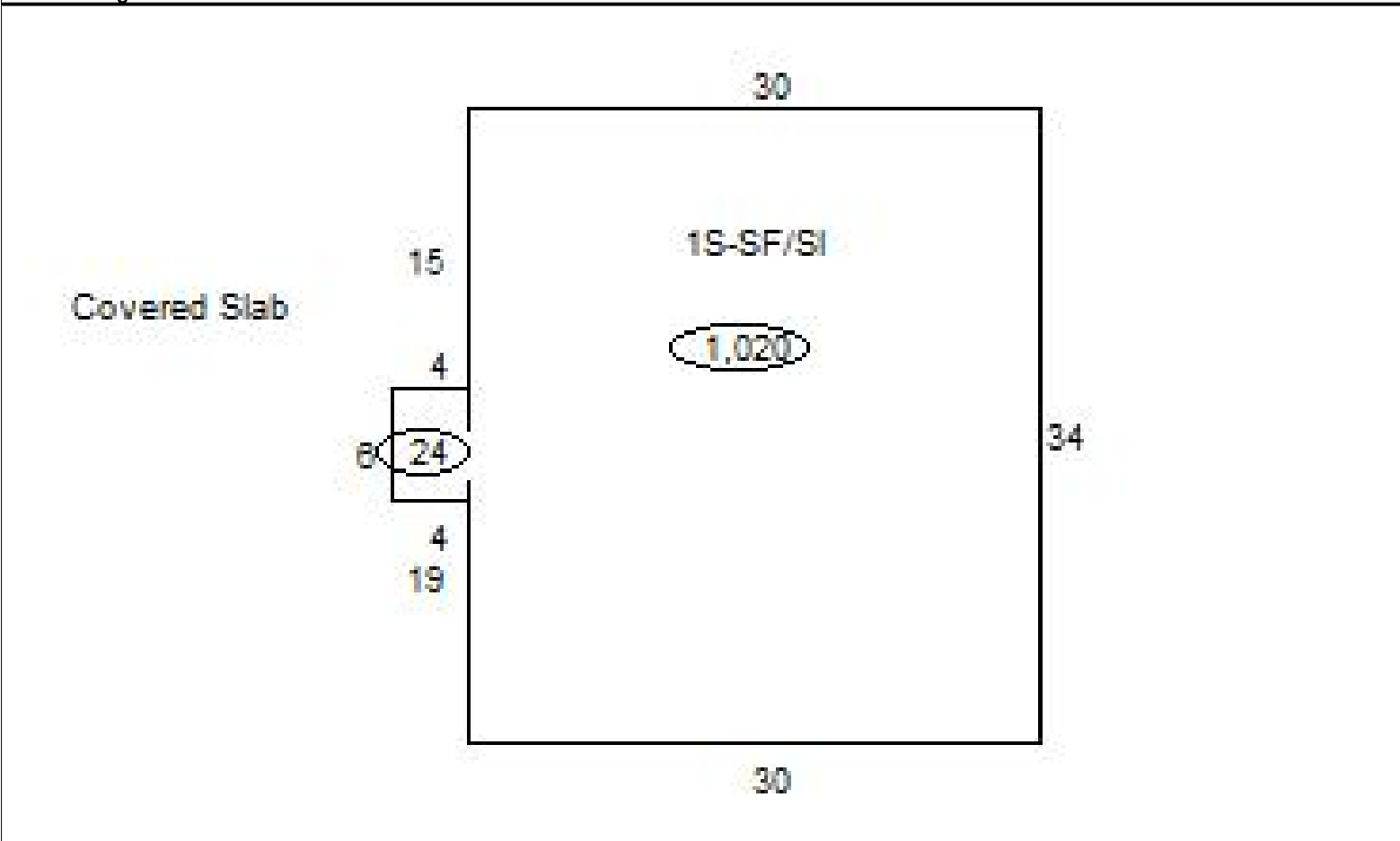

Sketch Vector Information

Sequence	Code	Type	Built Over	Scale	Section Label	Base Area	Multiplier	Total Area
1	R	1	Slab	20	1S-SF/SI	1,020	1.000	1,020
2	M	PRCH		20	Covered Slab	24	1.000	24
<b>Total Building Area</b>						1,020		1,020