



Harper

Assessment Property Record Card for Tax Year 2026

Data provided by SHAYLYN WEDER County Assessor

Date 02/06/2026
 Time 06:09:22
 Page 1

Assessment Data					Primary Image																																																																																																																				
Account 300001305 Parcel ID 0000-04-26N-23W-1-002-00 Cadastral ID 0000-26N-23W-04-1-002-00 Property Type REAL - Real Property Property Class RA VI Area 4 Tax Area 102 - 4R-BUFFALO Name ID 25840 SNELL FARMS LIVING TRUST (THE) TRUSTEE: BARBARA L. SNELL 18764 E 17 RD BUFFALO OK 73834- Parcel Location Situs 18764 E 17 RD Subdivision Lot/Block / Parcel Size 42 - Acres Sec/Twn/Rng 4 / 26 / 23 / 1 Neighborhood 1000 - COUNTY School District 4-BUFFAL - 4-BUFFALO																																																																																																																									
Legal Description Lat/Long: 36.69194717 -99.64994698 SEC.4-26N-23W LOT 2																																																																																																																									
Exemptions <table border="1"> <thead> <tr> <th>Code</th> <th>Type</th> <th>Active</th> <th>Maximum</th> <th>Exemption</th> </tr> </thead> <tbody> <tr> <td>H</td> <td>Homestead</td> <td>Yes</td> <td>1,000</td> <td>1,000</td> </tr> </tbody> </table>					Code	Type	Active	Maximum	Exemption	H	Homestead	Yes	1,000	1,000	Building Permits <table border="1"> <thead> <tr> <th>Number</th> <th>Description</th> <th>Opened</th> <th>Closed</th> <th>Amount</th> </tr> </thead> <tbody> <tr> <td></td> <td></td> <td></td> <td></td> <td></td> </tr> </tbody> </table>					Number	Description	Opened	Closed	Amount																																																																																																	
Code	Type	Active	Maximum	Exemption																																																																																																																					
H	Homestead	Yes	1,000	1,000																																																																																																																					
Number	Description	Opened	Closed	Amount																																																																																																																					
Parcel Valuation <table border="1"> <thead> <tr> <th>Source</th> <th>REAL</th> <th>Fair Cash</th> <th>Capped</th> <th>Asmnt Level</th> <th>Assessed</th> <th>Levy Rate</th> <th>78.740</th> <th>Current Tax</th> </tr> </thead> <tbody> <tr> <td>Remove Cap</td> <td></td> <td>Land Value</td> <td>13,280</td> <td>13,280</td> <td>12%</td> <td>1,594</td> <td>Assessed</td> <td>10,563 831.73</td> </tr> <tr> <td>Year Frozen</td> <td></td> <td>Improvements</td> <td>107,290</td> <td>74,747</td> <td></td> <td>8,969</td> <td>Penalty</td> <td>0</td> </tr> <tr> <td>Uncapped Value</td> <td>0</td> <td>Mobile Home</td> <td>0</td> <td>0</td> <td>0</td> <td>0</td> <td>Exemption</td> <td>1,000 -79.00</td> </tr> <tr> <td>TIF Project ID</td> <td>0</td> <td>Total Value</td> <td>120,570</td> <td>88,027</td> <td>10,563</td> <td>Total Taxable</td> <td>9,563</td> <td>753.00</td> </tr> </tbody> </table>					Source	REAL	Fair Cash	Capped	Asmnt Level	Assessed	Levy Rate	78.740	Current Tax	Remove Cap		Land Value	13,280	13,280	12%	1,594	Assessed	10,563 831.73	Year Frozen		Improvements	107,290	74,747		8,969	Penalty	0	Uncapped Value	0	Mobile Home	0	0	0	0	Exemption	1,000 -79.00	TIF Project ID	0	Total Value	120,570	88,027	10,563	Total Taxable	9,563	753.00	Sale History <table border="1"> <thead> <tr> <th>Bk/Pg</th> <th>Grantor</th> <th>Date</th> <th>Price</th> <th>Code</th> </tr> </thead> <tbody> <tr> <td>793/523</td> <td>SNELL, BARBARA L.</td> <td>10/13/2025</td> <td></td> <td>04</td> </tr> <tr> <td>792/407</td> <td>SNELL, DAVID LINN</td> <td>10/08/2025</td> <td></td> <td>04</td> </tr> </tbody> </table>					Bk/Pg	Grantor	Date	Price	Code	793/523	SNELL, BARBARA L.	10/13/2025		04	792/407	SNELL, DAVID LINN	10/08/2025		04																																																				
Source	REAL	Fair Cash	Capped	Asmnt Level	Assessed	Levy Rate	78.740	Current Tax																																																																																																																	
Remove Cap		Land Value	13,280	13,280	12%	1,594	Assessed	10,563 831.73																																																																																																																	
Year Frozen		Improvements	107,290	74,747		8,969	Penalty	0																																																																																																																	
Uncapped Value	0	Mobile Home	0	0	0	0	Exemption	1,000 -79.00																																																																																																																	
TIF Project ID	0	Total Value	120,570	88,027	10,563	Total Taxable	9,563	753.00																																																																																																																	
Bk/Pg	Grantor	Date	Price	Code																																																																																																																					
793/523	SNELL, BARBARA L.	10/13/2025		04																																																																																																																					
792/407	SNELL, DAVID LINN	10/08/2025		04																																																																																																																					
Assessment History <table border="1"> <thead> <tr> <th>Tax Year</th> <th>Statement Number</th> <th>Billed Owner</th> <th>Tax Area</th> <th>Total Value</th> <th>Exemptions</th> <th>Taxable Value</th> <th>Billed Tax</th> </tr> </thead> <tbody> <tr><td>2025</td><td>2025-300001305</td><td>SNELL FARMS LIVING TRUST (THE)</td><td>102</td><td>120,570</td><td>1000</td><td>9,256</td><td>729.00</td></tr> <tr><td>2024</td><td>2024-300001305</td><td>SNELL, DAVID LINN, ETUX</td><td>102</td><td>125,085</td><td>1000</td><td>8,957</td><td>729.00</td></tr> <tr><td>2023</td><td>2023-300001305</td><td>SNELL, DAVID LINN, ETUX</td><td>102</td><td>116,549</td><td>1000</td><td>8,667</td><td>717.00</td></tr> <tr><td>2022</td><td>2022-300001305</td><td>SNELL, DAVID LINN, ETUX</td><td>102</td><td>78,213</td><td>1000</td><td>8,385</td><td>690.00</td></tr> <tr><td>2021</td><td>2021-300001305</td><td>SNELL, DAVID LINN, ETUX</td><td>102</td><td>78,213</td><td>1000</td><td>8,385</td><td>692.00</td></tr> <tr><td>2020</td><td>2020-300001305</td><td>SNELL, DAVID LINN, ETUX</td><td>102</td><td>78,213</td><td>1000</td><td>8,385</td><td>690.00</td></tr> <tr><td>2019</td><td>2019-0001305</td><td>SNELL, DAVID LINN, ETUX</td><td>102</td><td>77,961</td><td></td><td>8,355</td><td>692.00</td></tr> <tr><td>2018</td><td>2018-0001305</td><td>SNELL, DAVID LINN, ETUX</td><td>102</td><td>79,611</td><td></td><td>8,553</td><td>709.00</td></tr> <tr><td>2017</td><td>2017-0001305</td><td>SNELL, DAVID LINN, ETUX</td><td>102</td><td>78,165</td><td></td><td>8,379</td><td>697.00</td></tr> <tr><td>2016</td><td>2016-0001305</td><td>SNELL, DAVID LINN, ETUX</td><td>102</td><td>73,633</td><td></td><td>7,663</td><td>652.00</td></tr> <tr><td>2015</td><td>2015-0001305</td><td>SNELL, DAVID LINN, ETUX</td><td>102</td><td>73,031</td><td></td><td>7,412</td><td>588.00</td></tr> <tr><td>2014</td><td>2014-0001305</td><td>SNELL, DAVID LINN, ETUX</td><td>102</td><td>71,729</td><td></td><td>7,167</td><td>574.00</td></tr> <tr><td>2013</td><td>2013-0001305</td><td>SNELL, DAVID LINN, ETUX</td><td>102</td><td>71,982</td><td></td><td>6,928</td><td>552.00</td></tr> </tbody> </table>										Tax Year	Statement Number	Billed Owner	Tax Area	Total Value	Exemptions	Taxable Value	Billed Tax	2025	2025-300001305	SNELL FARMS LIVING TRUST (THE)	102	120,570	1000	9,256	729.00	2024	2024-300001305	SNELL, DAVID LINN, ETUX	102	125,085	1000	8,957	729.00	2023	2023-300001305	SNELL, DAVID LINN, ETUX	102	116,549	1000	8,667	717.00	2022	2022-300001305	SNELL, DAVID LINN, ETUX	102	78,213	1000	8,385	690.00	2021	2021-300001305	SNELL, DAVID LINN, ETUX	102	78,213	1000	8,385	692.00	2020	2020-300001305	SNELL, DAVID LINN, ETUX	102	78,213	1000	8,385	690.00	2019	2019-0001305	SNELL, DAVID LINN, ETUX	102	77,961		8,355	692.00	2018	2018-0001305	SNELL, DAVID LINN, ETUX	102	79,611		8,553	709.00	2017	2017-0001305	SNELL, DAVID LINN, ETUX	102	78,165		8,379	697.00	2016	2016-0001305	SNELL, DAVID LINN, ETUX	102	73,633		7,663	652.00	2015	2015-0001305	SNELL, DAVID LINN, ETUX	102	73,031		7,412	588.00	2014	2014-0001305	SNELL, DAVID LINN, ETUX	102	71,729		7,167	574.00	2013	2013-0001305	SNELL, DAVID LINN, ETUX	102	71,982		6,928	552.00
Tax Year	Statement Number	Billed Owner	Tax Area	Total Value	Exemptions	Taxable Value	Billed Tax																																																																																																																		
2025	2025-300001305	SNELL FARMS LIVING TRUST (THE)	102	120,570	1000	9,256	729.00																																																																																																																		
2024	2024-300001305	SNELL, DAVID LINN, ETUX	102	125,085	1000	8,957	729.00																																																																																																																		
2023	2023-300001305	SNELL, DAVID LINN, ETUX	102	116,549	1000	8,667	717.00																																																																																																																		
2022	2022-300001305	SNELL, DAVID LINN, ETUX	102	78,213	1000	8,385	690.00																																																																																																																		
2021	2021-300001305	SNELL, DAVID LINN, ETUX	102	78,213	1000	8,385	692.00																																																																																																																		
2020	2020-300001305	SNELL, DAVID LINN, ETUX	102	78,213	1000	8,385	690.00																																																																																																																		
2019	2019-0001305	SNELL, DAVID LINN, ETUX	102	77,961		8,355	692.00																																																																																																																		
2018	2018-0001305	SNELL, DAVID LINN, ETUX	102	79,611		8,553	709.00																																																																																																																		
2017	2017-0001305	SNELL, DAVID LINN, ETUX	102	78,165		8,379	697.00																																																																																																																		
2016	2016-0001305	SNELL, DAVID LINN, ETUX	102	73,633		7,663	652.00																																																																																																																		
2015	2015-0001305	SNELL, DAVID LINN, ETUX	102	73,031		7,412	588.00																																																																																																																		
2014	2014-0001305	SNELL, DAVID LINN, ETUX	102	71,729		7,167	574.00																																																																																																																		
2013	2013-0001305	SNELL, DAVID LINN, ETUX	102	71,982		6,928	552.00																																																																																																																		



Harper

Assessment Property Record Card for Tax Year 2026

Data provided by SHAYLYN WEDER County Assessor

Date 02/06/2026
 Time 06:09:22
 Page 2

Lot Data		Acre - HomeSite and Tracts	
Lot Size			
Lot Count			
Units Buildable			
Non-Ag Acres	1		
Topography			
Street Access			
Utilities			
Amenities			
Method	Acre		
Base Lot Value	1.00 x 5,000.00 = 5,000		
Factor Value			
Adjustments			
Lot Value	5,000		

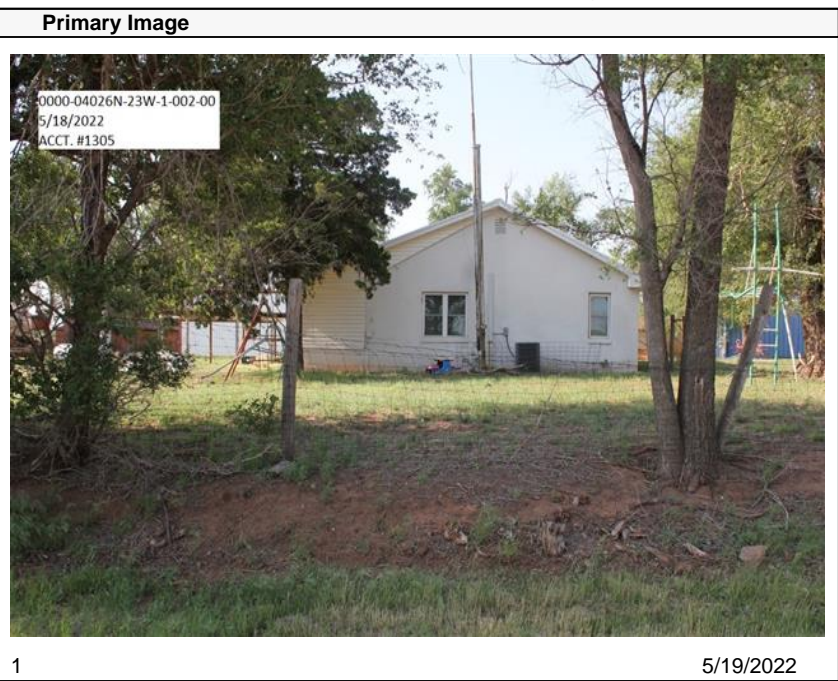

1 5/19/2022

Residential Data	
Type	1 Single Family Residence
Condition	2 - Fair
Quality	2 - Fair
Architecture	TRAD TRADITIONAL
Style	100% One Story
Exterior Wall	100% Frame, Stucco
Base/Total Area	1,334 / 1,334
Style	100% One Story
HVAC	100% Floor Furnace 1 Wall Air Conditioners (Cour
Roof Cover	4 Metal, Preformed
Area on Slab	0
Fixture/RghIn	5 /
Bed/F/H Bath	2 / 1.0 /
Basement Area	
Garage Type	
Remodel	
Year/Eff Age	1940 / 103

GRM Approach

GRM Code	
Gross Rent Indicated Value	

Multiple Regression

MRA Code	
Adjusted R Indicated Value	

Direct Comparables

Selection Model	DEFAULT	DEFAULT SELECTION MODEL
Adjustment Model	DEFAULT	DEFAULT ADJUSTMENTS TABLE
Comparables Indicated Value		

Value Reconciliation

Selected Approach	Cost Approach		
Improvements	23,177		
Lot Value	5,000		
Indicated Value	28,177	21.12	Per SqFt
Agland Value	8,280		
Site Improvements	82,152		
Total Value	118,609	88.91	Total Value Per SqFt

Cost Approach		Manual :	
Base Cost	75.01	Total Misc Impr	+ 932
Roofing Adj	+ 3.90	Garage Cost	+ 932
Subfloor Adj	+ 1.96	Total RCN	= 115,883
Heat/Cool Adj	+ 1.40	Depreciation (80%)	- 92,706
Plumbing Adj	+ 3.89	Lump Sums	+ 0
Basement Adj	+ 0.00	RCNLD	= 23,177
Adj Base Cost	= 86.17	Lot Value	+ 5,000
Total Area	x 1,334	Indicated Value	= 28,177
Adjusted Cost	= 114,951	Value Per SqFt	21.12

Miscellaneous Improvements

Code	Description	Sketch ID	Size	Year	Units	Unit Cost	Depr	Value
PATO	Raised Slab Porch - Open	446	3x3		9	8.72		78
PATO	Raised Slab Porch - Open	447	7x4		28	8.72		244
PATO	Slab Porch - Open	448	10x7		70	8.72		610



Harper

Assessment Property Record Card for Tax Year 2026

Data provided by SHAYLYN WEDER County Assessor

Date 02/06/2026
 Time 06:09:22
 Page 3

Sketch Image

300001305

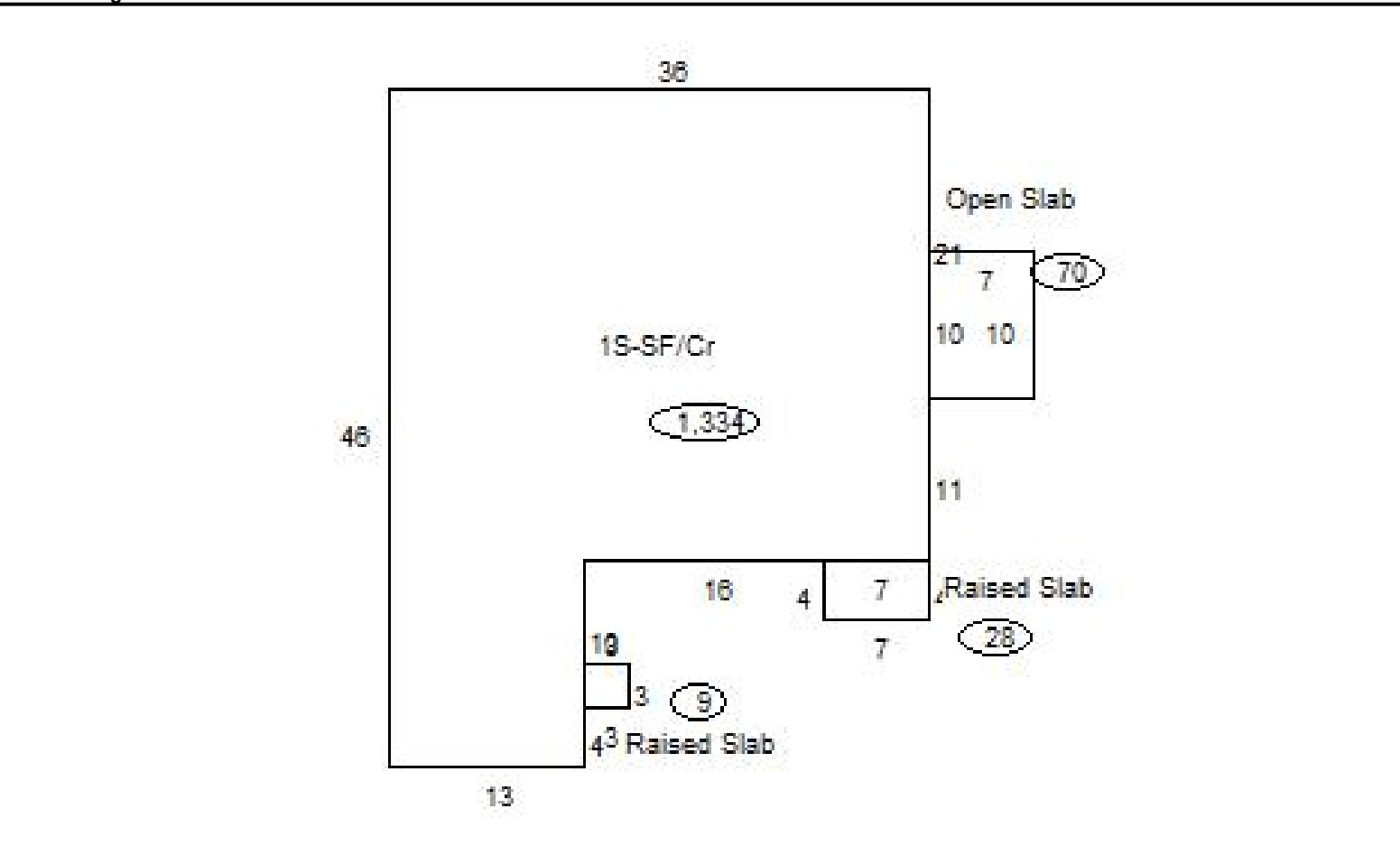

Sketch Vector Information

Sequence	Code	Type	Built Over	Scale	Section Label	Base Area	Multiplier	Total Area
1	R	1	Crawl	20	1S-SF/Cr	1,334	1.000	1,334
2	M	PATO		20	Raised Slab	9	1.000	9
3	M	PATO		20	Raised Slab	28	1.000	28
4	M	PATO		20	Open Slab	70	1.000	70
Total Building Area						1,334		1,334



Harper







Assessment Property Record Card for Tax Year 2026

Date provided by SHAYLYN WEDER County Assessor

Date 02/06/2026
 Time 06:09:22
 Page 4

300001305

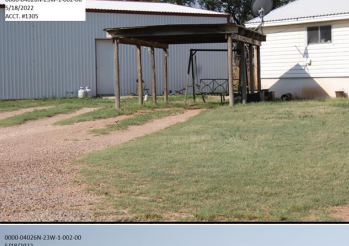
Outbuildings/Site Improvements

Building Image	Code	Description	Dimensions	Floor	Roofing	Total Units
	GBST	Grain Bin - Storage 400 BU X 2	0x0x0			800
	Qual	3	Cond 3	Year 2020	Eff Age 6	
	Valuation Summary		Modifier Total	RCN	Depr (28% Phys/ % Func)	RCNLD
	Base Cost (1.62 x 800)		1,296		1,296	363
	BFT1	Bulk Feed Tank - Single 15 TON	0x0x0			16
	Qual	3	Cond 3	Year 2020	Eff Age 6	
	Valuation Summary		Modifier Total	RCN	Depr (37% Phys/ % Func)	RCNLD
	Base Cost (236.24 x 16)		3,780		3,780	1,399
	GBST	Grain Bin - Storage 1,000 BU X 3	0x0x0			3,000
	Qual	3	Cond 3	Year 2017	Eff Age 9	
	Valuation Summary		Modifier Total	RCN	Depr (40% Phys/ % Func)	RCNLD
	Base Cost (1.62 x 3,000)		4,860		4,860	1,944
	STSL	Storage Tanks - Horizontal(2)	0x0x0			10,000
	Qual	3	Cond 3	Year 2012	Eff Age 14	
	Valuation Summary		Modifier Total	RCN	Depr (44% Phys/ % Func)	RCNLD
	Base Cost (1.28 x 10,000)		12,800		12,800	5,632
	SCTR	Scales - Truck, Concrete Platform	50x12x0			50
	Qual	3	Cond 3	Year 2010	Eff Age 16	
	Valuation Summary		Modifier Total	RCN	Depr (37% Phys/ % Func)	RCNLD
	Base Cost (717.92 x 50)		35,896		35,896	13,282
	CPDT	Carport - Detached	20x10x8		Formed Metal	200
	Qual	3	Cond 3	Year 2008	Eff Age 18	
	Valuation Summary		Modifier Total	RCN	Depr (64% Phys/ % Func)	RCNLD
	Base Cost (7.94 x 200)		1,588		1,588	1,016
	BFT1	Bulk Feed Tank - Single 25 TON	0x0x0			25
	Qual	3	Cond 3	Year 2006	Eff Age 20	
	Valuation Summary		Modifier Total	RCN	Depr (69% Phys/ % Func)	RCNLD
	Base Cost (236.24 x 25)		5,906		5,906	4,075



Harper

Assessment Property Record Card for Tax Year 2026

Data provided by SHAYLYN WEDER County Assessor

Date 02/06/2026
 Time 06:09:22
 Page 5

300001305

Outbuildings/Site Improvements

Building Image	Code	Description	Dimensions	Floor	Roofing	Total Units
	SHDS	Shipping/Storage Container	40x8x8		Formed Metal	320
	Qual 3	Cond 3	Year 2005	Eff Age 21		
			0			
			0			
Valuation Summary		Modifier Total	RCN	Depr (61% Phys/ % Func)	RCNLD	
Base Cost (19.46 x 320)		6,227		6,227	3,798	2,429
	GBST	Grain Bin - Storage 1,000 BU X 3	0x0x0			3,000
	Qual 3	Cond 3	Year 1990	Eff Age 36		
			0			
			0			
Valuation Summary		Modifier Total	RCN	Depr (80% Phys/ % Func)	RCNLD	
Base Cost (1.62 x 3,000)		4,860		4,860	3,888	972
	UTIL	Utility Building	60x40x14		Formed Metal	2,400
	Qual 3	Cond 3	Year 1980	Eff Age 46		
			0			
			0			
Valuation Summary		Modifier Total	RCN	Depr (69% Phys/ % Func)	RCNLD	
Base Cost (23.07 x 2,400)		55,368		55,368	38,204	17,164
	BNGP	Barn - General Purpose	52x48x8		Formed Metal	2,496
	Qual 3	Cond 3	Year 1980	Eff Age 46		
			0			
			0			
Valuation Summary		Modifier Total	RCN	Depr (69% Phys/ % Func)	RCNLD	
Base Cost (16.22 x 2,496)		40,485		40,485	27,935	12,550
	ASC	Awing	60x20x14		Formed Metal	1,200
	Qual 3	Cond 3	Year 1980	Eff Age 35		
			0			
			0			
Valuation Summary		Modifier Total	RCN	Depr (80% Phys/ % Func)	RCNLD	
Base Cost (3.94 x 1,200)		4,728		4,728	3,782	946
	CKCP	Chicken Coop	10x32x6		Galvanized Metal	320
	Qual 3	Cond 3	Year 1970	Eff Age 56		
			0			
			0			
Valuation Summary		Modifier Total	RCN	Depr (80% Phys/ % Func)	RCNLD	
Base Cost (6.11 x 320)		1,955		1,955	1,564	391
	CKCP	Chicken Coop	10x18x6		Galvanized Metal	180
	Qual 3	Cond 3	Year 1970	Eff Age 56		
			0			
			0			
Valuation Summary		Modifier Total	RCN	Depr (80% Phys/ % Func)	RCNLD	
Base Cost (5.54 x 180)		997		997	798	199



Harper

Assessment Property Record Card for Tax Year 2026

Data provided by SHAYLYN WEDER County Assessor

Date 02/06/2026
 Time 06:09:22
 Page 6

300001305

Outbuildings/Site Improvements

Building Image	Code	Description	Dimensions	Floor	Roofing	Total Units	
	UTIL	Utility Building	30x50x12		Formed Metal	1,500	
	Qual	3	Cond 3	Year	1970	Eff Age	56
							0
							0
							0
		Valuation Summary	Modifier Total	RCN	Depr (76% Phys/ % Func)	RCNLD	
		Base Cost (25.24 x 1,500)	37,860		37,860	28,774	9,086



Harper

Assessment Property Record Card for Tax Year 2026

Data provided by SHAYLYN WEDER County Assessor

Date 02/06/2026
Time 06:09:22
Page 7

Agland Inventory

300001305

Soi	Description	Land Use	LPI	Adj Type	Adj Code	Acres	Use/Acre	Mkt/Acre	Use Value	Market Value
CA	CAREY SILT 1-3%	NP	50			1.953	160	160	312	312
CA	CAREY SILT 1-3%	CR	50			17.546	255	255	4,466	4,466
LD	LOAMY ALLUVIAL LAND	NP	33			1.299	106	106	137	137
LD	LOAMY ALLUVIAL LAND	CR	33			.154	168	168	26	26
QA	QUINLAN LOAM	CR	11			.556	56	56	31	31
QA	QUINLAN LOAM	NP	11			1.508	35	35	53	53
W	WATER	CR	0			.515	0	0	0	0
WA	WOODWARD 1-3%	NP	43			1.613	138	138	222	222
WA	WOODWARD 1-3%	CR	43			7.260	219	219	1,589	1,589
WB	WOODWARD 3-8%	CR	33			8.596	168	168	1,444	1,444
CR Totals						41.000			8,280	8,280
Total Agland						41.000			8,280	8,280