



Harper

Assessment Property Record Card for Tax Year 2026

Data provided by SHAYLYN WEDER County Assessor

Date 02/06/2026
 Time 06:11:51
 Page 1

Assessment Data					Primary Image									
Account	300001478				<p>0000-06-26N-24W-2-001-00</p> <p>f:\pictures\0000-06-26N-24W-2-001-00-001-000-001.jpg 9/11/2014</p>									
Parcel ID	0000-06-26N-24W-2-001-00													
Cadastral ID	0000-26N-24W-06-2-001-00													
Property Type	REAL - Real Property													
Property Class	RA	VI Area	4											
Tax Area	101 - 1R-LAVERNE													
Name ID	12979													
BENTLEY, TY														
1059 N 180 RD ROSSTON OK 73855-0000														
Parcel Location														
Situs	N 179 RD													
Subdivision														
Lot/Block	/	Parcel Size	263 - Acres											
Sec/Twn/Rng	6 / 26 / 24 / 2													
Neighborhood	1000 - COUNTY													
School District	1-LAVERN - 1-LAVERNE													
Legal Description Lat/Long: 36.75073273 -99.65861612														
SEC. 6-26-24 LOT 3 THRU 7; SE4NW4 BOOK 713 PAGE 772														
Building Permits														
<table border="1"> <thead> <tr> <th>Number</th> <th>Description</th> <th>Opened</th> <th>Closed</th> <th>Amount</th> </tr> </thead> <tbody> <tr> <td colspan="5" style="height: 100px;"> </td> </tr> </tbody> </table>					Number	Description	Opened	Closed	Amount					
Number	Description	Opened	Closed	Amount										
Exemptions														
Code	Type	Active	Maximum	Exemption										
Sale History														
Bk/Pg	Grantor	Date	Price	Code										
713/772	FERGASON, INEZ L. (TRUS	12/16/2015	250,000	Q										
Parcel Valuation														
Source	REAL	Fair Cash	Capped	Asmnt Level	Assessed	Levy Rate	67.190	Current Tax						
Remove Cap		Land Value	24,539	24,539	12%	2,945	Assessed	2,945 197.87						
Year Frozen		Improvements	0	0		0	Penalty	0						
Uncapped Value	0	Mobile Home	0	0		0	Exemption	0 0.00						
TIF Project ID	0	Total Value	24,539	24,539		2,945	Total Taxable	2,945 198.00						
Assessment History														
Tax Year	Statement Number	Billed Owner	Tax Area	Total Value	Exemptions	Taxable Value	Billed Tax							
2025	2025-300001478	BENTLEY, TY	101	24,539	0	2,945	198.00							
2024	2024-300001478	BENTLEY, TY	101	24,539	0	2,945	196.00							
2023	2023-300001478	BENTLEY, TY	101	24,539	0	2,945	198.00							
2022	2022-300001478	BENTLEY, TY	101	25,610	0	3,073	208.00							
2021	2021-300001478	BENTLEY, TY	101	25,610	0	3,073	212.00							
2020	2020-300001478	BENTLEY, TY	101	25,610	0	3,073	208.00							
2019	2019-0001478	BENTLEY, TY	101	25,610		3,073	183.00							
2018	2018-0001478	BENTLEY, TY	101	25,610		3,073	183.00							
2017	2017-0001478	BENTLEY, TY	101	25,610		3,073	183.00							
2016	2016-0001478	BENTLEY, TY	101	25,610		3,073	183.00							
2015	2015-0001478	FERGASON, INEZ L. (TRUST)	101	25,610		3,073	183.00							
2014	2014-0001478	FERGASON, INEZ L. (TRUST)	101	25,610		3,073	183.00							
2013	2013-0001478	FERGASON, INEZ L. (TRUST)	101	25,610		3,073	183.00							



Harper

Assessment Property Record Card for Tax Year 2026

Data provided by SHAYLYN WEDER County Assessor

Date 02/06/2026
 Time 06:11:51
 Page 2

Lot Data	
Lot Size	-
Lot Count	-
Units Buildable	-
Non-Ag Acres	0
Topography	-
Street Access	-
Utilities	-
Amenities	-
Method	-
Base Lot Value	-
Factor Value	-
Adjustments	-
Lot Value	-

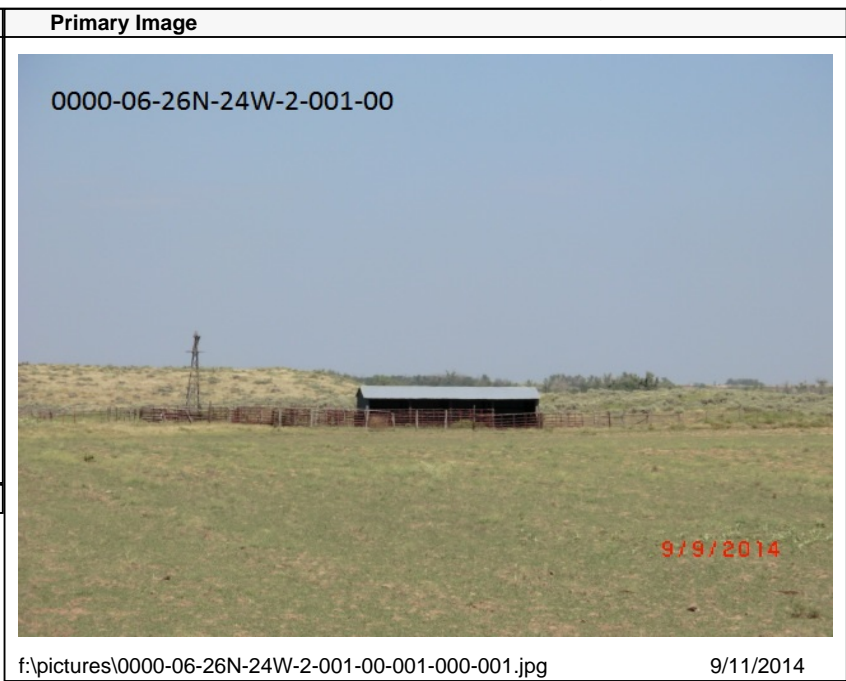

Residential Data	
Type	-
Condition	-
Quality	-
Architecture	-
Style	-
Exterior Wall	-
Base/Total Area	/
Style	-
HVAC	-
Roof Cover	-
Area on Slab	-
Fixture/RghIn	/
Bed/F/H Bath	//
Basement Area	-
Garage Type	-
Remodel	-
Year/Eff Age	/

GRM Approach

GRM Code	-
Gross Rent	-
Indicated Value	-

Multiple Regression

MRA Code	-
Adjusted R	-
Indicated Value	-

Direct Comparables

Selection Model	DEFAULT	DEFAULT SELECTION MODEL
Adjustment Model	DEFAULT	DEFAULT ADJUSTMENTS TABLE
Comparables	-	-
Indicated Value	-	-

Value Reconciliation

Selected Approach	Cost Approach
Improvements	-
Lot Value	-
Indicated Value	0.00 Per SqFt
Agland Value	24,539
Site Improvements	-
Total Value	24,539 0.00 Total Value Per SqFt

Cost Approach		Manual :	
Base Cost	0.00	Total Misc Impr	+ 0
Roofing Adj	+ 0.00	Garage Cost	+ 0
Subfloor Adj	+ 0.00	Total RCN	= 0
Heat/Cool Adj	+ 0.00	Depreciation (0%)	- 0
Plumbing Adj	+ 0.00	Lump Sums	+ 0
Basement Adj	+ 0.00	RCNLD	= 0
Adj Base Cost	= 0.00	Lot Value	+ 0
Total Area	x	Indicated Value	= 0
Adjusted Cost	= 0	Value Per SqFt	0.00

Miscellaneous Improvements

Code	Description	Sketch ID	Size	Year	Units	Unit Cost	Depr	Value
------	-------------	-----------	------	------	-------	-----------	------	-------



Harper

Assessment Property Record Card for Tax Year 2026

Data provided by SHAYLYN WEDER County Assessor

Date 02/06/2026
Time 06:11:51
Page 3

Agland Inventory

300001478

Soi	Description	Land Use	LPI	Adj Type	Adj Code	Acres	Use/Acre	Mkt/Acre	Use Value	Market Value
MD	MANSKER LOAM 1-3%	NP	39			2.103	125	125	262	262
PA	PRATT BILLOWY	CR	48			10.929	244	244	2,670	2,670
PA	PRATT BILLOWY	NP	48			.033	154	154	5	5
PB	PRATT HUMMOCKY	NP	40			.232	128	128	30	30
PB	PRATT HUMMOCKY	CR	40			1.823	204	204	371	371
PC	PRATT LOAMY BILLOWY	CR	37			8.647	188	188	1,629	1,629
PC	PRATT LOAMY BILLOWY	NP	37			65.310	118	118	7,733	7,733
PD	PRATT LOAMY HUMMOCKY	NP	31			54.528	99	99	5,409	5,409
PD	PRATT LOAMY HUMMOCKY	CR	31			12.552	158	158	1,981	1,981
PE	PRATT LOAMY DUNED	NP	20			.173	64	64	11	11
TD	TIVOLI FINE SAND	NP	13			106.671	42	42	4,438	4,438
NP Totals						263.000			24,539	24,539
Total Agland						263.000			24,539	24,539