



Harper

Assessment Property Record Card for Tax Year 2026

Data provided by SHAYLYN WEDER County Assessor

Date 02/06/2026
 Time 06:15:08
 Page 1

Assessment Data					Primary Image																																																																																																																				
Account 300001707 Parcel ID 0000-21-26N-25W-1-009-00 Cadastral ID 0000-26N-25W-21-1-009-00 Property Type REAL - Real Property Property Class RR VI Area 4 Tax Area 101 - 1R-LAVERNE Name ID 13081 WATSON, DANNY R. & SHERRI R. WATSON 199120 E COUNTY RD 48 WOODWARD OK 73801- Parcel Location Situs 02049 176 RD N Subdivision Lot/Block / Parcel Size .42 - Acres Sec/Twn/Rng 21 / 26 / 25 / 1 Neighborhood 1000 - COUNTY School District 1-LAVERNE - 1-LAVERNE					<p>0000-21-26N-25W-1-009-00 ACCT # 1707 07/01/22</p> <p>House / Covered Porch 7/5/2022</p>																																																																																																																				
Legal Description Lat/Long: 36.76439832 -100.00154192 SEC.21-26-25 TRACT IN SE4NE4 BOOK 664 PAGE 682																																																																																																																									
Exemptions <table border="1"> <thead> <tr> <th>Code</th> <th>Type</th> <th>Active</th> <th>Maximum</th> <th>Exemption</th> </tr> </thead> <tbody> <tr> <td>H</td> <td>Homestead</td> <td>Yes</td> <td>1,000</td> <td>1,000</td> </tr> </tbody> </table>					Code	Type	Active	Maximum	Exemption	H	Homestead	Yes	1,000	1,000	Building Permits <table border="1"> <thead> <tr> <th>Number</th> <th>Description</th> <th>Opened</th> <th>Closed</th> <th>Amount</th> </tr> </thead> <tbody> <tr> <td></td> <td></td> <td></td> <td></td> <td></td> </tr> </tbody> </table>					Number	Description	Opened	Closed	Amount																																																																																																	
Code	Type	Active	Maximum	Exemption																																																																																																																					
H	Homestead	Yes	1,000	1,000																																																																																																																					
Number	Description	Opened	Closed	Amount																																																																																																																					
Parcel Valuation <table border="1"> <thead> <tr> <th>Source</th> <th>REAL</th> <th>Fair Cash</th> <th>Capped</th> <th>Asmnt Level</th> <th>Assessed</th> <th>Levy Rate</th> <th>67.190</th> <th>Current Tax</th> </tr> </thead> <tbody> <tr> <td>Remove Cap</td> <td></td> <td>Land Value 2,500</td> <td>2,500</td> <td>12%</td> <td>300</td> <td>Assessed 7,999</td> <td></td> <td>537.45</td> </tr> <tr> <td>Year Frozen</td> <td></td> <td>Improvements 64,152</td> <td>64,152</td> <td></td> <td>7,699</td> <td>Penalty 0</td> <td></td> <td></td> </tr> <tr> <td>Uncapped Value</td> <td>0</td> <td>Mobile Home 0</td> <td>0</td> <td></td> <td>0</td> <td>Exemption 1,000</td> <td></td> <td>-67.00</td> </tr> <tr> <td>TIF Project ID</td> <td>0</td> <td>Total Value 66,652</td> <td>66,652</td> <td></td> <td>7,999</td> <td>Total Taxable 6,999</td> <td></td> <td>470.00</td> </tr> </tbody> </table>					Source	REAL	Fair Cash	Capped	Asmnt Level	Assessed	Levy Rate	67.190	Current Tax	Remove Cap		Land Value 2,500	2,500	12%	300	Assessed 7,999		537.45	Year Frozen		Improvements 64,152	64,152		7,699	Penalty 0			Uncapped Value	0	Mobile Home 0	0		0	Exemption 1,000		-67.00	TIF Project ID	0	Total Value 66,652	66,652		7,999	Total Taxable 6,999		470.00	Sale History <table border="1"> <thead> <tr> <th>Bk/Pg</th> <th>Grantor</th> <th>Date</th> <th>Price</th> <th>Code</th> </tr> </thead> <tbody> <tr> <td>589/397</td> <td>GOLDSTON, DICKIE L. ETUX</td> <td>12/30/2003</td> <td>33,500</td> <td>PQ</td> </tr> <tr> <td>/</td> <td>WATSON, DANNY R. &</td> <td></td> <td></td> <td></td> </tr> </tbody> </table>					Bk/Pg	Grantor	Date	Price	Code	589/397	GOLDSTON, DICKIE L. ETUX	12/30/2003	33,500	PQ	/	WATSON, DANNY R. &																																																							
Source	REAL	Fair Cash	Capped	Asmnt Level	Assessed	Levy Rate	67.190	Current Tax																																																																																																																	
Remove Cap		Land Value 2,500	2,500	12%	300	Assessed 7,999		537.45																																																																																																																	
Year Frozen		Improvements 64,152	64,152		7,699	Penalty 0																																																																																																																			
Uncapped Value	0	Mobile Home 0	0		0	Exemption 1,000		-67.00																																																																																																																	
TIF Project ID	0	Total Value 66,652	66,652		7,999	Total Taxable 6,999		470.00																																																																																																																	
Bk/Pg	Grantor	Date	Price	Code																																																																																																																					
589/397	GOLDSTON, DICKIE L. ETUX	12/30/2003	33,500	PQ																																																																																																																					
/	WATSON, DANNY R. &																																																																																																																								
Assessment History <table border="1"> <thead> <tr> <th>Tax Year</th> <th>Statement Number</th> <th>Billed Owner</th> <th>Tax Area</th> <th>Total Value</th> <th>Exemptions</th> <th>Taxable Value</th> <th>Billed Tax</th> </tr> </thead> <tbody> <tr><td>2025</td><td>2025-300001707</td><td>WATSON, DANNY R. &</td><td>101</td><td>66,652</td><td>1000</td><td>6,999</td><td>470.00</td></tr> <tr><td>2024</td><td>2024-300001707</td><td>WATSON, DANNY R. &</td><td>101</td><td>72,757</td><td>1000</td><td>6,776</td><td>451.00</td></tr> <tr><td>2023</td><td>2023-300001707</td><td>WATSON, DANNY R. &</td><td>101</td><td>73,750</td><td>1000</td><td>6,550</td><td>440.00</td></tr> <tr><td>2022</td><td>2022-300001707</td><td>WATSON, DANNY R. &</td><td>101</td><td>61,081</td><td>1000</td><td>6,330</td><td>429.00</td></tr> <tr><td>2021</td><td>2021-300001707</td><td>WATSON, DANNY R. &</td><td>101</td><td>61,081</td><td>1000</td><td>6,330</td><td>437.00</td></tr> <tr><td>2020</td><td>2020-300001707</td><td>WATSON, DANNY R. &</td><td>101</td><td>61,081</td><td>1000</td><td>6,330</td><td>429.00</td></tr> <tr><td>2019</td><td>2019-0001707</td><td>WATSON, DANNY R. &</td><td>101</td><td>61,977</td><td></td><td>6,437</td><td>384.00</td></tr> <tr><td>2018</td><td>2018-0001707</td><td>WATSON, DANNY R. &</td><td>101</td><td>63,273</td><td></td><td>6,537</td><td>390.00</td></tr> <tr><td>2017</td><td>2017-0001707</td><td>WATSON, DANNY R. &</td><td>101</td><td>60,974</td><td></td><td>6,317</td><td>377.00</td></tr> <tr><td>2016</td><td>2016-0001707</td><td>WATSON, DANNY R. &</td><td>101</td><td>62,078</td><td></td><td>6,450</td><td>385.00</td></tr> <tr><td>2015</td><td>2015-0001707</td><td>WATSON, DANNY R. &</td><td>101</td><td>63,000</td><td></td><td>6,560</td><td>392.00</td></tr> <tr><td>2014</td><td>2014-0001707</td><td>WATSON, DANNY R. &</td><td>101</td><td>63,000</td><td></td><td>6,560</td><td>392.00</td></tr> <tr><td>2013</td><td>2013-0001707</td><td>WATSON, DANNY R. &</td><td>101</td><td>63,000</td><td></td><td>6,560</td><td>392.00</td></tr> </tbody> </table>										Tax Year	Statement Number	Billed Owner	Tax Area	Total Value	Exemptions	Taxable Value	Billed Tax	2025	2025-300001707	WATSON, DANNY R. &	101	66,652	1000	6,999	470.00	2024	2024-300001707	WATSON, DANNY R. &	101	72,757	1000	6,776	451.00	2023	2023-300001707	WATSON, DANNY R. &	101	73,750	1000	6,550	440.00	2022	2022-300001707	WATSON, DANNY R. &	101	61,081	1000	6,330	429.00	2021	2021-300001707	WATSON, DANNY R. &	101	61,081	1000	6,330	437.00	2020	2020-300001707	WATSON, DANNY R. &	101	61,081	1000	6,330	429.00	2019	2019-0001707	WATSON, DANNY R. &	101	61,977		6,437	384.00	2018	2018-0001707	WATSON, DANNY R. &	101	63,273		6,537	390.00	2017	2017-0001707	WATSON, DANNY R. &	101	60,974		6,317	377.00	2016	2016-0001707	WATSON, DANNY R. &	101	62,078		6,450	385.00	2015	2015-0001707	WATSON, DANNY R. &	101	63,000		6,560	392.00	2014	2014-0001707	WATSON, DANNY R. &	101	63,000		6,560	392.00	2013	2013-0001707	WATSON, DANNY R. &	101	63,000		6,560	392.00
Tax Year	Statement Number	Billed Owner	Tax Area	Total Value	Exemptions	Taxable Value	Billed Tax																																																																																																																		
2025	2025-300001707	WATSON, DANNY R. &	101	66,652	1000	6,999	470.00																																																																																																																		
2024	2024-300001707	WATSON, DANNY R. &	101	72,757	1000	6,776	451.00																																																																																																																		
2023	2023-300001707	WATSON, DANNY R. &	101	73,750	1000	6,550	440.00																																																																																																																		
2022	2022-300001707	WATSON, DANNY R. &	101	61,081	1000	6,330	429.00																																																																																																																		
2021	2021-300001707	WATSON, DANNY R. &	101	61,081	1000	6,330	437.00																																																																																																																		
2020	2020-300001707	WATSON, DANNY R. &	101	61,081	1000	6,330	429.00																																																																																																																		
2019	2019-0001707	WATSON, DANNY R. &	101	61,977		6,437	384.00																																																																																																																		
2018	2018-0001707	WATSON, DANNY R. &	101	63,273		6,537	390.00																																																																																																																		
2017	2017-0001707	WATSON, DANNY R. &	101	60,974		6,317	377.00																																																																																																																		
2016	2016-0001707	WATSON, DANNY R. &	101	62,078		6,450	385.00																																																																																																																		
2015	2015-0001707	WATSON, DANNY R. &	101	63,000		6,560	392.00																																																																																																																		
2014	2014-0001707	WATSON, DANNY R. &	101	63,000		6,560	392.00																																																																																																																		
2013	2013-0001707	WATSON, DANNY R. &	101	63,000		6,560	392.00																																																																																																																		



Harper

Assessment Property Record Card for Tax Year 2026

Data provided by SHAYLYN WEDER County Assessor

Date 02/06/2026
 Time 06:15:08
 Page 2

Lot Data	Acre - HomeSite and Tracts	Primary Image
Lot Size Lot Count Units Buildable Non-Ag Acres 0.42 Topography Street Access Utilities Amenities Method Acre Base Lot Value .42 x 5,952.38 = 2,500 Factor Value Adjustments Lot Value 2,500		<p>0000-21-26N-25W-1-009-00 ACCT # 1707 07/01/22</p>

Residential Data	
Type	1 Single Family Residence
Condition	3 - Average
Quality	3 - Average
Architecture	TRAD TRADITIONAL
Style	100% One Story
Exterior Wall	100% Frame, Siding, Vinyl
Base/Total Area	1,680 / 1,680
Style	100% One Story
HVAC	100% Warmed & Cooled Air
Roof Cover	4 Metal, Preformed
Area on Slab	0
Fixture/RghIn	8 /
Bed/F/H Bath	3 / 2.0 /
Basement Area	
Garage Type	440 Detached Garage - Finished
Remodel	ROOF -
Year/Eff Age	1956 / 70

House / Covered Porch	7/5/2022
-----------------------	----------

GRM Approach	
GRM Code	
Gross Rent	
Indicated Value	

Multiple Regression	
MRA Code	
Adjusted R	
Indicated Value	

Direct Comparables	
Selection Model	DEFAULT DEFAULT SELECTION MODEL
Adjustment Model	DEFAULT DEFAULT ADJUSTMENTS TABLE
Comparables	
Indicated Value	

Cost Approach		Manual :	
Base Cost	81.21	Total Misc Impr	+ 2,894
Roofing Adj	+ 4.53	Garage Cost	+ 18,487
Subfloor Adj	+ 0.00	Total RCN	= 193,312
Heat/Cool Adj	+ 10.77	Depreciation (70%)	- 135,318
Plumbing Adj	+ 5.83	Lump Sums	+ 0
Basement Adj	+ 0.00	RCNLD	= 57,994
Adj Base Cost	= 102.34	Lot Value	+ 2,500
Total Area	x 1,680	Indicated Value	= 60,494
Adjusted Cost	= 171,931	Value Per SqFt	36.01

Value Reconciliation			
Selected Approach	Cost Approach		
Improvements	57,994		
Lot Value	2,500		
Indicated Value	60,494	36.01	Per SqFt
Agland Value			
Site Improvements	4,401		
Total Value	64,895	38.63	Total Value Per SqFt

Miscellaneous Improvements								
Code	Description	Sketch ID	Size	Year	Units	Unit Cost	Depr	Value
RSPC	Raised Slab Porch - Covered	635	12x6		72	40.20		2,894



Harper

Assessment Property Record Card for Tax Year 2026

Data provided by SHAYLYN WEDER County Assessor

Date 02/06/2026
Time 06:15:08
Page 3

Sketch Image

300001707

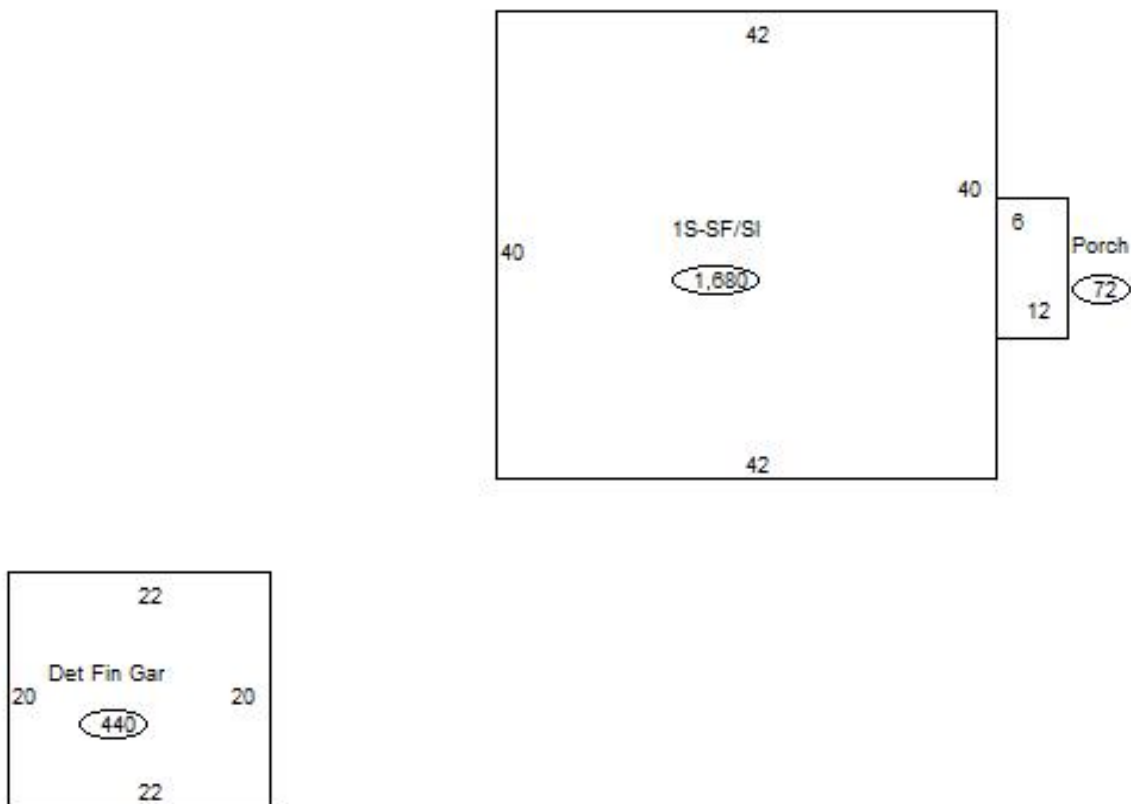

Sketch Vector Information

Sequence	Code	Type	Built Over	Scale	Section Label	Base Area	Multiplier	Total Area
1	R	1	Slab	20	1S-SF/Slab	1,680	1.000	1,680
2	M	RSPC		20	Porch	72	1.000	72
3	G	6		20	Det Fin Gar	440	1.000	440
Total Building Area						1,680		1,680



Harper

Assessment Property Record Card for Tax Year 2026

Data provided by SHAYLYN WEDER County Assessor

Date 02/06/2026
Time 06:15:08
Page 4

300001707

Outbuildings/Site Improvements

Building Image	Code	Description	Dimensions	Floor	Roofing	Total Units
	SHDS	Yard Shed - Wood	16x12x6		Formed Metal	192
	Qual	3	Cond 3	Year 2010	Eff Age 16	
	Valuation Summary		Modifier Total	RCN	Depr (52% Phys/ % Func)	RCNLD
	Base Cost (20.77 x 192)		3,988		3,988	2,074
	WODO	Wood Deck - Open	8x8x0			64
	Qual	3	Cond 3	Year 2010	Eff Age 16	
	Valuation Summary		Modifier Total	RCN	Depr (59% Phys/ % Func)	RCNLD
	Base Cost (24.63 x 64)		1,576		1,576	930
	PACN	Paving - Concrete / Driveway	75x18x0			1,350
	Qual	3	Cond 3	Year 2010	Eff Age 16	
	Valuation Summary		Modifier Total	RCN	Depr (80% Phys/ % Func)	RCNLD
	Base Cost (4.03 x 1,350)		5,441		5,441	4,353
	PACN	Paving - Concrete / Sidewalk by Deck	20x4x0			80
	Qual	3	Cond 3	Year 2010	Eff Age 16	
	Valuation Summary		Modifier Total	RCN	Depr (80% Phys/ % Func)	RCNLD
	Base Cost (7.35 x 80)		588		588	470
	CPDT	Carport - Detached	20x20x6		Formed Metal	400
	Qual	3	Cond 3	Year 1995	Eff Age 31	
	Valuation Summary		Modifier Total	RCN	Depr (80% Phys/ % Func)	RCNLD
	Base Cost (7.94 x 400)		3,176		3,176	2,541