



Harper

Assessment Property Record Card for Tax Year 2026

Data provided by SHAYLYN WEDER County Assessor

Date 02/06/2026
 Time 06:16:00
 Page 1

Assessment Data					Primary Image									
Account	300001769													
Parcel ID	0000-27-26N-25W-2-001-00													
Cadastral ID	0000-26N-25W-27-2-001-00													
Property Type	REAL - Real Property													
Property Class	RR	VI Area	4											
Tax Area	101 - 1R-LAVERNE													
Name ID	25604													
HUBBARD, JAMES WADE														
P O BOX 231 LAVERNE OK 73848-														
Parcel Location														
Situs	00659 S COUNTY LINE ROAD													
Subdivision														
Lot/Block	/	Parcel Size	1 - Acres											
Sec/Twn/Rng	27 / 26 / 25 / 2													
Neighborhood	1000 - COUNTY													
School District	1-LAVERN - 1-LAVERNE													
1 7/5/2022														
Legal Description Lat/Long: 36.72246036 -99.85051114														
SEC.27-26-25 TRACT IN NW4 BOOK 783 PAGE 419														
Building Permits														
<table border="1"> <thead> <tr> <th>Number</th> <th>Description</th> <th>Opened</th> <th>Closed</th> <th>Amount</th> </tr> </thead> <tbody> <tr> <td> </td> <td> </td> <td> </td> <td> </td> <td> </td> </tr> </tbody> </table>					Number	Description	Opened	Closed	Amount					
Number	Description	Opened	Closed	Amount										
Exemptions														
Sale History														
Code	Type	Active	Maximum	Exemption	Bk/Pg	Grantor	Date	Price	Code					
					783/419	MORRISON, RONALD D. AND	07/24/2024	85,000	Q					
					654/412	OLMSTEAD, PARKER R.	08/28/2009	60,000	Q					
Parcel Valuation														
Source	REAL	Fair Cash	Capped	Asmnt Level	Assessed	Levy Rate	67.190	Current Tax						
Remove Cap	2025	Land Value	5,000	5,000	12%	600	Assessed	10,200	685.34					
Year Frozen		Improvements	4,851	4,851		582	Penalty	0						
Uncapped Value	0	Mobile Home	75,149	75,149		9,018	Exemption	0	0.00					
TIF Project ID	0	Total Value	85,000	85,000		10,200	Total Taxable	10,200	685.00					
Assessment History														
Tax Year	Statement Number	Billed Owner	Tax Area	Total Value	Exemptions	Taxable Value	Billed Tax							
2025	2025-300001769	HUBBARD, JAMES WADE	101	85,000	0	10,200	685.00							
2024	2024-300001769	HUBBARD, JAMES	101	61,559	1000	5,265	350.00							
2023	2023-300001769	MORRISON, RONALD D. AND	101	54,332	1000	5,082	341.00							
2022	2022-300001769	MORRISON, RONALD D. AND	101	49,209	1000	4,905	332.00							
2021	2021-300001769	MORRISON, RONALD D. AND	101	49,209	1000	4,905	339.00							
2020	2020-300001769	MORRISON, RONALD D. AND	101	49,209	1000	4,905	332.00							
2019	2019-0001769	MORRISON, RONALD D. AND	101	51,788		5,214	311.00							
2018	2018-0001769	MORRISON, RONALD D. AND	101	52,919		5,350	319.00							
2017	2017-0001769	MORRISON, RONALD D. AND	101	53,150		5,378	321.00							
2016	2016-0001769	MORRISON, RONALD D. AND	101	63,125		6,575	392.00							
2015	2015-0001769	MORRISON, RONALD D. AND	101	65,587		6,868	410.00							
2014	2014-0001769	MORRISON, RONALD D. AND	101	68,222		6,639	396.00							
2013	2013-0001769	MORRISON, RONALD D. AND	101	71,752		6,416	383.00							



Harper

Assessment Property Record Card for Tax Year 2026

Data provided by SHAYLYN WEDER County Assessor

Date 02/06/2026
 Time 06:16:00
 Page 2

Lot Data	Acre - HomeSite and Tracts	Primary Image
Lot Size Lot Count Units Buildable Non-Ag Acres 1 Topography Street Access Utilities Amenities Method Acre Base Lot Value 1.00 x 5,000.00 = 5,000 Factor Value Adjustments Lot Value 5,000		<p>0000-27-26N-25W-2-001-00 ACCT # 1769 07/01/22</p>

Residential Data	
Type	6 Mobile Home 55 x 27
Condition	4 - Good
Quality	4 - Good
Architecture	
Style	100% Double Wide
Exterior Wall	75% Aluminum Lap 25% Veneer, Masonry
Base/Total Area	1,474 / 1,474
Style	100% Double Wide
HVAC	100% Warmed & Cooled Air
Roof Cover	1 Composition Shingle
Area on Slab	0
Fixture/RghIn	8 /
Bed/F/H Bath	3 / 2.0 /
Basement Area	
Garage Type	
Remodel	PARTIAL -
Year/Eff Age	1999 / 14



Cost Approach		Manual :	
Base Cost	58.05	Total Misc Impr	+ 10,085
Roofing Adj	+ 3.14	Garage Cost	+
Subfloor Adj	+ 0.00	Total RCN	= 118,056
Heat/Cool Adj	+ 3.48	Depreciation (33%)	- 38,958
Plumbing Adj	+ 8.58	Lump Sums	+ 0
Basement Adj	+ 0.00	RCNLD	= 79,098
Adj Base Cost	= 73.25	Lot Value	+ 5,000
Total Area	x 1,474	Indicated Value	= 84,098
Adjusted Cost	= 107,971	Value Per SqFt	57.05

GRM Approach
GRM Code
Gross Rent
Indicated Value

Multiple Regression
MRA Code
Adusted R
Indicated Value

Direct Comparables
Selection Model DEFAULT DEFAULT SELECTION MODEL
Adjustment Model DEFAULT DEFAULT ADJUSTMENTS TABLE
Comparables
Indicated Value

Value Reconciliation
Selected Approach Cost Approach
Improvements 79,098
Lot Value 5,000
Indicated Value 84,098 57.05 Per SqFt
Agland Value
Site Improvements 182
Total Value 84,280 57.18 Total Value Per SqFt

Miscellaneous Improvements								
Code	Description	Sketch ID	Size	Year	Units	Unit Cost	Depr	Value
WODO	Wood Deck - Open	723	60	2010	60	31.08		1,865
RSPC	Raised Slab Porch - Covered	724	273	1999	273	30.11		8,220



Harper

Assessment Property Record Card for Tax Year 2026

Data provided by SHAYLYN WEDER County Assessor

Date 02/06/2026
 Time 06:16:00
 Page 3

Sketch Image

300001769

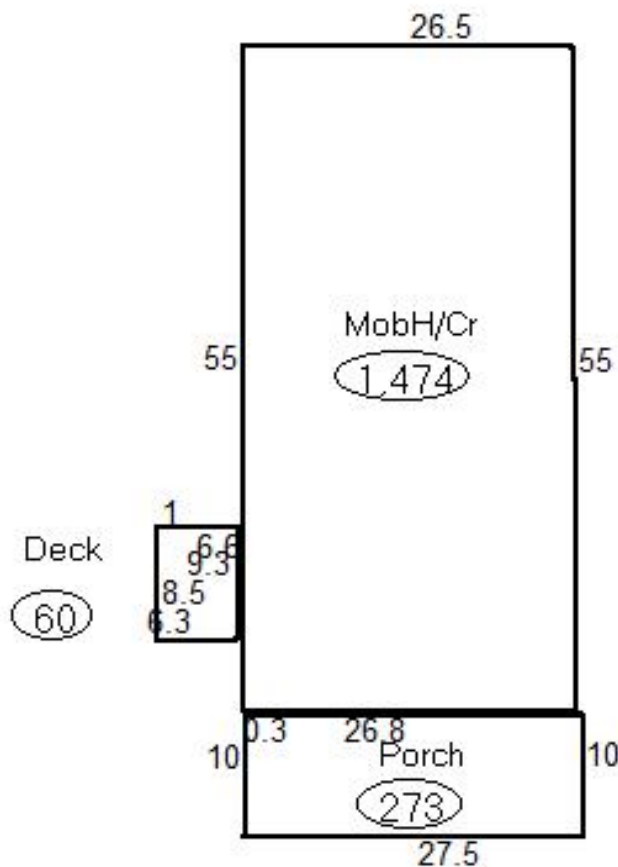

Sketch Vector Information

Sequence	Code	Type	Built Over	Scale	Section Label	Base Area	Multiplier	Total Area
1	M	WODO		20	Deck	60	1.000	60
2	M	RSPC		20	Porch	273	1.000	273
3	R	14	Crawl	20	MobH/Cr	1,474	1.000	1,474
Total Building Area						1,474		1,474



Harper

Assessment Property Record Card for Tax Year 2026

Data provided by SHAYLYN WEDER County Assessor

Date 02/06/2026
 Time 06:16:00
 Page 4

300001769

Outbuildings/Site Improvements

Building Image	Code	Description	Dimensions	Floor	Roofing	Total Units		
	PACN	Paving - Concrete	0x0x0			140		
	Qual	3	Cond	3	Year	2000	Eff Age	26
						0		
						0		
						0		
Valuation Summary				Modifier Total	RCN	Depr (80% Phys/ % Func)	RCNLD	
Base Cost (6.49 x 140)		909			909	727	182	