



Harper

Assessment Property Record Card for Tax Year 2026

Data provided by SHAYLYN WEDER County Assessor

Date 02/06/2026
 Time 06:16:44
 Page 1

Assessment Data					Primary Image																																																																																																																				
Account 300001824 Parcel ID 0000-28-26N-25W-2-011-00 Cadastral ID 0000-26N-25W-28-2-011-00 Property Type REAL - Real Property Property Class E VI Area 4 Tax Area 101 - 1R-LAVERNE Name ID 16517 HARPER COUNTY DEVELOPMENT AUTH P O BOX 1127 LAVERNE OK 73848-0000 Parcel Location Situs SW SECOND ST Subdivision Lot/Block / Parcel Size 7.747 - Acres Sec/Twn/Rng 28 / 26 / 25 / 2 Neighborhood 1000 - COUNTY School District 1-LAVERN - 1-LAVERNE					<p>0000-28-26N-25W-2-011-00 09/17/2018</p> <p>f:\pictures\0000-28-26N-25W-2-011-00-001-000-003.jpg 9/21/2018</p>																																																																																																																				
Legal Description Lat/Long: 36.70490803 -99.89462465 SEC. 28-26-25 7.747 ACRE TRACT IN NW4																																																																																																																									
Exemptions <table border="1"> <thead> <tr> <th>Code</th> <th>Type</th> <th>Active</th> <th>Maximum</th> <th>Exemption</th> </tr> </thead> <tbody> <tr> <td></td> <td></td> <td></td> <td></td> <td></td> </tr> </tbody> </table>					Code	Type	Active	Maximum	Exemption						Building Permits <table border="1"> <thead> <tr> <th>Number</th> <th>Description</th> <th>Opened</th> <th>Closed</th> <th>Amount</th> </tr> </thead> <tbody> <tr> <td></td> <td></td> <td></td> <td></td> <td></td> </tr> </tbody> </table>					Number	Description	Opened	Closed	Amount																																																																																																	
Code	Type	Active	Maximum	Exemption																																																																																																																					
Number	Description	Opened	Closed	Amount																																																																																																																					
Parcel Valuation <table border="1"> <thead> <tr> <th>Source</th> <th>REAL</th> <th>Fair Cash</th> <th>Capped</th> <th>Asmnt Level</th> <th>Assessed</th> <th>Levy Rate</th> <th>67.190</th> <th>Current Tax</th> </tr> </thead> <tbody> <tr> <td>Remove Cap</td> <td></td> <td>Land Value 38,900</td> <td>0</td> <td>12%</td> <td>0</td> <td>Assessed</td> <td>0</td> <td>0.00</td> </tr> <tr> <td>Year Frozen</td> <td></td> <td>Improvements 2,157,939</td> <td>0</td> <td></td> <td>0</td> <td>Penalty</td> <td>0</td> <td></td> </tr> <tr> <td>Uncapped Value</td> <td>0</td> <td>Mobile Home 0</td> <td>0</td> <td></td> <td>0</td> <td>Exemption</td> <td>0</td> <td>0.00</td> </tr> <tr> <td>TIF Project ID</td> <td>0</td> <td>Total Value 2,196,839</td> <td>0</td> <td></td> <td>0</td> <td>Total Taxable</td> <td>0</td> <td>0.00</td> </tr> </tbody> </table>					Source	REAL	Fair Cash	Capped	Asmnt Level	Assessed	Levy Rate	67.190	Current Tax	Remove Cap		Land Value 38,900	0	12%	0	Assessed	0	0.00	Year Frozen		Improvements 2,157,939	0		0	Penalty	0		Uncapped Value	0	Mobile Home 0	0		0	Exemption	0	0.00	TIF Project ID	0	Total Value 2,196,839	0		0	Total Taxable	0	0.00	Sale History <table border="1"> <thead> <tr> <th>Bk/Pg</th> <th>Grantor</th> <th>Date</th> <th>Price</th> <th>Code</th> </tr> </thead> <tbody> <tr> <td>593/56</td> <td>HARPER CO. DEVELOPMENT AU</td> <td>05/11/2004</td> <td>25,000</td> <td>Q</td> </tr> </tbody> </table>					Bk/Pg	Grantor	Date	Price	Code	593/56	HARPER CO. DEVELOPMENT AU	05/11/2004	25,000	Q																																																									
Source	REAL	Fair Cash	Capped	Asmnt Level	Assessed	Levy Rate	67.190	Current Tax																																																																																																																	
Remove Cap		Land Value 38,900	0	12%	0	Assessed	0	0.00																																																																																																																	
Year Frozen		Improvements 2,157,939	0		0	Penalty	0																																																																																																																		
Uncapped Value	0	Mobile Home 0	0		0	Exemption	0	0.00																																																																																																																	
TIF Project ID	0	Total Value 2,196,839	0		0	Total Taxable	0	0.00																																																																																																																	
Bk/Pg	Grantor	Date	Price	Code																																																																																																																					
593/56	HARPER CO. DEVELOPMENT AU	05/11/2004	25,000	Q																																																																																																																					
Assessment History <table border="1"> <thead> <tr> <th>Tax Year</th> <th>Statement Number</th> <th>Billed Owner</th> <th>Tax Area</th> <th>Total Value</th> <th>Exemptions</th> <th>Taxable Value</th> <th>Billed Tax</th> </tr> </thead> <tbody> <tr><td>2025</td><td>2025-300001824</td><td>HARPER COUNTY DEVELOPMENT AUTH</td><td>101</td><td>2,196,839</td><td>0</td><td></td><td>.00</td></tr> <tr><td>2024</td><td>2024-300001824</td><td>HARPER COUNTY DEVELOPMENT AUTH</td><td>101</td><td>2,228,243</td><td>0</td><td></td><td>.00</td></tr> <tr><td>2023</td><td>2023-300001824</td><td>HARPER COUNTY DEVELOPMENT AUTH</td><td>101</td><td>1,923,325</td><td>0</td><td></td><td>.00</td></tr> <tr><td>2022</td><td>2022-300001824</td><td>HARPER COUNTY DEVELOPMENT AUTH</td><td>101</td><td>2,061,904</td><td>0</td><td></td><td>.00</td></tr> <tr><td>2021</td><td>2021-300001824</td><td>HARPER COUNTY DEVELOPMENT AUT</td><td>101</td><td>2,061,904</td><td>0</td><td></td><td>.00</td></tr> <tr><td>2020</td><td>2020-300001824</td><td>HARPER COUNTY DEVELOPMENT AUT</td><td>101</td><td>2,061,904</td><td>0</td><td></td><td>.00</td></tr> <tr><td>2019</td><td>2019-0001824</td><td>HARPER COUNTY DEVELOPMENT AUT</td><td>101</td><td>2,061,904</td><td></td><td></td><td>.00</td></tr> <tr><td>2018</td><td>2018-0001824</td><td>HARPER COUNTY DEVELOPMENT AUT</td><td>101</td><td>2,272,568</td><td></td><td></td><td>.00</td></tr> <tr><td>2017</td><td>2017-0001824</td><td>HARPER COUNTY DEVELOPMENT AUT</td><td>101</td><td>1,912,737</td><td></td><td></td><td>.00</td></tr> <tr><td>2016</td><td>2016-0001824</td><td>HARPER COUNTY DEVELOPMENT AUT</td><td>101</td><td></td><td></td><td></td><td>.00</td></tr> <tr><td>2015</td><td>2015-0001824</td><td>HARPER COUNTY DEVELOPMENT AUT</td><td>101</td><td></td><td></td><td></td><td>.00</td></tr> <tr><td>2014</td><td>2014-0001824</td><td>HARPER COUNTY DEVELOPMENT AUT</td><td>101</td><td></td><td></td><td></td><td>.00</td></tr> <tr><td>2013</td><td>2013-0001824</td><td>HARPER COUNTY DEVELOPMENT AUT</td><td>101</td><td></td><td></td><td></td><td>.00</td></tr> </tbody> </table>										Tax Year	Statement Number	Billed Owner	Tax Area	Total Value	Exemptions	Taxable Value	Billed Tax	2025	2025-300001824	HARPER COUNTY DEVELOPMENT AUTH	101	2,196,839	0		.00	2024	2024-300001824	HARPER COUNTY DEVELOPMENT AUTH	101	2,228,243	0		.00	2023	2023-300001824	HARPER COUNTY DEVELOPMENT AUTH	101	1,923,325	0		.00	2022	2022-300001824	HARPER COUNTY DEVELOPMENT AUTH	101	2,061,904	0		.00	2021	2021-300001824	HARPER COUNTY DEVELOPMENT AUT	101	2,061,904	0		.00	2020	2020-300001824	HARPER COUNTY DEVELOPMENT AUT	101	2,061,904	0		.00	2019	2019-0001824	HARPER COUNTY DEVELOPMENT AUT	101	2,061,904			.00	2018	2018-0001824	HARPER COUNTY DEVELOPMENT AUT	101	2,272,568			.00	2017	2017-0001824	HARPER COUNTY DEVELOPMENT AUT	101	1,912,737			.00	2016	2016-0001824	HARPER COUNTY DEVELOPMENT AUT	101				.00	2015	2015-0001824	HARPER COUNTY DEVELOPMENT AUT	101				.00	2014	2014-0001824	HARPER COUNTY DEVELOPMENT AUT	101				.00	2013	2013-0001824	HARPER COUNTY DEVELOPMENT AUT	101				.00
Tax Year	Statement Number	Billed Owner	Tax Area	Total Value	Exemptions	Taxable Value	Billed Tax																																																																																																																		
2025	2025-300001824	HARPER COUNTY DEVELOPMENT AUTH	101	2,196,839	0		.00																																																																																																																		
2024	2024-300001824	HARPER COUNTY DEVELOPMENT AUTH	101	2,228,243	0		.00																																																																																																																		
2023	2023-300001824	HARPER COUNTY DEVELOPMENT AUTH	101	1,923,325	0		.00																																																																																																																		
2022	2022-300001824	HARPER COUNTY DEVELOPMENT AUTH	101	2,061,904	0		.00																																																																																																																		
2021	2021-300001824	HARPER COUNTY DEVELOPMENT AUT	101	2,061,904	0		.00																																																																																																																		
2020	2020-300001824	HARPER COUNTY DEVELOPMENT AUT	101	2,061,904	0		.00																																																																																																																		
2019	2019-0001824	HARPER COUNTY DEVELOPMENT AUT	101	2,061,904			.00																																																																																																																		
2018	2018-0001824	HARPER COUNTY DEVELOPMENT AUT	101	2,272,568			.00																																																																																																																		
2017	2017-0001824	HARPER COUNTY DEVELOPMENT AUT	101	1,912,737			.00																																																																																																																		
2016	2016-0001824	HARPER COUNTY DEVELOPMENT AUT	101				.00																																																																																																																		
2015	2015-0001824	HARPER COUNTY DEVELOPMENT AUT	101				.00																																																																																																																		
2014	2014-0001824	HARPER COUNTY DEVELOPMENT AUT	101				.00																																																																																																																		
2013	2013-0001824	HARPER COUNTY DEVELOPMENT AUT	101				.00																																																																																																																		



Harper

Assessment Property Record Card for Tax Year 2026

Data provided by SHAYLYN WEDER County Assessor

Date 02/06/2026
 Time 06:16:44
 Page 2

Lot Data	Primary Image
<p>Lot Size x</p> <p>Lot Count</p> <p>Units Buildable</p> <p>Non-Ag Acres 7.78</p> <p>Topography</p> <p>Street Access</p> <p>Utilities</p> <p>Amenities</p> <p>Value Model 181 RURAL COMMERCIAL</p> <p>Value Method Acre</p> <p>Base Lot Value 7.78 x 5,000.00 = 38,900</p> <p>Factor Value 0</p> <p>Adjustments</p> <p>Lot Value 38,900</p>	
<p>Cost Approach</p>	
<p>Manual Date 07/2025</p> <p>Total Building Area 22,950</p> <p>Total Base Value 2,503,845</p> <p>Modifier Value</p> <p>Misc Improvements</p> <p>Replacement Cost New 2,503,845</p> <p>Phys/Func Depreciation Loss ()</p> <p>RCN Less Phys/Func 2,203,384</p> <p>Economic Depreciation</p> <p>RCNLD (All Sources) 2,203,384</p> <p>Depreciated Improvements</p> <p>Outbuilding Value 31,414</p> <p>Total Improvement Value 2,234,798</p> <p>Land Value 38,900</p> <p>Cost Approach Value 2,273,698 99.07/SqFt</p>	<p>Image Information</p> <p>Image ID 1058</p> <p>Image Date 9/21/2018</p> <p>Name 0000-28-26N-25W-2-011-00-001-000-003.jpg</p> <p>Description f:\pictures\0000-28-26N-25W-2-011-00-001-000-003.jpg</p>
<p>Income Approach</p>	<p>Value Reconciliation</p>
<p>Potential Gross Income (PGI)</p> <p>Vacancy & Collection Loss</p> <p>Miscellaneous Income</p> <p>Effective Gross Income (EGI)</p> <p>Total Expenses</p> <p>Net Operating Income (NOI)</p> <p>Income Capitalization Rate</p> <p>Indicated Value 0.00</p>	<p>Selected Valuation Method Cost Approach</p> <p>Total Improvement Value 31,414</p> <p>Land Value 38,900</p> <p>Total Appraised Value 2,273,698 99.07/SqFt</p>



Harper

Assessment Property Record Card for Tax Year 2026

Data provided by SHAYLYN WEDER County Assessor

Date 02/06/2026

Time 06:16:44

Page 3

Sketch Image

300001824

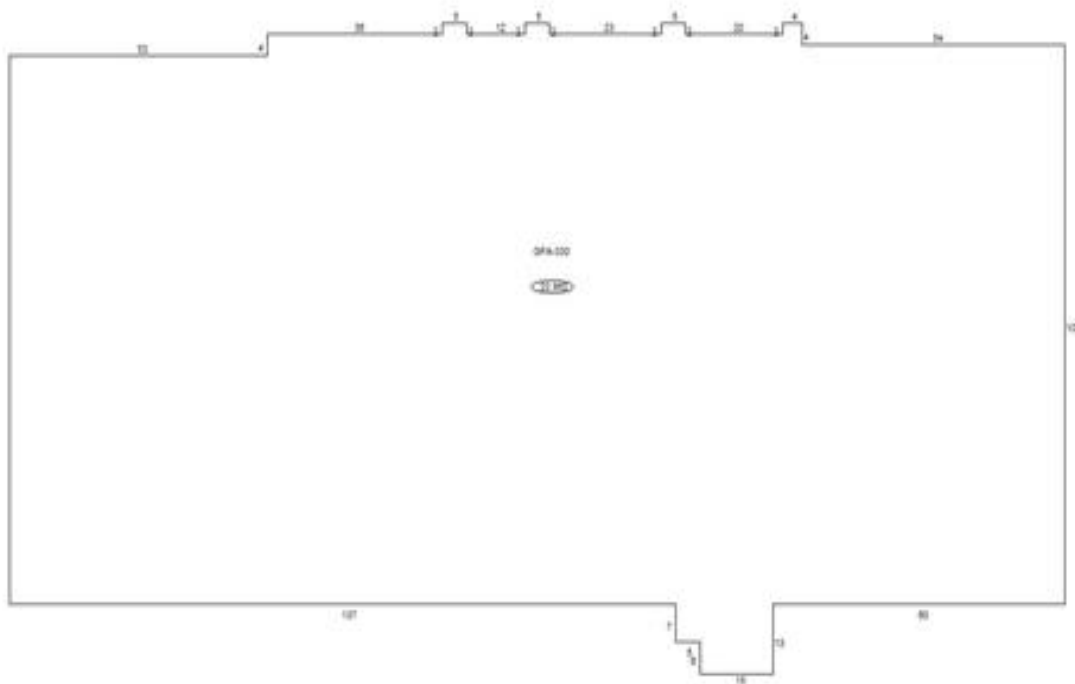

Sketch Vector Information

Sequence	Code	Type	Built Over	Scale	Section Label	Base Area	Multiplier	Total Area
1	C	330		20	GFA-330	22,950	1.000	22,950
2	O	CPDT		20	CPDT	240	1.000	240
3	O	CPDT		50	CPDT	240	1.000	240
4	O	SHDS		50	YHWD	396	1.000	396
Total Building Area						22,950		22,950



Harper

Assessment Property Record Card for Tax Year 2026

Data provided by SHAYLYN WEDER County Assessor

Date 02/06/2026
 Time 06:16:44
 Page 4

Account	300001824	Tax Area Code	101
Parcel ID	0000-28-26N-25W-2-011-00	Property Class	E
Cadastral ID	0000-26N-25W-28-2-011-00	Owners Name	HARPER COUNTY DEVELOPMENT AUTH

Building Data	Building Image
---------------	----------------

Building ID	10
Building Sequence	1
Occupancy 1	330 Home For The Elderly 100%
Occupancy 2	
Occupancy 3	
Total Floor Area	22,950
Average Perimeter	688
Number Of Storys	1.00
Average Wall Ht	8.00
Year Built	2014
Effective Age	12
Construction Class	6 - Engineered Wood Post Frame (Pole)
Quality	3.5 - Average
Condition	3 - Average
Exterior Wall	110 - Single Wall-Boards on Wood
Heating/Cooling	8 - Warmed and Cooled Air
Roof Type	Gable
Roof Cover	Composition
Basement Area	
Basement Levels	
Basement Finish	
Finish Code - 1	
Finish Area - 1	
Finish Code - 2	
Finish Area - 2	

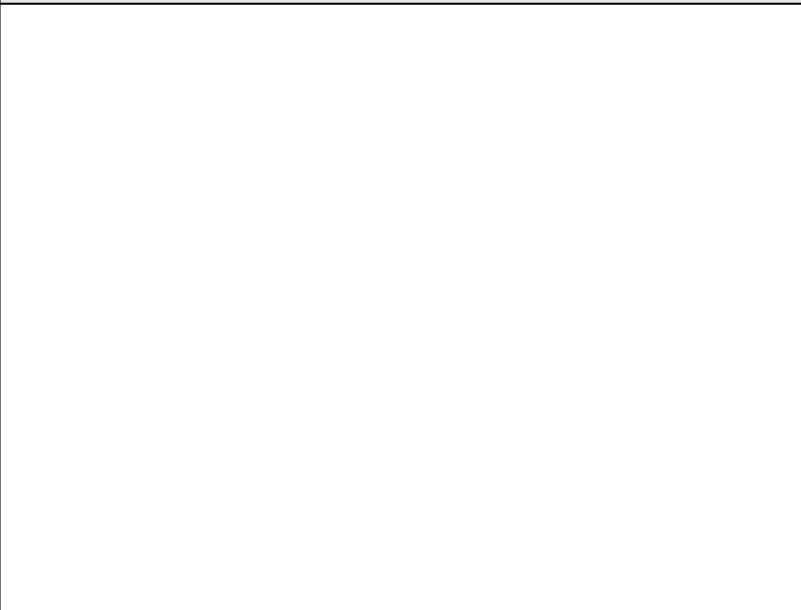

Image Information

Image Name	
Image Date	
Image Name	
Description	

Cost Calculations	
-------------------	--

Appraisal Zone	4
Zone Description	VI AREA 4
Base Cost	88.77
Wall Cost	5.68
HVAC Cost	14.65
Basement Cost	0.00
Total Base Cost	109.10
Total Area	22,950
Base RCN	2,503,845
Misc Impr Value	

Manual Date	
Base Year	2026
Modifier Value	
Total Replacement Cost	2,503,845
Physical Depreciation	12%
Functional Depreciation	
Total Depreciation	12% (300,461)
Total RCNLD	2,203,384
Lump Sums	
Total Building Value	2,203,384 \$ 96.01 Per SqFt

Building Modifiers					
--------------------	--	--	--	--	--

Code	Description	Units - 1	Units - 2	Units - 3	Modifier Value
5	Brick Veneer	Percent	50%		

Total Modifier Value



Harper

Assessment Property Record Card for Tax Year 2026

Data provided by SHAYLYN WEDER County Assessor

Date 02/06/2026

Time 06:16:44

Page 5

300001824

Outbuildings/Site Improvements

Building Image	Code	Description	Dimensions	Floor	Roofing	Total Units
	CPDT	Carport - Detached	20x12x8		Formed Metal	240
	Qual	3	Cond 3	Year 2020	Eff Age 6	
	Valuation Summary Base Cost (7.94 x 240)		Modifier Total	RCN	Depr (% Phys/ % Func)	RCNLD
				1,906	705	1,201
	CPDT	Carport - Detached	20x12x8		Formed Metal	240
	Qual	3	Cond 3	Year 2020	Eff Age 6	
	Valuation Summary Base Cost (7.94 x 240)		Modifier Total	RCN	Depr (% Phys/ % Func)	RCNLD
				1,906	705	1,201
	SHDS	Yard Shed - Wood	22x18x8		Composition Shingle	396
	Qual	3	Cond 3	Year 2020	Eff Age 6	
	Valuation Summary Base Cost (17.86 x 396)		Modifier Total	RCN	Depr (% Phys/ % Func)	RCNLD
				7,073	1,980	5,093
	PACN	Paving - Concrete DRIVEWAY	0x0x0			16,800
	Qual	3	Cond 3	Year 2014	Eff Age 12	
	Valuation Summary Base Cost (3.77 x 16,800)		Modifier Total	RCN	Depr (% Phys/ % Func)	RCNLD
				63,336	43,702	19,634
	PACN	Paving - Concrete SIDEWALK	0x0x0			3,666
	Qual	3	Cond 3	Year 2014	Eff Age 12	
	Valuation Summary Base Cost (3.77 x 3,666)		Modifier Total	RCN	Depr (% Phys/ % Func)	RCNLD
				13,821	9,536	4,285
Total Site Improvement Value						31,414