



Harper

Assessment Property Record Card for Tax Year 2026

Data provided by SHAYLYN WEDER County Assessor

Date 02/06/2026
 Time 06:30:03
 Page 1

Assessment Data					Primary Image																																																																																																																				
Account 300002777 Parcel ID 0000-32-27N-24W-2-001-00 Cadastral ID 0000-27N-24W-32-2-001-00 Property Type REAL - Real Property Property Class RR VI Area 4 Tax Area 101 - 1R-LAVERNE Name ID 25005 BENTLEY, COLE AND TONYA BENTLEY 1642 N 180 RD ROSSTON OK 73855- Parcel Location Situs 01642 180 RD N Subdivision Lot/Block / Parcel Size 10 - Acres Sec/Twn/Rng 32 / 27 / 24 / 2 Neighborhood 1000 - COUNTY School District 1-LAVERNE - 1-LAVERNE																																																																																																																									
Legal Description Lat/Long: 36.74368214 -99.65186167 SEC. 32-27-24 10 ACRE TRACT IN SW4SW4NW4 AND IN NW4NW4SW4 BOOK 777 PAGE 23																																																																																																																									
Exemptions <table border="1"> <thead> <tr> <th>Code</th> <th>Type</th> <th>Active</th> <th>Maximum</th> <th>Exemption</th> </tr> </thead> <tbody> <tr> <td>H</td> <td>Homestead</td> <td>Yes</td> <td>1,000</td> <td>1,000</td> </tr> </tbody> </table>					Code	Type	Active	Maximum	Exemption	H	Homestead	Yes	1,000	1,000	Building Permits <table border="1"> <thead> <tr> <th>Number</th> <th>Description</th> <th>Opened</th> <th>Closed</th> <th>Amount</th> </tr> </thead> <tbody> <tr> <td></td> <td></td> <td></td> <td></td> <td></td> </tr> </tbody> </table>					Number	Description	Opened	Closed	Amount																																																																																																	
Code	Type	Active	Maximum	Exemption																																																																																																																					
H	Homestead	Yes	1,000	1,000																																																																																																																					
Number	Description	Opened	Closed	Amount																																																																																																																					
Parcel Valuation <table border="1"> <thead> <tr> <th>Source</th> <th>REAL</th> <th>Fair Cash</th> <th>Capped</th> <th>Asmnt Level</th> <th>Assessed</th> <th>Levy Rate</th> <th>67.190</th> <th>Current Tax</th> </tr> </thead> <tbody> <tr> <td>Remove Cap</td> <td>2024</td> <td>Land Value 11,750</td> <td>11,750</td> <td>12%</td> <td>1,410</td> <td>Assessed</td> <td>17,059</td> <td>1,146.19</td> </tr> <tr> <td>Year Frozen</td> <td></td> <td>Improvements 130,408</td> <td>130,408</td> <td></td> <td>15,649</td> <td>Penalty</td> <td>0</td> <td></td> </tr> <tr> <td>Uncapped Value</td> <td>0</td> <td>Mobile Home 0</td> <td>0</td> <td></td> <td>0</td> <td>Exemption</td> <td>1,000</td> <td>-67.00</td> </tr> <tr> <td>TIF Project ID</td> <td>0</td> <td>Total Value 142,158</td> <td>142,158</td> <td></td> <td>17,059</td> <td>Total Taxable</td> <td>16,059</td> <td>1,079.00</td> </tr> </tbody> </table>					Source	REAL	Fair Cash	Capped	Asmnt Level	Assessed	Levy Rate	67.190	Current Tax	Remove Cap	2024	Land Value 11,750	11,750	12%	1,410	Assessed	17,059	1,146.19	Year Frozen		Improvements 130,408	130,408		15,649	Penalty	0		Uncapped Value	0	Mobile Home 0	0		0	Exemption	1,000	-67.00	TIF Project ID	0	Total Value 142,158	142,158		17,059	Total Taxable	16,059	1,079.00	Sale History <table border="1"> <thead> <tr> <th>Bk/Pg</th> <th>Grantor</th> <th>Date</th> <th>Price</th> <th>Code</th> </tr> </thead> <tbody> <tr> <td>777/23</td> <td>LEIKAM, LEONARD J. &</td> <td>08/02/2023</td> <td>165,000</td> <td>18</td> </tr> <tr> <td>697/324</td> <td>BARBY, BEN RUSSELL</td> <td>04/17/2014</td> <td>85,000</td> <td>21</td> </tr> <tr> <td>566/503</td> <td>ANSEL, PATRICK STEVEN ET</td> <td>08/14/2001</td> <td>65,000</td> <td>PQ</td> </tr> <tr> <td>508/33</td> <td>DUNSWORTH, BARRY W, ETUX</td> <td>07/22/1995</td> <td>50,000</td> <td>PQ</td> </tr> </tbody> </table>					Bk/Pg	Grantor	Date	Price	Code	777/23	LEIKAM, LEONARD J. &	08/02/2023	165,000	18	697/324	BARBY, BEN RUSSELL	04/17/2014	85,000	21	566/503	ANSEL, PATRICK STEVEN ET	08/14/2001	65,000	PQ	508/33	DUNSWORTH, BARRY W, ETUX	07/22/1995	50,000	PQ																																										
Source	REAL	Fair Cash	Capped	Asmnt Level	Assessed	Levy Rate	67.190	Current Tax																																																																																																																	
Remove Cap	2024	Land Value 11,750	11,750	12%	1,410	Assessed	17,059	1,146.19																																																																																																																	
Year Frozen		Improvements 130,408	130,408		15,649	Penalty	0																																																																																																																		
Uncapped Value	0	Mobile Home 0	0		0	Exemption	1,000	-67.00																																																																																																																	
TIF Project ID	0	Total Value 142,158	142,158		17,059	Total Taxable	16,059	1,079.00																																																																																																																	
Bk/Pg	Grantor	Date	Price	Code																																																																																																																					
777/23	LEIKAM, LEONARD J. &	08/02/2023	165,000	18																																																																																																																					
697/324	BARBY, BEN RUSSELL	04/17/2014	85,000	21																																																																																																																					
566/503	ANSEL, PATRICK STEVEN ET	08/14/2001	65,000	PQ																																																																																																																					
508/33	DUNSWORTH, BARRY W, ETUX	07/22/1995	50,000	PQ																																																																																																																					
Assessment History <table border="1"> <thead> <tr> <th>Tax Year</th> <th>Statement Number</th> <th>Billed Owner</th> <th>Tax Area</th> <th>Total Value</th> <th>Exemptions</th> <th>Taxable Value</th> <th>Billed Tax</th> </tr> </thead> <tbody> <tr><td>2025</td><td>2025-300002777</td><td>BENTLEY, COLE AND</td><td>101</td><td>142,158</td><td>1000</td><td>16,059</td><td>1,079.00</td></tr> <tr><td>2024</td><td>2024-300002777</td><td>BENTLEY, COLE AND</td><td>101</td><td>147,673</td><td>1000</td><td>16,721</td><td>1,112.00</td></tr> <tr><td>2023</td><td>2023-300002777</td><td>BENTLEY, COLE AND</td><td>101</td><td>135,613</td><td>0</td><td>14,332</td><td>963.00</td></tr> <tr><td>2022</td><td>2022-300002777</td><td>LEIKAM, LEONARD J. &</td><td>101</td><td>113,746</td><td>0</td><td>13,650</td><td>924.00</td></tr> <tr><td>2021</td><td>2021-300002777</td><td>LEIKAM, LEONARD J. &</td><td>101</td><td>113,746</td><td>0</td><td>13,650</td><td>942.00</td></tr> <tr><td>2020</td><td>2020-300002777</td><td>LEIKAM, LEONARD J. &</td><td>101</td><td>113,746</td><td>0</td><td>13,650</td><td>925.00</td></tr> <tr><td>2019</td><td>2019-0002777</td><td>LEIKAM, LEONARD J. &</td><td>101</td><td>116,434</td><td></td><td>13,972</td><td>834.00</td></tr> <tr><td>2018</td><td>2018-0002777</td><td>LEIKAM, LEONARD J. &</td><td>101</td><td>118,480</td><td></td><td>14,218</td><td>849.00</td></tr> <tr><td>2017</td><td>2017-0002777</td><td>LEIKAM, LEONARD J. &</td><td>101</td><td>114,036</td><td></td><td>13,685</td><td>817.00</td></tr> <tr><td>2016</td><td>2016-0002777</td><td>LEIKAM, LEONARD J. &</td><td>101</td><td>116,516</td><td></td><td>13,982</td><td>834.00</td></tr> <tr><td>2015</td><td>2015-0002777</td><td>LEIKAM, LEONARD J. &</td><td>101</td><td>85,000</td><td></td><td>10,200</td><td>609.00</td></tr> <tr><td>2014</td><td>2014-0002777</td><td>LEIKAM, LEONARD J. &</td><td>101</td><td>38,447</td><td></td><td>3,613</td><td>216.00</td></tr> <tr><td>2013</td><td>2013-0002777</td><td>BARBY, BEN RUSSELL</td><td>101</td><td>86,490</td><td></td><td>7,407</td><td>442.00</td></tr> </tbody> </table>										Tax Year	Statement Number	Billed Owner	Tax Area	Total Value	Exemptions	Taxable Value	Billed Tax	2025	2025-300002777	BENTLEY, COLE AND	101	142,158	1000	16,059	1,079.00	2024	2024-300002777	BENTLEY, COLE AND	101	147,673	1000	16,721	1,112.00	2023	2023-300002777	BENTLEY, COLE AND	101	135,613	0	14,332	963.00	2022	2022-300002777	LEIKAM, LEONARD J. &	101	113,746	0	13,650	924.00	2021	2021-300002777	LEIKAM, LEONARD J. &	101	113,746	0	13,650	942.00	2020	2020-300002777	LEIKAM, LEONARD J. &	101	113,746	0	13,650	925.00	2019	2019-0002777	LEIKAM, LEONARD J. &	101	116,434		13,972	834.00	2018	2018-0002777	LEIKAM, LEONARD J. &	101	118,480		14,218	849.00	2017	2017-0002777	LEIKAM, LEONARD J. &	101	114,036		13,685	817.00	2016	2016-0002777	LEIKAM, LEONARD J. &	101	116,516		13,982	834.00	2015	2015-0002777	LEIKAM, LEONARD J. &	101	85,000		10,200	609.00	2014	2014-0002777	LEIKAM, LEONARD J. &	101	38,447		3,613	216.00	2013	2013-0002777	BARBY, BEN RUSSELL	101	86,490		7,407	442.00
Tax Year	Statement Number	Billed Owner	Tax Area	Total Value	Exemptions	Taxable Value	Billed Tax																																																																																																																		
2025	2025-300002777	BENTLEY, COLE AND	101	142,158	1000	16,059	1,079.00																																																																																																																		
2024	2024-300002777	BENTLEY, COLE AND	101	147,673	1000	16,721	1,112.00																																																																																																																		
2023	2023-300002777	BENTLEY, COLE AND	101	135,613	0	14,332	963.00																																																																																																																		
2022	2022-300002777	LEIKAM, LEONARD J. &	101	113,746	0	13,650	924.00																																																																																																																		
2021	2021-300002777	LEIKAM, LEONARD J. &	101	113,746	0	13,650	942.00																																																																																																																		
2020	2020-300002777	LEIKAM, LEONARD J. &	101	113,746	0	13,650	925.00																																																																																																																		
2019	2019-0002777	LEIKAM, LEONARD J. &	101	116,434		13,972	834.00																																																																																																																		
2018	2018-0002777	LEIKAM, LEONARD J. &	101	118,480		14,218	849.00																																																																																																																		
2017	2017-0002777	LEIKAM, LEONARD J. &	101	114,036		13,685	817.00																																																																																																																		
2016	2016-0002777	LEIKAM, LEONARD J. &	101	116,516		13,982	834.00																																																																																																																		
2015	2015-0002777	LEIKAM, LEONARD J. &	101	85,000		10,200	609.00																																																																																																																		
2014	2014-0002777	LEIKAM, LEONARD J. &	101	38,447		3,613	216.00																																																																																																																		
2013	2013-0002777	BARBY, BEN RUSSELL	101	86,490		7,407	442.00																																																																																																																		



Harper

Assessment Property Record Card for Tax Year 2026

Data provided by SHAYLYN WEDER County Assessor

Date 02/06/2026
 Time 06:30:03
 Page 2

Lot Data	Acre - HomeSite and Tracts	Primary Image
Lot Size Lot Count Units Buildable Non-Ag Acres 10 Topography Street Access Utilities Amenities Method Acre Base Lot Value 10.00 x 1,175.00 = 11,750 Factor Value Adjustments Lot Value 11,750		<p>0000-32-27N-24W-2-001-00 ACCT # 2777 - 07/01/22</p>

Residential Data	
Type	1 Single Family Residence
Condition	3 - Average
Quality	4 - Good
Architecture	TRAD TRADITIONAL
Style	50% One Story 50% 1 1/2 Story Finished
Exterior Wall	25% Frame, Siding, Vinyl 75% Veneer, Stone
Base/Total Area	1,826 / 2,186
Style	50% One Story - 50% 1 1/2 Story Finished
HVAC	100% Warmed & Cooled Air
Roof Cover	4 Metal, Preformed
Area on Slab	0
Fixture/RghIn	9 /
Bed/F/H Bath	4 / 2.0 /
Basement Area	
Garage Type	384 Detached Garage - Finished
Remodel	
Year/Eff Age	1950 / 76



GRM Approach

GRM Code	
Gross Rent	
Indicated Value	

Multiple Regression

MRA Code	
Adusted R	
Indicated Value	

Direct Comparables

Selection Model	DEFAULT	DEFAULT SELECTION MODEL
Adjustment Model	DEFAULT	DEFAULT ADJUSTMENTS TABLE
Comparables		
Indicated Value		

Value Reconciliation

Selected Approach	Cost Approach		
Improvements	72,841		
Lot Value	11,750		
Indicated Value	84,591	38.70	Per SqFt
Agland Value			
Site Improvements	57,688		
Total Value	142,279	65.09	Total Value Per SqFt

Cost Approach		Manual :	
Base Cost	91.40	Total Misc Impr	+ 1,360
Roofing Adj	+ 4.89	Garage Cost	+ 23,824
Subfloor Adj	+ 0.00	Total RCN	= 280,159
Heat/Cool Adj	+ 13.89	Depreciation (74%)	- 207,318
Plumbing Adj	+ 6.46	Lump Sums	+ 0
Basement Adj	+ 0.00	RCNLD	= 72,841
Adj Base Cost	= 116.64	Lot Value	+ 11,750
Total Area	x 2,186	Indicated Value	= 84,591
Adjusted Cost	= 254,975	Value Per SqFt	38.70

Miscellaneous Improvements

Code	Description	Sketch ID	Size	Year	Units	Unit Cost	Depr	Value
PATO	OPEN PORCH	1456	14x8		112	12.14		1,360



Harper

Assessment Property Record Card for Tax Year 2026

Data provided by SHAYLYN WEDER County Assessor

Date 02/06/2026
 Time 06:30:03
 Page 3

Sketch Image

300002777

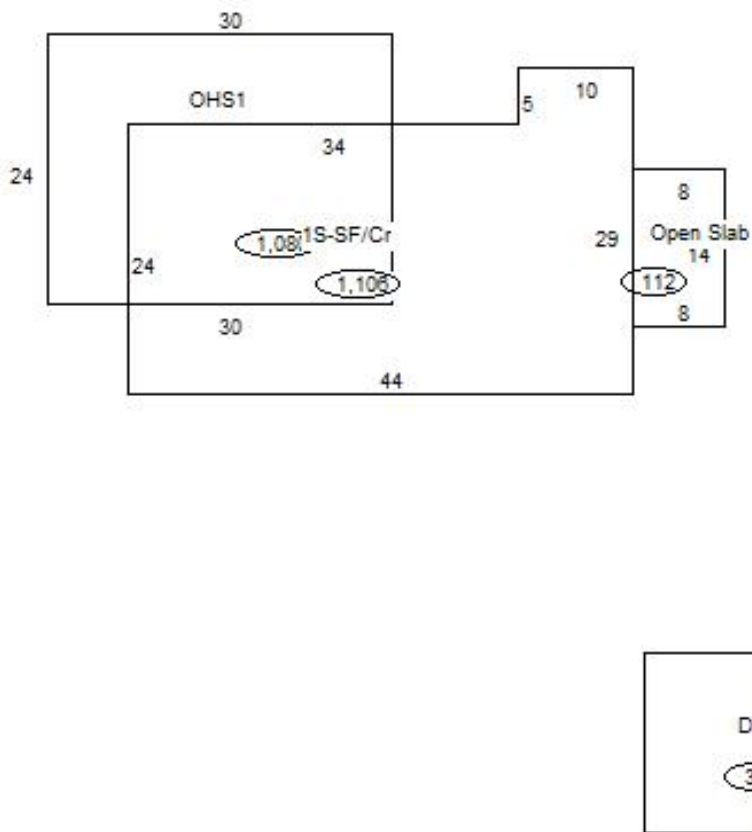

Sketch Vector Information

Sequence	Code	Type	Built Over	Scale	Section Label	Base Area	Multiplier	Total Area
1	R	5	Crawl	20	OHS1	720	1.500	1,080
2	M	PATO		20	Open Slab	112	1.000	112
3	G	2		20	Det Gar	384	1.000	384
4	R	1	Crawl	20	1S-SF/Cr	1,106	1.000	1,106
Total Building Area						1,826		2,186



Harper

Assessment Property Record Card for Tax Year 2026

Data provided by SHAYLYN WEDER County Assessor

Date 02/06/2026
 Time 06:30:03
 Page 4

300002777

Outbuildings/Site Improvements

Building Image	Code	Description	Dimensions	Floor	Roofing	Total Units
	UTIL	Utility Building	80x40x14	Concrete	Formed Metal	3,200
	Qual 3	Cond 4	Year 2015	Eff Age 9		
		0				
		0				
Valuation Summary			Modifier Total			
Base Cost (21.72 x 3,200)		69,504		RCN 69,504	Depr (17% Phys/ % Func) 11,816	RCNLD 57,688