



Harper

Assessment Property Record Card for Tax Year 2026

Date provided by SHAYLYN WEDER County Assessor

Date 02/06/2026
 Time 06:35:43
 Page 1

Assessment Data					Primary Image																																																																																																																				
Account 300003178 Parcel ID 0000-33-28N-21W-1-002-00 Cadastral ID 0000-28N-21W-33-1-002-00 Property Type REAL - Real Property Property Class RR VI Area 2 Tax Area 102 - 4R-BUFFALO Name ID 25437 MALLORY, TOWANDA YVONNE BRICKMAN 1015 8TH ST. ALVA OK 73717- Parcel Location Situs 19956 10 RD E Subdivision Lot/Block / Parcel Size 2.79 - Acres Sec/Twn/Rng 33 / 28 / 21 / 1 Neighborhood 1000 - COUNTY School District 4-BUFFAL - 4-BUFFALO																																																																																																																									
Legal Description Lat/Long: 36.86329247 -99.50729643 SEC. 33-28-21 TRACT IN NE4 2.7984 ACRES TOWANDA DECEASED 7/30/2025 BOOK 778 PAGE 393-389 FD																																																																																																																									
Exemptions					Building Permits																																																																																																																				
<table border="1"> <thead> <tr> <th>Code</th> <th>Type</th> <th>Active</th> <th>Maximum</th> <th>Exemption</th> </tr> </thead> <tbody> <tr> <td></td> <td></td> <td></td> <td></td> <td></td> </tr> </tbody> </table>					Code	Type	Active	Maximum	Exemption						<table border="1"> <thead> <tr> <th>Number</th> <th>Description</th> <th>Opened</th> <th>Closed</th> <th>Amount</th> </tr> </thead> <tbody> <tr> <td></td> <td></td> <td></td> <td></td> <td></td> </tr> </tbody> </table>					Number	Description	Opened	Closed	Amount																																																																																																	
Code	Type	Active	Maximum	Exemption																																																																																																																					
Number	Description	Opened	Closed	Amount																																																																																																																					
<table border="1"> <thead> <tr> <th>Code</th> <th>Type</th> <th>Active</th> <th>Maximum</th> <th>Exemption</th> </tr> </thead> <tbody> <tr> <td></td> <td></td> <td></td> <td></td> <td></td> </tr> </tbody> </table>					Code	Type	Active	Maximum	Exemption						Sale History <table border="1"> <thead> <tr> <th>Bk/Pg</th> <th>Grantor</th> <th>Date</th> <th>Price</th> <th>Code</th> </tr> </thead> <tbody> <tr> <td>778/393</td> <td>MALLORY, CHARLES WESLEY</td> <td>09/28/2023</td> <td></td> <td>04</td> </tr> </tbody> </table>					Bk/Pg	Grantor	Date	Price	Code	778/393	MALLORY, CHARLES WESLEY	09/28/2023		04																																																																																												
Code	Type	Active	Maximum	Exemption																																																																																																																					
Bk/Pg	Grantor	Date	Price	Code																																																																																																																					
778/393	MALLORY, CHARLES WESLEY	09/28/2023		04																																																																																																																					
Parcel Valuation <table border="1"> <thead> <tr> <th>Source</th> <th>REAL</th> <th>Fair Cash</th> <th>Capped</th> <th>Asmnt Level</th> <th>Assessed</th> <th>Levy Rate</th> <th>78.740</th> <th>Current Tax</th> </tr> </thead> <tbody> <tr> <td>Remove Cap</td> <td></td> <td>Land Value 6,343</td> <td>6,343</td> <td>12%</td> <td>761</td> <td>Assessed</td> <td>7,932</td> <td>624.57</td> </tr> <tr> <td>Year Frozen</td> <td></td> <td>Improvements 59,758</td> <td>59,758</td> <td></td> <td>7,171</td> <td>Penalty</td> <td>0</td> <td></td> </tr> <tr> <td>Uncapped Value</td> <td>0</td> <td>Mobile Home 0</td> <td>0</td> <td></td> <td>0</td> <td>Exemption</td> <td>0</td> <td>0.00</td> </tr> <tr> <td>TIF Project ID</td> <td>0</td> <td>Total Value 66,101</td> <td>66,101</td> <td></td> <td>7,932</td> <td>Total Taxable</td> <td>7,932</td> <td>625.00</td> </tr> </tbody> </table>										Source	REAL	Fair Cash	Capped	Asmnt Level	Assessed	Levy Rate	78.740	Current Tax	Remove Cap		Land Value 6,343	6,343	12%	761	Assessed	7,932	624.57	Year Frozen		Improvements 59,758	59,758		7,171	Penalty	0		Uncapped Value	0	Mobile Home 0	0		0	Exemption	0	0.00	TIF Project ID	0	Total Value 66,101	66,101		7,932	Total Taxable	7,932	625.00																																																																			
Source	REAL	Fair Cash	Capped	Asmnt Level	Assessed	Levy Rate	78.740	Current Tax																																																																																																																	
Remove Cap		Land Value 6,343	6,343	12%	761	Assessed	7,932	624.57																																																																																																																	
Year Frozen		Improvements 59,758	59,758		7,171	Penalty	0																																																																																																																		
Uncapped Value	0	Mobile Home 0	0		0	Exemption	0	0.00																																																																																																																	
TIF Project ID	0	Total Value 66,101	66,101		7,932	Total Taxable	7,932	625.00																																																																																																																	
Assessment History <table border="1"> <thead> <tr> <th>Tax Year</th> <th>Statement Number</th> <th>Billed Owner</th> <th>Tax Area</th> <th>Total Value</th> <th>Exemptions</th> <th>Taxable Value</th> <th>Billed Tax</th> </tr> </thead> <tbody> <tr><td>2025</td><td>2025-300003178</td><td>MALLORY, TOWANDA YVONNE BRICKMAN</td><td>102</td><td>66,101</td><td>0</td><td>7,932</td><td>625.00</td></tr> <tr><td>2024</td><td>2024-300003178</td><td>MALLORY, TOWANDA YVONNE BRICKMAN</td><td>102</td><td>71,036</td><td>0</td><td>8,133</td><td>662.00</td></tr> <tr><td>2023</td><td>2023-300003178</td><td>MALLORY, CHARLES WESLEY</td><td>102</td><td>65,868</td><td>0</td><td>7,746</td><td>641.00</td></tr> <tr><td>2022</td><td>2022-300003178</td><td>MALLORY, CHARLES WESLEY</td><td>102</td><td>62,949</td><td>0</td><td>7,378</td><td>607.00</td></tr> <tr><td>2021</td><td>2021-300003178</td><td>MALLORY, CHARLES WESLEY</td><td>102</td><td>62,318</td><td>0</td><td>7,026</td><td>580.00</td></tr> <tr><td>2020</td><td>2020-300003178</td><td>MALLORY, CHARLES WESLEY</td><td>102</td><td>64,242</td><td>0</td><td>6,692</td><td>551.00</td></tr> <tr><td>2019</td><td>2019-0003178</td><td>MALLORY, CHARLES WESLEY</td><td>102</td><td>64,242</td><td></td><td>6,372</td><td>528.00</td></tr> <tr><td>2018</td><td>2018-0003178</td><td>MALLORY, CHARLES WESLEY</td><td>102</td><td>64,242</td><td></td><td>6,069</td><td>503.00</td></tr> <tr><td>2017</td><td>2017-0003178</td><td>MALLORY, CHARLES WESLEY</td><td>102</td><td>60,734</td><td></td><td>5,781</td><td>481.00</td></tr> <tr><td>2016</td><td>2016-0003178</td><td>MALLORY, CHARLES WESLEY</td><td>102</td><td>60,734</td><td></td><td>5,505</td><td>468.00</td></tr> <tr><td>2015</td><td>2015-0003178</td><td>MALLORY, CHARLES WESLEY</td><td>102</td><td>58,849</td><td></td><td>5,243</td><td>416.00</td></tr> <tr><td>2014</td><td>2014-0003178</td><td>MALLORY, CHARLES WESLEY</td><td>102</td><td>55,755</td><td></td><td>4,994</td><td>400.00</td></tr> <tr><td>2013</td><td>2013-0003178</td><td>MALLORY, CHARLES WESLEY</td><td>102</td><td>55,755</td><td></td><td>4,755</td><td>379.00</td></tr> </tbody> </table>										Tax Year	Statement Number	Billed Owner	Tax Area	Total Value	Exemptions	Taxable Value	Billed Tax	2025	2025-300003178	MALLORY, TOWANDA YVONNE BRICKMAN	102	66,101	0	7,932	625.00	2024	2024-300003178	MALLORY, TOWANDA YVONNE BRICKMAN	102	71,036	0	8,133	662.00	2023	2023-300003178	MALLORY, CHARLES WESLEY	102	65,868	0	7,746	641.00	2022	2022-300003178	MALLORY, CHARLES WESLEY	102	62,949	0	7,378	607.00	2021	2021-300003178	MALLORY, CHARLES WESLEY	102	62,318	0	7,026	580.00	2020	2020-300003178	MALLORY, CHARLES WESLEY	102	64,242	0	6,692	551.00	2019	2019-0003178	MALLORY, CHARLES WESLEY	102	64,242		6,372	528.00	2018	2018-0003178	MALLORY, CHARLES WESLEY	102	64,242		6,069	503.00	2017	2017-0003178	MALLORY, CHARLES WESLEY	102	60,734		5,781	481.00	2016	2016-0003178	MALLORY, CHARLES WESLEY	102	60,734		5,505	468.00	2015	2015-0003178	MALLORY, CHARLES WESLEY	102	58,849		5,243	416.00	2014	2014-0003178	MALLORY, CHARLES WESLEY	102	55,755		4,994	400.00	2013	2013-0003178	MALLORY, CHARLES WESLEY	102	55,755		4,755	379.00
Tax Year	Statement Number	Billed Owner	Tax Area	Total Value	Exemptions	Taxable Value	Billed Tax																																																																																																																		
2025	2025-300003178	MALLORY, TOWANDA YVONNE BRICKMAN	102	66,101	0	7,932	625.00																																																																																																																		
2024	2024-300003178	MALLORY, TOWANDA YVONNE BRICKMAN	102	71,036	0	8,133	662.00																																																																																																																		
2023	2023-300003178	MALLORY, CHARLES WESLEY	102	65,868	0	7,746	641.00																																																																																																																		
2022	2022-300003178	MALLORY, CHARLES WESLEY	102	62,949	0	7,378	607.00																																																																																																																		
2021	2021-300003178	MALLORY, CHARLES WESLEY	102	62,318	0	7,026	580.00																																																																																																																		
2020	2020-300003178	MALLORY, CHARLES WESLEY	102	64,242	0	6,692	551.00																																																																																																																		
2019	2019-0003178	MALLORY, CHARLES WESLEY	102	64,242		6,372	528.00																																																																																																																		
2018	2018-0003178	MALLORY, CHARLES WESLEY	102	64,242		6,069	503.00																																																																																																																		
2017	2017-0003178	MALLORY, CHARLES WESLEY	102	60,734		5,781	481.00																																																																																																																		
2016	2016-0003178	MALLORY, CHARLES WESLEY	102	60,734		5,505	468.00																																																																																																																		
2015	2015-0003178	MALLORY, CHARLES WESLEY	102	58,849		5,243	416.00																																																																																																																		
2014	2014-0003178	MALLORY, CHARLES WESLEY	102	55,755		4,994	400.00																																																																																																																		
2013	2013-0003178	MALLORY, CHARLES WESLEY	102	55,755		4,755	379.00																																																																																																																		



Harper

Assessment Property Record Card for Tax Year 2026

Data provided by SHAYLYN WEDER County Assessor

Date 02/06/2026
 Time 06:35:43
 Page 2

Lot Data	Acre - HomeSite and Tracts	Primary Image
Lot Size Lot Count Units Buildable Non-Ag Acres 2.791 Topography Street Access Utilities Amenities Method Acre Base Lot Value 2.79 x 2,272.66 = 6,343 Factor Value Adjustments Lot Value 6,343		

Residential Data	
Type	1 Single Family Residence
Condition	3.5 - Average
Quality	3.5 - Average
Architecture	TRAD TRADITIONAL
Style	100% One Story
Exterior Wall	100% Asbestos Siding
Base/Total Area	2,152 / 2,152
Style	100% One Story
HVAC	100% Floor Furnace 1 Wall Air Conditioners (Cour
Roof Cover	1 Composition Shingle
Area on Slab	0
Fixture/RghIn	6 /
Bed/F/H Bath	3 / 1.0 /
Basement Area	
Garage Type	
Remodel	
Year/Eff Age	1940 / 78

HOUSE 6/12/2024

GRM Approach

GRM Code	
Gross Rent	
Indicated Value	

Multiple Regression

MRA Code	
Adusted R	
Indicated Value	

Direct Comparables

Selection Model	DEFAULT	DEFAULT SELECTION MODEL
Adjustment Model	DEFAULT	DEFAULT ADJUSTMENTS TABLE
Comparables		
Indicated Value		

Value Reconciliation

Selected Approach	Cost Approach		
Improvements	48,449		
Lot Value	6,343		
Indicated Value	54,792	25.46	Per SqFt
Agland Value			
Site Improvements	11,327		
Total Value	66,119	30.72	Total Value Per SqFt

Cost Approach		Manual :	
Base Cost	78.60	Total Misc Impr	+ 2,700
Roofing Adj	+ 4.22	Garage Cost	+ 0
Subfloor Adj	+ 0.00	Total RCN	= 193,798
Heat/Cool Adj	+ 1.97	Depreciation (75%)	- 145,349
Plumbing Adj	+ 4.00	Lump Sums	+ 0
Basement Adj	+ 0.00	RCNLD	= 48,449
Adj Base Cost	= 88.80	Lot Value	+ 6,343
Total Area	x 2,152	Indicated Value	= 54,792
Adjusted Cost	= 191,098	Value Per SqFt	25.46

Miscellaneous Improvements

Code	Description	Sketch ID	Size	Year	Units	Unit Cost	Depr	Value
PRCH	Slab Porch - Open	1631	9x7	1940	63	24.98		1,574
PRCH	Slab Porch - Open	1632	9x5	1940	45	25.03		1,126



Harper

Assessment Property Record Card for Tax Year 2026

Data provided by SHAYLYN WEDER County Assessor

Date 02/06/2026
 Time 06:35:43
 Page 3

Sketch Image

300003178

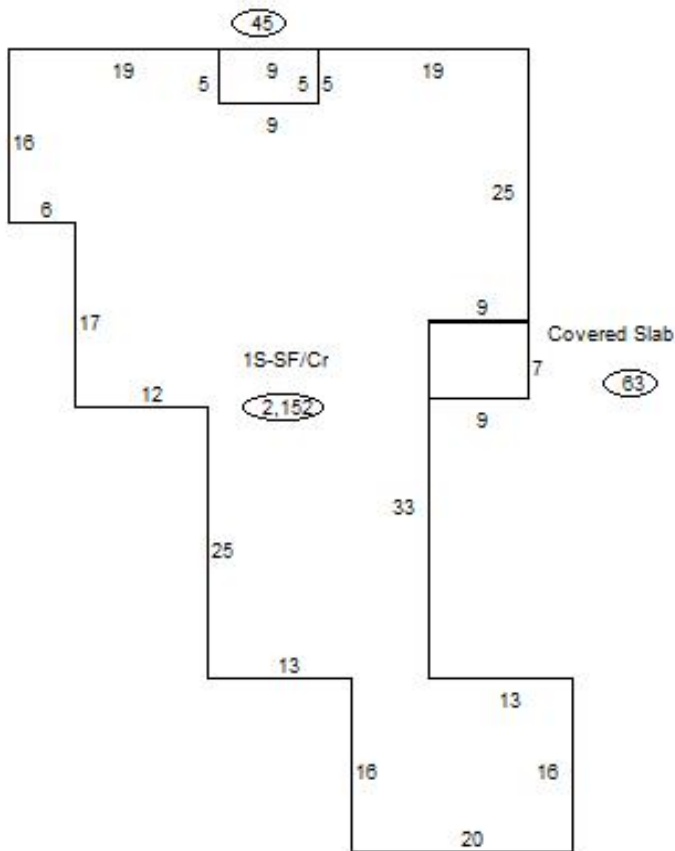

Sketch Vector Information

Sequence	Code	Type	Built Over	Scale	Section Label	Base Area	Multiplier	Total Area
1	M	PRCH		20	Covered Slab	63	1.000	63
2	M	PRCH		20	Covered Slab	45	1.000	45
3	R	1	Crawl	20	1S-SF/Cr	2,152	1.000	2,152
Total Building Area						2,152		2,152



Harper

Assessment Property Record Card for Tax Year 2026

Data provided by SHAYLYN WEDER County Assessor

Date 02/06/2026

Time 06:35:43

Page 4

300003178

Outbuildings/Site Improvements

Building Image	Code	Description	Dimensions	Floor	Roofing	Total Units
	GBST	Grain Bin 2000	0x0x0	Dirt		2,000
	Qual	3	Cond 3	Year 1997	Eff Age 29	
	Valuation Summary		Modifier Total	RCN	Depr (75% Phys/ % Func)	RCNLD
	Base Cost (1.62 x 2,000)	3,240		3,240	2,430	810
	GBST	Grain Bin - Storage	0x0x0	Dirt		2,000
	Qual	3	Cond 3	Year 1997	Eff Age 29	
	Valuation Summary		Modifier Total	RCN	Depr (75% Phys/ % Func)	RCNLD
	Base Cost (1.62 x 2,000)	3,240		3,240	2,430	810
	GBST	Grain Bin - Storage	0x0x0	Dirt		2,000
	Qual	3	Cond 3	Year 1997	Eff Age 29	
	Valuation Summary		Modifier Total	RCN	Depr (75% Phys/ % Func)	RCNLD
	Base Cost (1.62 x 2,000)	3,240		3,240	2,430	810
	GBST	Grain Bin - Storage	0x0x0	Dirt		2,000
	Qual	3	Cond 3	Year 1997	Eff Age 29	
	Valuation Summary		Modifier Total	RCN	Depr (75% Phys/ % Func)	RCNLD
	Base Cost (1.62 x 2,000)	3,240		3,240	2,430	810
	SHDS	Storage	42x18x10	Dirt	Galvanized Metal	756
	Qual	2	Cond 2	Year 1995	Eff Age 37	
	Valuation Summary		Modifier Total	RCN	Depr (80% Phys/ % Func)	RCNLD
	Base Cost (9.50 x 756)	7,182		7,182	5,746	1,436
	GBST	Grain Bin 1000 BU GR BN (1)	0x0x0	Dirt		1,000
	Qual	3	Cond 3	Year 1994	Eff Age 32	
	Valuation Summary		Modifier Total	RCN	Depr (80% Phys/ % Func)	RCNLD
	Base Cost (1.62 x 1,000)	1,620		1,620	1,296	324
	GBST	Grain Bin 6400 BU GR BN (1)	0x0x0	Dirt		6,400
	Qual	3	Cond 3	Year 1994	Eff Age 32	
	Valuation Summary		Modifier Total	RCN	Depr (80% Phys/ % Func)	RCNLD
	Base Cost (1.62 x 6,400)	10,368		10,368	8,294	2,074



Harper

Assessment Property Record Card for Tax Year 2026

Data provided by SHAYLYN WEDER County Assessor

Date 02/06/2026
Time 06:35:43
Page 5

300003178

Outbuildings/Site Improvements

Building Image	Code	Description	Dimensions	Floor	Roofing	Total Units
	SHDS	Shed, Metal	52x32x10	Dirt	Galvanized Metal	1,664
	Qual	3	Cond 3	Year 1991	Eff Age 35	
	Valuation Summary		Modifier Total	RCN	Depr (80% Phys/ % Func)	RCNLD
Base Cost (12.78 x 1,664)		21,266		21,266	17,013	4,253
	BNV	WOOD STG N/V	16.3x8.2x0		Wood Shingle	134
	Qual	3	Cond 3	Year 1942	Eff Age	
	Valuation Summary		Modifier Total	RCN	Depr (0% Phys/ % Func)	RCNLD
Base Cost (0.00 x 134)						