



Harper

Assessment Property Record Card for Tax Year 2026

Data provided by SHAYLYN WEDER County Assessor

Date 02/06/2026
 Time 06:56:46
 Page 1

Assessment Data					Primary Image														
Account 300004733 Parcel ID 0070-00-264-001-0-001-00 Cadastral ID 0070-264-001-00-0-001-00 Property Type REAL - Real Property Property Class UR VI Area 2 Tax Area 201 - 4T-BUFFALO-C Name ID 14325 SARABIA, MIGUEL & LINDSAY SARABIA 604 E BRULE ST BUFFALO OK 73834- Parcel Location Situs 00604 E BRULE ST Subdivision OUT OF LIMITS--BUFFALO Lot/Block 0001 / 0264 Parcel Size 12 - Lots Sec/Twn/Rng / / / Neighborhood 119900 - OUTLYING AREA BUFF School District 4-BUFFAL - 4-BUFFALO					<p>0070-00-264-001-0-001-00 02/22/24</p>														
HOUSE 2/23/2024																			
Legal Description Lat/Long: 36.85995659 -99.62283474					Building Permits														
BUFFALO OUT OF LIMITS BLOCK 264 OF MILLER'S ADD. ALL BLOCK (12 LOTS)					<table border="1"> <thead> <tr> <th>Number</th> <th>Description</th> <th>Opened</th> <th>Closed</th> <th>Amount</th> </tr> </thead> <tbody> <tr> <td> </td> <td> </td> <td> </td> <td> </td> <td> </td> </tr> </tbody> </table>					Number	Description	Opened	Closed	Amount					
					Number	Description	Opened	Closed	Amount										
Exemptions					Sale History														
Code	Type	Active	Maximum	Exemption	Bk/Pg	Grantor	Date	Price	Code										
H	Homestead	Yes	1,000	1,000	735/815	ANDERSON, TRUMAN	03/23/2018	83,000	07										
Parcel Valuation																			
Source	REAL	Fair Cash	Capped	Asmnt Level	Assessed	Levy Rate	78.740	Current Tax											
Remove Cap		Land Value	11,985	11,985	12%	1,438	Assessed	11,685	920.08										
Year Frozen		Improvements	91,070	85,390		10,247	Penalty	0											
Uncapped Value	0	Mobile Home	0	0		0	Exemption	1,000	-79.00										
TIF Project ID	0	Total Value	103,055	97,375		11,685	Total Taxable	10,685	841.00										
Assessment History																			
Tax Year	Statement Number	Billed Owner	Tax Area	Total Value	Exemptions	Taxable Value	Billed Tax												
2025	2025-300004733	SARABIA, MIGUEL &	201	103,055	1000	10,345	815.00												
2024	2024-300004733	SARABIA, MIGUEL &	201	102,804	1000	10,014	815.00												
2023	2023-300004733	SARABIA, MIGUEL &	201	99,440	1000	9,693	802.00												
2022	2022-300004733	SARABIA, MIGUEL &	201	86,518	1000	9,382	772.00												
2021	2021-300004733	SARABIA, MIGUEL AND	201	86,576	1000	9,269	765.00												
2020	2020-300004733	SARABIA, MIGUEL AND	201	83,083	0	9,970	820.00												
2019	2019-0004733	SARABIA, MIGUEL AND	201	83,000		9,960	825.00												
2018	2018-0004733	SARABIA, MIGUEL AND	102	61,689		7,403	614.00												
2017	2017-0004733	ANDERSON, TRUMAN	102	62,708		6,525	542.00												
2016	2016-0004733	ANDERSON, TRUMAN	102	64,746		6,430	547.00												
2015	2015-0004733	ANDERSON, TRUMAN	102	60,117		6,214	493.00												
2014	2014-0004733	ANDERSON, TRUMAN	102	61,015		6,193	496.00												
2013	2013-0004733	ANDERSON, TRUMAN	102	58,202		5,985	477.00												



Harper

Assessment Property Record Card for Tax Year 2026

Data provided by SHAYLYN WEDER County Assessor

Date 02/06/2026
 Time 06:56:46
 Page 2

Lot Data	Square-Foot - OUTLYING AREA	Primary Image
Lot Size	0 0	
Lot Count		
Units Buildable	11985	
Non-Ag Acres		
Topography		
Street Access		
Utilities		
Amenities		
Method	Square-Foot	
Base Lot Value	39,950.00 x .30 = 11,985	
Factor Value		
Adjustments		
Lot Value	11,985	

Residential Data	
Type	1 Single Family Residence
Condition	2.8 - Fair
Quality	2.8 - Fair
Architecture	TRAD TRADITIONAL
Style	100% One Story
Exterior Wall	100% Frame, Siding, Vinyl
Base/Total Area	1,624 / 1,624
Style	100% One Story
HVAC	100% Warmed & Cooled Air
Roof Cover	1 Composition Shingle
Area on Slab	1,624
Fixture/RghIn	5 /
Bed/F/H Bath	2 / 1.0 /
Basement Area	
Garage Type	1,066 Carport - Gable Roof
Remodel	
Year/Eff Age	1975 / 53

HOUSE	2/23/2024
-------	-----------

GRM Approach	
GRM Code	
Gross Rent	
Indicated Value	

Multiple Regression	
MRA Code	
Adjusted R	
Indicated Value	

Direct Comparables	
Selection Model	DEFAULT DEFAULT SELECTION MODEL
Adjustment Model	DEFAULT DEFAULT ADJUSTMENTS TABLE
Comparables	
Indicated Value	

Cost Approach		Manual :	
Base Cost	79.57	Total Misc Impr	+ 3,874
Roofing Adj	+ 3.76	Garage Cost	+ 8,291
Subfloor Adj	+ -1.49	Total RCN	= 168,053
Heat/Cool Adj	+ 10.37	Depreciation (58%)	- 97,471
Plumbing Adj	+ 3.78	Lump Sums	+ 0
Basement Adj	+ 0.00	RCNLD	= 70,582
Adj Base Cost	= 95.99	Lot Value	+ 11,985
Total Area	x 1,624	Indicated Value	= 82,567
Adjusted Cost	= 155,888	Value Per SqFt	50.84

Value Reconciliation			
Selected Approach	Cost Approach		
Improvements	70,582		
Lot Value	11,985		
Indicated Value	82,567	50.84	Per SqFt
Agland Value			
Site Improvements	18,713		
Total Value	101,280	62.36	Total Value Per SqFt

Miscellaneous Improvements							
Code	Description	Sketch ID	Size	Year	Units	Unit Cost	Depr Value
RSPC	Raised Slab Porch - Covered	2124	25x4		100	38.74	3,874



Harper

Assessment Property Record Card for Tax Year 2026

Data provided by SHAYLYN WEDER County Assessor

Date 02/06/2026
 Time 06:56:46
 Page 3

Sketch Image

300004733

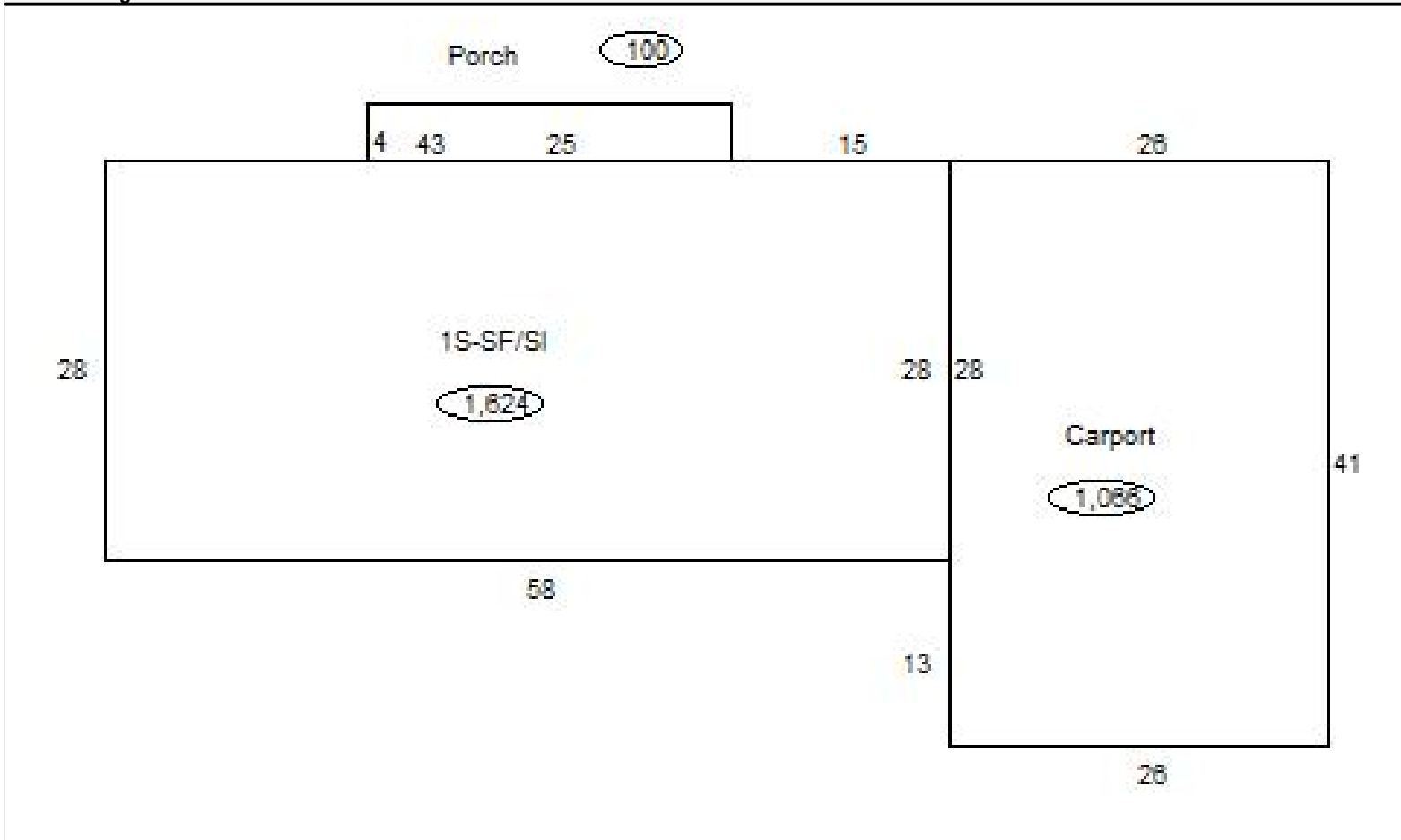

Sketch Vector Information

Sequence	Code	Type	Built Over	Scale	Section Label	Base Area	Multiplier	Total Area
1	G	3		20	Carport	1,066	1.000	1,066
2	M	RSPC		20	Porch	100	1.000	100
3	R	1	Slab	20	1S-SF/Sl	1,624	1.000	1,624
Total Building Area						1,624		1,624



Harper

Assessment Property Record Card for Tax Year 2026

Data provided by SHAYLYN WEDER County Assessor

Date 02/06/2026
Time 06:56:46
Page 4

300004733

Outbuildings/Site Improvements

Building Image	Code	Description	Dimensions	Floor	Roofing	Total Units
	CPDT	Carport - Detached	30x20x8	Dirt	Formed Metal	600
	Qual	3	Cond 3	Year 2018	Eff Age 8	
	Valuation Summary		Modifier Total	RCN	Depr (43% Phys/ % Func)	RCNLD
	Base Cost (4.81 x 600)	2,886		2,886	1,241	1,645
	SHDS	Yard Shed - Metal	20x10x6	Dirt	Formed Metal	200
	Qual	3	Cond 3	Year 1995	Eff Age 31	
	Valuation Summary		Modifier Total	RCN	Depr (78% Phys/ % Func)	RCNLD
	Base Cost (16.85 x 200)	3,370		3,370	2,629	741
	UTIL	Utility Building	50x30x12	Concrete	Formed Metal	1,500
	Qual	3	Cond 3	Year 1995	Eff Age 31	
	Valuation Summary		Modifier Total	RCN	Depr (58% Phys/ % Func)	RCNLD
	Base Cost (25.24 x 1,500)	37,860		37,860	21,959	15,901
	SHDS	Yard Shed	15x8x6	Dirt	Galvanized Metal	120
	Qual	3	Cond 3	Year 1990	Eff Age 36	
	Valuation Summary		Modifier Total	RCN	Depr (80% Phys/ % Func)	RCNLD
	Base Cost (17.76 x 120)	2,131		2,131	1,705	426