



# Harper

## Assessment Property Record Card for Tax Year 2026

Data provided by SHAYLYN WEDER County Assessor

Date 02/06/2026  
 Time 06:57:07  
 Page 1

Assessment Data					Primary Image																																																																																																																				
<b>Account</b> 300004758 <b>Parcel ID</b> 1001-00-007-021-0-001-00 <b>Cadastral ID</b> 1001-007-021-00-0-001-00 <b>Property Type</b> REAL - Real Property <b>Property Class</b> UR VI Area 1 <b>Tax Area</b> 201 - 4T-BUFFALO-C <b>Name ID</b> 14340 CENICEROS, JESUS & ELIA CENICEROS  P.O. BOX 62 BUFFALO OK 73834-0000  <b>Parcel Location</b> <b>Situs</b> 00203 SE FIRST ST <b>Subdivision</b> BUFFALO ORIG <b>Lot/Block</b> 0021 / 0007 <b>Parcel Size</b> 4 - Lots <b>Sec/Twn/Rng</b> / / / <b>Neighborhood</b> 100100 - BUFFALO ORIG/MILLERS <b>School District</b> 4-BUFFAL - 4-BUFFALO					<p>1001-00-007-021-0-001-00 01/05/23</p>																																																																																																																				
<b>HOUSE</b> 1/6/2023																																																																																																																									
<b>Legal Description</b> Lat/Long: 36.82789387 -99.62881048					<b>Building Permits</b>																																																																																																																				
BUFFALO ORIG. BLOCK 7 LOTS: 21 THRU 24					<table border="1"> <thead> <tr> <th>Number</th> <th>Description</th> <th>Opened</th> <th>Closed</th> <th>Amount</th> </tr> </thead> <tbody> <tr> <td> </td> <td> </td> <td> </td> <td> </td> <td> </td> </tr> </tbody> </table>					Number	Description	Opened	Closed	Amount																																																																																																											
Number	Description	Opened	Closed	Amount																																																																																																																					
<b>Exemptions</b>					<b>Sale History</b>																																																																																																																				
<table border="1"> <thead> <tr> <th>Code</th> <th>Type</th> <th>Active</th> <th>Maximum</th> <th>Exemption</th> </tr> </thead> <tbody> <tr> <td> </td> <td> </td> <td> </td> <td> </td> <td> </td> </tr> </tbody> </table>					Code	Type	Active	Maximum	Exemption						<table border="1"> <thead> <tr> <th>Bk/Pg</th> <th>Grantor</th> <th>Date</th> <th>Price</th> <th>Code</th> </tr> </thead> <tbody> <tr> <td>/</td> <td>CENICEROS, JESUS &amp;</td> <td> </td> <td> </td> <td> </td> </tr> </tbody> </table>					Bk/Pg	Grantor	Date	Price	Code	/	CENICEROS, JESUS &																																																																																															
Code	Type	Active	Maximum	Exemption																																																																																																																					
Bk/Pg	Grantor	Date	Price	Code																																																																																																																					
/	CENICEROS, JESUS &																																																																																																																								
<b>Parcel Valuation</b>																																																																																																																									
<table border="1"> <thead> <tr> <th>Source</th> <th>REAL</th> </tr> </thead> <tbody> <tr> <td>Remove Cap</td> <td>2020</td> </tr> </tbody> </table>		Source	REAL	Remove Cap	2020	<table border="1"> <thead> <tr> <th>Fair Cash</th> <th>Capped</th> <th>Asmnt Level</th> <th>Assessed</th> </tr> </thead> <tbody> <tr> <td>Land Value 4,200</td> <td>4,200</td> <td>12%</td> <td>504</td> </tr> <tr> <td>Improvements 28,890</td> <td>28,890</td> <td> </td> <td>3,467</td> </tr> <tr> <td>Uncapped Value 0</td> <td>0</td> <td> </td> <td>0</td> </tr> <tr> <td>TIF Project ID 0</td> <td>0</td> <td> </td> <td>3,971</td> </tr> <tr> <td><b>Total Value</b> 33,090</td> <td>33,090</td> <td> </td> <td><b>3,971</b></td> </tr> </tbody> </table>			Fair Cash	Capped	Asmnt Level	Assessed	Land Value 4,200	4,200	12%	504	Improvements 28,890	28,890		3,467	Uncapped Value 0	0		0	TIF Project ID 0	0		3,971	<b>Total Value</b> 33,090	33,090		<b>3,971</b>	<table border="1"> <thead> <tr> <th>Levy Rate</th> <th>78.740</th> <th>Current Tax</th> </tr> </thead> <tbody> <tr> <td>Assessed</td> <td>3,971</td> <td>312.68</td> </tr> <tr> <td>Penalty</td> <td>0</td> <td> </td> </tr> <tr> <td>Exemption</td> <td>0</td> <td>0.00</td> </tr> <tr> <td><b>Total Taxable</b></td> <td><b>3,971</b></td> <td><b>313.00</b></td> </tr> </tbody> </table>		Levy Rate	78.740	Current Tax	Assessed	3,971	312.68	Penalty	0		Exemption	0	0.00	<b>Total Taxable</b>	<b>3,971</b>	<b>313.00</b>																																																																								
Source	REAL																																																																																																																								
Remove Cap	2020																																																																																																																								
Fair Cash	Capped	Asmnt Level	Assessed																																																																																																																						
Land Value 4,200	4,200	12%	504																																																																																																																						
Improvements 28,890	28,890		3,467																																																																																																																						
Uncapped Value 0	0		0																																																																																																																						
TIF Project ID 0	0		3,971																																																																																																																						
<b>Total Value</b> 33,090	33,090		<b>3,971</b>																																																																																																																						
Levy Rate	78.740	Current Tax																																																																																																																							
Assessed	3,971	312.68																																																																																																																							
Penalty	0																																																																																																																								
Exemption	0	0.00																																																																																																																							
<b>Total Taxable</b>	<b>3,971</b>	<b>313.00</b>																																																																																																																							
<b>Assessment History</b>																																																																																																																									
<table border="1"> <thead> <tr> <th>Tax Year</th> <th>Statement Number</th> <th>Billed Owner</th> <th>Tax Area</th> <th>Total Value</th> <th>Exemptions</th> <th>Taxable Value</th> <th>Billed Tax</th> </tr> </thead> <tbody> <tr><td>2025</td><td>2025-300004758</td><td>CENICEROS, JESUS &amp;</td><td>201</td><td>33,090</td><td>0</td><td>3,971</td><td>313.00</td></tr> <tr><td>2024</td><td>2024-300004758</td><td>CENICEROS, JESUS &amp;</td><td>201</td><td>35,211</td><td>0</td><td>3,843</td><td>313.00</td></tr> <tr><td>2023</td><td>2023-300004758</td><td>CENICEROS, JESUS &amp;</td><td>201</td><td>30,497</td><td>0</td><td>3,660</td><td>303.00</td></tr> <tr><td>2022</td><td>2022-300004758</td><td>CENICEROS, JESUS &amp;</td><td>201</td><td>30,497</td><td>0</td><td>3,660</td><td>301.00</td></tr> <tr><td>2021</td><td>2021-300004758</td><td>CENICEROS, JESUS &amp;</td><td>201</td><td>30,497</td><td>0</td><td>3,660</td><td>302.00</td></tr> <tr><td>2020</td><td>2020-300004758</td><td>CENICEROS, JESUS &amp;</td><td>201</td><td>30,497</td><td>0</td><td>3,660</td><td>301.00</td></tr> <tr><td>2019</td><td>2019-0004758</td><td>CENICEROS, JESUS &amp;</td><td>201</td><td>28,595</td><td> </td><td>3,431</td><td>284.00</td></tr> <tr><td>2018</td><td>2018-0004758</td><td>CENICEROS, JESUS &amp;</td><td>201</td><td>28,595</td><td> </td><td>3,268</td><td>271.00</td></tr> <tr><td>2017</td><td>2017-0004758</td><td>CENICEROS, JESUS &amp;</td><td>201</td><td>28,595</td><td> </td><td>3,112</td><td>259.00</td></tr> <tr><td>2016</td><td>2016-0004758</td><td>CENICEROS, JESUS &amp;</td><td>201</td><td>28,595</td><td> </td><td>2,964</td><td>252.00</td></tr> <tr><td>2015</td><td>2015-0004758</td><td>CENICEROS, JESUS &amp;</td><td>201</td><td>28,688</td><td> </td><td>2,823</td><td>224.00</td></tr> <tr><td>2014</td><td>2014-0004758</td><td>CENICEROS, JESUS &amp;</td><td>201</td><td>28,688</td><td> </td><td>2,689</td><td>215.00</td></tr> <tr><td>2013</td><td>2013-0004758</td><td>CENICEROS, JESUS &amp;</td><td>201</td><td>31,981</td><td> </td><td>2,561</td><td>204.00</td></tr> </tbody> </table>										Tax Year	Statement Number	Billed Owner	Tax Area	Total Value	Exemptions	Taxable Value	Billed Tax	2025	2025-300004758	CENICEROS, JESUS &	201	33,090	0	3,971	313.00	2024	2024-300004758	CENICEROS, JESUS &	201	35,211	0	3,843	313.00	2023	2023-300004758	CENICEROS, JESUS &	201	30,497	0	3,660	303.00	2022	2022-300004758	CENICEROS, JESUS &	201	30,497	0	3,660	301.00	2021	2021-300004758	CENICEROS, JESUS &	201	30,497	0	3,660	302.00	2020	2020-300004758	CENICEROS, JESUS &	201	30,497	0	3,660	301.00	2019	2019-0004758	CENICEROS, JESUS &	201	28,595		3,431	284.00	2018	2018-0004758	CENICEROS, JESUS &	201	28,595		3,268	271.00	2017	2017-0004758	CENICEROS, JESUS &	201	28,595		3,112	259.00	2016	2016-0004758	CENICEROS, JESUS &	201	28,595		2,964	252.00	2015	2015-0004758	CENICEROS, JESUS &	201	28,688		2,823	224.00	2014	2014-0004758	CENICEROS, JESUS &	201	28,688		2,689	215.00	2013	2013-0004758	CENICEROS, JESUS &	201	31,981		2,561	204.00
Tax Year	Statement Number	Billed Owner	Tax Area	Total Value	Exemptions	Taxable Value	Billed Tax																																																																																																																		
2025	2025-300004758	CENICEROS, JESUS &	201	33,090	0	3,971	313.00																																																																																																																		
2024	2024-300004758	CENICEROS, JESUS &	201	35,211	0	3,843	313.00																																																																																																																		
2023	2023-300004758	CENICEROS, JESUS &	201	30,497	0	3,660	303.00																																																																																																																		
2022	2022-300004758	CENICEROS, JESUS &	201	30,497	0	3,660	301.00																																																																																																																		
2021	2021-300004758	CENICEROS, JESUS &	201	30,497	0	3,660	302.00																																																																																																																		
2020	2020-300004758	CENICEROS, JESUS &	201	30,497	0	3,660	301.00																																																																																																																		
2019	2019-0004758	CENICEROS, JESUS &	201	28,595		3,431	284.00																																																																																																																		
2018	2018-0004758	CENICEROS, JESUS &	201	28,595		3,268	271.00																																																																																																																		
2017	2017-0004758	CENICEROS, JESUS &	201	28,595		3,112	259.00																																																																																																																		
2016	2016-0004758	CENICEROS, JESUS &	201	28,595		2,964	252.00																																																																																																																		
2015	2015-0004758	CENICEROS, JESUS &	201	28,688		2,823	224.00																																																																																																																		
2014	2014-0004758	CENICEROS, JESUS &	201	28,688		2,689	215.00																																																																																																																		
2013	2013-0004758	CENICEROS, JESUS &	201	31,981		2,561	204.00																																																																																																																		



# Harper

## Assessment Property Record Card for Tax Year 2026

Data provided by SHAYLYN WEDER County Assessor

Date 02/06/2026  
 Time 06:57:07  
 Page 2

Lot Data	Square-Foot - BUFFALO ORIGMILLERS	Primary Image
Lot Size	0 0	
Lot Count		
Units Buildable	4200	
Non-Ag Acres		
Topography		
Street Access		
Utilities		
Amenities		
Method	Square-Foot	
Base Lot Value	14,000.00 x .30 = 4,200	
Factor Value		
Adjustments		
Lot Value	4,200	

Residential Data	
Type	1 Single Family Residence
Condition	1.25 - Low
Quality	1.25 - Low
Architecture	TRAD TRADITIONAL
Style	100% One Story
Exterior Wall	100% Frame, Siding, Vinyl
Base/Total Area	1,751 / 1,751
Style	100% One Story
HVAC	100% Warmed & Cooled Air
Roof Cover	1 Composition Shingle
Area on Slab	1,751
Fixture/RghIn	8 /
Bed/F/H Bath	4 / 2.0 /
Basement Area	
Garage Type	
Remodel	
Year/Eff Age	1940 / 116

HOUSE	1/6/2023
-------	----------

GRM Approach	
GRM Code	
Gross Rent	
Indicated Value	

Multiple Regression	
MRA Code	
Adjusted R	
Indicated Value	

Direct Comparables	
Selection Model	DEFAULT DEFAULT SELECTION MODEL
Adjustment Model	DEFAULT DEFAULT ADJUSTMENTS TABLE
Comparables	
Indicated Value	

Value Reconciliation			
Selected Approach	Cost Approach		
Improvements	28,981		
Lot Value	4,200		
Indicated Value	33,181	18.95	Per SqFt
Agland Value			
Site Improvements			
Total Value	33,181	18.95	Total Value Per SqFt

Cost Approach		Manual :	
Base Cost	61.99	Total Misc Impr	+ 9,253
Roofing Adj	+ 2.94	Garage Cost	+ 0
Subfloor Adj	+ 0.00	Total RCN	= 144,903
Heat/Cool Adj	+ 8.25	Depreciation ( 80%)	- 115,922
Plumbing Adj	+ 4.28	Lump Sums	+ 0
Basement Adj	+ 0.00	RCNLD	= 28,981
Adj Base Cost	= 77.47	Lot Value	+ 4,200
Total Area	x 1,751	Indicated Value	= 33,181
Adjusted Cost	= 135,650	Value Per SqFt	18.95

Miscellaneous Improvements								
Code	Description	Sketch ID	Size	Year	Units	Unit Cost	Depr	Value
FPR1	Fireplace - Residential 1 Story	0		1 1940	1	3,665.22		3,665
RSPC	Raised Slab Porch - Covered	2158	28x7	1980	196	28.51		5,588



Harper

Assessment Property Record Card for Tax Year 2026

Data provided by SHAYLYN WEDER County Assessor

Date 02/06/2026  
Time 06:57:07  
Page 3

Sketch Image

300004758

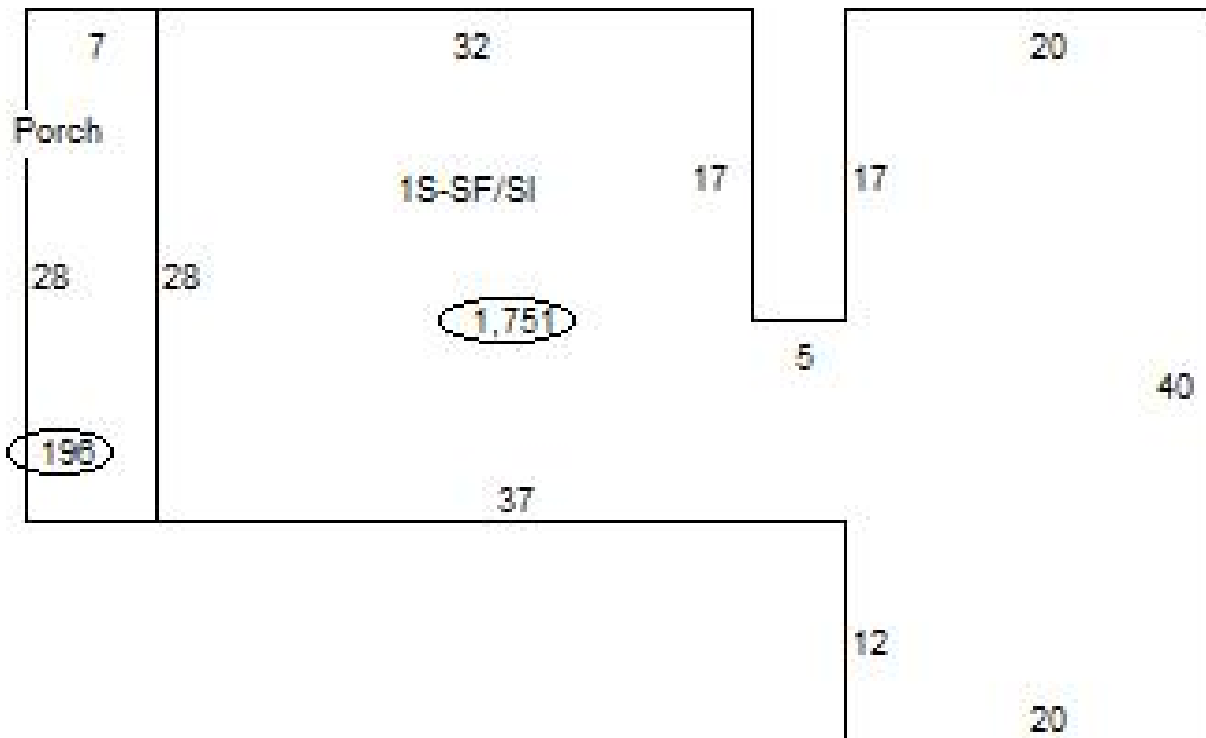

Sketch Vector Information

Sequence	Code	Type	Built Over	Scale	Section Label	Base Area	Multiplier	Total Area
1	M	RSPC		20	Porch	196	1.000	196
2	R	1	Slab	20	1S-SF/SI	1,751	1.000	1,751
<b>Total Building Area</b>						1,751		1,751