



# Harper

## Assessment Property Record Card for Tax Year 2026

Data provided by SHAYLYN WEDER County Assessor

Date 02/06/2026  
 Time 06:58:08  
 Page 1

| Assessment Data  |                          |                         |           |           | Primary Image                                    |                         |               |               |             |  |  |  |  |  |
|--|--------------------------|-------------------------|-----------|-----------|--|-------------------------|---------------|---------------|-------------|--|--|--|--|--|
| Account  | 300004831                |                         |           |           | <p>1001-00-023-014-0-001-00_001.JPG 1/6/2023</p> |                         |               |               |             |  |  |  |  |  |
| Parcel ID  | 1001-00-023-014-0-001-00 |                         |           |           |  |                         |               |               |             |  |  |  |  |  |
| Cadastral ID   | 1001-023-014-00-0-001-00 |                         |           |           |  |                         |               |               |             |  |  |  |  |  |
| Property Type  | REAL - Real Property     |                         |           |           |  |                         |               |               |             |  |  |  |  |  |
| Property Class   | UR                       | VI Area 1               |           |           |  |                         |               |               |             |  |  |  |  |  |
| Tax Area   | 201 - 4T-BUFFALO-C       |                         |           |           |  |                         |               |               |             |  |  |  |  |  |
| Name ID  | 14855                    |                         |           |           |  |                         |               |               |             |  |  |  |  |  |
| OLMSTEAD, BILLY W. &<br>KARLINDA OLMSTEAD  |                          |                         |           |           |  |                         |               |               |             |  |  |  |  |  |
| 608 E BRULE ST.<br>BUFFALO OK 73834-0000   |                          |                         |           |           |  |                         |               |               |             |  |  |  |  |  |
| Parcel Location  |                          |                         |           |           |  |                         |               |               |             |  |  |  |  |  |
| Situs  | 00227 DR OLIVE           |                         |           |           |  |                         |               |               |             |  |  |  |  |  |
| Subdivision  | BUFFALO ORIG             |                         |           |           |  |                         |               |               |             |  |  |  |  |  |
| Lot/Block  | 0014 / 0023              | Parcel Size 2 - Lots    |           |           |  |                         |               |               |             |  |  |  |  |  |
| Sec/Twn/Rng  | / / /                    |                         |           |           |  |                         |               |               |             |  |  |  |  |  |
| Neighborhood   | 103020 - BUFFALO ORIG.   |                         |           |           |  |                         |               |               |             |  |  |  |  |  |
| School District  | 4-BUFFAL - 4-BUFFALO     |                         |           |           |  |                         |               |               |             |  |  |  |  |  |
| Legal Description Lat/Long: 36.97635985 -99.84925053   |                          |                         |           |           |  |                         |               |               |             |  |  |  |  |  |
| BUFFALO ORIG. BLOCK 23 LOTS: 14-15   |                          |                         |           |           |  |                         |               |               |             |  |  |  |  |  |
| Building Permits   |                          |                         |           |           |  |                         |               |               |             |  |  |  |  |  |
| <table border="1"> <thead> <tr> <th>Number</th> <th>Description</th> <th>Opened</th> <th>Closed</th> <th>Amount</th> </tr> </thead> <tbody> <tr> <td></td> <td></td> <td></td> <td></td> <td></td> </tr> </tbody> </table> |                          |                         |           |           | Number   | Description             | Opened        | Closed        | Amount      |  |  |  |  |  |
| Number   | Description              | Opened                  | Closed    | Amount    |  |                         |               |               |             |  |  |  |  |  |
|  |                          |                         |           |           |  |                         |               |               |             |  |  |  |  |  |
| Exemptions   |                          |                         |           |           |  |                         |               |               |             |  |  |  |  |  |
| Sale History   |                          |                         |           |           |  |                         |               |               |             |  |  |  |  |  |
| Code   | Type                     | Active                  | Maximum   | Exemption | Bk/Pg  | Grantor                 | Date          | Price         | Code        |  |  |  |  |  |
|  |                          |                         |           |           | 753/683  | POWELL, MARTON LEE, JR. | 11/06/2017    |               | 0 04        |  |  |  |  |  |
|  |                          |                         |           |           | /  | POWELL, MARTON LEE, JR. |               |               |             |  |  |  |  |  |
| Parcel Valuation   |                          |                         |           |           |  |                         |               |               |             |  |  |  |  |  |
| Source   | REAL                     |                         | Fair Cash | Capped    | Asmnt Level                                      | Assessed                | Levy Rate     | 78.740        | Current Tax |  |  |  |  |  |
| Remove Cap   |                          | Land Value              | 2,100     | 2,100     | 12%  | 252                     | Assessed      | 2,765         | 217.72      |  |  |  |  |  |
| Year Frozen  |                          | Improvements            | 20,940    | 20,940    |  | 2,513                   | Penalty       | 0             |             |  |  |  |  |  |
| Uncapped Value   | 0                        | Mobile Home             | 0         | 0         |  | 0                       | Exemption     | 0             | 0.00        |  |  |  |  |  |
| TIF Project ID   | 0                        | Total Value             | 23,040    | 23,040    |  | 2,765                   | Total Taxable | 2,765         | 218.00      |  |  |  |  |  |
| Assessment History   |                          |                         |           |           |  |                         |               |               |             |  |  |  |  |  |
| Tax Year   | Statement Number         | Billed Owner            |           |           | Tax Area   | Total Value             | Exemptions    | Taxable Value | Billed Tax  |  |  |  |  |  |
| 2025   | 2025-300004831           | OLMSTEAD, BILLY W. &    |           |           | 201  | 23,040                  | 0             | 2,765         | 218.00      |  |  |  |  |  |
| 2024   | 2024-300004831           | OLMSTEAD, BILLY W. &    |           |           | 201  | 24,357                  | 0             | 2,639         | 215.00      |  |  |  |  |  |
| 2023   | 2023-300004831           | OLMSTEAD, BILLY W. &    |           |           | 201  | 20,945                  | 0             | 2,513         | 208.00      |  |  |  |  |  |
| 2022   | 2022-300004831           | OLMSTEAD, BILLY W. &    |           |           | 201  | 20,945                  | 0             | 2,513         | 207.00      |  |  |  |  |  |
| 2021   | 2021-300004831           | OLMSTEAD, BILLY W. AND  |           |           | 201  | 20,945                  | 0             | 2,513         | 207.00      |  |  |  |  |  |
| 2020   | 2020-300004831           | OLMSTEAD, BILLY W. AND  |           |           | 201  | 20,945                  | 0             | 2,513         | 207.00      |  |  |  |  |  |
| 2019   | 2019-0004831             | POWELL, MARTON LEE, JR. |           |           | 201  | 20,945                  |               | 2,514         | 208.00      |  |  |  |  |  |
| 2018   | 2018-0004831             | POWELL, MARTON LEE, JR. |           |           | 201  | 20,945                  |               | 2,514         | 208.00      |  |  |  |  |  |
| 2017   | 2017-0004831             | POWELL, MARTON LEE, JR. |           |           | 201  | 20,945                  |               | 2,481         | 206.00      |  |  |  |  |  |
| 2016   | 2016-0004831             | POWELL, MARTON LEE, JR. |           |           | 201  | 20,945                  |               | 2,363         | 201.00      |  |  |  |  |  |
| 2015   | 2015-0004831             | POWELL, MARTON LEE, JR. |           |           | 201  | 18,753                  |               | 2,251         | 179.00      |  |  |  |  |  |
| 2014   | 2014-0004831             | POWELL, MARTON LEE, JR. |           |           | 201  | 18,753                  |               | 2,195         | 176.00      |  |  |  |  |  |
| 2013   | 2013-0004831             | POWELL, MARTON LEE, JR. |           |           | 201  | 17,420                  |               | 2,091         | 167.00      |  |  |  |  |  |



# Harper

## Assessment Property Record Card for Tax Year 2026

Data provided by SHAYLYN WEDER County Assessor

Date 02/06/2026  
 Time 06:58:08  
 Page 2

| Lot Data        |                        | Square-Foot - BUFFALO ORIGMILLERS |
|-----------------|------------------------|-----------------------------------|
| Lot Size        | 50                     | x 140                             |
| Lot Count       |                        |                                   |
| Units Buildable | 2100                   |                                   |
| Non-Ag Acres    |                        |                                   |
| Topography      |                        |                                   |
| Street Access   |                        |                                   |
| Utilities       |                        |                                   |
| Amenities       |                        |                                   |
| Method          | Square-Foot            |                                   |
| Base Lot Value  | 7,000.00 x .30 = 2,100 |                                   |
| Factor Value    |                        |                                   |
| Adjustments     |                        |                                   |
| Lot Value       | 2,100                  |                                   |



1001-00-023-014-0-001-00\_001.JPG 1/6/2023

| Residential Data |                                  |
|------------------|----------------------------------|
| Type             | 1 Single Family Residence        |
| Condition        | 1 - Low                          |
| Quality          | 1 - Low                          |
| Architecture     | TRAD TRADITIONAL                 |
| Style            | 100% One Story                   |
| Exterior Wall    | 100% Frame, Plywood or Hardboard |
| Base/Total Area  | 1,209 / 1,209                    |
| Style            | 100% One Story                   |
| HVAC             | 100% Warmed & Cooled Air         |
| Roof Cover       | 1 Composition Shingle            |
| Area on Slab     | 0                                |
| Fixture/RghIn    | 5 /                              |
| Bed/F/H Bath     | 2 / 1.0 /                        |
| Basement Area    |                                  |
| Garage Type      |                                  |
| Remodel          |                                  |
| Year/Eff Age     | 1940 / 120                       |

| GRM Approach    |  |
|-----------------|--|
| GRM Code        |  |
| Gross Rent      |  |
| Indicated Value |  |

| Multiple Regression |  |
|---------------------|--|
| MRA Code            |  |
| Adjusted R          |  |
| Indicated Value     |  |

| Direct Comparables |                                   |
|--------------------|-----------------------------------|
| Selection Model    | DEFAULT DEFAULT SELECTION MODEL   |
| Adjustment Model   | DEFAULT DEFAULT ADJUSTMENTS TABLE |
| Comparables        |                                   |
| Indicated Value    |                                   |

| Cost Approach |          | Manual :            |          |
|---------------|----------|---------------------|----------|
| Base Cost     | 64.12    | Total Misc Impr     | + 857    |
| Roofing Adj   | + 3.13   | Garage Cost         | + 0      |
| Subfloor Adj  | + 1.96   | Total RCN           | = 99,064 |
| Heat/Cool Adj | + 8.07   | Depreciation ( 80%) | - 79,251 |
| Plumbing Adj  | + 3.95   | Lump Sums           | + 0      |
| Basement Adj  | + 0.00   | RCNLD               | = 19,813 |
| Adj Base Cost | = 81.23  | Lot Value           | + 2,100  |
| Total Area    | x 1,209  | Indicated Value     | = 21,913 |
| Adjusted Cost | = 98,207 | Value Per SqFt      | 18.12    |

| Value Reconciliation |               |       |                      |
|----------------------|---------------|-------|----------------------|
| Selected Approach    | Cost Approach |       |                      |
| Improvements         | 19,813        |       |                      |
| Lot Value            | 2,100         |       |                      |
| Indicated Value      | 21,913        | 18.12 | Per SqFt             |
| Agland Value         |               |       |                      |
| Site Improvements    | 1,219         |       |                      |
| Total Value          | 23,132        | 19.13 | Total Value Per SqFt |

| Miscellaneous Improvements |                   |           |      |      |       |           |      |       |
|----------------------------|-------------------|-----------|------|------|-------|-----------|------|-------|
| Code                       | Description       | Sketch ID | Size | Year | Units | Unit Cost | Depr | Value |
| PATO                       | Slab Porch - Open | 2237      | 6x5  | 1940 | 30    | 7.79      |      | 234   |
| PATO                       | Slab Porch - Open | 2238      | 16x5 | 1940 | 80    | 7.79      |      | 623   |



Harper

Assessment Property Record Card for Tax Year 2026

Data provided by SHAYLYN WEDER County Assessor

Date 02/06/2026  
Time 06:58:08  
Page 3

Sketch Image

300004831

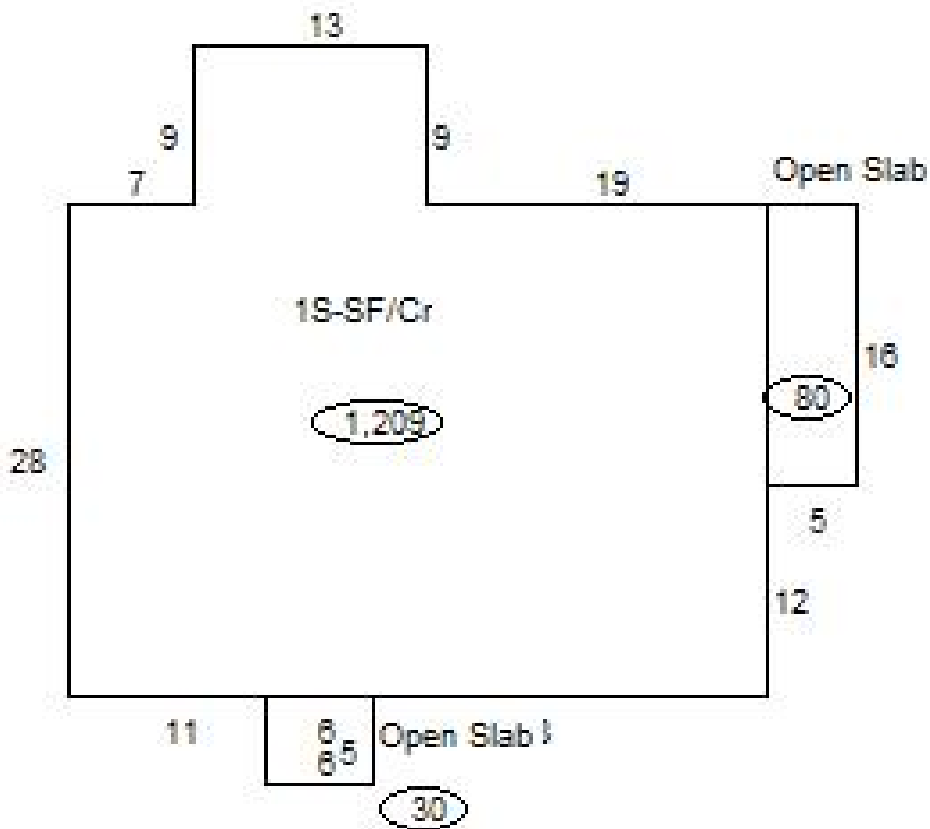

Sketch Vector Information

| Sequence                   | Code | Type | Built Over | Scale | Section Label | Base Area | Multiplier | Total Area |
|----------------------------|------|------|------------|-------|---------------|-----------|------------|------------|
| 1                          | R    | 1    | Crawl      | 20    | 1S-SF/Cr      | 1,209     | 1.000      | 1,209      |
| 2                          | M    | PATO |            | 20    | Open Slab     | 30        | 1.000      | 30         |
| 3                          | M    | PATO |            | 20    | Open Slab     | 80        | 1.000      | 80         |
| <b>Total Building Area</b> |      |      |            |       |               | 1,209     |            | 1,209      |



# Harper



## Assessment Property Record Card for Tax Year 2026

Data provided by SHAYLYN WEDER County Assessor

Date 02/06/2026  
Time 06:58:08  
Page 4

300004831

### Outbuildings/Site Improvements

| Building Image   | Code                     | Description        | Dimensions            | Floor      | Roofing                        | Total Units  |
|--|--------------------------|--------------------|-----------------------|------------|--------------------------------|--------------|
|  | SHDS                     | Yard Shed - Metal  | 14x10x6               |            | Formed Metal                   | 140          |
|  | Qual                     | 3                  | Cond 3                | Year 1990  | Eff Age 36                     |              |
|  | <b>Valuation Summary</b> |                    | <b>Modifier Total</b> | <b>RCN</b> | <b>Depr (80% Phys/ % Func)</b> | <b>RCNLD</b> |
|  | Base Cost (22.23 x 140)  |                    | 3,112                 | 3,112      | 2,490                          | 622          |
|  | CPDT                     | Carport - Detached | 22x20x8               |            | Galvanized Metal               | 440          |
|  | Qual                     | 2                  | Cond 2                | Year 1980  | Eff Age 55                     |              |
|  | <b>Valuation Summary</b> |                    | <b>Modifier Total</b> | <b>RCN</b> | <b>Depr (80% Phys/ % Func)</b> | <b>RCNLD</b> |
|  | Base Cost (6.78 x 440)   |                    | 2,983                 | 2,983      | 2,386                          | 597          |