



# Harper

## Assessment Property Record Card for Tax Year 2026

Data provided by SHAYLYN WEDER County Assessor

Date 02/06/2026  
 Time 06:59:01  
 Page 1

Assessment Data					Primary Image									
Account	300004892													
Parcel ID	1001-00-039-022-0-001-00													
Cadastral ID	1001-039-022-00-0-001-00													
Property Type	REAL - Real Property													
Property Class	UR	VI Area 1												
Tax Area	201 - 4T-BUFFALO-C													
Name ID	14414													
BARTH, ALETA M, ETAL														
BOX 441														
BUFFALO OK 73834-0000														
<b>Parcel Location</b>														
Situs	00703 SE FOURTH ST													
Subdivision	BUFFALO ORIG													
Lot/Block	0022 / 0039	Parcel Size 3 - Lots												
Sec/Twn/Rng	/ / /													
Neighborhood	100100 - BUFFALO ORIG/MILLERS													
School District	4-BUFFALO - 4-BUFFALO													
HOUSE 4/8/2019														
<b>Legal Description</b> Lat/Long: 36.82853416 -99.62848412														
BUFFALO ORIG. BLOCK 39 LOTS: 22-23-24														
<b>Building Permits</b>														
<table border="1"> <thead> <tr> <th>Number</th> <th>Description</th> <th>Opened</th> <th>Closed</th> <th>Amount</th> </tr> </thead> <tbody> <tr> <td> </td> <td> </td> <td> </td> <td> </td> <td> </td> </tr> </tbody> </table>					Number	Description	Opened	Closed	Amount					
Number	Description	Opened	Closed	Amount										
<b>Exemptions</b>														
Code	Type	Active	Maximum	Exemption										
H	Homestead	Yes	1,000	1,000										
<b>Sale History</b>														
<table border="1"> <thead> <tr> <th>Bk/Pg</th> <th>Grantor</th> <th>Date</th> <th>Price</th> <th>Code</th> </tr> </thead> <tbody> <tr> <td> </td> <td> </td> <td> </td> <td> </td> <td> </td> </tr> </tbody> </table>					Bk/Pg	Grantor	Date	Price	Code					
Bk/Pg	Grantor	Date	Price	Code										
<b>Parcel Valuation</b>														
Source	REAL	Fair Cash	Capped	Asmnt Level	Assessed	Levy Rate	78.740	Current Tax						
Remove Cap		Land Value	3,150	3,150	12%	378	Assessed	6,197 487.95						
Year Frozen		Improvements	49,432	48,494		5,819	Penalty	0						
Uncapped Value	0	Mobile Home	0	0		0	Exemption	1,000 -79.00						
TIF Project ID	0	Total Value	52,582	51,644		6,197	Total Taxable	5,197 409.00						
<b>Assessment History</b>														
Tax Year	Statement Number	Billed Owner	Tax Area	Total Value	Exemptions	Taxable Value	Billed Tax							
2025	2025-300004892	BARTH, ALETA M, ETAL	201	52,582	1000	5,016	395.00							
2024	2024-300004892	BARTH, ALETA M, ETAL	201	58,346	1000	4,841	394.00							
2023	2023-300004892	BARTH, ALETA M, ETAL	201	47,263	1000	4,672	386.00							
2022	2022-300004892	BARTH, ALETA M, ETAL	201	47,263	1000	4,672	384.00							
2021	2021-300004892	BARTH, ALETA M, ETAL	201	47,263	1000	4,672	386.00							
2020	2020-300004892	BARTH, ALETA M, ETAL	201	47,263	1000	4,542	374.00							
2019	2019-0004892	BARTH, ALETA M, ETAL	201	47,263		5,047	418.00							
2018	2018-0004892	BARTH, ALETA M, ETAL	201	47,263		4,891	406.00							
2017	2017-0004892	BARTH, ALETA M, ETAL	201	47,263		4,072	339.00							
2016	2016-0004892	BARTH, ALETA M, ETAL	201	47,263		3,925	334.00							
2015	2015-0004892	BARTH, ALETA M, ETAL	201	47,436		3,781	300.00							
2014	2014-0004892	BARTH, ALETA M, ETAL	201	47,436		3,642	292.00							
2013	2013-0004892	BARTH, ALETA M, ETAL	201	53,977		3,507	279.00							



# Harper

## Assessment Property Record Card for Tax Year 2026

Data provided by SHAYLYN WEDER County Assessor

Date 02/06/2026  
 Time 06:59:01  
 Page 2

Lot Data	Square-Foot - BUFFALO ORIGMILLERS	Primary Image
Lot Size	75 x 140	
Lot Count		
Units Buildable	3150	
Non-Ag Acres		
Topography		
Street Access		
Utilities		
Amenities		
Method	Square-Foot	
Base Lot Value	10,500.00 x .30 = 3,150	
Factor Value		
Adjustments		
Lot Value	3,150	

Residential Data	
Type	1 Single Family Residence
Condition	3 - Average
Quality	3 - Average
Architecture	TRAD TRADITIONAL
Style	100% One Story
Exterior Wall	100% Veneer, Masonry
Base/Total Area	1,894 / 1,894
Style	100% One Story
HVAC	100% Warmed & Cooled Air
Roof Cover	1 Composition Shingle
Area on Slab	0
Fixture/RghIn	8 /
Bed/F/H Bath	2 / 2.0 /
Basement Area	
Garage Type	
Remodel	
Year/Eff Age	1945 / 81

HOUSE	4/8/2019
-------	----------

GRM Approach	
GRM Code	
Gross Rent Indicated Value	

Multiple Regression	
MRA Code	
Adjusted R Indicated Value	

Direct Comparables	
Selection Model	DEFAULT DEFAULT SELECTION MODEL
Adjustment Model	DEFAULT DEFAULT ADJUSTMENTS TABLE
Comparables Indicated Value	

Value Reconciliation			
Selected Approach	Cost Approach		
Improvements	43,027		
Lot Value	3,150		
Indicated Value	46,177	24.38	Per SqFt
Agland Value			
Site Improvements	2,420		
Total Value	48,597	25.66	Total Value Per SqFt

Cost Approach		Manual :	
Base Cost	87.96	Total Misc Impr	+ 832
Roofing Adj	+ 3.84	Garage Cost	+ 0
Subfloor Adj	+ 0.00	Total RCN	= 204,892
Heat/Cool Adj	+ 10.77	Depreciation ( 79%)	- 161,865
Plumbing Adj	+ 5.17	Lump Sums	+ 0
Basement Adj	+ 0.00	RCNLD	= 43,027
Adj Base Cost	= 107.74	Lot Value	+ 3,150
Total Area	x 1,894	Indicated Value	= 46,177
Adjusted Cost	= 204,060	Value Per SqFt	24.38

Miscellaneous Improvements								
Code	Description	Sketch ID	Size	Year	Units	Unit Cost	Depr	Value
PATO	Slab Porch - Open	2325	5x5		25	9.78		245
PATO	Slab Porch - Open	2326	8x5		40	9.78		391
PATO	Slab Porch - Open	2327	5x4		20	9.78		196



Harper

Assessment Property Record Card for Tax Year 2026

Data provided by SHAYLYN WEDER County Assessor

Date 02/06/2026  
 Time 06:59:01  
 Page 3

Sketch Image

300004892

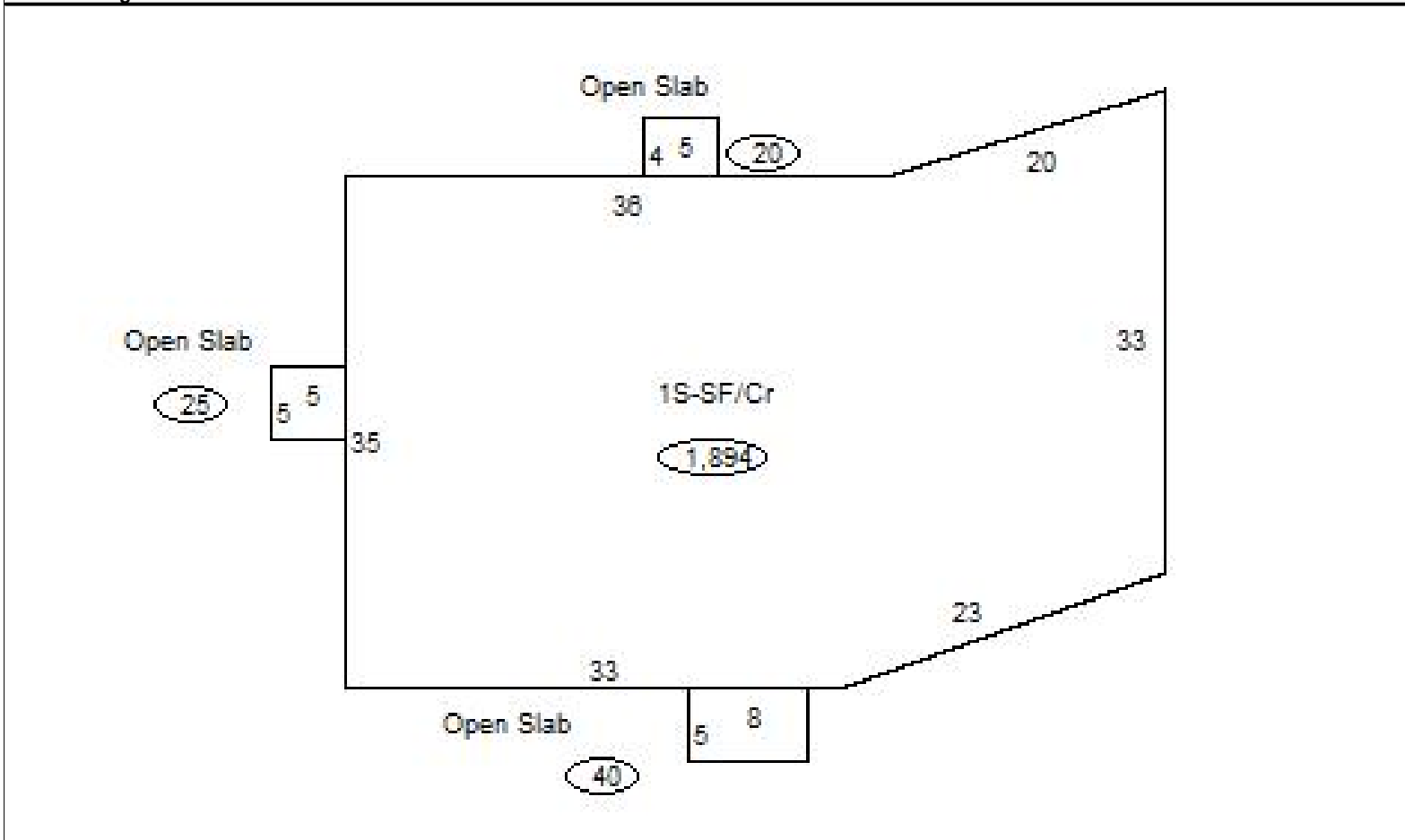

Sketch Vector Information

Sequence	Code	Type	Built Over	Scale	Section Label	Base Area	Multiplier	Total Area
1	R	1	Crawl	20	1S-SF/Cr	1,894	1.000	1,894
2	M	PATO		20	Open Slab	25	1.000	25
3	M	PATO		20	Open Slab	40	1.000	40
4	M	PATO		20	Open Slab	20	1.000	20
<b>Total Building Area</b>						1,894		1,894



# Harper

## Assessment Property Record Card for Tax Year 2026

Data provided by SHAYLYN WEDER County Assessor

Date 02/06/2026  
 Time 06:59:01  
 Page 4

300004892

### Outbuildings/Site Improvements

Building Image	Code	Description	Dimensions	Floor	Roofing	Total Units	
	CPDT	Carport - Detached	20x12x8		Formed Metal	240	
	Qual	3	Cond 3	Year 2003	Eff Age 23		
	<b>Valuation Summary</b>		<b>Modifier Total</b>		<b>RCN</b>	<b>Depr (75% Phys/ 0% Func)</b>	<b>RCNLD</b>
	Base Cost (8.04 x 240)	1,930			1,930	1,448	482
	SHDS	Shed - Small	12x24x8		Formed Metal	288	
	Qual	3	Cond 3	Year 1995	Eff Age 31		
	<b>Valuation Summary</b>		<b>Modifier Total</b>		<b>RCN</b>	<b>Depr (78% Phys/ 0% Func)</b>	<b>RCNLD</b>
	Base Cost (18.87 x 288)	5,435			5,435	4,239	1,196
	PACN	Paving - Concrete / WEST SIDEWALK	25x3x0			75	
	Qual	3	Cond 3	Year 1945	Eff Age 81		
	<b>Valuation Summary</b>		<b>Modifier Total</b>		<b>RCN</b>	<b>Depr (80% Phys/ % Func)</b>	<b>RCNLD</b>
	Base Cost (7.43 x 75)	557			557	446	111
	PACN	Paving - Concrete / DRIVEWAY	32x24x0			768	
	Qual	3	Cond 3	Year 1945	Eff Age 81		
	<b>Valuation Summary</b>		<b>Modifier Total</b>		<b>RCN</b>	<b>Depr (80% Phys/ % Func)</b>	<b>RCNLD</b>
	Base Cost (4.11 x 768)	3,156			3,156	2,525	631