



Harper

Assessment Property Record Card for Tax Year 2026

Data provided by SHAYLYN WEDER County Assessor

Date 02/06/2026
 Time 07:01:08
 Page 1

Assessment Data					Primary Image																																																																																																																				
Account 300005039 Parcel ID 1070-00-106-024-0-001-00 Cadastral ID 1070-106-024-00-0-001-00 Property Type REAL - Real Property Property Class UR VI Area 4 Tax Area 201 - 4T-BUFFALO-C Name ID 14502 LAUER, SONNY AND LACEY LAUER % RUBY LOAIZA P.O. BOX 862 BUFFALO OK 73834-0000																																																																																																																									
Parcel Location Situs 00326 SW SECOND ST Subdivision MILLER'S ADDN Lot/Block 0024 / 0106 Parcel Size 3 - Lots Sec/Twn/Rng / / / Neighborhood 100100 - BUFFALO ORIG/MILLERS School District 4-BUFFAL - 4-BUFFALO																																																																																																																									
Legal Description Lat/Long: 36.83710309 -99.63292698 MILLERS ADD BLOCK 106 LOTS 24-26-28					Building Permits <table border="1"> <thead> <tr> <th>Number</th> <th>Description</th> <th>Opened</th> <th>Closed</th> <th>Amount</th> </tr> </thead> <tbody> <tr> <td> </td> <td> </td> <td> </td> <td> </td> <td> </td> </tr> </tbody> </table>					Number	Description	Opened	Closed	Amount																																																																																																											
Number	Description	Opened	Closed	Amount																																																																																																																					
Exemptions <table border="1"> <thead> <tr> <th>Code</th> <th>Type</th> <th>Active</th> <th>Maximum</th> <th>Exemption</th> </tr> </thead> <tbody> <tr> <td> </td> <td> </td> <td> </td> <td> </td> <td> </td> </tr> </tbody> </table>					Code	Type	Active	Maximum	Exemption						Sale History <table border="1"> <thead> <tr> <th>Bk/Pg</th> <th>Grantor</th> <th>Date</th> <th>Price</th> <th>Code</th> </tr> </thead> <tbody> <tr> <td>647/217</td> <td>MCVICKER, MARGARET M.</td> <td>01/02/2009</td> <td>18,000</td> <td>Q</td> </tr> </tbody> </table>					Bk/Pg	Grantor	Date	Price	Code	647/217	MCVICKER, MARGARET M.	01/02/2009	18,000	Q																																																																																												
Code	Type	Active	Maximum	Exemption																																																																																																																					
Bk/Pg	Grantor	Date	Price	Code																																																																																																																					
647/217	MCVICKER, MARGARET M.	01/02/2009	18,000	Q																																																																																																																					
Parcel Valuation <table border="1"> <thead> <tr> <th>Source</th> <th>REAL</th> <th>Fair Cash</th> <th>Capped</th> <th>Asmnt Level</th> <th>Assessed</th> <th>Levy Rate</th> <th>78.740</th> <th>Current Tax</th> </tr> </thead> <tbody> <tr> <td>Remove Cap</td> <td> </td> <td>Land Value 2,644</td> <td>2,644</td> <td>12%</td> <td>317</td> <td>Assessed</td> <td>3,743</td> <td>294.72</td> </tr> <tr> <td>Year Frozen</td> <td> </td> <td>Improvements 28,552</td> <td>28,552</td> <td> </td> <td>3,426</td> <td>Penalty</td> <td>0</td> <td> </td> </tr> <tr> <td>Uncapped Value</td> <td>0</td> <td>Mobile Home 0</td> <td>0</td> <td> </td> <td>0</td> <td>Exemption</td> <td>0</td> <td>0.00</td> </tr> <tr> <td>TIF Project ID</td> <td>0</td> <td>Total Value 31,196</td> <td>31,196</td> <td> </td> <td>3,743</td> <td>Total Taxable</td> <td>3,743</td> <td>295.00</td> </tr> </tbody> </table>										Source	REAL	Fair Cash	Capped	Asmnt Level	Assessed	Levy Rate	78.740	Current Tax	Remove Cap		Land Value 2,644	2,644	12%	317	Assessed	3,743	294.72	Year Frozen		Improvements 28,552	28,552		3,426	Penalty	0		Uncapped Value	0	Mobile Home 0	0		0	Exemption	0	0.00	TIF Project ID	0	Total Value 31,196	31,196		3,743	Total Taxable	3,743	295.00																																																																			
Source	REAL	Fair Cash	Capped	Asmnt Level	Assessed	Levy Rate	78.740	Current Tax																																																																																																																	
Remove Cap		Land Value 2,644	2,644	12%	317	Assessed	3,743	294.72																																																																																																																	
Year Frozen		Improvements 28,552	28,552		3,426	Penalty	0																																																																																																																		
Uncapped Value	0	Mobile Home 0	0		0	Exemption	0	0.00																																																																																																																	
TIF Project ID	0	Total Value 31,196	31,196		3,743	Total Taxable	3,743	295.00																																																																																																																	
Assessment History <table border="1"> <thead> <tr> <th>Tax Year</th> <th>Statement Number</th> <th>Billed Owner</th> <th>Tax Area</th> <th>Total Value</th> <th>Exemptions</th> <th>Taxable Value</th> <th>Billed Tax</th> </tr> </thead> <tbody> <tr><td>2025</td><td>2025-300005039</td><td>LAUER, SONNY AND</td><td>201</td><td>31,196</td><td>0</td><td>3,743</td><td>295.00</td></tr> <tr><td>2024</td><td>2024-300005039</td><td>LAUER, SONNY AND</td><td>201</td><td>33,268</td><td>0</td><td>3,666</td><td>299.00</td></tr> <tr><td>2023</td><td>2023-300005039</td><td>LAUER, SONNY AND</td><td>201</td><td>30,520</td><td>0</td><td>3,491</td><td>289.00</td></tr> <tr><td>2022</td><td>2022-300005039</td><td>LAUER, LACEY &</td><td>201</td><td>27,713</td><td>0</td><td>3,325</td><td>274.00</td></tr> <tr><td>2021</td><td>2021-300005039</td><td>LAUER, LACEY AND</td><td>201</td><td>27,713</td><td>0</td><td>3,325</td><td>275.00</td></tr> <tr><td>2020</td><td>2020-300005039</td><td>LAUER, LACEY AND</td><td>201</td><td>27,713</td><td>0</td><td>3,325</td><td>274.00</td></tr> <tr><td>2019</td><td>2019-0005039</td><td>LAUER, LACEY AND</td><td>201</td><td>27,713</td><td> </td><td>3,325</td><td>276.00</td></tr> <tr><td>2018</td><td>2018-0005039</td><td>LAUER, LACEY AND</td><td>201</td><td>27,713</td><td> </td><td>3,325</td><td>276.00</td></tr> <tr><td>2017</td><td>2017-0005039</td><td>LAUER, LACEY AND</td><td>201</td><td>27,713</td><td> </td><td>3,191</td><td>265.00</td></tr> <tr><td>2016</td><td>2016-0005039</td><td>LAUER, LACEY AND</td><td>201</td><td>27,713</td><td> </td><td>3,039</td><td>259.00</td></tr> <tr><td>2015</td><td>2015-0005039</td><td>LAUER, LACEY AND</td><td>201</td><td>27,811</td><td> </td><td>2,894</td><td>230.00</td></tr> <tr><td>2014</td><td>2014-0005039</td><td>LAUER, LACEY AND</td><td>201</td><td>27,811</td><td> </td><td>2,756</td><td>221.00</td></tr> <tr><td>2013</td><td>2013-0005039</td><td>LAUER, LACEY AND</td><td>201</td><td>27,471</td><td> </td><td>2,625</td><td>209.00</td></tr> </tbody> </table>										Tax Year	Statement Number	Billed Owner	Tax Area	Total Value	Exemptions	Taxable Value	Billed Tax	2025	2025-300005039	LAUER, SONNY AND	201	31,196	0	3,743	295.00	2024	2024-300005039	LAUER, SONNY AND	201	33,268	0	3,666	299.00	2023	2023-300005039	LAUER, SONNY AND	201	30,520	0	3,491	289.00	2022	2022-300005039	LAUER, LACEY &	201	27,713	0	3,325	274.00	2021	2021-300005039	LAUER, LACEY AND	201	27,713	0	3,325	275.00	2020	2020-300005039	LAUER, LACEY AND	201	27,713	0	3,325	274.00	2019	2019-0005039	LAUER, LACEY AND	201	27,713		3,325	276.00	2018	2018-0005039	LAUER, LACEY AND	201	27,713		3,325	276.00	2017	2017-0005039	LAUER, LACEY AND	201	27,713		3,191	265.00	2016	2016-0005039	LAUER, LACEY AND	201	27,713		3,039	259.00	2015	2015-0005039	LAUER, LACEY AND	201	27,811		2,894	230.00	2014	2014-0005039	LAUER, LACEY AND	201	27,811		2,756	221.00	2013	2013-0005039	LAUER, LACEY AND	201	27,471		2,625	209.00
Tax Year	Statement Number	Billed Owner	Tax Area	Total Value	Exemptions	Taxable Value	Billed Tax																																																																																																																		
2025	2025-300005039	LAUER, SONNY AND	201	31,196	0	3,743	295.00																																																																																																																		
2024	2024-300005039	LAUER, SONNY AND	201	33,268	0	3,666	299.00																																																																																																																		
2023	2023-300005039	LAUER, SONNY AND	201	30,520	0	3,491	289.00																																																																																																																		
2022	2022-300005039	LAUER, LACEY &	201	27,713	0	3,325	274.00																																																																																																																		
2021	2021-300005039	LAUER, LACEY AND	201	27,713	0	3,325	275.00																																																																																																																		
2020	2020-300005039	LAUER, LACEY AND	201	27,713	0	3,325	274.00																																																																																																																		
2019	2019-0005039	LAUER, LACEY AND	201	27,713		3,325	276.00																																																																																																																		
2018	2018-0005039	LAUER, LACEY AND	201	27,713		3,325	276.00																																																																																																																		
2017	2017-0005039	LAUER, LACEY AND	201	27,713		3,191	265.00																																																																																																																		
2016	2016-0005039	LAUER, LACEY AND	201	27,713		3,039	259.00																																																																																																																		
2015	2015-0005039	LAUER, LACEY AND	201	27,811		2,894	230.00																																																																																																																		
2014	2014-0005039	LAUER, LACEY AND	201	27,811		2,756	221.00																																																																																																																		
2013	2013-0005039	LAUER, LACEY AND	201	27,471		2,625	209.00																																																																																																																		



Harper

Assessment Property Record Card for Tax Year 2026

Data provided by SHAYLYN WEDER County Assessor

Date 02/06/2026
 Time 07:01:09
 Page 2

Lot Data	Square-Foot - BUFFALO ORIGMILLERS	Primary Image
Lot Size	75 x 117.5	
Lot Count		
Units Buildable	2644	
Non-Ag Acres		
Topography		
Street Access		
Utilities		
Amenities		
Method	Square-Foot	
Base Lot Value	8,812.50 x .30 = 2,644	
Factor Value		
Adjustments		
Lot Value	2,644	

Residential Data	
Type	1 Single Family Residence
Condition	2 - Fair
Quality	3 - Average
Architecture	TRAD TRADITIONAL
Style	100% One Story
Exterior Wall	100% Asbestos Siding
Base/Total Area	1,264 / 1,264
Style	100% One Story
HVAC	100% Floor Furnace 1 Wall Air Conditioners (Cour
Roof Cover	1 Composition Shingle
Area on Slab	1,264
Fixture/RghIn	5 /
Bed/F/H Bath	2 / 1.0 /
Basement Area	
Garage Type	
Remodel	
Year/Eff Age	1950 / 91



GRM Approach	
GRM Code	
Gross Rent	
Indicated Value	

Multiple Regression	
MRA Code	
Adjusted R	
Indicated Value	

Direct Comparables	
Selection Model	DEFAULT DEFAULT SELECTION MODEL
Adjustment Model	DEFAULT DEFAULT ADJUSTMENTS TABLE
Comparables	
Indicated Value	

Cost Approach		Manual :	
Base Cost	83.47	Total Misc Impr	+ 4,437
Roofing Adj	+ 4.12	Garage Cost	+ 0
Subfloor Adj	+ -1.96	Total RCN	= 121,231
Heat/Cool Adj	+ 1.73	Depreciation (80%)	- 96,985
Plumbing Adj	+ 5.04	Lump Sums	+ 0
Basement Adj	+ 0.00	RCNLD	= 24,246
Adj Base Cost	= 92.40	Lot Value	+ 2,644
Total Area	x 1,264	Indicated Value	= 26,890
Adjusted Cost	= 116,794	Value Per SqFt	21.27

Value Reconciliation			
Selected Approach	Cost Approach		
Improvements	24,246		
Lot Value	2,644		
Indicated Value	26,890	21.27	Per SqFt
Agland Value			
Site Improvements	4,417		
Total Value	31,307	24.77	Total Value Per SqFt

Miscellaneous Improvements							
Code	Description	Sketch ID	Size	Year	Units	Unit Cost	Depr Value
PRCH	Slab Porch - Covered	2664	22x9		198	22.41	4,437



Harper

Assessment Property Record Card for Tax Year 2026

Data provided by SHAYLYN WEDER County Assessor

Date 02/06/2026

Time 07:01:09

Page 3

Sketch Image

300005039

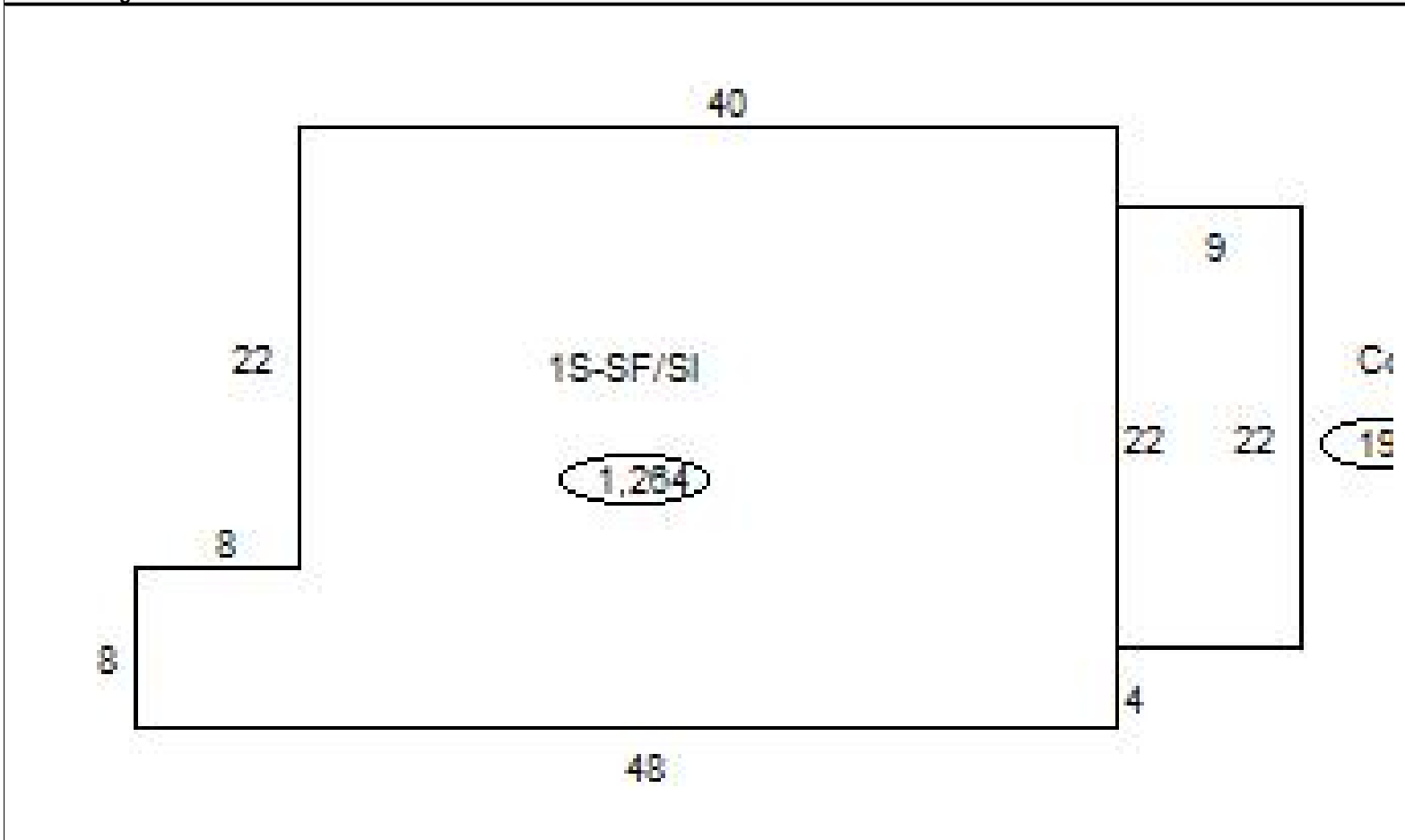

Sketch Vector Information

Sequence	Code	Type	Built Over	Scale	Section Label	Base Area	Multiplier	Total Area
1	R	1	Slab	20	1S-SF/SI	1,264	1.000	1,264
2	M	PRCH		20	Covered Slab	198	1.000	198
Total Building Area						1,264		1,264



Harper

Assessment Property Record Card for Tax Year 2026

Data provided by SHAYLYN WEDER County Assessor

Date 02/06/2026
Time 07:01:09
Page 4

300005039

Outbuildings/Site Improvements

Building Image	Code	Description	Dimensions	Floor	Roofing	Total Units
	GRDT	Garage - Detached	24x15x10	Concrete	Formed Metal	360
	Qual 3	Cond 3	Year 1980	Eff Age 46		
		Valuation Summary	Modifier Total	RCN	Depr (69% Phys/ % Func)	RCNLD
		Base Cost (39.58 x 360)	14,249	14,249	9,832	4,417