



Harper

Assessment Property Record Card for Tax Year 2026

Data provided by SHAYLYN WEDER County Assessor

Date 02/06/2026
 Time 07:01:49
 Page 1

Assessment Data					Primary Image									
Account	300005085													
Parcel ID	1070-00-112-006-0-001-00													
Cadastral ID	1070-112-006-00-0-001-00													
Property Type	REAL - Real Property													
Property Class	UR	VI Area 4												
Tax Area	201 - 4T-BUFFALO-C													
Name ID	14531													
HELMUTH, CHRIS														
P O BOX 8														
BUFFALO OK 73834-0000														
Parcel Location														
Situs	00210 SW FIRST ST													
Subdivision	MILLER'S ADDN													
Lot/Block	0006 / 0112	Parcel Size 4 - Lots												
Sec/Twn/Rng	/ / /													
Neighborhood	100100 - BUFFALO ORIG/MILLERS													
School District	4-BUFFAL - 4-BUFFALO													
1 3/2/2022														
Legal Description Lat/Long: 36.83596885 -99.63362716														
MILLERS ADD. BLOCK 112 LOTS 6-8-10-12 BOOK 592 PAGE 300														
Building Permits														
<table border="1"> <thead> <tr> <th>Number</th> <th>Description</th> <th>Opened</th> <th>Closed</th> <th>Amount</th> </tr> </thead> <tbody> <tr> <td> </td> <td> </td> <td> </td> <td> </td> <td> </td> </tr> </tbody> </table>					Number	Description	Opened	Closed	Amount					
Number	Description	Opened	Closed	Amount										
Exemptions														
Sale History														
Code	Type	Active	Maximum	Exemption	Bk/Pg	Grantor	Date	Price	Code					
					592/300	CLARK, KATHE	10/11/2000	3,000	U					
					519/254	TAYLOR, STEPHEN L.,	10/21/1996	5,000	PQ					
					510/91	HARPER, GENE E. ETUX	09/10/1995	10,500	PQ					
Parcel Valuation														
Source	REAL	Fair Cash	Capped	Asmnt Level	Assessed	Levy Rate	78.740	Current Tax						
Remove Cap	0	Land Value	3,526	3,526	12%	423	Assessed	7,328	577.01					
Year Frozen		Improvements	68,774	57,549		6,905	Penalty	0						
Uncapped Value	0	Mobile Home	0	0		0	Exemption	0	0.00					
TIF Project ID	0	Total Value	72,300	61,075		7,328	Total Taxable	7,328	577.00					
Assessment History														
Tax Year	Statement Number	Billed Owner	Tax Area	Total Value	Exemptions	Taxable Value	Billed Tax							
2025	2025-300005085	HELMUTH, CHRIS	201	72,300	0	6,979	550.00							
2024	2024-300005085	HELMUTH, CHRIS	201	76,580	0	6,647	541.00							
2023	2023-300005085	HELMUTH, CHRIS	201	60,574	0	6,331	524.00							
2022	2022-300005085	HELMUTH, CHRIS	201	50,248	0	6,030	496.00							
2021	2021-300005085	HELMUTH, CHRIS	201	50,248	0	6,030	498.00							
2020	2020-300005085	HELMUTH, CHRIS	201	50,248	0	6,030	496.00							
2019	2019-0005085	HELMUTH, CHRIS	201	50,248		6,029	500.00							
2018	2018-0005085	HELMUTH, CHRIS	201	44,977		5,354	444.00							
2017	2017-0005085	HELMUTH, CHRIS	201	36,244		3,649	303.00							
2016	2016-0005085	HELMUTH, CHRIS	201	36,244		3,476	296.00							
2015	2015-0005085	HELMUTH, CHRIS	201	36,360		3,310	263.00							
2014	2014-0005085	HELMUTH, CHRIS	201	34,132		2,897	232.00							
2013	2013-0005085	HELMUTH, CHRIS	201	30,407		2,760	220.00							



Harper

Assessment Property Record Card for Tax Year 2026

Data provided by SHAYLYN WEDER County Assessor

Date 02/06/2026
 Time 07:01:49
 Page 2

Lot Data	Square-Foot - BUFFALO ORIGMILLERS	Primary Image
Lot Size	0 0	
Lot Count		
Units Buildable	3526	
Non-Ag Acres		
Topography		
Street Access		
Utilities		
Amenities		
Method	Square-Foot	
Base Lot Value	11,752.00 x .30 = 3,526	
Factor Value		
Adjustments		
Lot Value	3,526	

Residential Data	
Type	1 Single Family Residence
Condition	3 - Average
Quality	3 - Average
Architecture	TRAD TRADITIONAL
Style	100% 1 1/2 Story Finished
Exterior Wall	100% Frame, Siding, Wood
Base/Total Area	1,036 / 1,295
Style	100% 1 1/2 Story Finished
HVAC	100% Warmed & Cooled Air
Roof Cover	1 Composition Shingle
Area on Slab	0
Fixture/RghIn	5 /
Bed/F/H Bath	2 / 1.0 /
Basement Area	80 Total, 80 Minimum
Garage Type	
Remodel	PARTIAL -
Year/Eff Age	1935 / 69

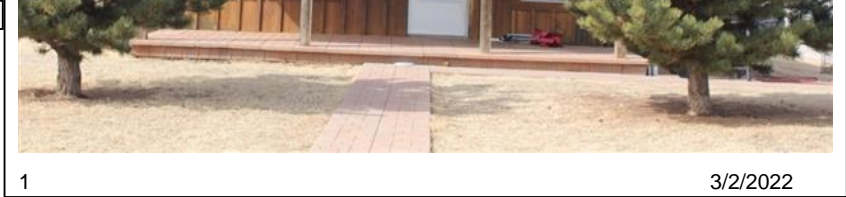

1 3/2/2022

GRM Approach	
GRM Code	
Gross Rent	
Indicated Value	

Multiple Regression	
MRA Code	
Adjusted R	
Indicated Value	

Direct Comparables	
Selection Model	DEFAULT DEFAULT SELECTION MODEL
Adjustment Model	DEFAULT DEFAULT ADJUSTMENTS TABLE
Comparables	
Indicated Value	

Value Reconciliation			
Selected Approach	Cost Approach		
Improvements	43,578		
Lot Value	3,526		
Indicated Value	47,104	36.37	Per SqFt
Agland Value			
Site Improvements	23,830		
Total Value	70,934	54.78	Total Value Per SqFt

Cost Approach		Manual :	
Base Cost	79.94	Total Misc Impr	+ 8,536
Roofing Adj	+ 3.50	Garage Cost	+
Subfloor Adj	+ 0.00	Total RCN	= 140,574
Heat/Cool Adj	+ 10.77	Depreciation (69%)	- 96,996
Plumbing Adj	+ 4.93	Lump Sums	+ 0
Basement Adj	+ 2.81	RCNLD	= 43,578
Adj Base Cost	= 101.96	Lot Value	+ 3,526
Total Area	x 1,295	Indicated Value	= 47,104
Adjusted Cost	= 132,038	Value Per SqFt	36.37

Miscellaneous Improvements							
Code	Description	Sketch ID	Size	Year	Units	Unit Cost	Depr Value
RSPC	Raised Slab Porch - Covered	2761	24x9		216	39.52	8,536



Harper

Assessment Property Record Card for Tax Year 2026

Data provided by SHAYLYN WEDER County Assessor

Date 02/06/2026
Time 07:01:49
Page 3

Sketch Image

300005085

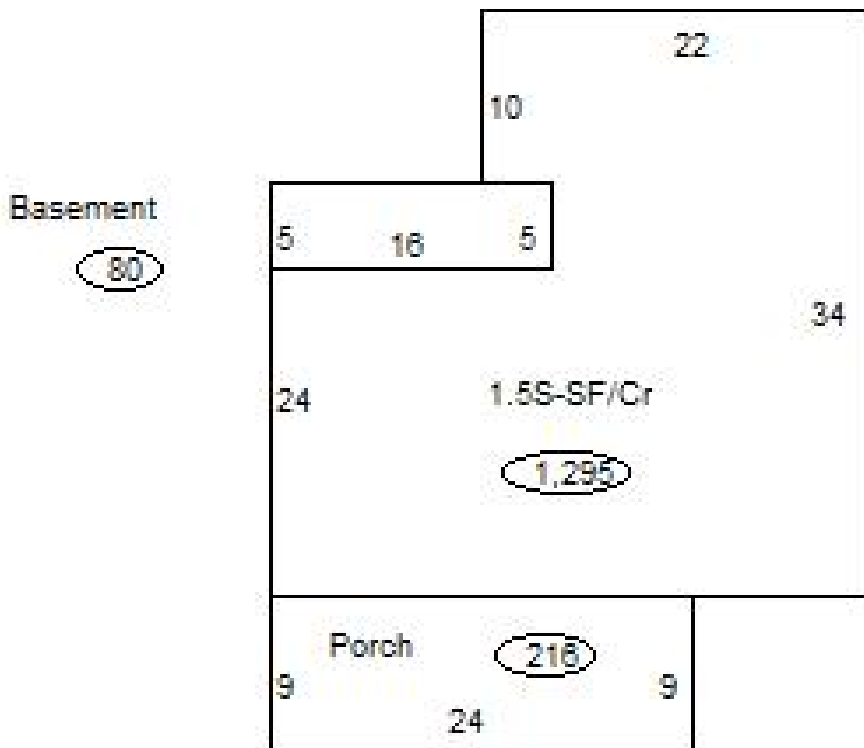

Sketch Vector Information

Sequence	Code	Type	Built Over	Scale	Section Label	Base Area	Multiplier	Total Area
1	R	5	Crawl	20	1.5S-SF/Cr	1,036	1.250	1,295
2	B	1		20	Basement	80	1.000	80
3	M	RSPC		20	Porch	216	1.000	216
Total Building Area						1,036		1,295



Harper

Assessment Property Record Card for Tax Year 2026

Data provided by SHAYLYN WEDER County Assessor

Date 02/06/2026
Time 07:01:49
Page 4

300005085

Outbuildings/Site Improvements

Building Image	Code	Description	Dimensions	Floor	Roofing	Total Units
	UTIL	Utility Building	30x30x20		Formed Metal	900
	Qual 3	Cond 3	Year 2018	Eff Age 8		
		Valuation Summary	Modifier Total	RCN	Depr (15% Phys/ % Func)	RCNLD
		Base Cost (31.15 x 900)	28,035	28,035	4,205	23,830