



# Harper

## Assessment Property Record Card for Tax Year 2026

Data provided by SHAYLYN WEDER County Assessor

Date 02/06/2026  
 Time 07:02:06  
 Page 1

Assessment Data					Primary Image																			
Account	300005103				<p>1070-00-125-001-0-001-00            3/29/2022            ACCT. #5103</p> <p>1 3/30/2022</p>																			
Parcel ID	1070-00-125-001-0-001-00																							
Cadastral ID	1070-125-001-00-0-001-00																							
Property Type	REAL - Real Property																							
Property Class	UR	VI Area 4																						
Tax Area	201 - 4T-BUFFALO-C																							
Name ID	14542																							
INDERLIED, MIKALE F. & BRENT INDERLIED																								
316 W TURNER BUFFALO OK 73834-0000																								
Parcel Location																								
Situs	00316 W TURNER ST																							
Subdivision	MILLER'S ADDN																							
Lot/Block	0001 / 0125	Parcel Size 4 - Lots																						
Sec/Twn/Rng	/ / /																							
Neighborhood	100100 - BUFFALO ORIG/MILLERS																							
School District	4-BUFFAL - 4-BUFFALO																							
Legal Description Lat/Long: 36.83390060 -99.62479555																								
MILLERS ADD. BLOCK 125, LOTS: 1-2; W 100' OF 11 LESS 12'X 15' OF NE PART; W 100' OF 13																								
Building Permits																								
<table border="1"> <thead> <tr> <th>Number</th> <th>Description</th> <th>Opened</th> <th>Closed</th> <th>Amount</th> </tr> </thead> <tbody> <tr> <td> </td> <td> </td> <td> </td> <td> </td> <td> </td> </tr> </tbody> </table>					Number	Description	Opened	Closed	Amount															
Number	Description	Opened	Closed	Amount																				
Exemptions																								
<table border="1"> <thead> <tr> <th>Code</th> <th>Type</th> <th>Active</th> <th>Maximum</th> <th>Exemption</th> <th>Bk/Pg</th> <th>Grantor</th> <th>Date</th> <th>Price</th> <th>Code</th> </tr> </thead> <tbody> <tr> <td>H</td> <td>Homestead</td> <td>Yes</td> <td>1,000</td> <td>1,000</td> <td>548/513</td> <td>ROESNER, LEETA J. ET VIR.</td> <td>08/31/1999</td> <td>20,000</td> <td>Q</td> </tr> </tbody> </table>					Code	Type	Active	Maximum	Exemption	Bk/Pg	Grantor	Date	Price	Code	H	Homestead	Yes	1,000	1,000	548/513	ROESNER, LEETA J. ET VIR.	08/31/1999	20,000	Q
Code	Type	Active	Maximum	Exemption	Bk/Pg	Grantor	Date	Price	Code															
H	Homestead	Yes	1,000	1,000	548/513	ROESNER, LEETA J. ET VIR.	08/31/1999	20,000	Q															
Sale History																								
Parcel Valuation																								
Source	REAL	Fair Cash	Capped	Asmnt Level	Assessed	Levy Rate	78.740	Current Tax																
Remove Cap		Land Value	2,946	2,946	12%	354	Assessed	4,203	330.94															
Year Frozen		Improvements	33,769	32,070		3,849	Penalty	0																
Uncapped Value	0	Mobile Home	0	0		0	Exemption	1,000	-79.00															
TIF Project ID	0	Total Value	36,715	35,016		4,203	Total Taxable	3,203	252.00															
Assessment History																								
Tax Year	Statement Number	Billed Owner			Tax Area	Total Value	Exemptions	Taxable Value	Billed Tax															
2025	2025-300005103	INDERLIED, MIKALE F. &			201	36,715	1000	3,080	243.00															
2024	2024-300005103	INDERLIED, MIKALE F. &			201	40,774	1000	2,962	241.00															
2023	2023-300005103	INDERLIED, MIKALE F. &			201	38,539	1000	2,846	235.00															
2022	2022-300005103	INDERLIED, MIKALE F. &			201	31,113	1000	2,734	225.00															
2021	2021-300005103	INDERLIED, MIKALE F. &			201	31,113	1000	2,734	226.00															
2020	2020-300005103	INDERLIED, MIKALE F. &			201	31,113	1000	2,695	222.00															
2019	2019-0005103	INDERLIED, MIKALE F. &			201	31,113		2,588	214.00															
2018	2018-0005103	INDERLIED, MIKALE F. &			201	31,113		2,484	206.00															
2017	2017-0005103	INDERLIED, MIKALE F. &			201	31,113		2,382	198.00															
2016	2016-0005103	INDERLIED, MIKALE F. &			201	31,113		2,284	194.00															
2015	2015-0005103	INDERLIED, MIKALE F. &			201	31,218		2,188	174.00															
2014	2014-0005103	INDERLIED, MIKALE F. &			201	31,218		2,096	168.00															
2013	2013-0005103	INDERLIED, MIKALE F. &			201	31,559		2,005	160.00															



# Harper

## Assessment Property Record Card for Tax Year 2026

Data provided by SHAYLYN WEDER County Assessor

Date 02/06/2026  
 Time 07:02:06  
 Page 2

Lot Data		Square-Foot - BUFFALO ORIGMILLERS	
Lot Size	0	0	
Lot Count			
Units Buildable	2946		
Non-Ag Acres			
Topography			
Street Access			
Utilities			
Amenities			
Method	Square-Foot		
Base Lot Value	9,820.00 x .30 = 2,946		
Factor Value			
Adjustments			
Lot Value	2,946		



Residential Data	
Type	1 Single Family Residence
Condition	2.75 - Fair
Quality	3 - Average
Architecture	TRAD TRADITIONAL
Style	100% One Story
Exterior Wall	100% Frame, Plywood or Hardboard
Base/Total Area	1,240 / 1,240
Style	100% One Story
HVAC	100% Warmed & Cooled Air
Roof Cover	1 Composition Shingle
Area on Slab	0
Fixture/RghIn	5 /
Bed/F/H Bath	3 / 1.0 /
Basement Area	
Garage Type	
Remodel	
Year/Eff Age	1948 / 82

GRM Approach	
GRM Code	
Gross Rent	
Indicated Value	

Multiple Regression	
MRA Code	
Adusted R	
Indicated Value	

Direct Comparables	
Selection Model	DEFAULT DEFAULT SELECTION MODEL
Adjustment Model	DEFAULT DEFAULT ADJUSTMENTS TABLE
Comparables	
Indicated Value	

Cost Approach		Manual :	
Base Cost	85.69	Total Misc Impr	+ 1,935
Roofing Adj	+ 4.15	Garage Cost	+
Subfloor Adj	+ 0.00	Total RCN	= 133,065
Heat/Cool Adj	+ 10.77	Depreciation ( 80%)	- 106,452
Plumbing Adj	+ 5.14	Lump Sums	+ 0
Basement Adj	+ 0.00	RCNLD	= 26,613
Adj Base Cost	= 105.75	Lot Value	+ 2,946
Total Area	x 1,240	Indicated Value	= 29,559
Adjusted Cost	= 131,130	Value Per SqFt	23.84

Value Reconciliation			
Selected Approach	Cost Approach		
Improvements	26,613		
Lot Value	2,946		
Indicated Value	29,559	23.84	Per SqFt
Agland Value			
Site Improvements	5,997		
Total Value	35,556	28.67	Total Value Per SqFt

Miscellaneous Improvements								
Code	Description	Sketch ID	Size	Year	Units	Unit Cost	Depr	Value
PATO	OPEN PORCH	2807	28x8		224	8.64		1,935



Harper

Assessment Property Record Card for Tax Year 2026

Data provided by SHAYLYN WEDER County Assessor

Date 02/06/2026  
 Time 07:02:06  
 Page 3

Sketch Image

300005103

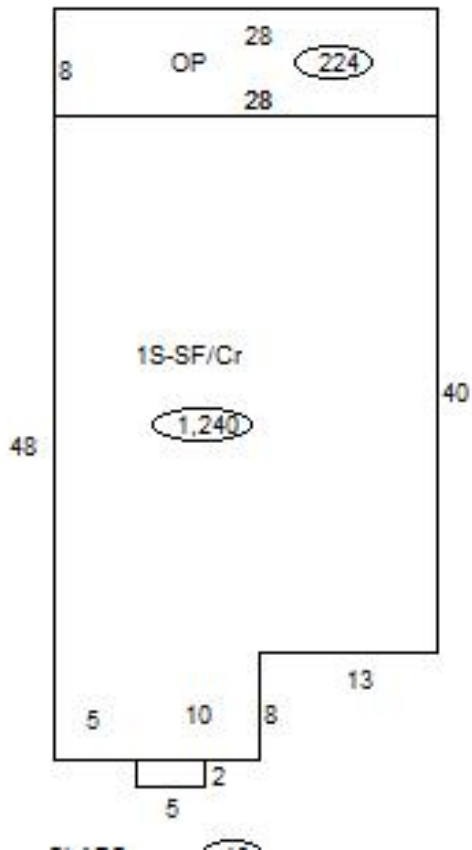

Sketch Vector Information

Sequence	Code	Type	Built Over	Scale	Section Label	Base Area	Multiplier	Total Area
1	M	PATO		20	OP	224	1.000	224
2	O	PATO		20	SLABS	10	1.000	10
3	R	1	Crawl	20	1S-SF/Cr	1,240	1.000	1,240
<b>Total Building Area</b>						<b>1,240</b>		<b>1,240</b>



# Harper

## Assessment Property Record Card for Tax Year 2026

Data provided by SHAYLYN WEDER County Assessor

Date 02/06/2026

Time 07:02:06

Page 4

300005103

### Outbuildings/Site Improvements

Building Image	Code	Description	Dimensions	Floor	Roofing	Total Units		
	SHDS	Yard Shed - big wooden	26x14x10		Composition Roll	364		
	Qual	3	Cond	3	Year	2010	Eff Age	16
						0		
						0		
<b>Valuation Summary</b>		<b>Modifier Total</b>		<b>RCN</b>	<b>Depr (52% Phys/ % Func)</b>	<b>RCNLD</b>		
Base Cost (18.22 x 364)		6,632			6,632	3,449	3,183	
	SHDS	Yard Shed - Wood / white	20x4x8		Composition Roll	80		
	Qual	2	Cond	2	Year	1990	Eff Age	43
						0		
						0		
<b>Valuation Summary</b>		<b>Modifier Total</b>		<b>RCN</b>	<b>Depr (80% Phys/ % Func)</b>	<b>RCNLD</b>		
Base Cost (21.70 x 80)		1,736			1,736	1,389	347	
	SHDS	Yard Shed - white metal	28x12x8		Wood Shingle	336		
	Qual	3	Cond	3	Year	1990	Eff Age	36
<b>Valuation Summary</b>		<b>Modifier Total</b>		<b>RCN</b>	<b>Depr (80% Phys/ % Func)</b>	<b>RCNLD</b>		
Base Cost (17.17 x 336)		5,769			5,769	4,615	1,154	
	SHDS	Yard Shed - back shed	14x14x8		Composition Roll	196		
	Qual	1	Cond	1	Year	1948	Eff Age	109
<b>Valuation Summary</b>		<b>Modifier Total</b>		<b>RCN</b>	<b>Depr (80% Phys/ % Func)</b>	<b>RCNLD</b>		
Base Cost (14.13 x 196)		2,769			2,769	2,215	554	
	PATO	Slab Class C	2x5x0			10		
	Qual	3	Cond	3	Year	1948	Eff Age	78
<b>Valuation Summary</b>		<b>Modifier Total</b>		<b>RCN</b>	<b>Depr (80% Phys/ % Func)</b>	<b>RCNLD</b>		
Base Cost (9.78 x 10)		98			98	78	20	
	SHDS	Yard Shed - det. garage bad shape	22x10x8		Composition Roll	220		
	Qual	2	Cond	2	Year	1948	Eff Age	94
<b>Valuation Summary</b>		<b>Modifier Total</b>		<b>RCN</b>	<b>Depr (80% Phys/ % Func)</b>	<b>RCNLD</b>		
Base Cost (16.80 x 220)		3,696			3,696	2,957	739	