



# Harper

## Assessment Property Record Card for Tax Year 2026

Data provided by SHAYLYN WEDER County Assessor

Date 02/06/2026  
Time 07:03:52  
Page 1

Assessment Data					Primary Image																																																																																																																				
<b>Account</b> 300005233 <b>Parcel ID</b> 1070-00-148-005-0-001-00 <b>Cadastral ID</b> 1070-148-005-00-0-001-00 <b>Property Type</b> REAL - Real Property <b>Property Class</b> UR VI Area 2 <b>Tax Area</b> 201 - 4T-BUFFALO-C <b>Name ID</b> 25769 BAMMERLIN, DEBORAH a/k/a DEBORAH ADKINS  PO BOX 168 BUFFALO OK 73834-  <b>Parcel Location</b> <b>Situs</b> 00115 NE SECOND ST <b>Subdivision</b> MILLER'S ADDN <b>Lot/Block</b> 0005 / 0148 <b>Parcel Size</b> 4 - Lots <b>Sec/Twn/Rng</b> / / / <b>Neighborhood</b> 100100 - BUFFALO ORIG/MILLERS <b>School District</b> 4-BUFFAL - 4-BUFFALO																																																																																																																									
<b>Legal Description</b> Lat/Long: 36.83545018 -99.63071001										HOUSE 2/23/2024																																																																																																															
<b>Legal Description</b> MILLER'S ADD. BLOCK 148 LOTS 5-7-9-11 DARLENE DECEASED 10/7/2024					<b>Building Permits</b> <table border="1"> <thead> <tr> <th>Number</th> <th>Description</th> <th>Opened</th> <th>Closed</th> <th>Amount</th> </tr> </thead> <tbody> <tr> <td colspan="5" style="height: 100px;"> </td> </tr> </tbody> </table>					Number	Description	Opened	Closed	Amount																																																																																																											
Number	Description	Opened	Closed	Amount																																																																																																																					
<b>Exemptions</b> <table border="1"> <thead> <tr> <th>Code</th> <th>Type</th> <th>Active</th> <th>Maximum</th> <th>Exemption</th> </tr> </thead> <tbody> <tr> <td>H</td> <td>Homestead</td> <td>No</td> <td>1,000</td> <td></td> </tr> </tbody> </table>					Code	Type	Active	Maximum	Exemption	H	Homestead	No	1,000		<b>Sale History</b> <table border="1"> <thead> <tr> <th>Bk/Pg</th> <th>Grantor</th> <th>Date</th> <th>Price</th> <th>Code</th> </tr> </thead> <tbody> <tr> <td>790/599</td> <td>BAMMERLIN, DARLENE</td> <td>07/16/2025</td> <td></td> <td>04</td> </tr> </tbody> </table>					Bk/Pg	Grantor	Date	Price	Code	790/599	BAMMERLIN, DARLENE	07/16/2025		04																																																																																												
Code	Type	Active	Maximum	Exemption																																																																																																																					
H	Homestead	No	1,000																																																																																																																						
Bk/Pg	Grantor	Date	Price	Code																																																																																																																					
790/599	BAMMERLIN, DARLENE	07/16/2025		04																																																																																																																					
<b>Parcel Valuation</b> <table border="1"> <thead> <tr> <th>Source</th> <th>REAL</th> <th>Fair Cash</th> <th>Capped</th> <th>Asmnt Level</th> <th>Assessed</th> <th>Levy Rate</th> <th>78.740</th> <th>Current Tax</th> </tr> </thead> <tbody> <tr> <td>Remove Cap</td> <td></td> <td>Land Value 3,525</td> <td>2,423</td> <td>12%</td> <td>291</td> <td>Assessed</td> <td>3,112</td> <td>245.04</td> </tr> <tr> <td>Year Frozen</td> <td>2013</td> <td>Improvements 31,694</td> <td>23,509</td> <td></td> <td>2,821</td> <td>Penalty</td> <td>0</td> <td></td> </tr> <tr> <td>Uncapped Value</td> <td>0</td> <td>Mobile Home 0</td> <td>0</td> <td></td> <td>0</td> <td>Exemption</td> <td>0</td> <td>0.00</td> </tr> <tr> <td>TIF Project ID</td> <td>0</td> <td>Total Value 35,219</td> <td>25,932</td> <td></td> <td>3,112</td> <td>Total Taxable</td> <td>3,112</td> <td>245.00</td> </tr> </tbody> </table>										Source	REAL	Fair Cash	Capped	Asmnt Level	Assessed	Levy Rate	78.740	Current Tax	Remove Cap		Land Value 3,525	2,423	12%	291	Assessed	3,112	245.04	Year Frozen	2013	Improvements 31,694	23,509		2,821	Penalty	0		Uncapped Value	0	Mobile Home 0	0		0	Exemption	0	0.00	TIF Project ID	0	Total Value 35,219	25,932		3,112	Total Taxable	3,112	245.00																																																																			
Source	REAL	Fair Cash	Capped	Asmnt Level	Assessed	Levy Rate	78.740	Current Tax																																																																																																																	
Remove Cap		Land Value 3,525	2,423	12%	291	Assessed	3,112	245.04																																																																																																																	
Year Frozen	2013	Improvements 31,694	23,509		2,821	Penalty	0																																																																																																																		
Uncapped Value	0	Mobile Home 0	0		0	Exemption	0	0.00																																																																																																																	
TIF Project ID	0	Total Value 35,219	25,932		3,112	Total Taxable	3,112	245.00																																																																																																																	
<b>Assessment History</b> <table border="1"> <thead> <tr> <th>Tax Year</th> <th>Statement Number</th> <th>Billed Owner</th> <th>Tax Area</th> <th>Total Value</th> <th>Exemptions</th> <th>Taxable Value</th> <th>Billed Tax</th> </tr> </thead> <tbody> <tr><td>2025</td><td>2025-300005233</td><td>BAMMERLIN, DEBORAH</td><td>201</td><td>35,219</td><td>0</td><td>2,964</td><td>233.00</td></tr> <tr><td>2024</td><td>2024-300005233</td><td>BAMMERLIN, DARLENE</td><td>201</td><td>37,729</td><td>1000</td><td>1,823</td><td>148.00</td></tr> <tr><td>2023</td><td>2023-300005233</td><td>BAMMERLIN, DARLENE</td><td>201</td><td>34,254</td><td>1000</td><td>1,823</td><td>151.00</td></tr> <tr><td>2022</td><td>2022-300005233</td><td>BAMMERLIN, DARLENE</td><td>201</td><td>29,260</td><td>1000</td><td>1,823</td><td>150.00</td></tr> <tr><td>2021</td><td>2021-300005233</td><td>BAMMERLIN, DARLENE</td><td>201</td><td>31,873</td><td>1000</td><td>1,823</td><td>151.00</td></tr> <tr><td>2020</td><td>2020-300005233</td><td>BAMMERLIN, DARLENE</td><td>201</td><td>30,959</td><td>2000</td><td>822</td><td>68.00</td></tr> <tr><td>2019</td><td>2019-0005233</td><td>BAMMERLIN, DARLENE</td><td>201</td><td>30,959</td><td></td><td>823</td><td>68.00</td></tr> <tr><td>2018</td><td>2018-0005233</td><td>BAMMERLIN, DARLENE</td><td>201</td><td>30,959</td><td></td><td>823</td><td>68.00</td></tr> <tr><td>2017</td><td>2017-0005233</td><td>BAMMERLIN, DARLENE</td><td>201</td><td>30,959</td><td></td><td>823</td><td>68.00</td></tr> <tr><td>2016</td><td>2016-0005233</td><td>BAMMERLIN, DARLENE</td><td>201</td><td>30,997</td><td></td><td>823</td><td>70.00</td></tr> <tr><td>2015</td><td>2015-0005233</td><td>BAMMERLIN, DARLENE</td><td>201</td><td>31,083</td><td></td><td>823</td><td>65.00</td></tr> <tr><td>2014</td><td>2014-0005233</td><td>BAMMERLIN, DARLENE</td><td>201</td><td>31,083</td><td></td><td>823</td><td>66.00</td></tr> <tr><td>2013</td><td>2013-0005233</td><td>BAMMERLIN, DARLENE</td><td>201</td><td>23,522</td><td></td><td>823</td><td>66.00</td></tr> </tbody> </table>										Tax Year	Statement Number	Billed Owner	Tax Area	Total Value	Exemptions	Taxable Value	Billed Tax	2025	2025-300005233	BAMMERLIN, DEBORAH	201	35,219	0	2,964	233.00	2024	2024-300005233	BAMMERLIN, DARLENE	201	37,729	1000	1,823	148.00	2023	2023-300005233	BAMMERLIN, DARLENE	201	34,254	1000	1,823	151.00	2022	2022-300005233	BAMMERLIN, DARLENE	201	29,260	1000	1,823	150.00	2021	2021-300005233	BAMMERLIN, DARLENE	201	31,873	1000	1,823	151.00	2020	2020-300005233	BAMMERLIN, DARLENE	201	30,959	2000	822	68.00	2019	2019-0005233	BAMMERLIN, DARLENE	201	30,959		823	68.00	2018	2018-0005233	BAMMERLIN, DARLENE	201	30,959		823	68.00	2017	2017-0005233	BAMMERLIN, DARLENE	201	30,959		823	68.00	2016	2016-0005233	BAMMERLIN, DARLENE	201	30,997		823	70.00	2015	2015-0005233	BAMMERLIN, DARLENE	201	31,083		823	65.00	2014	2014-0005233	BAMMERLIN, DARLENE	201	31,083		823	66.00	2013	2013-0005233	BAMMERLIN, DARLENE	201	23,522		823	66.00
Tax Year	Statement Number	Billed Owner	Tax Area	Total Value	Exemptions	Taxable Value	Billed Tax																																																																																																																		
2025	2025-300005233	BAMMERLIN, DEBORAH	201	35,219	0	2,964	233.00																																																																																																																		
2024	2024-300005233	BAMMERLIN, DARLENE	201	37,729	1000	1,823	148.00																																																																																																																		
2023	2023-300005233	BAMMERLIN, DARLENE	201	34,254	1000	1,823	151.00																																																																																																																		
2022	2022-300005233	BAMMERLIN, DARLENE	201	29,260	1000	1,823	150.00																																																																																																																		
2021	2021-300005233	BAMMERLIN, DARLENE	201	31,873	1000	1,823	151.00																																																																																																																		
2020	2020-300005233	BAMMERLIN, DARLENE	201	30,959	2000	822	68.00																																																																																																																		
2019	2019-0005233	BAMMERLIN, DARLENE	201	30,959		823	68.00																																																																																																																		
2018	2018-0005233	BAMMERLIN, DARLENE	201	30,959		823	68.00																																																																																																																		
2017	2017-0005233	BAMMERLIN, DARLENE	201	30,959		823	68.00																																																																																																																		
2016	2016-0005233	BAMMERLIN, DARLENE	201	30,997		823	70.00																																																																																																																		
2015	2015-0005233	BAMMERLIN, DARLENE	201	31,083		823	65.00																																																																																																																		
2014	2014-0005233	BAMMERLIN, DARLENE	201	31,083		823	66.00																																																																																																																		
2013	2013-0005233	BAMMERLIN, DARLENE	201	23,522		823	66.00																																																																																																																		



# Harper

## Assessment Property Record Card for Tax Year 2026

Data provided by SHAYLYN WEDER County Assessor

Date 02/06/2026  
Time 07:03:52  
Page 2

Lot Data	Square-Foot - BUFFALO ORIGMILLERS	Primary Image
Lot Size	100 x 117.5	
Lot Count		
Units Buildable	3525	
Non-Ag Acres		
Topography		
Street Access		
Utilities		
Amenities		
Method	Square-Foot	
Base Lot Value	11,750.00 x .30 = 3,525	
Factor Value		
Adjustments		
Lot Value	3,525	

Residential Data	
Type	1 Single Family Residence
Condition	3 - Average
Quality	3 - Average
Architecture	TRAD TRADITIONAL
Style	100% One Story
Exterior Wall	100% Frame, Siding, Vinyl
Base/Total Area	1,425 / 1,425
Style	100% One Story
HVAC	100% Floor Furnace 1 Wall Air Conditioners (Cour
Roof Cover	1 Composition Shingle
Area on Slab	0
Fixture/RghIn	5 /
Bed/F/H Bath	1 / 1.0 /
Basement Area	
Garage Type	
Remodel	
Year/Eff Age	1941 / 85

HOUSE	2/23/2024
-------	-----------

GRM Approach	
GRM Code	
Gross Rent	
Indicated Value	

Multiple Regression	
MRA Code	
Adusted R	
Indicated Value	

Direct Comparables	
Selection Model	DEFAULT DEFAULT SELECTION MODEL
Adjustment Model	DEFAULT DEFAULT ADJUSTMENTS TABLE
Comparables	
Indicated Value	

Cost Approach		Manual :	
Base Cost	84.41	Total Misc Impr	+ 1,174
Roofing Adj	+ 4.02	Garage Cost	+
Subfloor Adj	+ 0.00	Total RCN	= 136,022
Heat/Cool Adj	+ 1.73	Depreciation ( 80%)	- 108,818
Plumbing Adj	+ 4.47	Lump Sums	+ 0
Basement Adj	+ 0.00	RCNLD	= 27,204
Adj Base Cost	= 94.63	Lot Value	+ 3,525
Total Area	x 1,425	Indicated Value	= 30,729
Adjusted Cost	= 134,848	Value Per SqFt	21.56

Value Reconciliation			
Selected Approach	Cost Approach		
Improvements	27,204		
Lot Value	3,525		
Indicated Value	30,729	21.56	Per SqFt
Agland Value			
Site Improvements	4,571		
Total Value	35,300	24.77	Total Value Per SqFt

Miscellaneous Improvements								
Code	Description	Sketch ID	Size	Year	Units	Unit Cost	Depr	Value
PATO	Slab Porch - Open	11630	6x6		36	9.78		352
PRCH	Slab Porch - Covered	11631	6x6		36	22.84		822



Harper

Assessment Property Record Card for Tax Year 2026

Data provided by SHAYLYN WEDER County Assessor

Date 02/06/2026  
 Time 07:03:52  
 Page 3

Sketch Image

300005233

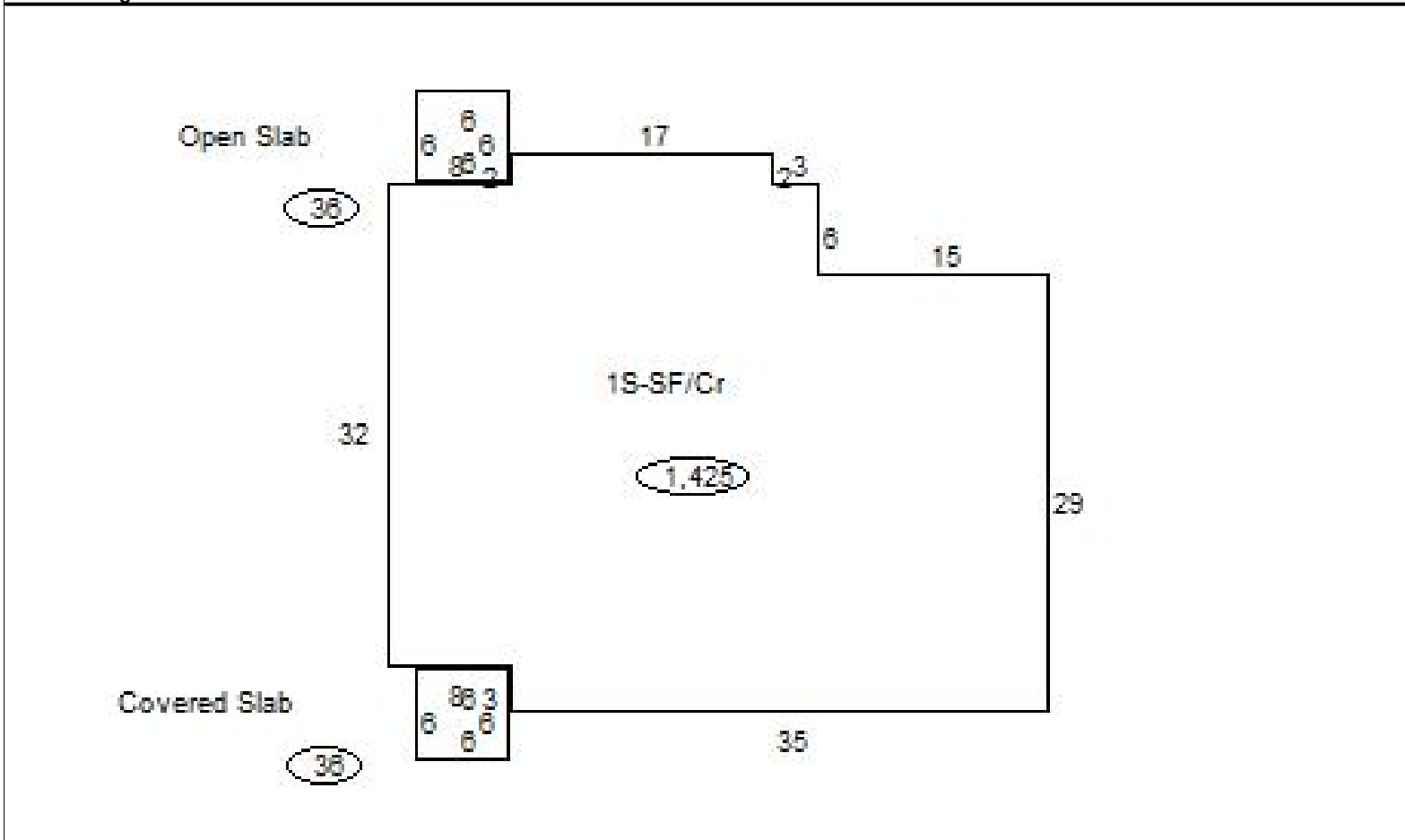

Sketch Vector Information

Sequence	Code	Type	Built Over	Scale	Section Label	Base Area	Multiplier	Total Area
1	R	1	Crawl	20	1S-SF/Cr	1,425	1.000	1,425
2	M	PATO		20	Open Slab	36	1.000	36
3	M	PRCH		20	Covered Slab	36	1.000	36
<b>Total Building Area</b>						1,425		1,425



# Harper

## Assessment Property Record Card for Tax Year 2026

Data provided by SHAYLYN WEDER County Assessor

Date 02/06/2026  
Time 07:03:52  
Page 4

300005233

### Outbuildings/Site Improvements

Building Image	Code	Description	Dimensions	Floor	Roofing	Total Units
	SHDS	Shed - GARAGE	30x14x10	Concrete	Formed Metal	420
	Qual	3	Cond 3	Year 2012	Eff Age 2017	
		<b>Valuation Summary</b>	<b>Modifier Total</b>	<b>RCN</b>	<b>Depr (40% Phys/ 0% Func)</b>	<b>RCNLD</b>
		Base Cost (18.14 x 420)	7,619	7,619	3,048	4,571