



# Harper

## Assessment Property Record Card for Tax Year 2026

Data provided by SHAYLYN WEDER County Assessor

Date 02/06/2026  
 Time 07:04:29  
 Page 1

| Assessment Data   |                               |                                  |          |             | Primary Image  |               |               |             |           |  |  |  |  |  |
|---|-------------------------------|----------------------------------|----------|-------------|--|---------------|---------------|-------------|-----------|--|--|--|--|--|
| Account   | 300005280                     |                                  |          |             | <p>1070-00-152-001-0-001-00<br/>5280 4/08/2021</p> <p>Church 4/19/2021</p> |               |               |             |           |  |  |  |  |  |
| Parcel ID   | 1070-00-152-001-0-001-00      |                                  |          |             |  |               |               |             |           |  |  |  |  |  |
| Cadastral ID  | 1070-152-001-00-0-001-00      |                                  |          |             |  |               |               |             |           |  |  |  |  |  |
| Property Type   | REAL - Real Property          |                                  |          |             |  |               |               |             |           |  |  |  |  |  |
| Property Class  | E                             | VI Area 3                        |          |             |  |               |               |             |           |  |  |  |  |  |
| Tax Area  | 201 - 4T-BUFFALO-C            |                                  |          |             |  |               |               |             |           |  |  |  |  |  |
| Name ID   | 14628                         |                                  |          |             |  |               |               |             |           |  |  |  |  |  |
| FIRST CHRISTIAN CHURCH - BUFFALO  |                               |                                  |          |             |  |               |               |             |           |  |  |  |  |  |
| PO BOX 557<br>BUFFALO OK 73834-0000   |                               |                                  |          |             |  |               |               |             |           |  |  |  |  |  |
| Parcel Location   |                               |                                  |          |             |  |               |               |             |           |  |  |  |  |  |
| Situs   | 00121 NW SECOND ST            |                                  |          |             |  |               |               |             |           |  |  |  |  |  |
| Subdivision   | MILLER'S ADDN                 |                                  |          |             |  |               |               |             |           |  |  |  |  |  |
| Lot/Block   | 0001 / 0152                   | Parcel Size 11 - Lots            |          |             |  |               |               |             |           |  |  |  |  |  |
| Sec/Twn/Rng   | / / /                         |                                  |          |             |  |               |               |             |           |  |  |  |  |  |
| Neighborhood  | 100100 - BUFFALO ORIG/MILLERS |                                  |          |             |  |               |               |             |           |  |  |  |  |  |
| School District   | 4-BUFFAL - 4-BUFFALO          |                                  |          |             |  |               |               |             |           |  |  |  |  |  |
| Legal Description Lat/Long: 36.83489369 -99.63229797  |                               |                                  |          |             |  |               |               |             |           |  |  |  |  |  |
| MILLER'S ADD BLOCK 152 LOTS 1-3-5-7-9-11-13-15 17-18-19   |                               |                                  |          |             |  |               |               |             |           |  |  |  |  |  |
| Building Permits  |                               |                                  |          |             |  |               |               |             |           |  |  |  |  |  |
| <table border="1"> <thead> <tr> <th>Number</th> <th>Description</th> <th>Opened</th> <th>Closed</th> <th>Amount</th> </tr> </thead> <tbody> <tr> <td> </td> <td> </td> <td> </td> <td> </td> <td> </td> </tr> </tbody> </table> |                               |                                  |          |             | Number   | Description   | Opened        | Closed      | Amount    |  |  |  |  |  |
| Number  | Description                   | Opened                           | Closed   | Amount      |  |               |               |             |           |  |  |  |  |  |
|   |                               |                                  |          |             |  |               |               |             |           |  |  |  |  |  |
| Exemptions  |                               |                                  |          |             |  |               |               |             |           |  |  |  |  |  |
| <table border="1"> <thead> <tr> <th>Code</th> <th>Type</th> <th>Active</th> <th>Maximum</th> <th>Exemption</th> </tr> </thead> <tbody> <tr> <td> </td> <td> </td> <td> </td> <td> </td> <td> </td> </tr> </tbody> </table>      |                               |                                  |          |             | Code   | Type          | Active        | Maximum     | Exemption |  |  |  |  |  |
| Code  | Type                          | Active                           | Maximum  | Exemption   |  |               |               |             |           |  |  |  |  |  |
|   |                               |                                  |          |             |  |               |               |             |           |  |  |  |  |  |
| Sale History  |                               |                                  |          |             |  |               |               |             |           |  |  |  |  |  |
| <table border="1"> <thead> <tr> <th>Bk/Pg</th> <th>Grantor</th> <th>Date</th> <th>Price</th> <th>Code</th> </tr> </thead> <tbody> <tr> <td> </td> <td> </td> <td> </td> <td> </td> <td> </td> </tr> </tbody> </table>           |                               |                                  |          |             | Bk/Pg  | Grantor       | Date          | Price       | Code      |  |  |  |  |  |
| Bk/Pg   | Grantor                       | Date                             | Price    | Code        |  |               |               |             |           |  |  |  |  |  |
|   |                               |                                  |          |             |  |               |               |             |           |  |  |  |  |  |
| Parcel Valuation  |                               |                                  |          |             |  |               |               |             |           |  |  |  |  |  |
| Source  | REAL                          | Fair Cash                        | Capped   | Asmnt Level | Assessed   | Levy Rate     | 78.740        | Current Tax |           |  |  |  |  |  |
| Remove Cap  |                               | Land Value                       | 9,324    | 0           | 12%  | 0             | Assessed      | 0 0.00      |           |  |  |  |  |  |
| Year Frozen   |                               | Improvements                     | 758,185  | 0           |  | 0             | Penalty       | 0 0.00      |           |  |  |  |  |  |
| Uncapped Value  | 0                             | Mobile Home                      | 0        | 0           |  | 0             | Exemption     | 0 0.00      |           |  |  |  |  |  |
| TIF Project ID  | 0                             | Total Value                      | 767,509  | 0           |  | 0             | Total Taxable | 0 0.00      |           |  |  |  |  |  |
| Assessment History  |                               |                                  |          |             |  |               |               |             |           |  |  |  |  |  |
| Tax Year  | Statement Number              | Billed Owner                     | Tax Area | Total Value | Exemptions   | Taxable Value | Billed Tax    |             |           |  |  |  |  |  |
| 2025  | 2025-300005280                | FIRST CHRISTIAN CHURCH - BUFFALO | 201      | 767,509     | 0  |               | .00           |             |           |  |  |  |  |  |
| 2024  | 2024-300005280                | FIRST CHRISTIAN CHURCH - BUFFALO | 201      | 846,675     | 0  |               | .00           |             |           |  |  |  |  |  |
| 2023  | 2023-300005280                | CHRISTIAN CHURCH                 | 201      | 760,117     | 0  |               | .00           |             |           |  |  |  |  |  |
| 2022  | 2022-300005280                | CHRISTIAN CHURCH                 | 201      | 637,592     | 0  |               | .00           |             |           |  |  |  |  |  |
| 2021  | 2021-300005280                | CHRISTIAN CHURCH                 | 201      |             | 0  |               | .00           |             |           |  |  |  |  |  |
| 2020  | 2020-300005280                | CHRISTIAN CHURCH                 | 201      |             | 0  |               | .00           |             |           |  |  |  |  |  |
| 2019  | 2019-0005280                  | CHRISTIAN CHURCH                 | 201      |             |  |               | .00           |             |           |  |  |  |  |  |
| 2018  | 2018-0005280                  | CHRISTIAN CHURCH                 | 201      |             |  |               | .00           |             |           |  |  |  |  |  |
| 2017  | 2017-0005280                  | CHRISTIAN CHURCH                 | 201      |             |  |               | .00           |             |           |  |  |  |  |  |
| 2016  | 2016-0005280                  | CHRISTIAN CHURCH                 | 201      |             |  |               | .00           |             |           |  |  |  |  |  |
| 2015  | 2015-0005280                  | CHRISTIAN CHURCH                 | 201      |             |  |               | .00           |             |           |  |  |  |  |  |
| 2014  | 2014-0005280                  | CHRISTIAN CHURCH                 | 201      |             |  |               | .00           |             |           |  |  |  |  |  |
| 2013  | 2013-0005280                  | CHRISTIAN CHURCH                 | 201      |             |  |               | .00           |             |           |  |  |  |  |  |



# Harper

## Assessment Property Record Card for Tax Year 2026

Data provided by SHAYLYN WEDER County Assessor

Date 02/06/2026  
 Time 07:04:29  
 Page 2

| Lot Data  | Primary Image  |  |
|---|--|--|
| <p>Lot Size x</p> <p>Lot Count</p> <p>Units Buildable</p> <p>Non-Ag Acres</p> <p>Topography</p> <p>Street Access</p> <p>Utilities</p> <p>Amenities</p> <p>Value Model 4 BUFFALO ORIGMILLERS</p> <p>Value Method Square-Foot</p> <p>Base Lot Value 31,080.00 x .30 = 9,324</p> <p>Factor Value 0</p> <p>Adjustments</p> <p>Lot Value 9,324</p>   |  |  |
| Cost Approach   |  |  |
| <p>Manual Date 07/2025</p> <p>Total Building Area 5,808</p> <p>Total Base Value 755,695</p> <p>Modifier Value</p> <p>Misc Improvements</p> <p>Replacement Cost New 755,695</p> <p>Phys/Func Depreciation Loss ()</p> <p>RCN Less Phys/Func 755,695</p> <p>Economic Depreciation</p> <p>RCNLD (All Sources) 755,695</p> <p>Depreciated Improvements</p> <p>Outbuilding Value 7,773</p> <p>Total Improvement Value 763,468</p> <p>Land Value 9,324</p> <p>Cost Approach Value 772,792 133.06/SqFt</p> |  | <p><b>Image Information</b></p> <p>Image ID 10844</p> <p>Image Date 4/19/2021</p> <p>Name 5280_1.JPG</p> <p>Description Church</p> |
| Income Approach   | Value Reconciliation   |  |
| <p>Potential Gross Income (PGI)</p> <p>Vacancy &amp; Collection Loss</p> <p>Miscellaneous Income</p> <p>Effective Gross Income (EGI)</p> <p>Total Expenses</p> <p>Net Operating Income (NOI)</p> <p>Income Capitalization Rate</p> <p>Indicated Value 0.00</p>  | <p>Selected Valuation Method Cost Approach</p> <p>Total Improvement Value 7,773</p> <p>Land Value 9,324</p> <p>Total Appraised Value 772,792 133.06/SqFt</p> |  |



Harper

Assessment Property Record Card for Tax Year 2026

Data provided by SHAYLYN WEDER County Assessor

Date 02/06/2026

Time 07:04:29

Page 3

Sketch Image

300005280

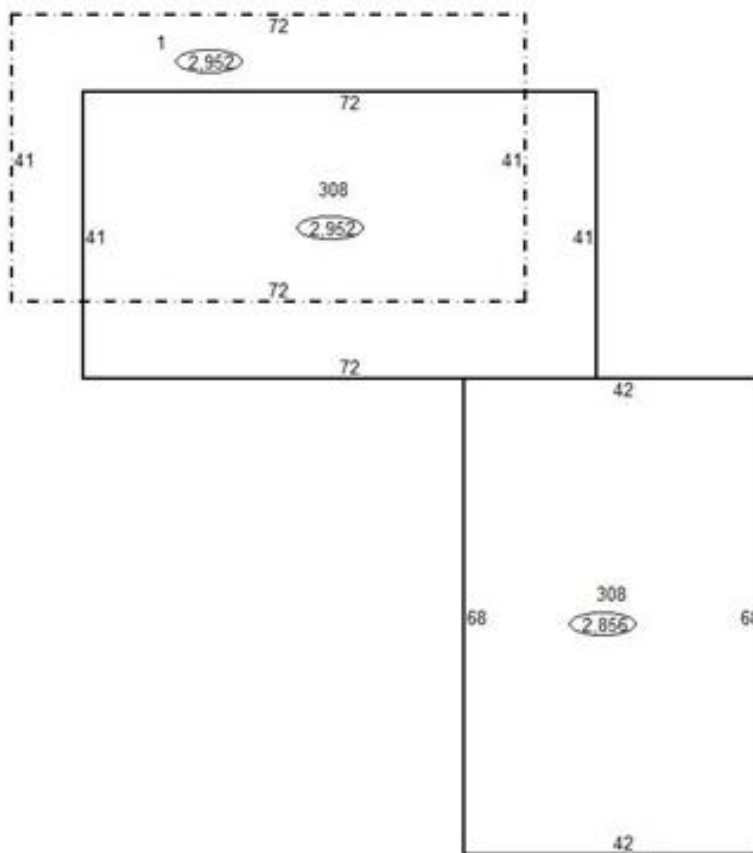

Sketch Vector Information

| Sequence                   | Code | Type | Built Over | Scale | Section Label | Base Area    | Multiplier | Total Area   |
|----------------------------|------|------|------------|-------|---------------|--------------|------------|--------------|
| 1                          | C    | 308  |            | 20    | 308           | 2,952        | 1.000      | 2,952        |
| 2                          | C    | 308  |            | 20    | 308           | 2,856        | 1.000      | 2,856        |
| 3                          | B    | 1    |            | 20    | 1             | 2,952        | 1.000      | 2,952        |
| <b>Total Building Area</b> |      |      |            |       |               | <b>5,808</b> |            | <b>5,808</b> |



# Harper

## Assessment Property Record Card for Tax Year 2026

Data provided by SHAYLYN WEDER County Assessor

Date 02/06/2026  
Time 07:04:29  
Page 4

Account 300005280  
Parcel ID 1070-00-152-001-0-001-00  
Cadastral ID 1070-152-001-00-0-001-00

Tax Area Code 201  
Property Class E  
Owners Name FIRST CHRISTIAN CHURCH - BUFFALO

### Building Data

Building ID 344  
Building Sequence 1  
Occupancy 1 308 Church w/ Sunday School 100%  
Occupancy 2  
Occupancy 3  
Total Floor Area 2,952  
Average Perimeter 226  
Number Of Storys 1.00  
Average Wall Ht 10.00  
Year Built 1980  
Effective Age 40  
Construction Class 1 - Residential Stud Frame  
Quality 3 - Average  
Condition 3 - Average  
Exterior Wall 82 - Stud Brick Veneer  
Heating/Cooling 8 - Warmed and Cooled Air  
Roof Type Gable  
Roof Cover Metal

Basement Area 2,952  
Basement Levels 1  
Basement Finish  
Finish Code - 1  
Finish Area - 1  
Finish Code - 2  
Finish Area - 2

### Building Image

### Image Information

Image Name  
Image Date  
Image Name  
Description

### Cost Calculations

Appraisal Zone 3  
Zone Description VI AREA 3  
Base Cost 77.20  
Wall Cost 31.34  
HVAC Cost 16.18  
Basement Cost 10.32  
Total Base Cost 135.04  
Total Area 2,952  
Base RCN 398,638  
Misc Impr Value

Manual Date  
Base Year 2026  
Modifier Value  
Total Replacement Cost 398,638  
Physical Depreciation  
Functional Depreciation  
Total Depreciation  
Total RCNLD 398,638  
Lump Sums  
Total Building Value 398,638 \$ 135.04 Per SqFt



# Harper

## Assessment Property Record Card for Tax Year 2026

Data provided by SHAYLYN WEDER County Assessor

Date 02/06/2026  
Time 07:04:29  
Page 5

Account 300005280  
Parcel ID 1070-00-152-001-0-001-00  
Cadastral ID 1070-152-001-00-0-001-00

Tax Area Code 201  
Property Class E  
Owners Name FIRST CHRISTIAN CHURCH - BUFFALO

### Building Data

Building ID 345  
Building Sequence 2  
Occupancy 1 308 Church w/ Sunday School 100%  
Occupancy 2  
Occupancy 3  
Total Floor Area 2,856  
Average Perimeter 220  
Number Of Storys 1.00  
Average Wall Ht 8.00  
Year Built 1980  
Effective Age 46  
Construction Class 1 - Residential Stud Frame  
Quality 3 - Average  
Condition 3 - Average  
Exterior Wall 82 - Stud Brick Veneer  
Heating/Cooling 8 - Warmed and Cooled Air  
Roof Type Flat  
Roof Cover Metal

Basement Area  
Basement Levels  
Basement Finish  
Finish Code - 1  
Finish Area - 1  
Finish Code - 2  
Finish Area - 2

### Building Image

### Image Information

Image Name  
Image Date  
Image Name  
Description

### Cost Calculations

Appraisal Zone 3  
Zone Description VI AREA 3  
Base Cost 77.30  
Wall Cost 31.54  
HVAC Cost 16.18  
Basement Cost 0.00  
Total Base Cost 125.02  
Total Area 2,856  
Base RCN 357,057  
Misc Impr Value

Manual Date  
Base Year 2026  
Modifier Value  
Total Replacement Cost 357,057  
Physical Depreciation  
Functional Depreciation  
Total Depreciation  
Total RCNLD 357,057  
Lump Sums  
Total Building Value 357,057 \$ 125.02 Per SqFt



# Harper

## Assessment Property Record Card for Tax Year 2026

Data provided by SHAYLYN WEDER County Assessor



Date 02/06/2026

Time 07:04:29

Page 6

300005280

### Outbuildings/Site Improvements

| Building Image   | Code | Description                   | Dimensions            | Floor      | Roofing                      | Total Units  |
|--|------|-------------------------------|-----------------------|------------|------------------------------|--------------|
|  | PACN | Paving - Concrete BBALL COURT | 40x40x0               |            |                              | 1,600        |
|  | Qual | 3                             | Cond 3                | Year 1980  | Eff Age 46                   |              |
|  |      | <b>Valuation Summary</b>      | <b>Modifier Total</b> | <b>RCN</b> | <b>Depr (% Phys/ % Func)</b> | <b>RCNLD</b> |
|  |      | Base Cost (3.99 x 1,600)      |                       | 6,384      | 5,107                        | 1,277        |
|  | PAVA | Paving - Asphalt PARKING LOT  | 200x70x0              |            |                              | 14,000       |
|  | Qual | 3                             | Cond 3                | Year 1980  | Eff Age 46                   |              |
|  |      | <b>Valuation Summary</b>      | <b>Modifier Total</b> | <b>RCN</b> | <b>Depr (% Phys/ % Func)</b> | <b>RCNLD</b> |
|  |      | Base Cost (2.32 x 14,000)     |                       | 32,480     | 25,984                       | 6,496        |
| <b>Total Site Improvement Value</b>  |      |                               |                       |            |                              | <b>7,773</b> |