



Harper

Assessment Property Record Card for Tax Year 2026

Data provided by SHAYLYN WEDER County Assessor

Date 02/06/2026
 Time 07:05:18
 Page 1

Assessment Data					Primary Image																																																																
Account 300005335 Parcel ID 1070-00-169-002-0-001-00 Cadastral ID 1070-169-002-00-0-001-00 Property Type REAL - Real Property Property Class UR VI Area 2 Tax Area 201 - 4T-BUFFALO-C Name ID 14667 MATA, ESMERALDA & PEDRO ESTRADA PO BOX 123 BUFFALO OK 73834-0000 Parcel Location Situs 00221 NW FIRST ST Subdivision MILLER'S ADDN Lot/Block 0002 / 0169 Parcel Size 3 - Lots Sec/Twn/Rng / / / Neighborhood 100100 - BUFFALO ORIG/MILLERS School District 4-BUFFAL - 4-BUFFALO																																																																					
Legal Description Lat/Long: 36.83568759 -99.62822290 MILLERS ADD. BLOCK 169 LOTS 2-4-6										HOUSE 9/13/2023																																																											
Exemptions					Building Permits																																																																
<table border="1"> <thead> <tr> <th>Code</th> <th>Type</th> <th>Active</th> <th>Maximum</th> <th>Exemption</th> </tr> </thead> <tbody> <tr> <td></td> <td></td> <td></td> <td></td> <td></td> </tr> </tbody> </table>					Code	Type	Active	Maximum	Exemption						<table border="1"> <thead> <tr> <th>Number</th> <th>Description</th> <th>Opened</th> <th>Closed</th> <th>Amount</th> </tr> </thead> <tbody> <tr> <td></td> <td></td> <td></td> <td></td> <td></td> </tr> </tbody> </table>					Number	Description	Opened	Closed	Amount																																													
Code	Type	Active	Maximum	Exemption																																																																	
Number	Description	Opened	Closed	Amount																																																																	
<table border="1"> <thead> <tr> <th>Code</th> <th>Type</th> <th>Active</th> <th>Maximum</th> <th>Exemption</th> </tr> </thead> <tbody> <tr> <td></td> <td></td> <td></td> <td></td> <td></td> </tr> </tbody> </table>					Code	Type	Active	Maximum	Exemption						Sale History																																																						
Code	Type	Active	Maximum	Exemption																																																																	
<table border="1"> <thead> <tr> <th>Bk/Pg</th> <th>Grantor</th> <th>Date</th> <th>Price</th> <th>Code</th> </tr> </thead> <tbody> <tr> <td>745/576</td> <td>WADDLE, TOM & DEBBY</td> <td>06/21/2019</td> <td>14,000</td> <td>16</td> </tr> <tr> <td>566/574</td> <td>HARMON, BRADLEY L., ETUX</td> <td>12/19/2000</td> <td>5,000</td> <td>U</td> </tr> </tbody> </table>					Bk/Pg	Grantor	Date	Price	Code	745/576	WADDLE, TOM & DEBBY	06/21/2019	14,000	16	566/574	HARMON, BRADLEY L., ETUX	12/19/2000	5,000	U	<table border="1"> <thead> <tr> <th>Source</th> <th>REAL</th> <th>Fair Cash</th> <th>Capped</th> <th>Asmnt Level</th> <th>Assessed</th> <th>Levy Rate</th> <th>78.740</th> <th>Current Tax</th> </tr> </thead> <tbody> <tr> <td>Remove Cap</td> <td>2020</td> <td>Land Value 3,038</td> <td>3,038</td> <td>12%</td> <td>365</td> <td>Assessed</td> <td>4,192</td> <td>330.08</td> </tr> <tr> <td>Year Frozen</td> <td></td> <td>Improvements 47,463</td> <td>31,894</td> <td></td> <td>3,827</td> <td>Penalty</td> <td>0</td> <td></td> </tr> <tr> <td>Uncapped Value</td> <td>0</td> <td>Mobile Home 0</td> <td>0</td> <td></td> <td>0</td> <td>Exemption</td> <td>0</td> <td>0.00</td> </tr> <tr> <td>TIF Project ID</td> <td>0</td> <td>Total Value 50,501</td> <td>34,932</td> <td></td> <td>4,192</td> <td>Total Taxable</td> <td>4,192</td> <td>330.00</td> </tr> </tbody> </table>					Source	REAL	Fair Cash	Capped	Asmnt Level	Assessed	Levy Rate	78.740	Current Tax	Remove Cap	2020	Land Value 3,038	3,038	12%	365	Assessed	4,192	330.08	Year Frozen		Improvements 47,463	31,894		3,827	Penalty	0		Uncapped Value	0	Mobile Home 0	0		0	Exemption	0	0.00	TIF Project ID	0	Total Value 50,501	34,932		4,192	Total Taxable	4,192	330.00
Bk/Pg	Grantor	Date	Price	Code																																																																	
745/576	WADDLE, TOM & DEBBY	06/21/2019	14,000	16																																																																	
566/574	HARMON, BRADLEY L., ETUX	12/19/2000	5,000	U																																																																	
Source	REAL	Fair Cash	Capped	Asmnt Level	Assessed	Levy Rate	78.740	Current Tax																																																													
Remove Cap	2020	Land Value 3,038	3,038	12%	365	Assessed	4,192	330.08																																																													
Year Frozen		Improvements 47,463	31,894		3,827	Penalty	0																																																														
Uncapped Value	0	Mobile Home 0	0		0	Exemption	0	0.00																																																													
TIF Project ID	0	Total Value 50,501	34,932		4,192	Total Taxable	4,192	330.00																																																													
Assessment History																																																																					
Tax Year	Statement Number	Billed Owner	Tax Area	Total Value	Exemptions	Taxable Value	Billed Tax																																																														
2025	2025-300005335	MATA, ESMERALDA &	201	50,501	0	3,993	314.00																																																														
2024	2024-300005335	MATA, ESMERALDA &	201	61,916	0	3,802	310.00																																																														
2023	2023-300005335	MATA, ESMERALDA &	201	34,315	0	3,622	300.00																																																														
2022	2022-300005335	MATA, ESMERALDA &	201	28,740	0	3,449	284.00																																																														
2021	2021-300005335	MATA, ESMERALDA &	201	29,865	0	3,531	292.00																																																														
2020	2020-300005335	MATA, ESMERALDA &	201	28,018	0	3,363	277.00																																																														
2019	2019-0005335	MATA, ESMERALDA &	201	28,018		3,068	254.00																																																														
2018	2018-0005335	WADDLE, TOM &	201	28,018		2,923	242.00																																																														
2017	2017-0005335	WADDLE, TOM &	201	28,018		2,783	231.00																																																														
2016	2016-0005335	WADDLE, TOM &	201	28,018		2,651	226.00																																																														
2015	2015-0005335	WADDLE, TOM &	201	28,112		2,525	200.00																																																														
2014	2014-0005335	WADDLE, TOM &	201	28,112		2,405	193.00																																																														
2013	2013-0005335	WADDLE, TOM &	201	31,214		2,290	182.00																																																														



Harper

Assessment Property Record Card for Tax Year 2026

Data provided by SHAYLYN WEDER County Assessor

Date 02/06/2026
 Time 07:05:18
 Page 2

Lot Data	Square-Foot - BUFFALO ORIGMILLERS	Primary Image
Lot Size	75 x 135	
Lot Count		
Units Buildable	3038	
Non-Ag Acres		
Topography		
Street Access		
Utilities		
Amenities		
Method	Square-Foot	
Base Lot Value	10,125.00 x .30 = 3,038	
Factor Value		
Adjustments		
Lot Value	3,038	

Residential Data	
Type	1 Single Family Residence
Condition	3 - Average
Quality	3 - Average
Architecture	TRAD TRADITIONAL
Style	100% One Story
Exterior Wall	100% Frame, Siding, Vinyl
Base/Total Area	1,058 / 1,058
Style	100% One Story
HVAC	100% Floor Furnace 1 Wall Air Conditioners (Cour
Roof Cover	1 Composition Shingle
Area on Slab	0
Fixture/RghIn	5 /
Bed/F/H Bath	2 / 1.0 /
Basement Area	
Garage Type	240 Detached Garage - Unfinished
Remodel	EXTWALL -
Year/Eff Age	1945 / 63

HOUSE	9/13/2023
-------	-----------

GRM Approach	
GRM Code	
Gross Rent	
Indicated Value	

Multiple Regression	
MRA Code	
Adusted R	
Indicated Value	

Direct Comparables	
Selection Model	DEFAULT DEFAULT SELECTION MODEL
Adjustment Model	DEFAULT DEFAULT ADJUSTMENTS TABLE
Comparables	
Indicated Value	

Cost Approach		Manual :	
Base Cost	91.50	Total Misc Impr	+ 1,076
Roofing Adj	+ 4.36	Garage Cost	+ 10,818
Subfloor Adj	+ 0.00	Total RCN	= 121,524
Heat/Cool Adj	+ 1.73	Depreciation (64%)	- 77,775
Plumbing Adj	+ 6.03	Lump Sums	+ 0
Basement Adj	+ 0.00	RCNLD	= 43,749
Adj Base Cost	= 103.62	Lot Value	+ 3,038
Total Area	x 1,058	Indicated Value	= 46,787
Adjusted Cost	= 109,630	Value Per SqFt	44.22

Value Reconciliation			
Selected Approach	Cost Approach		
Improvements	43,749		
Lot Value	3,038		
Indicated Value	46,787	44.22	Per SqFt
Agland Value			
Site Improvements	529		
Total Value	47,316	44.72	Total Value Per SqFt

Miscellaneous Improvements								
Code	Description	Sketch ID	Size	Year	Units	Unit Cost	Depr	Value
PATO	Slab Porch - Open	3154	5x4		20	9.78		196
PATO	Slab Porch - Open	3155	15x6		90	9.78		880



Harper

Assessment Property Record Card for Tax Year 2026

Data provided by SHAYLYN WEDER County Assessor

Date 02/06/2026
 Time 07:05:18
 Page 3

Sketch Image

300005335

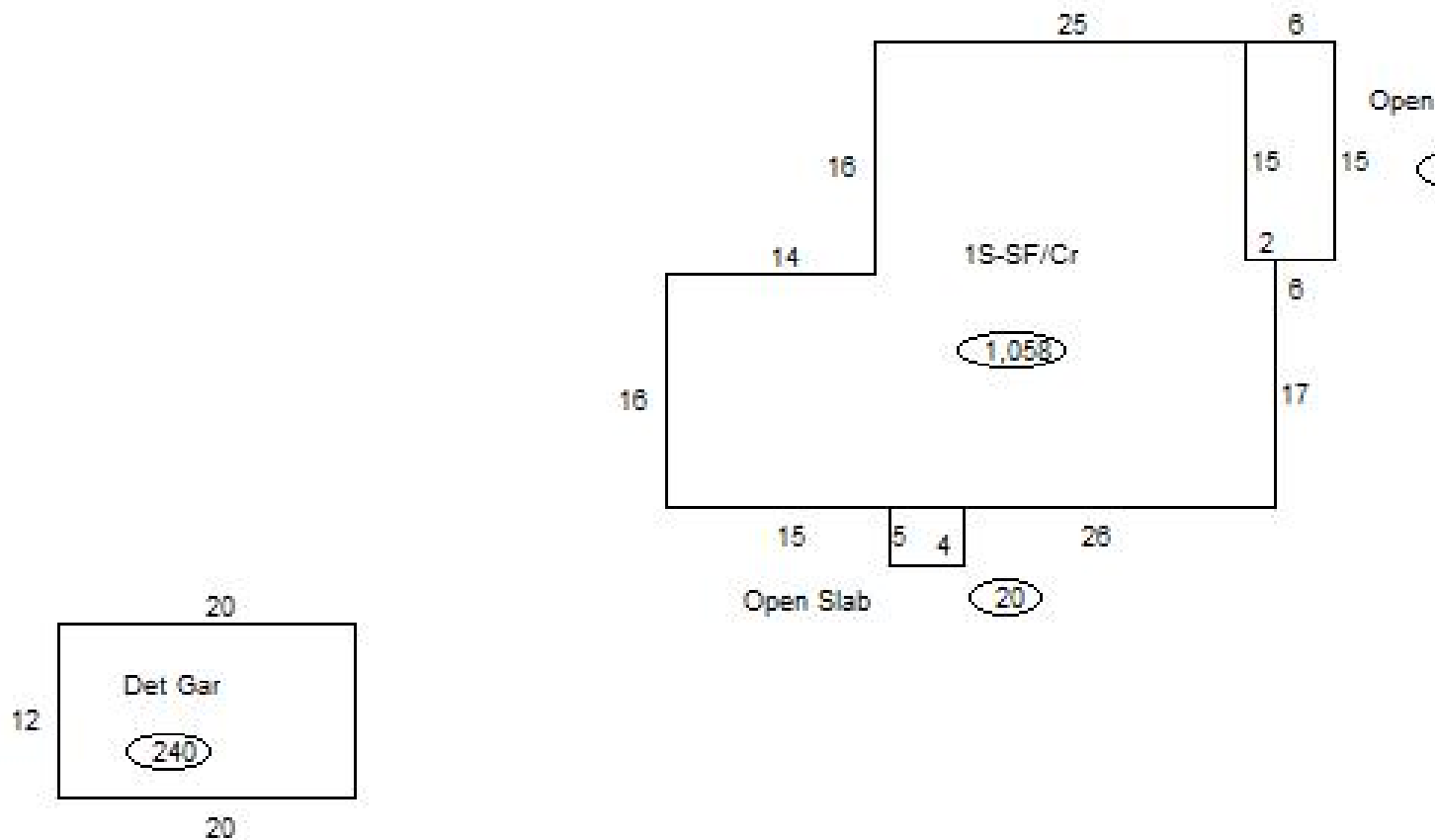

Sketch Vector Information

Sequence	Code	Type	Built Over	Scale	Section Label	Base Area	Multiplier	Total Area
1	M	PATO		20	Open Slab	20	1.000	20
2	M	PATO		20	Open Slab	90	1.000	90
3	R	1	Crawl	20	1S-SF/Cr	1,058	1.000	1,058
4	G	2		20	Det Gar	240	1.000	240
Total Building Area						1,058		1,058



Harper

Assessment Property Record Card for Tax Year 2026

Data provided by SHAYLYN WEDER County Assessor

Date 02/06/2026
Time 07:05:18
Page 4

300005335

Outbuildings/Site Improvements

Building Image	Code	Description	Dimensions	Floor	Roofing	Total Units	
	SHDS	Yard Shed - Wood	16x14x8	Dirt	Composition Shingle	224	
	Qual	2	Cond	2	Year	1993	Eff Age
		Valuation Summary	Modifier Total	RCN	Depr (80% Phys/ % Func)	RCNLD	
		Base Cost (11.81 x 224)	2,645		2,645	2,116	529