



Harper

Assessment Property Record Card for Tax Year 2026

Data provided by SHAYLYN WEDER County Assessor

Date 02/06/2026
 Time 07:05:21
 Page 1

Assessment Data					Primary Image																																																																																																																				
Account 300005338 Parcel ID 1070-00-169-014-0-001-00 Cadastral ID 1070-169-014-00-0-001-00 Property Type REAL - Real Property Property Class UR VI Area 2 Tax Area 201 - 4T-BUFFALO-C Name ID 14338 CENICEROS, FELIX & CRISTINA CENICEROS P O BOX 694 BUFFALO OK 73834-0000 Parcel Location Situs 00210 NW FIRST ST Subdivision MILLER'S ADDN Lot/Block 0014 / 0169 Parcel Size 4 - Lots Sec/Twn/Rng / / / Neighborhood 100100 - BUFFALO ORIG/MILLERS School District 4-BUFFAL - 4-BUFFALO					<p>1070-00-169-014-0-001-00 02/22/24</p>																																																																																																																				
Legal Description Lat/Long: 36.83853401 -99.62805942 MILLERS ADD BLOCK 169 LOTS 14-16-18-20																																																																																																																									
Exemptions					Building Permits																																																																																																																				
<table border="1"> <thead> <tr> <th>Code</th> <th>Type</th> <th>Active</th> <th>Maximum</th> <th>Exemption</th> </tr> </thead> <tbody> <tr> <td></td> <td></td> <td></td> <td></td> <td></td> </tr> </tbody> </table>					Code	Type	Active	Maximum	Exemption						<table border="1"> <thead> <tr> <th>Number</th> <th>Description</th> <th>Opened</th> <th>Closed</th> <th>Amount</th> </tr> </thead> <tbody> <tr> <td></td> <td></td> <td></td> <td></td> <td></td> </tr> </tbody> </table>					Number	Description	Opened	Closed	Amount																																																																																																	
Code	Type	Active	Maximum	Exemption																																																																																																																					
Number	Description	Opened	Closed	Amount																																																																																																																					
<table border="1"> <thead> <tr> <th>Code</th> <th>Type</th> <th>Active</th> <th>Maximum</th> <th>Exemption</th> </tr> </thead> <tbody> <tr> <td></td> <td></td> <td></td> <td></td> <td></td> </tr> </tbody> </table>					Code	Type	Active	Maximum	Exemption						Sale History <table border="1"> <thead> <tr> <th>Bk/Pg</th> <th>Grantor</th> <th>Date</th> <th>Price</th> <th>Code</th> </tr> </thead> <tbody> <tr> <td>631/725</td> <td>ROGERS, KELLY P, ETAL</td> <td>10/18/2007</td> <td>27,000</td> <td>Q</td> </tr> </tbody> </table>					Bk/Pg	Grantor	Date	Price	Code	631/725	ROGERS, KELLY P, ETAL	10/18/2007	27,000	Q																																																																																												
Code	Type	Active	Maximum	Exemption																																																																																																																					
Bk/Pg	Grantor	Date	Price	Code																																																																																																																					
631/725	ROGERS, KELLY P, ETAL	10/18/2007	27,000	Q																																																																																																																					
Parcel Valuation <table border="1"> <thead> <tr> <th>Source</th> <th>REAL</th> <th>Fair Cash</th> <th>Capped</th> <th>Asmnt Level</th> <th>Assessed</th> <th>Levy Rate</th> <th>78.740</th> <th>Current Tax</th> </tr> </thead> <tbody> <tr> <td>Remove Cap</td> <td></td> <td>4,050</td> <td>4,050</td> <td>12%</td> <td>486</td> <td>Assessed</td> <td>6,292</td> <td>495.43</td> </tr> <tr> <td>Year Frozen</td> <td></td> <td>48,381</td> <td>48,381</td> <td></td> <td>5,806</td> <td>Penalty</td> <td>0</td> <td></td> </tr> <tr> <td>Uncapped Value</td> <td>0</td> <td>0</td> <td>0</td> <td></td> <td>0</td> <td>Exemption</td> <td>0</td> <td>0.00</td> </tr> <tr> <td>TIF Project ID</td> <td>0</td> <td>52,431</td> <td>52,431</td> <td></td> <td>6,292</td> <td>Total Taxable</td> <td>6,292</td> <td>495.00</td> </tr> </tbody> </table>										Source	REAL	Fair Cash	Capped	Asmnt Level	Assessed	Levy Rate	78.740	Current Tax	Remove Cap		4,050	4,050	12%	486	Assessed	6,292	495.43	Year Frozen		48,381	48,381		5,806	Penalty	0		Uncapped Value	0	0	0		0	Exemption	0	0.00	TIF Project ID	0	52,431	52,431		6,292	Total Taxable	6,292	495.00																																																																			
Source	REAL	Fair Cash	Capped	Asmnt Level	Assessed	Levy Rate	78.740	Current Tax																																																																																																																	
Remove Cap		4,050	4,050	12%	486	Assessed	6,292	495.43																																																																																																																	
Year Frozen		48,381	48,381		5,806	Penalty	0																																																																																																																		
Uncapped Value	0	0	0		0	Exemption	0	0.00																																																																																																																	
TIF Project ID	0	52,431	52,431		6,292	Total Taxable	6,292	495.00																																																																																																																	
Assessment History <table border="1"> <thead> <tr> <th>Tax Year</th> <th>Statement Number</th> <th>Billed Owner</th> <th>Tax Area</th> <th>Total Value</th> <th>Exemptions</th> <th>Taxable Value</th> <th>Billed Tax</th> </tr> </thead> <tbody> <tr><td>2025</td><td>2025-300005338</td><td>CENICEROS, FELIX &</td><td>201</td><td>52,431</td><td>0</td><td>6,129</td><td>483.00</td></tr> <tr><td>2024</td><td>2024-300005338</td><td>CENICEROS, FELIX &</td><td>201</td><td>57,066</td><td>0</td><td>5,838</td><td>475.00</td></tr> <tr><td>2023</td><td>2023-300005338</td><td>CENICEROS, FELIX &</td><td>201</td><td>51,531</td><td>0</td><td>5,559</td><td>460.00</td></tr> <tr><td>2022</td><td>2022-300005338</td><td>CENICEROS, FELIX &</td><td>201</td><td>44,122</td><td>0</td><td>5,295</td><td>436.00</td></tr> <tr><td>2021</td><td>2021-300005338</td><td>CENICEROS, FELIX &</td><td>201</td><td>44,530</td><td>0</td><td>5,344</td><td>441.00</td></tr> <tr><td>2020</td><td>2020-300005338</td><td>CENICEROS, FELIX &</td><td>201</td><td>44,115</td><td>0</td><td>5,294</td><td>436.00</td></tr> <tr><td>2019</td><td>2019-0005338</td><td>CENICEROS, FELIX &</td><td>201</td><td>44,115</td><td></td><td>5,294</td><td>439.00</td></tr> <tr><td>2018</td><td>2018-0005338</td><td>CENICEROS, FELIX &</td><td>201</td><td>44,115</td><td></td><td>5,294</td><td>439.00</td></tr> <tr><td>2017</td><td>2017-0005338</td><td>CENICEROS, FELIX &</td><td>201</td><td>44,115</td><td></td><td>5,294</td><td>440.00</td></tr> <tr><td>2016</td><td>2016-0005338</td><td>CENICEROS, FELIX &</td><td>201</td><td>44,115</td><td></td><td>5,294</td><td>450.00</td></tr> <tr><td>2015</td><td>2015-0005338</td><td>CENICEROS, FELIX &</td><td>201</td><td>44,235</td><td></td><td>4,180</td><td>332.00</td></tr> <tr><td>2014</td><td>2014-0005338</td><td>CENICEROS, FELIX &</td><td>201</td><td>44,235</td><td></td><td>4,028</td><td>323.00</td></tr> <tr><td>2013</td><td>2013-0005338</td><td>CENICEROS, FELIX &</td><td>201</td><td>43,710</td><td></td><td>3,883</td><td>309.00</td></tr> </tbody> </table>										Tax Year	Statement Number	Billed Owner	Tax Area	Total Value	Exemptions	Taxable Value	Billed Tax	2025	2025-300005338	CENICEROS, FELIX &	201	52,431	0	6,129	483.00	2024	2024-300005338	CENICEROS, FELIX &	201	57,066	0	5,838	475.00	2023	2023-300005338	CENICEROS, FELIX &	201	51,531	0	5,559	460.00	2022	2022-300005338	CENICEROS, FELIX &	201	44,122	0	5,295	436.00	2021	2021-300005338	CENICEROS, FELIX &	201	44,530	0	5,344	441.00	2020	2020-300005338	CENICEROS, FELIX &	201	44,115	0	5,294	436.00	2019	2019-0005338	CENICEROS, FELIX &	201	44,115		5,294	439.00	2018	2018-0005338	CENICEROS, FELIX &	201	44,115		5,294	439.00	2017	2017-0005338	CENICEROS, FELIX &	201	44,115		5,294	440.00	2016	2016-0005338	CENICEROS, FELIX &	201	44,115		5,294	450.00	2015	2015-0005338	CENICEROS, FELIX &	201	44,235		4,180	332.00	2014	2014-0005338	CENICEROS, FELIX &	201	44,235		4,028	323.00	2013	2013-0005338	CENICEROS, FELIX &	201	43,710		3,883	309.00
Tax Year	Statement Number	Billed Owner	Tax Area	Total Value	Exemptions	Taxable Value	Billed Tax																																																																																																																		
2025	2025-300005338	CENICEROS, FELIX &	201	52,431	0	6,129	483.00																																																																																																																		
2024	2024-300005338	CENICEROS, FELIX &	201	57,066	0	5,838	475.00																																																																																																																		
2023	2023-300005338	CENICEROS, FELIX &	201	51,531	0	5,559	460.00																																																																																																																		
2022	2022-300005338	CENICEROS, FELIX &	201	44,122	0	5,295	436.00																																																																																																																		
2021	2021-300005338	CENICEROS, FELIX &	201	44,530	0	5,344	441.00																																																																																																																		
2020	2020-300005338	CENICEROS, FELIX &	201	44,115	0	5,294	436.00																																																																																																																		
2019	2019-0005338	CENICEROS, FELIX &	201	44,115		5,294	439.00																																																																																																																		
2018	2018-0005338	CENICEROS, FELIX &	201	44,115		5,294	439.00																																																																																																																		
2017	2017-0005338	CENICEROS, FELIX &	201	44,115		5,294	440.00																																																																																																																		
2016	2016-0005338	CENICEROS, FELIX &	201	44,115		5,294	450.00																																																																																																																		
2015	2015-0005338	CENICEROS, FELIX &	201	44,235		4,180	332.00																																																																																																																		
2014	2014-0005338	CENICEROS, FELIX &	201	44,235		4,028	323.00																																																																																																																		
2013	2013-0005338	CENICEROS, FELIX &	201	43,710		3,883	309.00																																																																																																																		



Harper

Assessment Property Record Card for Tax Year 2026

Data provided by SHAYLYN WEDER County Assessor

Date 02/06/2026
 Time 07:05:21
 Page 2

Lot Data	Square-Foot - BUFFALO ORIGMILLERS	Primary Image
Lot Size	100 x 135	
Lot Count		
Units Buildable	4050	
Non-Ag Acres		
Topography		
Street Access		
Utilities		
Amenities		
Method	Square-Foot	
Base Lot Value	13,500.00 x .30 = 4,050	
Factor Value		
Adjustments		
Lot Value	4,050	

Residential Data	
Type	1 Single Family Residence
Condition	3 - Average
Quality	3 - Average
Architecture	TRAD TRADITIONAL
Style	100% One Story
Exterior Wall	100% Asbestos Siding
Base/Total Area	1,280 / 1,280
Style	100% One Story
HVAC	100% Warmed & Cooled Air
Roof Cover	1 Composition Shingle
Area on Slab	0
Fixture/RghIn	5 /
Bed/F/H Bath	2 / 1.0 /
Basement Area	
Garage Type	
Remodel	
Year/Eff Age	1951 / 75

HOUSE	2/23/2024
-------	-----------

GRM Approach	
GRM Code	
Gross Rent	
Indicated Value	

Multiple Regression	
MRA Code	
Adusted R	
Indicated Value	

Direct Comparables	
Selection Model	DEFAULT DEFAULT SELECTION MODEL
Adjustment Model	DEFAULT DEFAULT ADJUSTMENTS TABLE
Comparables	
Indicated Value	

Cost Approach		Manual :	
Base Cost	83.16	Total Misc Impr	+ 2,798
Roofing Adj	+ 4.11	Garage Cost	+
Subfloor Adj	+ 0.00	Total RCN	= 134,676
Heat/Cool Adj	+ 10.77	Depreciation (74%)	- 99,660
Plumbing Adj	+ 4.98	Lump Sums	+ 0
Basement Adj	+ 0.00	RCNLD	= 35,016
Adj Base Cost	= 103.03	Lot Value	+ 4,050
Total Area	x 1,280	Indicated Value	= 39,066
Adjusted Cost	= 131,878	Value Per SqFt	30.52

Value Reconciliation			
Selected Approach	Cost Approach		
Improvements	35,016		
Lot Value	4,050		
Indicated Value	39,066	30.52	Per SqFt
Agland Value			
Site Improvements	11,813		
Total Value	50,879	39.75	Total Value Per SqFt

Miscellaneous Improvements								
Code	Description	Sketch ID	Size	Year	Units	Unit Cost	Depr	Value
PATO	Slab Porch - Open	3164	4x3		12	9.78		117
PRCH	Slab Porch - Covered	3165	108		108	22.65		2,446
PATO	Slab Porch - Open	3166	6x4		24	9.78		235



Harper

Assessment Property Record Card for Tax Year 2026

Data provided by SHAYLYN WEDER County Assessor

Date 02/06/2026

Time 07:05:21

Page 3

Sketch Image

300005338

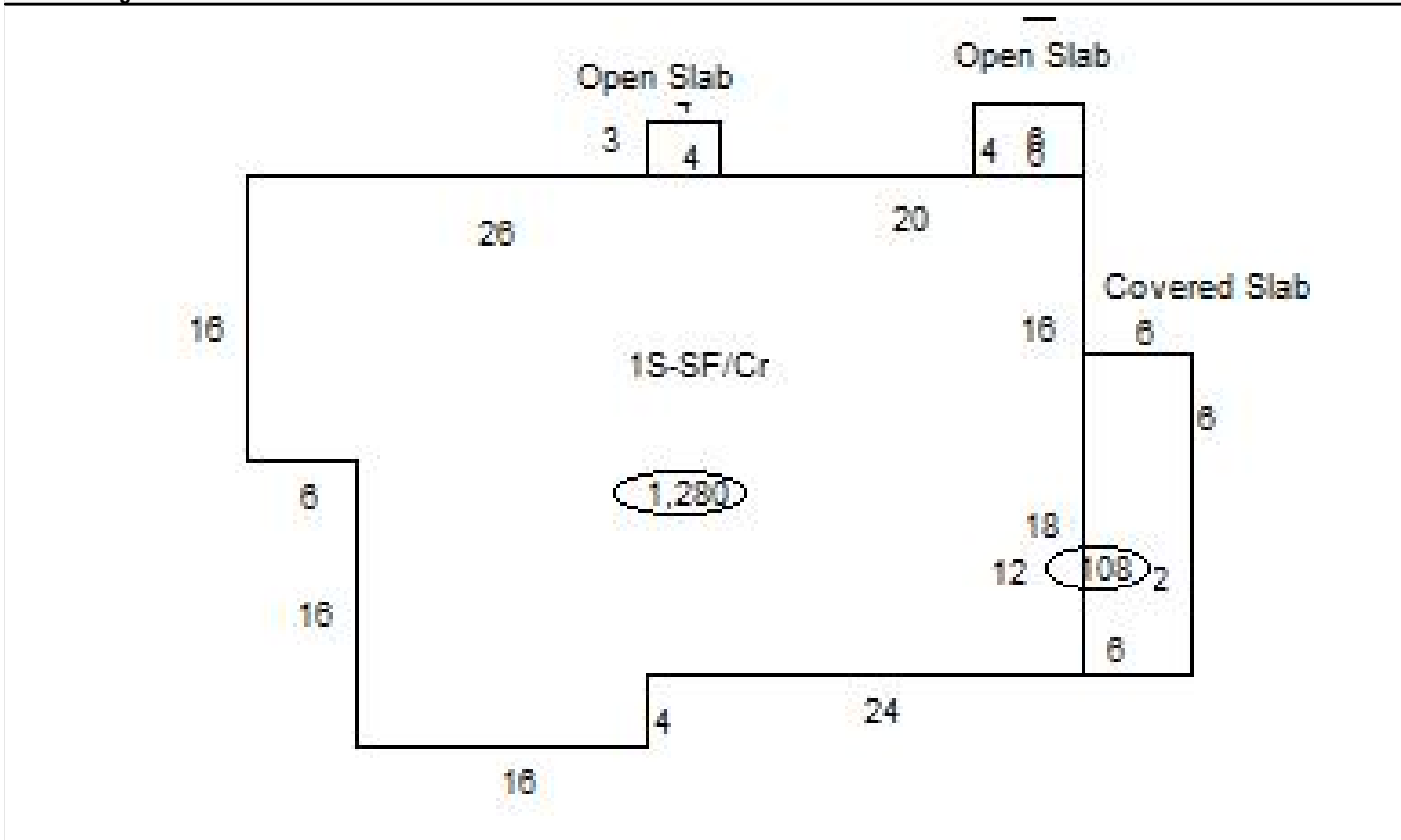

Sketch Vector Information

Sequence	Code	Type	Built Over	Scale	Section Label	Base Area	Multiplier	Total Area
1	M	PATO		20	Open Slab	12	1.000	12
2	M	PRCH		20	Covered Slab	108	1.000	108
3	M	PATO		20	Open Slab	24	1.000	24
4	R	1	Crawl	20	1S-SF/Cr	1,280	1.000	1,280
Total Building Area						1,280		1,280



Harper

Assessment Property Record Card for Tax Year 2026

Data provided by SHAYLYN WEDER County Assessor

Date 02/06/2026
 Time 07:05:21
 Page 4

300005338

Outbuildings/Site Improvements

Building Image	Code	Description	Dimensions	Floor	Roofing	Total Units
	ASC	Awning	24x18x8	Concrete	Formed Metal	432
	Qual	2.5	Cond 2.5	Year 2018	Eff Age 7	
	Valuation Summary		Modifier Total	RCN	Depr (28% Phys/ % Func)	RCNLD
	Base Cost (3.67 x 432)		1,585	1,585	444	1,141
	MGWH	SHIP/LIVING AREA	30x8x6	Base	Galvanized Metal	240
	Qual	4	Cond 4	Year 2010	Eff Age 13	
	Valuation Summary		Modifier Total	RCN	Depr (30% Phys/ % Func)	RCNLD
	Base Cost (49.59 x 240)		11,902	11,902	3,571	8,331
	CPDT	Carport - Detached	35x22x8	Concrete	Formed Metal	770
	Qual	3	Cond 3	Year 2001	Eff Age 25	
	Valuation Summary		Modifier Total	RCN	Depr (79% Phys/ % Func)	RCNLD
	Base Cost (7.84 x 770)		6,037	6,037	4,769	1,268
	SHDS	Yard Shed - Metal	14x10x6	Concrete	Formed Metal	140
	Qual	3	Cond 3	Year 1995	Eff Age 31	
	Valuation Summary		Modifier Total	RCN	Depr (78% Phys/ % Func)	RCNLD
	Base Cost (22.23 x 140)		3,112	3,112	2,427	685
	SHDS	Yard Shed - Wood	10x10x6	Dirt	Composition Shingle	100
	Qual	3	Cond 3	Year 1992	Eff Age 34	
	Valuation Summary		Modifier Total	RCN	Depr (80% Phys/ % Func)	RCNLD
	Base Cost (19.38 x 100)		1,938	1,938	1,550	388