



# Harper

## Assessment Property Record Card for Tax Year 2026

Data provided by SHAYLYN WEDER County Assessor

Date 02/06/2026  
 Time 07:05:34  
 Page 1

Assessment Data					Primary Image																																																																																																																				
<b>Account</b> 300005352 <b>Parcel ID</b> 1070-00-171-001-0-001-00 <b>Cadastral ID</b> 1070-171-001-00-0-001-00 <b>Property Type</b> REAL - Real Property <b>Property Class</b> UR VI Area 2 <b>Tax Area</b> 201 - 4T-BUFFALO-C <b>Name ID</b> 14679 WILKINSON, MICHELLE & PAMELA WILKINSON  P O BOX 675 BUFFALO OK 73834-0000  <b>Parcel Location</b> <b>Situs</b> 00221 NE SECOND ST <b>Subdivision</b> MILLER'S ADDN <b>Lot/Block</b> 0001 / 0171 <b>Parcel Size</b> 3 - Lots <b>Sec/Twn/Rng</b> / / / <b>Neighborhood</b> 100100 - BUFFALO ORIG/MILLERS <b>School District</b> 4-BUFFAL - 4-BUFFALO					<p>1070-00-171-001-0-001-00 02/22/24</p>																																																																																																																				
HOUSE										2/23/2024																																																																																																															
<b>Legal Description</b> Lat/Long: 36.83684302 -99.62780150					<b>Building Permits</b> <table border="1"> <thead> <tr> <th>Number</th> <th>Description</th> <th>Opened</th> <th>Closed</th> <th>Amount</th> </tr> </thead> <tbody> <tr> <td colspan="5" style="height: 100px;"> </td> </tr> </tbody> </table>					Number	Description	Opened	Closed	Amount																																																																																																											
Number	Description	Opened	Closed	Amount																																																																																																																					
MILLERS ADD. BLOCK 171 LOTS 1-3-5																																																																																																																									
<b>Exemptions</b> <table border="1"> <thead> <tr> <th>Code</th> <th>Type</th> <th>Active</th> <th>Maximum</th> <th>Exemption</th> </tr> </thead> <tbody> <tr> <td>H</td> <td>Homestead</td> <td>Yes</td> <td>1,000</td> <td>1,000</td> </tr> </tbody> </table>					Code	Type	Active	Maximum	Exemption	H	Homestead	Yes	1,000	1,000	<b>Sale History</b> <table border="1"> <thead> <tr> <th>Bk/Pg</th> <th>Grantor</th> <th>Date</th> <th>Price</th> <th>Code</th> </tr> </thead> <tbody> <tr> <td>680/120</td> <td>CLARK, LEVI AND</td> <td>03/27/2012</td> <td>36,309</td> <td>MQ</td> </tr> <tr> <td>585/767</td> <td>BRADY, DOUGLAS L., ETUX</td> <td>07/22/2003</td> <td>46,000</td> <td>PQ</td> </tr> </tbody> </table>					Bk/Pg	Grantor	Date	Price	Code	680/120	CLARK, LEVI AND	03/27/2012	36,309	MQ	585/767	BRADY, DOUGLAS L., ETUX	07/22/2003	46,000	PQ																																																																																							
Code	Type	Active	Maximum	Exemption																																																																																																																					
H	Homestead	Yes	1,000	1,000																																																																																																																					
Bk/Pg	Grantor	Date	Price	Code																																																																																																																					
680/120	CLARK, LEVI AND	03/27/2012	36,309	MQ																																																																																																																					
585/767	BRADY, DOUGLAS L., ETUX	07/22/2003	46,000	PQ																																																																																																																					
<b>Parcel Valuation</b> <table border="1"> <thead> <tr> <th>Source</th> <th>REAL</th> <th>Fair Cash</th> <th>Capped</th> <th>Asmnt Level</th> <th>Assessed</th> <th>Levy Rate</th> <th>78.740</th> <th>Current Tax</th> </tr> </thead> <tbody> <tr> <td>Remove Cap</td> <td></td> <td>Land Value 2,644</td> <td>2,644</td> <td>12%</td> <td>317</td> <td>Assessed</td> <td>4,091</td> <td>322.13</td> </tr> <tr> <td>Year Frozen</td> <td></td> <td>Improvements 36,175</td> <td>31,451</td> <td></td> <td>3,774</td> <td>Penalty</td> <td>0</td> <td></td> </tr> <tr> <td>Uncapped Value</td> <td>0</td> <td>Mobile Home 0</td> <td>0</td> <td></td> <td>0</td> <td>Exemption</td> <td>1,000</td> <td>-79.00</td> </tr> <tr> <td>TIF Project ID</td> <td>0</td> <td>Total Value 38,819</td> <td>34,095</td> <td></td> <td>4,091</td> <td>Total Taxable</td> <td>3,091</td> <td>243.00</td> </tr> </tbody> </table>										Source	REAL	Fair Cash	Capped	Asmnt Level	Assessed	Levy Rate	78.740	Current Tax	Remove Cap		Land Value 2,644	2,644	12%	317	Assessed	4,091	322.13	Year Frozen		Improvements 36,175	31,451		3,774	Penalty	0		Uncapped Value	0	Mobile Home 0	0		0	Exemption	1,000	-79.00	TIF Project ID	0	Total Value 38,819	34,095		4,091	Total Taxable	3,091	243.00																																																																			
Source	REAL	Fair Cash	Capped	Asmnt Level	Assessed	Levy Rate	78.740	Current Tax																																																																																																																	
Remove Cap		Land Value 2,644	2,644	12%	317	Assessed	4,091	322.13																																																																																																																	
Year Frozen		Improvements 36,175	31,451		3,774	Penalty	0																																																																																																																		
Uncapped Value	0	Mobile Home 0	0		0	Exemption	1,000	-79.00																																																																																																																	
TIF Project ID	0	Total Value 38,819	34,095		4,091	Total Taxable	3,091	243.00																																																																																																																	
<b>Assessment History</b> <table border="1"> <thead> <tr> <th>Tax Year</th> <th>Statement Number</th> <th>Billed Owner</th> <th>Tax Area</th> <th>Total Value</th> <th>Exemptions</th> <th>Taxable Value</th> <th>Billed Tax</th> </tr> </thead> <tbody> <tr><td>2025</td><td>2025-300005352</td><td>WILKINSON, MICHELLE &amp;</td><td>201</td><td>38,819</td><td>1000</td><td>2,972</td><td>234.00</td></tr> <tr><td>2024</td><td>2024-300005352</td><td>WILKINSON, MICHELLE &amp;</td><td>201</td><td>38,326</td><td>1000</td><td>2,856</td><td>233.00</td></tr> <tr><td>2023</td><td>2023-300005352</td><td>WILKINSON, MICHELLE &amp;</td><td>201</td><td>36,139</td><td>1000</td><td>2,744</td><td>227.00</td></tr> <tr><td>2022</td><td>2022-300005352</td><td>WILKINSON, MICHELLE &amp;</td><td>201</td><td>30,294</td><td>1000</td><td>2,635</td><td>217.00</td></tr> <tr><td>2021</td><td>2021-300005352</td><td>WILKINSON, MICHELLE &amp;</td><td>201</td><td>30,492</td><td>1000</td><td>2,659</td><td>220.00</td></tr> <tr><td>2020</td><td>2020-300005352</td><td>WILKINSON, MICHELLE &amp;</td><td>201</td><td>30,187</td><td>1000</td><td>2,622</td><td>216.00</td></tr> <tr><td>2019</td><td>2019-0005352</td><td>WILKINSON, MICHELLE &amp;</td><td>201</td><td>30,187</td><td></td><td>2,622</td><td>217.00</td></tr> <tr><td>2018</td><td>2018-0005352</td><td>WILKINSON, MICHELLE &amp;</td><td>201</td><td>30,187</td><td></td><td>2,622</td><td>217.00</td></tr> <tr><td>2017</td><td>2017-0005352</td><td>WILKINSON, MICHELLE &amp;</td><td>201</td><td>30,187</td><td></td><td>2,622</td><td>218.00</td></tr> <tr><td>2016</td><td>2016-0005352</td><td>WILKINSON, MICHELLE &amp;</td><td>201</td><td>30,187</td><td></td><td>2,622</td><td>223.00</td></tr> <tr><td>2015</td><td>2015-0005352</td><td>WILKINSON, MICHELLE &amp;</td><td>201</td><td>30,292</td><td></td><td>2,635</td><td>209.00</td></tr> <tr><td>2014</td><td>2014-0005352</td><td>WILKINSON, MICHELLE &amp;</td><td>201</td><td>30,292</td><td></td><td>2,635</td><td>211.00</td></tr> <tr><td>2013</td><td>2013-0005352</td><td>WILKINSON, MICHELLE &amp;</td><td>201</td><td>36,309</td><td></td><td>3,357</td><td>267.00</td></tr> </tbody> </table>										Tax Year	Statement Number	Billed Owner	Tax Area	Total Value	Exemptions	Taxable Value	Billed Tax	2025	2025-300005352	WILKINSON, MICHELLE &	201	38,819	1000	2,972	234.00	2024	2024-300005352	WILKINSON, MICHELLE &	201	38,326	1000	2,856	233.00	2023	2023-300005352	WILKINSON, MICHELLE &	201	36,139	1000	2,744	227.00	2022	2022-300005352	WILKINSON, MICHELLE &	201	30,294	1000	2,635	217.00	2021	2021-300005352	WILKINSON, MICHELLE &	201	30,492	1000	2,659	220.00	2020	2020-300005352	WILKINSON, MICHELLE &	201	30,187	1000	2,622	216.00	2019	2019-0005352	WILKINSON, MICHELLE &	201	30,187		2,622	217.00	2018	2018-0005352	WILKINSON, MICHELLE &	201	30,187		2,622	217.00	2017	2017-0005352	WILKINSON, MICHELLE &	201	30,187		2,622	218.00	2016	2016-0005352	WILKINSON, MICHELLE &	201	30,187		2,622	223.00	2015	2015-0005352	WILKINSON, MICHELLE &	201	30,292		2,635	209.00	2014	2014-0005352	WILKINSON, MICHELLE &	201	30,292		2,635	211.00	2013	2013-0005352	WILKINSON, MICHELLE &	201	36,309		3,357	267.00
Tax Year	Statement Number	Billed Owner	Tax Area	Total Value	Exemptions	Taxable Value	Billed Tax																																																																																																																		
2025	2025-300005352	WILKINSON, MICHELLE &	201	38,819	1000	2,972	234.00																																																																																																																		
2024	2024-300005352	WILKINSON, MICHELLE &	201	38,326	1000	2,856	233.00																																																																																																																		
2023	2023-300005352	WILKINSON, MICHELLE &	201	36,139	1000	2,744	227.00																																																																																																																		
2022	2022-300005352	WILKINSON, MICHELLE &	201	30,294	1000	2,635	217.00																																																																																																																		
2021	2021-300005352	WILKINSON, MICHELLE &	201	30,492	1000	2,659	220.00																																																																																																																		
2020	2020-300005352	WILKINSON, MICHELLE &	201	30,187	1000	2,622	216.00																																																																																																																		
2019	2019-0005352	WILKINSON, MICHELLE &	201	30,187		2,622	217.00																																																																																																																		
2018	2018-0005352	WILKINSON, MICHELLE &	201	30,187		2,622	217.00																																																																																																																		
2017	2017-0005352	WILKINSON, MICHELLE &	201	30,187		2,622	218.00																																																																																																																		
2016	2016-0005352	WILKINSON, MICHELLE &	201	30,187		2,622	223.00																																																																																																																		
2015	2015-0005352	WILKINSON, MICHELLE &	201	30,292		2,635	209.00																																																																																																																		
2014	2014-0005352	WILKINSON, MICHELLE &	201	30,292		2,635	211.00																																																																																																																		
2013	2013-0005352	WILKINSON, MICHELLE &	201	36,309		3,357	267.00																																																																																																																		



# Harper

## Assessment Property Record Card for Tax Year 2026

Data provided by SHAYLYN WEDER County Assessor

Date 02/06/2026  
 Time 07:05:34  
 Page 2

Lot Data	Square-Foot - BUFFALO ORIGMILLERS	Primary Image
Lot Size	75 x 117.5	
Lot Count		
Units Buildable	2644	
Non-Ag Acres		
Topography		
Street Access		
Utilities		
Amenities		
Method	Square-Foot	
Base Lot Value	8,812.50 x .30 = 2,644	
Factor Value		
Adjustments		
Lot Value	2,644	

Residential Data	
Type	1 Single Family Residence
Condition	3 - Average
Quality	3 - Average
Architecture	TRAD TRADITIONAL
Style	100% One Story
Exterior Wall	100% Frame, Siding, Vinyl
Base/Total Area	1,112 / 1,112
Style	100% One Story
HVAC	100% Warmed & Cooled Air
Roof Cover	1 Composition Shingle
Area on Slab	0
Fixture/RghIn	5 /
Bed/F/H Bath	3 / 1.0 /
Basement Area	200 Total, 200 Partition
Garage Type	
Remodel	
Year/Eff Age	1951 / 75

HOUSE	2/23/2024
-------	-----------

GRM Approach	
GRM Code	
Gross Rent	
Indicated Value	

Multiple Regression	
MRA Code	
Adusted R	
Indicated Value	

Direct Comparables	
Selection Model	DEFAULT DEFAULT SELECTION MODEL
Adjustment Model	DEFAULT DEFAULT ADJUSTMENTS TABLE
Comparables	
Indicated Value	

Cost Approach		Manual :	
Base Cost	90.33	Total Misc Impr	+ 1,954
Roofing Adj	+ 4.31	Garage Cost	+
Subfloor Adj	+ 0.00	Total RCN	= 137,006
Heat/Cool Adj	+ 10.77	Depreciation ( 74%)	- 101,384
Plumbing Adj	+ 5.74	Lump Sums	+ 0
Basement Adj	+ 10.30	RCNLD	= 35,622
Adj Base Cost	= 121.45	Lot Value	+ 2,644
Total Area	x 1,112	Indicated Value	= 38,266
Adjusted Cost	= 135,052	Value Per SqFt	34.41

Value Reconciliation			
Selected Approach	Cost Approach		
Improvements	35,622		
Lot Value	2,644		
Indicated Value	38,266	34.41	Per SqFt
Agland Value			
Site Improvements			
Total Value	38,266	34.41	Total Value Per SqFt

Miscellaneous Improvements								
Code	Description	Sketch ID	Size	Year	Units	Unit Cost	Depr	Value
PATO	Slab Porch - Open	3198	10x6		60	9.78		587
PRCH	Slab Porch - Covered	3199	12x5		60	22.78		1,367



Harper

Assessment Property Record Card for Tax Year 2026

Data provided by SHAYLYN WEDER County Assessor

Date 02/06/2026  
 Time 07:05:34  
 Page 3

Sketch Image

300005352

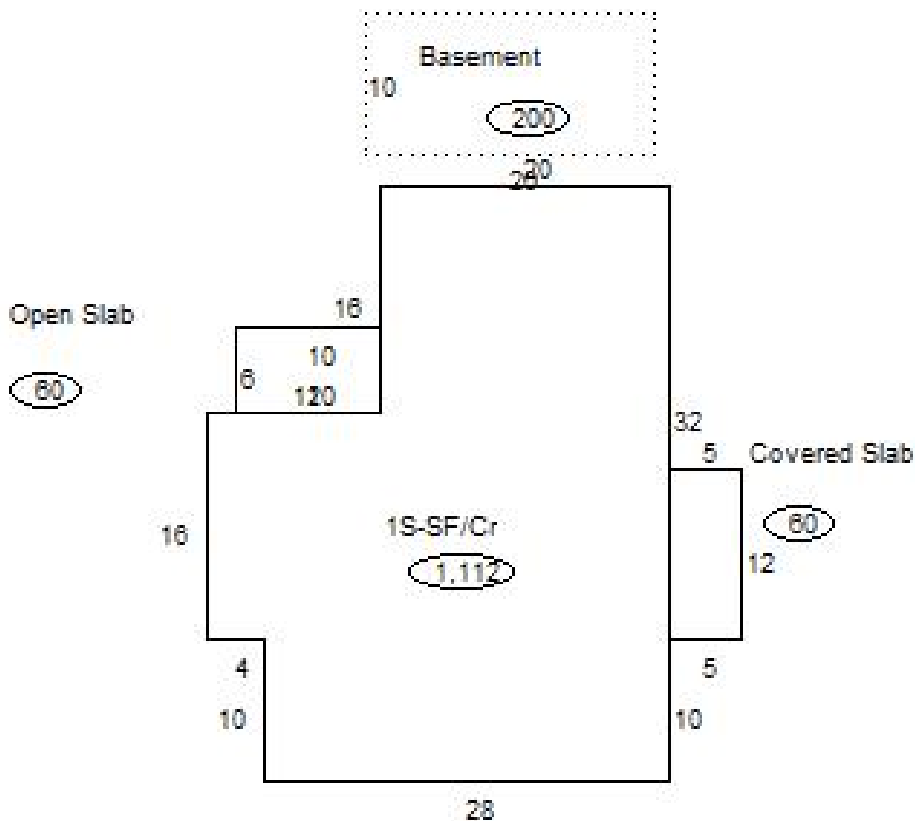

Sketch Vector Information

Sequence	Code	Type	Built Over	Scale	Section Label	Base Area	Multiplier	Total Area
1	B			20	Basement	200	1.000	200
2	M	PATO		20	Open Slab	60	1.000	60
3	M	PRCH		20	Covered Slab	60	1.000	60
4	R	1	Crawl	20	1S-SF/Cr	1,112	1.000	1,112
<b>Total Building Area</b>						<b>1,112</b>		<b>1,112</b>