



Harper

Assessment Property Record Card for Tax Year 2026

Data provided by SHAYLYN WEDER County Assessor

Date 02/06/2026
 Time 07:05:52
 Page 1

Assessment Data					Primary Image																																																																																																																				
Account 300005371 Parcel ID 1070-00-173-009-0-001-00 Cadastral ID 1070-173-009-00-0-001-00 Property Type REAL - Real Property Property Class UR VI Area 2 Tax Area 201 - 4T-BUFFALO-C Name ID 14690 RICHARD, MATTHEW 213 NE 4TH ST. BUFFALO OK 73834-0000 Parcel Location Situs 00213 NE FOURTH ST Subdivision MILLER'S ADDN Lot/Block 0009 / 0173 Parcel Size 4 - Lots Sec/Twn/Rng / / / Neighborhood 100100 - BUFFALO ORIG/MILLERS School District 4-BUFFAL - 4-BUFFALO					<p>1070-00-173-009-0-001-00 02/22/24</p>																																																																																																																				
Legal Description Lat/Long: 36.83678613 -99.62519618 MILLERS ADD. BLOCK 173 LOTS 9-11-13-15 835623																																																																																																																									
Exemptions <table border="1"> <thead> <tr> <th>Code</th> <th>Type</th> <th>Active</th> <th>Maximum</th> <th>Exemption</th> </tr> </thead> <tbody> <tr> <td></td> <td></td> <td></td> <td></td> <td></td> </tr> </tbody> </table>					Code	Type	Active	Maximum	Exemption						Building Permits <table border="1"> <thead> <tr> <th>Number</th> <th>Description</th> <th>Opened</th> <th>Closed</th> <th>Amount</th> </tr> </thead> <tbody> <tr> <td></td> <td></td> <td></td> <td></td> <td></td> </tr> </tbody> </table>					Number	Description	Opened	Closed	Amount																																																																																																	
Code	Type	Active	Maximum	Exemption																																																																																																																					
Number	Description	Opened	Closed	Amount																																																																																																																					
Parcel Valuation <table border="1"> <thead> <tr> <th>Source</th> <th>REAL</th> <th>Fair Cash</th> <th>Capped</th> <th>Asmnt Level</th> <th>Assessed</th> <th>Levy Rate</th> <th>78.740</th> <th>Current Tax</th> </tr> </thead> <tbody> <tr> <td>Remove Cap</td> <td></td> <td>Land Value 3,526</td> <td>3,526</td> <td>12%</td> <td>423</td> <td>Assessed</td> <td>3,406</td> <td>268.19</td> </tr> <tr> <td>Year Frozen</td> <td></td> <td>Improvements 24,855</td> <td>24,855</td> <td></td> <td>2,983</td> <td>Penalty</td> <td>0</td> <td></td> </tr> <tr> <td>Uncapped Value</td> <td>0</td> <td>Mobile Home 0</td> <td>0</td> <td></td> <td>0</td> <td>Exemption</td> <td>0</td> <td>0.00</td> </tr> <tr> <td>TIF Project ID</td> <td>0</td> <td>Total Value 28,381</td> <td>28,381</td> <td></td> <td>3,406</td> <td>Total Taxable</td> <td>3,406</td> <td>268.00</td> </tr> </tbody> </table>					Source	REAL	Fair Cash	Capped	Asmnt Level	Assessed	Levy Rate	78.740	Current Tax	Remove Cap		Land Value 3,526	3,526	12%	423	Assessed	3,406	268.19	Year Frozen		Improvements 24,855	24,855		2,983	Penalty	0		Uncapped Value	0	Mobile Home 0	0		0	Exemption	0	0.00	TIF Project ID	0	Total Value 28,381	28,381		3,406	Total Taxable	3,406	268.00	Sale History <table border="1"> <thead> <tr> <th>Bk/Pg</th> <th>Grantor</th> <th>Date</th> <th>Price</th> <th>Code</th> </tr> </thead> <tbody> <tr> <td>709/835</td> <td>COSGRAVE, APRIL</td> <td>07/24/2015</td> <td>12,000</td> <td>16</td> </tr> <tr> <td>709/623</td> <td>OPFERMAN, DAVID J.</td> <td>07/07/2015</td> <td>18,000</td> <td>PQ</td> </tr> <tr> <td>617/139</td> <td>ROBERTS, IRA DON, ETUX</td> <td>08/30/2006</td> <td>16,000</td> <td>U</td> </tr> <tr> <td>549/16</td> <td>BUSS, MACY DELL</td> <td>09/16/1999</td> <td>7,500</td> <td>PQ</td> </tr> </tbody> </table>					Bk/Pg	Grantor	Date	Price	Code	709/835	COSGRAVE, APRIL	07/24/2015	12,000	16	709/623	OPFERMAN, DAVID J.	07/07/2015	18,000	PQ	617/139	ROBERTS, IRA DON, ETUX	08/30/2006	16,000	U	549/16	BUSS, MACY DELL	09/16/1999	7,500	PQ																																										
Source	REAL	Fair Cash	Capped	Asmnt Level	Assessed	Levy Rate	78.740	Current Tax																																																																																																																	
Remove Cap		Land Value 3,526	3,526	12%	423	Assessed	3,406	268.19																																																																																																																	
Year Frozen		Improvements 24,855	24,855		2,983	Penalty	0																																																																																																																		
Uncapped Value	0	Mobile Home 0	0		0	Exemption	0	0.00																																																																																																																	
TIF Project ID	0	Total Value 28,381	28,381		3,406	Total Taxable	3,406	268.00																																																																																																																	
Bk/Pg	Grantor	Date	Price	Code																																																																																																																					
709/835	COSGRAVE, APRIL	07/24/2015	12,000	16																																																																																																																					
709/623	OPFERMAN, DAVID J.	07/07/2015	18,000	PQ																																																																																																																					
617/139	ROBERTS, IRA DON, ETUX	08/30/2006	16,000	U																																																																																																																					
549/16	BUSS, MACY DELL	09/16/1999	7,500	PQ																																																																																																																					
Assessment History <table border="1"> <thead> <tr> <th>Tax Year</th> <th>Statement Number</th> <th>Billed Owner</th> <th>Tax Area</th> <th>Total Value</th> <th>Exemptions</th> <th>Taxable Value</th> <th>Billed Tax</th> </tr> </thead> <tbody> <tr><td>2025</td><td>2025-300005371</td><td>RICHARD, MATTHEW</td><td>201</td><td>28,381</td><td>0</td><td>3,350</td><td>264.00</td></tr> <tr><td>2024</td><td>2024-300005371</td><td>RICHARD, MATTHEW</td><td>201</td><td>30,295</td><td>0</td><td>3,191</td><td>260.00</td></tr> <tr><td>2023</td><td>2023-300005371</td><td>RICHARD, MATTHEW</td><td>201</td><td>27,946</td><td>0</td><td>3,039</td><td>251.00</td></tr> <tr><td>2022</td><td>2022-300005371</td><td>RICHARD, MATTHEW</td><td>201</td><td>24,558</td><td>0</td><td>2,894</td><td>238.00</td></tr> <tr><td>2021</td><td>2021-300005371</td><td>RICHARD, MATTHEW</td><td>201</td><td>26,042</td><td>0</td><td>2,756</td><td>228.00</td></tr> <tr><td>2020</td><td>2020-300005371</td><td>RICHARD, MATTHEW</td><td>201</td><td>25,112</td><td>0</td><td>2,625</td><td>216.00</td></tr> <tr><td>2019</td><td>2019-0005371</td><td>RICHARD, MATTHEW</td><td>201</td><td>25,112</td><td></td><td>2,501</td><td>207.00</td></tr> <tr><td>2018</td><td>2018-0005371</td><td>RICHARD, MATTHEW</td><td>201</td><td>25,112</td><td></td><td>2,382</td><td>198.00</td></tr> <tr><td>2017</td><td>2017-0005371</td><td>RICHARD, MATTHEW</td><td>201</td><td>25,112</td><td></td><td>2,268</td><td>189.00</td></tr> <tr><td>2016</td><td>2016-0005371</td><td>RICHARD, MATTHEW</td><td>201</td><td>18,000</td><td></td><td>2,160</td><td>184.00</td></tr> <tr><td>2015</td><td>2015-0005371</td><td>RICHARD, MATTHEW</td><td>201</td><td>25,174</td><td></td><td>1,225</td><td>97.00</td></tr> <tr><td>2014</td><td>2014-0005371</td><td>OPFERMAN, DAVID J.</td><td>201</td><td>25,174</td><td></td><td>1,166</td><td>93.00</td></tr> <tr><td>2013</td><td>2013-0005371</td><td>OPFERMAN, DAVID J.</td><td>201</td><td>24,886</td><td></td><td>1,111</td><td>88.00</td></tr> </tbody> </table>										Tax Year	Statement Number	Billed Owner	Tax Area	Total Value	Exemptions	Taxable Value	Billed Tax	2025	2025-300005371	RICHARD, MATTHEW	201	28,381	0	3,350	264.00	2024	2024-300005371	RICHARD, MATTHEW	201	30,295	0	3,191	260.00	2023	2023-300005371	RICHARD, MATTHEW	201	27,946	0	3,039	251.00	2022	2022-300005371	RICHARD, MATTHEW	201	24,558	0	2,894	238.00	2021	2021-300005371	RICHARD, MATTHEW	201	26,042	0	2,756	228.00	2020	2020-300005371	RICHARD, MATTHEW	201	25,112	0	2,625	216.00	2019	2019-0005371	RICHARD, MATTHEW	201	25,112		2,501	207.00	2018	2018-0005371	RICHARD, MATTHEW	201	25,112		2,382	198.00	2017	2017-0005371	RICHARD, MATTHEW	201	25,112		2,268	189.00	2016	2016-0005371	RICHARD, MATTHEW	201	18,000		2,160	184.00	2015	2015-0005371	RICHARD, MATTHEW	201	25,174		1,225	97.00	2014	2014-0005371	OPFERMAN, DAVID J.	201	25,174		1,166	93.00	2013	2013-0005371	OPFERMAN, DAVID J.	201	24,886		1,111	88.00
Tax Year	Statement Number	Billed Owner	Tax Area	Total Value	Exemptions	Taxable Value	Billed Tax																																																																																																																		
2025	2025-300005371	RICHARD, MATTHEW	201	28,381	0	3,350	264.00																																																																																																																		
2024	2024-300005371	RICHARD, MATTHEW	201	30,295	0	3,191	260.00																																																																																																																		
2023	2023-300005371	RICHARD, MATTHEW	201	27,946	0	3,039	251.00																																																																																																																		
2022	2022-300005371	RICHARD, MATTHEW	201	24,558	0	2,894	238.00																																																																																																																		
2021	2021-300005371	RICHARD, MATTHEW	201	26,042	0	2,756	228.00																																																																																																																		
2020	2020-300005371	RICHARD, MATTHEW	201	25,112	0	2,625	216.00																																																																																																																		
2019	2019-0005371	RICHARD, MATTHEW	201	25,112		2,501	207.00																																																																																																																		
2018	2018-0005371	RICHARD, MATTHEW	201	25,112		2,382	198.00																																																																																																																		
2017	2017-0005371	RICHARD, MATTHEW	201	25,112		2,268	189.00																																																																																																																		
2016	2016-0005371	RICHARD, MATTHEW	201	18,000		2,160	184.00																																																																																																																		
2015	2015-0005371	RICHARD, MATTHEW	201	25,174		1,225	97.00																																																																																																																		
2014	2014-0005371	OPFERMAN, DAVID J.	201	25,174		1,166	93.00																																																																																																																		
2013	2013-0005371	OPFERMAN, DAVID J.	201	24,886		1,111	88.00																																																																																																																		



Harper

Assessment Property Record Card for Tax Year 2026

Data provided by SHAYLYN WEDER County Assessor

Date 02/06/2026
 Time 07:05:52
 Page 2

Lot Data	Square-Foot - BUFFALO ORIGMILLERS	Primary Image
Lot Size	0 0	
Lot Count		
Units Buildable	3526	
Non-Ag Acres		
Topography		
Street Access		
Utilities		
Amenities		
Method	Square-Foot	
Base Lot Value	11,752.00 x .30 = 3,526	
Factor Value		
Adjustments		
Lot Value	3,526	

Residential Data	
Type	1 Single Family Residence
Condition	3 - Average
Quality	3 - Average
Architecture	TRAD TRADITIONAL
Style	100% One Story
Exterior Wall	100% Frame, Stucco
Base/Total Area	1,004 / 1,004
Style	100% One Story
HVAC	100% Floor Furnace 1 Wall Air Conditioners (Cour
Roof Cover	4 Metal, Preformed
Area on Slab	0
Fixture/RghIn	5 /
Bed/F/H Bath	2 / 1.0 /
Basement Area	
Garage Type	432 Detached Garage - Unfinished
Remodel	
Year/Eff Age	1941 / 85

HOUSE	2/23/2024
-------	-----------

GRM Approach	
GRM Code	
Gross Rent	
Indicated Value	

Multiple Regression	
MRA Code	
Adusted R	
Indicated Value	

Direct Comparables	
Selection Model	DEFAULT DEFAULT SELECTION MODEL
Adjustment Model	DEFAULT DEFAULT ADJUSTMENTS TABLE
Comparables	
Indicated Value	

Cost Approach		Manual :	
Base Cost	94.66	Total Misc Impr	+ 1,152
Roofing Adj	+ 5.17	Garage Cost	+ 15,981
Subfloor Adj	+ 0.00	Total RCN	= 125,485
Heat/Cool Adj	+ 1.73	Depreciation (80%)	- 100,388
Plumbing Adj	+ 6.36	Lump Sums	+ 0
Basement Adj	+ 0.00	RCNLD	= 25,097
Adj Base Cost	= 107.92	Lot Value	+ 3,526
Total Area	x 1,004	Indicated Value	= 28,623
Adjusted Cost	= 108,352	Value Per SqFt	28.51

Value Reconciliation			
Selected Approach	Cost Approach		
Improvements	25,097		
Lot Value	3,526		
Indicated Value	28,623	28.51	Per SqFt
Agland Value			
Site Improvements			
Total Value	28,623	28.51	Total Value Per SqFt

Miscellaneous Improvements								
Code	Description	Sketch ID	Size	Year	Units	Unit Cost	Depr	Value
PATO	Slab Porch - Open	3261	12x3		36	9.78		352
PRCH	Slab Porch - Covered	3263	7x5		35	22.85		800



Harper

Assessment Property Record Card for Tax Year 2026

Data provided by SHAYLYN WEDER County Assessor

Date 02/06/2026
 Time 07:05:52
 Page 3

Sketch Image

300005371

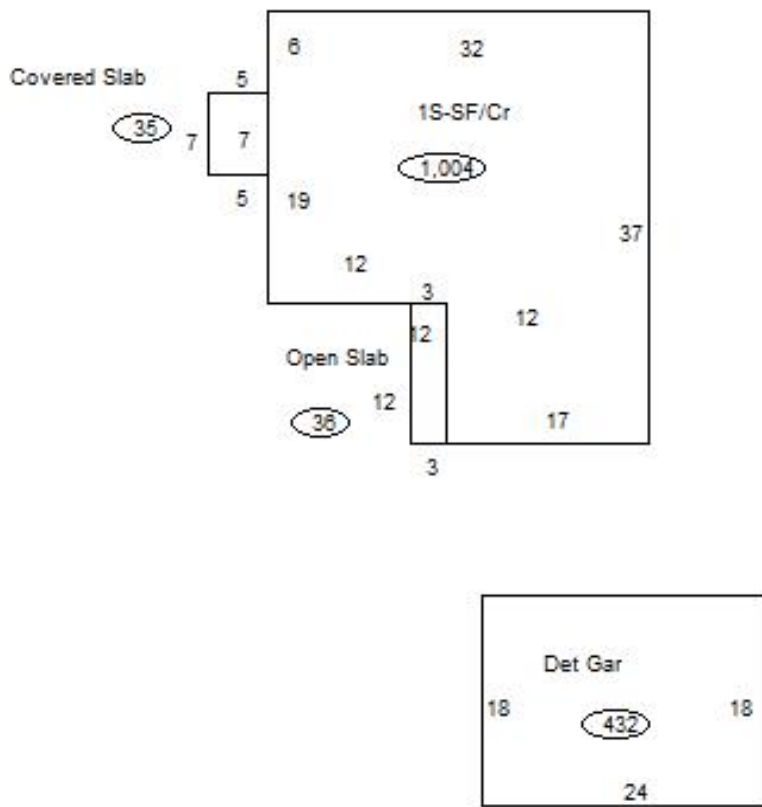

Sketch Vector Information

Sequence	Code	Type	Built Over	Scale	Section Label	Base Area	Multiplier	Total Area
1	R	1	Crawl	20	1S-SF/Cr	1,004	1.000	1,004
2	M	PATO		20	Open Slab	36	1.000	36
3	G	2		20	Det Gar	432	1.000	432
4	M	PRCH		20	Covered Slab	35	1.000	35
Total Building Area						1,004		1,004