



Harper

Assessment Property Record Card for Tax Year 2026

Data provided by SHAYLYN WEDER County Assessor

Date 02/06/2026
 Time 07:07:43
 Page 1

Assessment Data					Primary Image														
Account 300005486 Parcel ID 1070-00-211-001-0-001-00 Cadastral ID 1070-211-001-00-0-001-00 Property Type REAL - Real Property Property Class UR VI Area 2 Tax Area 201 - 4T-BUFFALO-C Name ID 14762 WALKER, JAY LYNN & DAYNA N. WALKER PO BOX 82 BUFFALO OK 73834-0000 Parcel Location Situs 00421 NW SECOND ST Subdivision MILLER'S ADDN Lot/Block 0001 / 0211 Parcel Size 5 - Lots Sec/Twn/Rng / / / Neighborhood 100100 - BUFFALO ORIG/MILLERS School District 4-BUFFAL - 4-BUFFALO					<p>1070-00-211-001-0-001-00 02/22/24</p>														
HOUSE / PORCH 3/4/2024																			
Legal Description Lat/Long: 36.83532810 -99.63021752					Building Permits														
MILLERS ADD BLOCK 211 LOTS 1-3-5-7-9					<table border="1"> <thead> <tr> <th>Number</th> <th>Description</th> <th>Opened</th> <th>Closed</th> <th>Amount</th> </tr> </thead> <tbody> <tr> <td> </td> <td> </td> <td> </td> <td> </td> <td> </td> </tr> </tbody> </table>					Number	Description	Opened	Closed	Amount					
Number	Description	Opened	Closed	Amount															
Exemptions					Sale History														
Code	Type	Active	Maximum	Exemption	Bk/Pg	Grantor	Date	Price	Code										
H	Homestead	Yes	1,000	1,000	/	WALKER, JAY LYNN &													
Parcel Valuation																			
Source	REAL	Fair Cash	Capped	Asmnt Level	Assessed	Levy Rate	78.740	Current Tax											
Remove Cap		Land Value	4,406	4,057	12%	487	Assessed	4,167	328.11										
Year Frozen		Improvements	43,211	30,668		3,680	Penalty	0											
Uncapped Value	0	Mobile Home	0	0		0	Exemption	1,000	-79.00										
TIF Project ID	0	Total Value	47,617	34,725		4,167	Total Taxable	3,167	249.00										
Assessment History																			
Tax Year	Statement Number	Billed Owner	Tax Area	Total Value	Exemptions	Taxable Value	Billed Tax												
2025	2025-300005486	WALKER, JAY LYNN &	201	47,617	1000	3,046	240.00												
2024	2024-300005486	WALKER, JAY LYNN &	201	49,008	1000	2,928	238.00												
2023	2023-300005486	WALKER, JAY LYNN &	201	41,151	1000	2,814	233.00												
2022	2022-300005486	WALKER, JAY LYNN &	201	36,011	1000	2,702	222.00												
2021	2021-300005486	WALKER, JAY LYNN &	201	36,360	1000	2,595	214.00												
2020	2020-300005486	WALKER, JAY LYNN &	201	36,586	1000	2,490	205.00												
2019	2019-0005486	WALKER, JAY LYNN &	201	36,586		2,388	198.00												
2018	2018-0005486	WALKER, JAY LYNN &	201	36,586		2,289	190.00												
2017	2017-0005486	WALKER, JAY LYNN &	201	36,586		2,195	182.00												
2016	2016-0005486	WALKER, JAY LYNN &	201	36,586		2,101	179.00												
2015	2015-0005486	WALKER, JAY LYNN &	201	37,579		2,011	160.00												
2014	2014-0005486	WALKER, JAY LYNN &	201	37,579		1,923	154.00												
2013	2013-0005486	WALKER, JAY LYNN &	201	37,851		1,838	146.00												



Harper

Assessment Property Record Card for Tax Year 2026

Data provided by SHAYLYN WEDER County Assessor

Date 02/06/2026
 Time 07:07:44
 Page 2

Lot Data	Square-Foot - BUFFALO ORIGMILLERS	Primary Image
Lot Size	125 x 117.5	
Lot Count		
Units Buildable	4406	
Non-Ag Acres		
Topography		
Street Access		
Utilities		
Amenities		
Method	Square-Foot	
Base Lot Value	14,687.50 x .30 = 4,406	
Factor Value		
Adjustments		
Lot Value	4,406	

Residential Data	
Type	1 Single Family Residence
Condition	3 - Average
Quality	2.5 - Fair
Architecture	TRAD TRADITIONAL
Style	100% One Story
Exterior Wall	100% Frame, Plywood or Hardboard
Base/Total Area	1,222 / 1,222
Style	100% One Story
HVAC	100% Warmed & Cooled Air
Roof Cover	1 Composition Shingle
Area on Slab	0
Fixture/RghIn	8 /
Bed/F/H Bath	3 / 2.0 /
Basement Area	
Garage Type	336 Detached Garage - Unfinished
Remodel	
Year/Eff Age	1958 / 68

1070-00-211-001-0-001-00	02/22/24
HOUSE / PORCH	3/4/2024

GRM Approach
GRM Code
Gross Rent
Indicated Value

Multiple Regression
MRA Code
Adusted R
Indicated Value

Direct Comparables		
Selection Model	DEFAULT	DEFAULT SELECTION MODEL
Adjustment Model	DEFAULT	DEFAULT ADJUSTMENTS TABLE
Comparables		
Indicated Value		

Cost Approach		Manual :	
Base Cost	80.09	Total Misc Impr	+ 9,412
Roofing Adj	+ 3.78	Garage Cost	+ 10,804
Subfloor Adj	+ 0.99	Total RCN	= 144,750
Heat/Cool Adj	+ 9.78	Depreciation (71%)	- 102,773
Plumbing Adj	+ 7.28	Lump Sums	+ 0
Basement Adj	+ 0.00	RCNLD	= 41,977
Adj Base Cost	= 101.91	Lot Value	+ 4,406
Total Area	x 1,222	Indicated Value	= 46,383
Adjusted Cost	= 124,534	Value Per SqFt	37.96

Value Reconciliation			
Selected Approach	Cost Approach		
Improvements	41,977		
Lot Value	4,406		
Indicated Value	46,383	37.96	Per SqFt
Agland Value			
Site Improvements			
Total Value	46,383	37.96	Total Value Per SqFt

Miscellaneous Improvements								
Code	Description	Sketch ID	Size	Year	Units	Unit Cost	Depr	Value
RSPC	Raised Slab Porch - Covered	3617	19x8		152	35.75		5,434
PATC	Patio - Covered	11653	20x16		320	12.43		3,978



Harper

Assessment Property Record Card for Tax Year 2026

Data provided by SHAYLYN WEDER County Assessor

Date 02/06/2026
 Time 07:07:44
 Page 3

Sketch Image

300005486

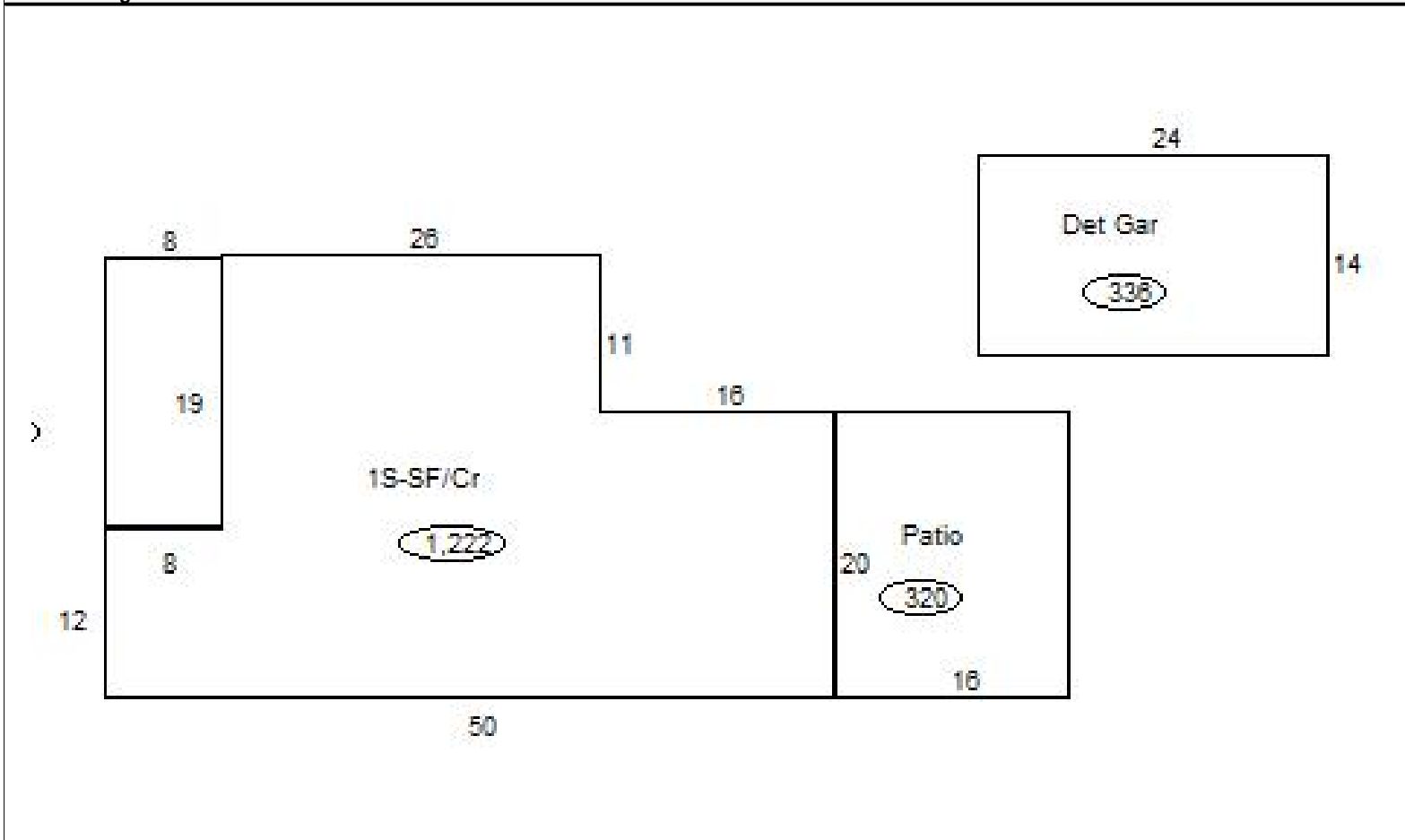

Sketch Vector Information

Sequence	Code	Type	Built Over	Scale	Section Label	Base Area	Multiplier	Total Area
1	M	RSPC		20	Porch	152	1.000	152
2	G	2		20	Det Gar	336	1.000	336
3	R	1	Crawl	20	1S-SF/Cr	1,222	1.000	1,222
4	M	PATC		20	Patio	320	1.000	320
Total Building Area						1,222		1,222