



Harper

Assessment Property Record Card for Tax Year 2026

Data provided by SHAYLYN WEDER County Assessor

Date 02/06/2026
 Time 07:07:51
 Page 1

Assessment Data					Primary Image														
Account 300005493 Parcel ID 1070-00-211-019-0-001-00 Cadastral ID 1070-211-019-00-0-001-00 Property Type REAL - Real Property Property Class UR VI Area 2 Tax Area 201 - 4T-BUFFALO-C Name ID 14768 WILKINSON, PAM P O BOX 675 BUFFALO OK 73834-0000 Parcel Location Situs 00207 E ADAMS ST Subdivision MILLER'S ADDN Lot/Block 0019 / 0211 Parcel Size 3 - Lots Sec/Twn/Rng / / / Neighborhood 100100 - BUFFALO ORIG/MILLERS School District 4-BUFFAL - 4-BUFFALO					 <p>1070-00-211-019-0-001-00 02/22/24</p>														
HOUSE / FRONT PORCH 3/4/2024																			
Legal Description Lat/Long: 36.83837330 -99.63059160					Building Permits														
MILLERS ADD BLOCK 211 LOTS 19-21-23					<table border="1"> <thead> <tr> <th>Number</th> <th>Description</th> <th>Opened</th> <th>Closed</th> <th>Amount</th> </tr> </thead> <tbody> <tr> <td> </td> <td> </td> <td> </td> <td> </td> <td> </td> </tr> </tbody> </table>					Number	Description	Opened	Closed	Amount					
Number	Description	Opened	Closed	Amount															
Exemptions					Sale History														
Code	Type	Active	Maximum	Exemption	Bk/Pg	Grantor	Date	Price	Code										
					/	WILKINSON, PAM													
Parcel Valuation																			
Source	REAL		Fair Cash	Capped	Asmnt Level	Assessed	Levy Rate	78.740	Current Tax										
Remove Cap		Land Value	2,644	2,644	12%	317	Assessed	3,903	307.32										
Year Frozen		Improvements	29,884	29,884		3,586	Penalty	0											
Uncapped Value	0	Mobile Home	0	0		0	Exemption	0	0.00										
TIF Project ID	0	Total Value	32,528	32,528		3,903	Total Taxable	3,903	307.00										
Assessment History																			
Tax Year	Statement Number	Billed Owner			Tax Area	Total Value	Exemptions	Taxable Value	Billed Tax										
2025	2025-300005493	WILKINSON, PAM			201	32,528	0	3,814	300.00										
2024	2024-300005493	WILKINSON, PAM			201	35,995	0	3,633	296.00										
2023	2023-300005493	WILKINSON, PAM			201	32,939	0	3,460	286.00										
2022	2022-300005493	WILKINSON, PAM			201	27,461	0	3,295	271.00										
2021	2021-300005493	WILKINSON, PAM			201	28,141	0	3,377	279.00										
2020	2020-300005493	WILKINSON, PAM			201	28,062	0	3,367	277.00										
2019	2019-0005493	WILKINSON, PAM			201	28,062		3,367	279.00										
2018	2018-0005493	WILKINSON, PAM			201	28,062		3,367	279.00										
2017	2017-0005493	WILKINSON, PAM			201	28,062		3,367	280.00										
2016	2016-0005493	WILKINSON, PAM			201	28,062		3,244	276.00										
2015	2015-0005493	WILKINSON, PAM			201	28,156		2,090	166.00										
2014	2014-0005493	WYSCAVER, WANDA			201	28,156		2,000	160.00										
2013	2013-0005493	WYSCAVER, WANDA			201	31,494		1,912	152.00										



Harper

Assessment Property Record Card for Tax Year 2026

Data provided by SHAYLYN WEDER County Assessor

Date 02/06/2026
 Time 07:07:51
 Page 2

Lot Data	Square-Foot - BUFFALO ORIGMILLERS	Primary Image
Lot Size	75 x 117.5	
Lot Count		
Units Buildable	2644	
Non-Ag Acres		
Topography		
Street Access		
Utilities		
Amenities		
Method	Square-Foot	
Base Lot Value	8,812.50 x .30 = 2,644	
Factor Value		
Adjustments		
Lot Value	2,644	

Residential Data	
Type	1 Single Family Residence
Condition	3.25 - Average
Quality	3 - Average
Architecture	TRAD TRADITIONAL
Style	100% One Story
Exterior Wall	100% Frame, Siding, Vinyl
Base/Total Area	1,064 / 1,064
Style	100% One Story
HVAC	100% Floor Furnace 1 Wall Air Conditioners (Cour
Roof Cover	1 Composition Shingle
Area on Slab	0
Fixture/RghIn	5 /
Bed/F/H Bath	2 / 1.0 /
Basement Area	
Garage Type	560 Detached Garage - Finished
Remodel	
Year/Eff Age	1940 / 82

HOUSE / FRONT PORCH	3/4/2024
---------------------	----------

GRM Approach	
GRM Code	
Gross Rent	
Indicated Value	

Multiple Regression	
MRA Code	
Adjusted R	
Indicated Value	

Direct Comparables	
Selection Model	DEFAULT DEFAULT SELECTION MODEL
Adjustment Model	DEFAULT DEFAULT ADJUSTMENTS TABLE
Comparables	
Indicated Value	

Cost Approach		Manual :	
Base Cost	91.39	Total Misc Impr	+ 3,549
Roofing Adj	+ 4.35	Garage Cost	+ 22,191
Subfloor Adj	+ 0.00	Total RCN	= 135,821
Heat/Cool Adj	+ 1.73	Depreciation (78%)	- 105,940
Plumbing Adj	+ 5.99	Lump Sums	+ 0
Basement Adj	+ 0.00	RCNLD	= 29,881
Adj Base Cost	= 103.46	Lot Value	+ 2,644
Total Area	x 1,064	Indicated Value	= 32,525
Adjusted Cost	= 110,081	Value Per SqFt	30.57

Value Reconciliation			
Selected Approach	Cost Approach		
Improvements	29,881		
Lot Value	2,644		
Indicated Value	32,525	30.57	Per SqFt
Agland Value			
Site Improvements	280		
Total Value	32,805	30.83	Total Value Per SqFt

Miscellaneous Improvements								
Code	Description	Sketch ID	Size	Year	Units	Unit Cost	Depr	Value
RSPC	Raised Slab Porch - Covered	3633	8x5		40	40.35		1,614
RSPC	Raised Slab Porch - Covered	3634	8x6		48	40.31		1,935



Harper

Assessment Property Record Card for Tax Year 2026

Data provided by SHAYLYN WEDER County Assessor

Date 02/06/2026
 Time 07:07:51
 Page 3

Sketch Image

300005493

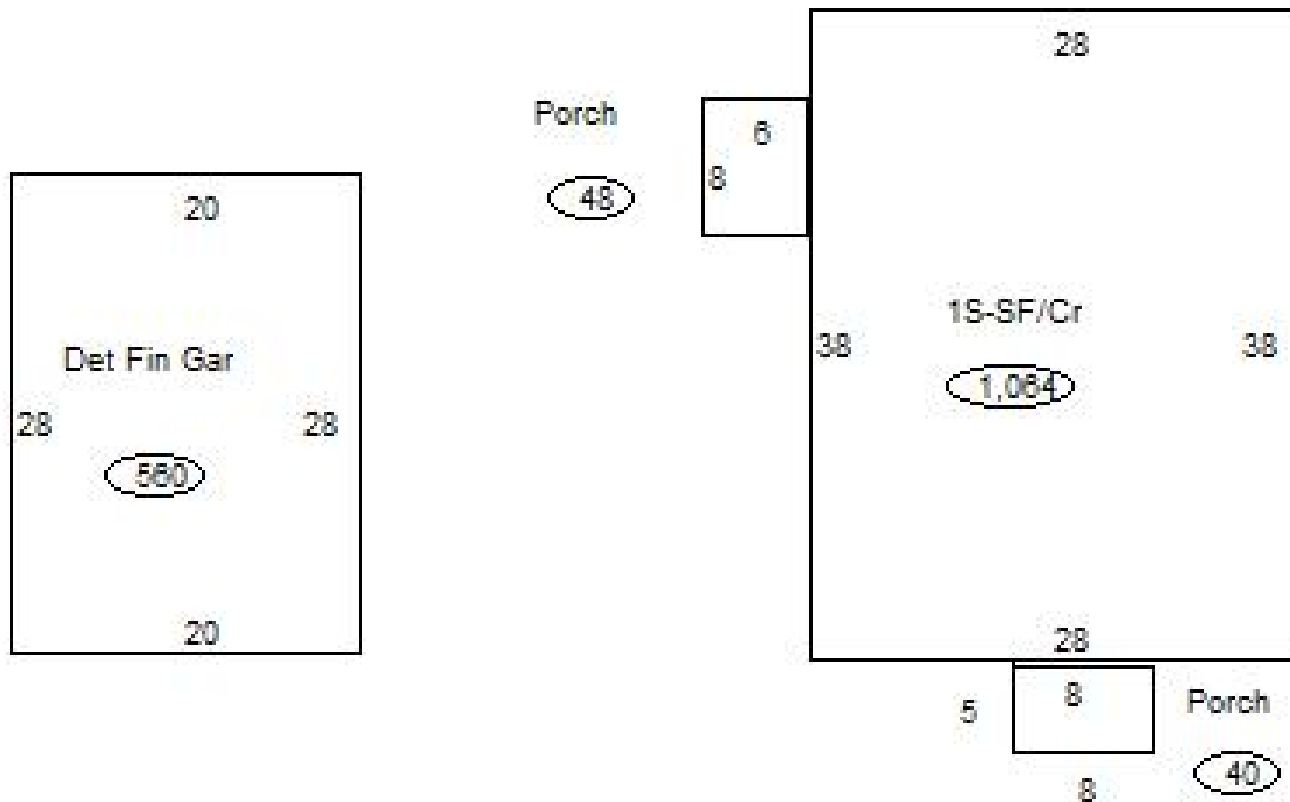

Sketch Vector Information

Sequence	Code	Type	Built Over	Scale	Section Label	Base Area	Multiplier	Total Area
1	R	1	Crawl	20	1S-SF/Cr	1,064	1.000	1,064
2	M	RSPC		20	Porch	40	1.000	40
3	M	RSPC		20	Porch	48	1.000	48
4	G	6		20	Det Fin Gar	560	1.000	560
Total Building Area						1,064		1,064



Harper



Assessment Property Record Card for Tax Year 2026

Data provided by SHAYLYN WEDER County Assessor

Date 02/06/2026
Time 07:07:51
Page 4

300005493

Outbuildings/Site Improvements

Building Image	Code	Description	Dimensions	Floor	Roofing	Total Units
	PACN	Paving - Concrete/ SIDEWALK	16x2x0	Concrete		32
	Qual	2	Cond 2	Year 1940	Eff Age 103	
	Valuation Summary		Modifier Total	RCN	Depr (80% Phys/ % Func)	RCNLD
	Base Cost (7.17 x 32)		229		229 183	46
	PACN	Paving - Concrete / DRIVEWAY	22x16x0	Concrete		352
	Qual	1	Cond 1	Year 1940	Eff Age 120	
	Valuation Summary		Modifier Total	RCN	Depr (80% Phys/ % Func)	RCNLD
	Base Cost (3.33 x 352)		1,172		1,172 938	234