



Harper

Assessment Property Record Card for Tax Year 2026

Data provided by SHAYLYN WEDER County Assessor

Date 02/06/2026
Time 07:09:02
Page 1

Assessment Data					Primary Image																																																																																																																				
Account 300005569 Parcel ID 1070-00-233-017-0-001-00 Cadastral ID 1070-233-017-00-0-001-00 Property Type REAL - Real Property Property Class UR VI Area 3 Tax Area 201 - 4T-BUFFALO-C Name ID 14817 NICHOLS, DANELL P O BOX 391 BUFFALO OK 73834-0000 Parcel Location Situs 00513 NW SECOND ST Subdivision MILLER'S ADDN Lot/Block 0017 / 0233 Parcel Size 4 - Lots Sec/Twn/Rng / / / Neighborhood 100100 - BUFFALO ORIG/MILLERS School District 4-BUFFAL - 4-BUFFALO					 <p>1070-00-233-017-0-001-00 02/24/25</p> <p>FRONT OF HOUSE 2/24/2025</p>																																																																																																																				
Legal Description Lat/Long: 36.83395554 -99.63095016 MILLERS ADD. BLOCK 233 LOTS 17-19-21-23																																																																																																																									
Exemptions <table border="1"> <thead> <tr> <th>Code</th> <th>Type</th> <th>Active</th> <th>Maximum</th> <th>Exemption</th> </tr> </thead> <tbody> <tr> <td>H</td> <td>Homestead</td> <td>Yes</td> <td>1,000</td> <td>1,000</td> </tr> </tbody> </table>					Code	Type	Active	Maximum	Exemption	H	Homestead	Yes	1,000	1,000	Building Permits <table border="1"> <thead> <tr> <th>Number</th> <th>Description</th> <th>Opened</th> <th>Closed</th> <th>Amount</th> </tr> </thead> <tbody> <tr> <td>608/664</td> <td>JUNGHANNS, DWAINE R. ETUX</td> <td>11/29/2005</td> <td></td> <td>59,500 Q</td> </tr> <tr> <td>516/535</td> <td>WAYMIER, MARY JULIA, ETAL</td> <td>06/15/1996</td> <td></td> <td>24,000 PQ</td> </tr> </tbody> </table>					Number	Description	Opened	Closed	Amount	608/664	JUNGHANNS, DWAINE R. ETUX	11/29/2005		59,500 Q	516/535	WAYMIER, MARY JULIA, ETAL	06/15/1996		24,000 PQ																																																																																							
Code	Type	Active	Maximum	Exemption																																																																																																																					
H	Homestead	Yes	1,000	1,000																																																																																																																					
Number	Description	Opened	Closed	Amount																																																																																																																					
608/664	JUNGHANNS, DWAINE R. ETUX	11/29/2005		59,500 Q																																																																																																																					
516/535	WAYMIER, MARY JULIA, ETAL	06/15/1996		24,000 PQ																																																																																																																					
Parcel Valuation <table border="1"> <thead> <tr> <th>Source</th> <th>REAL</th> <th>Fair Cash</th> <th>Capped</th> <th>Asmnt Level</th> <th>Assessed</th> <th>Levy Rate</th> <th>78.740</th> <th>Current Tax</th> </tr> </thead> <tbody> <tr> <td>Remove Cap</td> <td></td> <td>Land Value 3,525</td> <td>3,525</td> <td>12%</td> <td>423</td> <td>Assessed</td> <td>7,041</td> <td>554.41</td> </tr> <tr> <td>Year Frozen</td> <td></td> <td>Improvements 61,661</td> <td>55,151</td> <td></td> <td>6,618</td> <td>Penalty</td> <td>0</td> <td></td> </tr> <tr> <td>Uncapped Value</td> <td>0</td> <td>Mobile Home 0</td> <td>0</td> <td></td> <td>0</td> <td>Exemption</td> <td>1,000</td> <td>-78.00</td> </tr> <tr> <td>TIF Project ID</td> <td>0</td> <td>Total Value 65,186</td> <td>58,676</td> <td></td> <td>7,041</td> <td>Total Taxable</td> <td>6,041</td> <td>476.00</td> </tr> </tbody> </table>					Source	REAL	Fair Cash	Capped	Asmnt Level	Assessed	Levy Rate	78.740	Current Tax	Remove Cap		Land Value 3,525	3,525	12%	423	Assessed	7,041	554.41	Year Frozen		Improvements 61,661	55,151		6,618	Penalty	0		Uncapped Value	0	Mobile Home 0	0		0	Exemption	1,000	-78.00	TIF Project ID	0	Total Value 65,186	58,676		7,041	Total Taxable	6,041	476.00	Sale History <table border="1"> <thead> <tr> <th>Bk/Pg</th> <th>Grantor</th> <th>Date</th> <th>Price</th> <th>Code</th> </tr> </thead> <tbody> <tr> <td>608/664</td> <td>JUNGHANNS, DWAINE R. ETUX</td> <td>11/29/2005</td> <td>59,500</td> <td>Q</td> </tr> <tr> <td>516/535</td> <td>WAYMIER, MARY JULIA, ETAL</td> <td>06/15/1996</td> <td>24,000</td> <td>PQ</td> </tr> </tbody> </table>					Bk/Pg	Grantor	Date	Price	Code	608/664	JUNGHANNS, DWAINE R. ETUX	11/29/2005	59,500	Q	516/535	WAYMIER, MARY JULIA, ETAL	06/15/1996	24,000	PQ																																																				
Source	REAL	Fair Cash	Capped	Asmnt Level	Assessed	Levy Rate	78.740	Current Tax																																																																																																																	
Remove Cap		Land Value 3,525	3,525	12%	423	Assessed	7,041	554.41																																																																																																																	
Year Frozen		Improvements 61,661	55,151		6,618	Penalty	0																																																																																																																		
Uncapped Value	0	Mobile Home 0	0		0	Exemption	1,000	-78.00																																																																																																																	
TIF Project ID	0	Total Value 65,186	58,676		7,041	Total Taxable	6,041	476.00																																																																																																																	
Bk/Pg	Grantor	Date	Price	Code																																																																																																																					
608/664	JUNGHANNS, DWAINE R. ETUX	11/29/2005	59,500	Q																																																																																																																					
516/535	WAYMIER, MARY JULIA, ETAL	06/15/1996	24,000	PQ																																																																																																																					
Assessment History <table border="1"> <thead> <tr> <th>Tax Year</th> <th>Statement Number</th> <th>Billed Owner</th> <th>Tax Area</th> <th>Total Value</th> <th>Exemptions</th> <th>Taxable Value</th> <th>Billed Tax</th> </tr> </thead> <tbody> <tr><td>2025</td><td>2025-300005569</td><td>NICHOLS, DANELL</td><td>201</td><td>65,186</td><td>1000</td><td>5,836</td><td>460.00</td></tr> <tr><td>2024</td><td>2024-300005569</td><td>NICHOLS, DANELL</td><td>201</td><td>71,879</td><td>1000</td><td>5,637</td><td>459.00</td></tr> <tr><td>2023</td><td>2023-300005569</td><td>NICHOLS, DANELL</td><td>201</td><td>67,532</td><td>1000</td><td>5,444</td><td>450.00</td></tr> <tr><td>2022</td><td>2022-300005569</td><td>NICHOLS, DANELL</td><td>201</td><td>56,542</td><td>1000</td><td>5,256</td><td>432.00</td></tr> <tr><td>2021</td><td>2021-300005569</td><td>NICHOLS, DANELL</td><td>201</td><td>50,616</td><td>1000</td><td>5,074</td><td>419.00</td></tr> <tr><td>2020</td><td>2020-300005569</td><td>NICHOLS, DANELL</td><td>201</td><td>50,616</td><td>1000</td><td>5,074</td><td>418.00</td></tr> <tr><td>2019</td><td>2019-0005569</td><td>NICHOLS, DANELL</td><td>201</td><td>50,616</td><td></td><td>5,074</td><td>421.00</td></tr> <tr><td>2018</td><td>2018-0005569</td><td>NICHOLS, DANELL</td><td>201</td><td>50,616</td><td></td><td>5,074</td><td>421.00</td></tr> <tr><td>2017</td><td>2017-0005569</td><td>NICHOLS, DANELL</td><td>201</td><td>50,616</td><td></td><td>5,074</td><td>422.00</td></tr> <tr><td>2016</td><td>2016-0005569</td><td>NICHOLS, DANELL</td><td>201</td><td>50,616</td><td></td><td>5,074</td><td>432.00</td></tr> <tr><td>2015</td><td>2015-0005569</td><td>NICHOLS, DANELL</td><td>201</td><td>50,783</td><td></td><td>5,094</td><td>404.00</td></tr> <tr><td>2014</td><td>2014-0005569</td><td>NICHOLS, DANELL</td><td>201</td><td>50,783</td><td></td><td>5,094</td><td>408.00</td></tr> <tr><td>2013</td><td>2013-0005569</td><td>NICHOLS, DANELL</td><td>201</td><td>70,867</td><td></td><td>6,556</td><td>522.00</td></tr> </tbody> </table>										Tax Year	Statement Number	Billed Owner	Tax Area	Total Value	Exemptions	Taxable Value	Billed Tax	2025	2025-300005569	NICHOLS, DANELL	201	65,186	1000	5,836	460.00	2024	2024-300005569	NICHOLS, DANELL	201	71,879	1000	5,637	459.00	2023	2023-300005569	NICHOLS, DANELL	201	67,532	1000	5,444	450.00	2022	2022-300005569	NICHOLS, DANELL	201	56,542	1000	5,256	432.00	2021	2021-300005569	NICHOLS, DANELL	201	50,616	1000	5,074	419.00	2020	2020-300005569	NICHOLS, DANELL	201	50,616	1000	5,074	418.00	2019	2019-0005569	NICHOLS, DANELL	201	50,616		5,074	421.00	2018	2018-0005569	NICHOLS, DANELL	201	50,616		5,074	421.00	2017	2017-0005569	NICHOLS, DANELL	201	50,616		5,074	422.00	2016	2016-0005569	NICHOLS, DANELL	201	50,616		5,074	432.00	2015	2015-0005569	NICHOLS, DANELL	201	50,783		5,094	404.00	2014	2014-0005569	NICHOLS, DANELL	201	50,783		5,094	408.00	2013	2013-0005569	NICHOLS, DANELL	201	70,867		6,556	522.00
Tax Year	Statement Number	Billed Owner	Tax Area	Total Value	Exemptions	Taxable Value	Billed Tax																																																																																																																		
2025	2025-300005569	NICHOLS, DANELL	201	65,186	1000	5,836	460.00																																																																																																																		
2024	2024-300005569	NICHOLS, DANELL	201	71,879	1000	5,637	459.00																																																																																																																		
2023	2023-300005569	NICHOLS, DANELL	201	67,532	1000	5,444	450.00																																																																																																																		
2022	2022-300005569	NICHOLS, DANELL	201	56,542	1000	5,256	432.00																																																																																																																		
2021	2021-300005569	NICHOLS, DANELL	201	50,616	1000	5,074	419.00																																																																																																																		
2020	2020-300005569	NICHOLS, DANELL	201	50,616	1000	5,074	418.00																																																																																																																		
2019	2019-0005569	NICHOLS, DANELL	201	50,616		5,074	421.00																																																																																																																		
2018	2018-0005569	NICHOLS, DANELL	201	50,616		5,074	421.00																																																																																																																		
2017	2017-0005569	NICHOLS, DANELL	201	50,616		5,074	422.00																																																																																																																		
2016	2016-0005569	NICHOLS, DANELL	201	50,616		5,074	432.00																																																																																																																		
2015	2015-0005569	NICHOLS, DANELL	201	50,783		5,094	404.00																																																																																																																		
2014	2014-0005569	NICHOLS, DANELL	201	50,783		5,094	408.00																																																																																																																		
2013	2013-0005569	NICHOLS, DANELL	201	70,867		6,556	522.00																																																																																																																		



Harper

Assessment Property Record Card for Tax Year 2026

Data provided by SHAYLYN WEDER County Assessor

Date 02/06/2026
 Time 07:09:03
 Page 2

Lot Data	Square-Foot - BUFFALO ORIGMILLERS	Primary Image
Lot Size	100 x 117.5	<p>1070-00-233-017-0-001-00 02/24/25</p>
Lot Count		
Units Buildable	3525	
Non-Ag Acres		
Topography		
Street Access		
Utilities		
Amenities		
Method	Square-Foot	
Base Lot Value	11,750.00 x .30 = 3,525	
Factor Value		
Adjustments		
Lot Value	3,525	

Residential Data	
Type	1 Single Family Residence
Condition	2.5 - Fair
Quality	3 - Average
Architecture	TRAD TRADITIONAL
Style	100% One Story
Exterior Wall	100% Veneer, Masonry
Base/Total Area	1,526 / 1,526
Style	100% One Story
HVAC	100% Warmed & Cooled Air
Roof Cover	1 Composition Shingle
Area on Slab	0
Fixture/RghIn	8 /
Bed/F/H Bath	3 / 2.0 /
Basement Area	1,526 Total, 730 Partition
Garage Type	336 Detached Garage - Unfinished
Remodel	
Year/Eff Age	1958 / 75



GRM Approach	
GRM Code	
Gross Rent	
Indicated Value	

Multiple Regression	
MRA Code	
Adusted R	
Indicated Value	

Direct Comparables	
Selection Model	DEFAULT DEFAULT SELECTION MODEL
Adjustment Model	DEFAULT DEFAULT ADJUSTMENTS TABLE
Comparables	
Indicated Value	

Cost Approach		Manual :	
Base Cost	90.27	Total Misc Impr	+ 4,547
Roofing Adj	+ 3.94	Garage Cost	+ 13,335
Subfloor Adj	+ 0.00	Total RCN	= 232,209
Heat/Cool Adj	+ 10.77	Depreciation (74%)	- 171,835
Plumbing Adj	+ 6.42	Lump Sums	+ 0
Basement Adj	+ 29.05	RCNLD	= 60,374
Adj Base Cost	= 140.45	Lot Value	+ 3,525
Total Area	x 1,526	Indicated Value	= 63,899
Adjusted Cost	= 214,327	Value Per SqFt	41.87

Value Reconciliation			
Selected Approach	Cost Approach		
Improvements	60,374		
Lot Value	3,525		
Indicated Value	63,899	41.87	Per SqFt
Agland Value			
Site Improvements	1,295		
Total Value	65,194	42.72	Total Value Per SqFt

Miscellaneous Improvements								
Code	Description	Sketch ID	Size	Year	Units	Unit Cost	Depr	Value
PRCH	Porch	3827	7x4		28	22.87		640
WODO	Wood Deck - Open	3828	18x12		216	18.09		3,907



Harper

Assessment Property Record Card for Tax Year 2026

Data provided by SHAYLYN WEDER County Assessor

Date 02/06/2026
 Time 07:09:03
 Page 3

Sketch Image

300005569

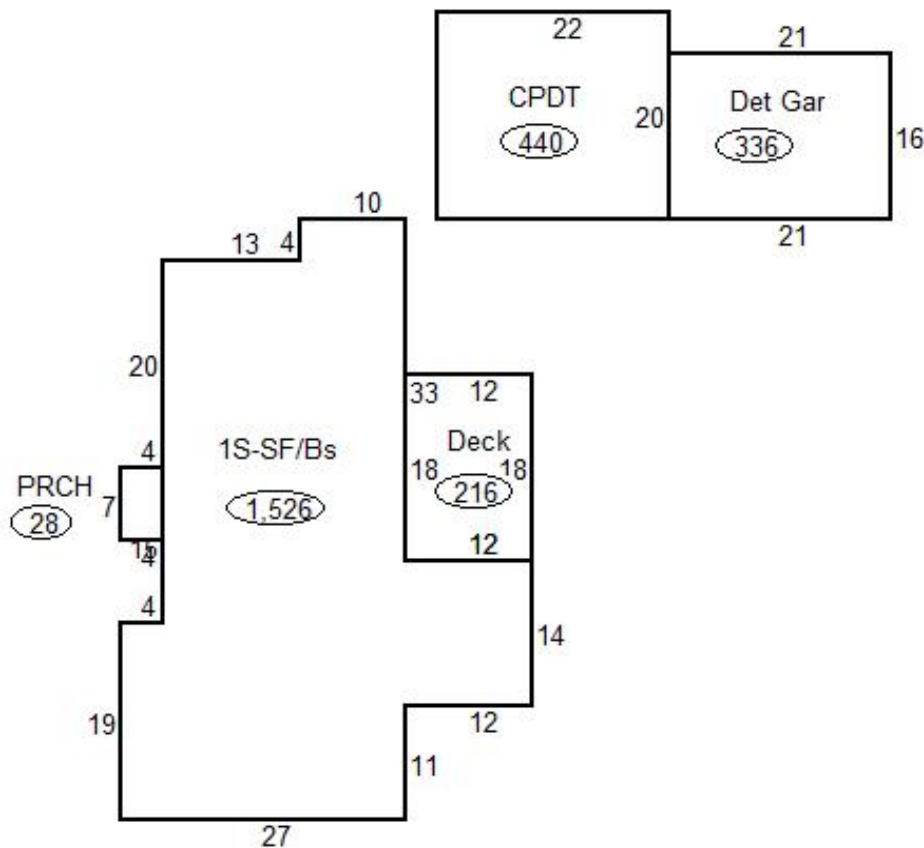

Sketch Vector Information

Sequence	Code	Type	Built Over	Scale	Section Label	Base Area	Multiplier	Total Area
1	M	PRCH		20	PRCH	28	1.000	28
2	M	WODO		20	Deck	216	1.000	216
3	R	1	Basement	20	1S-SF/Bs	1,526	1.000	1,526
4	G	2		20	Det Gar	336	1.000	336
5	O	CPDT		20	CPDT	440	1.000	440
Total Building Area						1,526		1,526



Harper

Assessment Property Record Card for Tax Year 2026

Data provided by SHAYLYN WEDER County Assessor

Date 02/06/2026
Time 07:09:03
Page 4

300005569

Outbuildings/Site Improvements

Building Image	Code	Description	Dimensions	Floor	Roofing	Total Units
	CPDT	Carport - Detached	22x20x0	Dirt	Formed Metal	440
	Qual 3	Cond 3	Year 2013	Eff Age 13		
Valuation Summary		Modifier Total	RCN	Depr (54% Phys/ 0% Func)		RCNLD
Base Cost (6.40 x 440)		2,816		2,816		1,295