



Harper

Assessment Property Record Card for Tax Year 2026

Data provided by SHAYLYN WEDER County Assessor

Date 02/06/2026
 Time 07:12:22
 Page 1

Assessment Data					Primary Image																																																																																																																				
Account 300005780 Parcel ID 2001-00-022-011-0-001-00 Cadastral ID 2001-022-011-00-0-001-00 Property Type REAL - Real Property Property Class UR VI Area 1 Tax Area 202 - 1T-LAVERNE-C Name ID 14949 THOMAS, ROGER LEE % JANET MOORE HARPER 710 BURRIS DRIVE YALE OK 74085-0000 Parcel Location Situs 00523 SW THIRD ST Subdivision LAVERNE ORIG. Lot/Block 0011 / 0022 Parcel Size 5 - Lots Sec/Twn/Rng / / / Neighborhood 200100 - LAVERNE ORIG\MULTI School District 1-LAVERN - 1-LAVERNE					<p>2001-00-022-011-0-001-00 02/28/23</p> <p>2001-00-022-011-0-001-00_001.JPG 3/1/2023</p>																																																																																																																				
Legal Description Lat/Long: 36.70542289 -99.89268039 LAVERNE ORIG. BLOCK 22 LOTS 11-12-13-14-15																																																																																																																									
Exemptions					Building Permits																																																																																																																				
<table border="1"> <thead> <tr> <th>Code</th> <th>Type</th> <th>Active</th> <th>Maximum</th> <th>Exemption</th> </tr> </thead> <tbody> <tr> <td></td> <td></td> <td></td> <td></td> <td></td> </tr> </tbody> </table>					Code	Type	Active	Maximum	Exemption						<table border="1"> <thead> <tr> <th>Number</th> <th>Description</th> <th>Opened</th> <th>Closed</th> <th>Amount</th> </tr> </thead> <tbody> <tr> <td></td> <td></td> <td></td> <td></td> <td></td> </tr> </tbody> </table>					Number	Description	Opened	Closed	Amount																																																																																																	
Code	Type	Active	Maximum	Exemption																																																																																																																					
Number	Description	Opened	Closed	Amount																																																																																																																					
<table border="1"> <thead> <tr> <th>Code</th> <th>Type</th> <th>Active</th> <th>Maximum</th> <th>Exemption</th> </tr> </thead> <tbody> <tr> <td></td> <td></td> <td></td> <td></td> <td></td> </tr> </tbody> </table>					Code	Type	Active	Maximum	Exemption						Sale History <table border="1"> <thead> <tr> <th>Bk/Pg</th> <th>Grantor</th> <th>Date</th> <th>Price</th> <th>Code</th> </tr> </thead> <tbody> <tr> <td>468/613 /</td> <td>TROY MEYER & PATSY THOMAS, ROGER LEE</td> <td>02/19/1992</td> <td>3,000</td> <td>U</td> </tr> </tbody> </table>					Bk/Pg	Grantor	Date	Price	Code	468/613 /	TROY MEYER & PATSY THOMAS, ROGER LEE	02/19/1992	3,000	U																																																																																												
Code	Type	Active	Maximum	Exemption																																																																																																																					
Bk/Pg	Grantor	Date	Price	Code																																																																																																																					
468/613 /	TROY MEYER & PATSY THOMAS, ROGER LEE	02/19/1992	3,000	U																																																																																																																					
Parcel Valuation <table border="1"> <thead> <tr> <th>Source</th> <th>REAL</th> <th>Fair Cash</th> <th>Capped</th> <th>Asmnt Level</th> <th>Assessed</th> <th>Levy Rate</th> <th>67.190</th> <th>Current Tax</th> </tr> </thead> <tbody> <tr> <td>Remove Cap</td> <td></td> <td>Land Value 7,879</td> <td>7,879</td> <td>12%</td> <td>945</td> <td>Assessed</td> <td>2,796</td> <td>187.86</td> </tr> <tr> <td>Year Frozen</td> <td></td> <td>Improvements 15,422</td> <td>15,422</td> <td></td> <td>1,851</td> <td>Penalty</td> <td>0</td> <td></td> </tr> <tr> <td>Uncapped Value</td> <td>0</td> <td>Mobile Home 0</td> <td>0</td> <td></td> <td>0</td> <td>Exemption</td> <td>0</td> <td>0.00</td> </tr> <tr> <td>TIF Project ID</td> <td>0</td> <td>Total Value 23,301</td> <td>23,301</td> <td></td> <td>2,796</td> <td>Total Taxable</td> <td>2,796</td> <td>188.00</td> </tr> </tbody> </table>										Source	REAL	Fair Cash	Capped	Asmnt Level	Assessed	Levy Rate	67.190	Current Tax	Remove Cap		Land Value 7,879	7,879	12%	945	Assessed	2,796	187.86	Year Frozen		Improvements 15,422	15,422		1,851	Penalty	0		Uncapped Value	0	Mobile Home 0	0		0	Exemption	0	0.00	TIF Project ID	0	Total Value 23,301	23,301		2,796	Total Taxable	2,796	188.00																																																																			
Source	REAL	Fair Cash	Capped	Asmnt Level	Assessed	Levy Rate	67.190	Current Tax																																																																																																																	
Remove Cap		Land Value 7,879	7,879	12%	945	Assessed	2,796	187.86																																																																																																																	
Year Frozen		Improvements 15,422	15,422		1,851	Penalty	0																																																																																																																		
Uncapped Value	0	Mobile Home 0	0		0	Exemption	0	0.00																																																																																																																	
TIF Project ID	0	Total Value 23,301	23,301		2,796	Total Taxable	2,796	188.00																																																																																																																	
Assessment History <table border="1"> <thead> <tr> <th>Tax Year</th> <th>Statement Number</th> <th>Billed Owner</th> <th>Tax Area</th> <th>Total Value</th> <th>Exemptions</th> <th>Taxable Value</th> <th>Billed Tax</th> </tr> </thead> <tbody> <tr><td>2025</td><td>2025-300005780</td><td>THOMAS, ROGER LEE</td><td>202</td><td>23,301</td><td>0</td><td>2,796</td><td>188.00</td></tr> <tr><td>2024</td><td>2024-300005780</td><td>THOMAS, ROGER LEE</td><td>202</td><td>24,530</td><td>0</td><td>2,687</td><td>179.00</td></tr> <tr><td>2023</td><td>2023-300005780</td><td>THOMAS, ROGER LEE</td><td>202</td><td>21,330</td><td>0</td><td>2,559</td><td>172.00</td></tr> <tr><td>2022</td><td>2022-300005780</td><td>THOMAS, ROGER LEE</td><td>202</td><td>21,330</td><td>0</td><td>2,559</td><td>173.00</td></tr> <tr><td>2021</td><td>2021-300005780</td><td>THOMAS, ROGER LEE</td><td>202</td><td>21,330</td><td>0</td><td>2,475</td><td>171.00</td></tr> <tr><td>2020</td><td>2020-300005780</td><td>THOMAS, ROGER LEE</td><td>202</td><td>21,330</td><td>0</td><td>2,357</td><td>160.00</td></tr> <tr><td>2019</td><td>2019-0005780</td><td>THOMAS, ROGER LEE</td><td>202</td><td>21,330</td><td></td><td>2,245</td><td>134.00</td></tr> <tr><td>2018</td><td>2018-0005780</td><td>THOMAS, ROGER LEE</td><td>202</td><td>23,375</td><td></td><td>2,138</td><td>128.00</td></tr> <tr><td>2017</td><td>2017-0005780</td><td>THOMAS, ROGER LEE</td><td>202</td><td>22,723</td><td></td><td>2,036</td><td>122.00</td></tr> <tr><td>2016</td><td>2016-0005780</td><td>THOMAS, ROGER LEE</td><td>202</td><td>22,723</td><td></td><td>1,939</td><td>116.00</td></tr> <tr><td>2015</td><td>2015-0005780</td><td>THOMAS, ROGER LEE</td><td>202</td><td>22,522</td><td></td><td>1,847</td><td>110.00</td></tr> <tr><td>2014</td><td>2014-0005780</td><td>THOMAS, ROGER LEE</td><td>202</td><td>23,600</td><td></td><td>1,759</td><td>105.00</td></tr> <tr><td>2013</td><td>2013-0005780</td><td>THOMAS, ROGER LEE</td><td>202</td><td>27,734</td><td></td><td>1,675</td><td>100.00</td></tr> </tbody> </table>										Tax Year	Statement Number	Billed Owner	Tax Area	Total Value	Exemptions	Taxable Value	Billed Tax	2025	2025-300005780	THOMAS, ROGER LEE	202	23,301	0	2,796	188.00	2024	2024-300005780	THOMAS, ROGER LEE	202	24,530	0	2,687	179.00	2023	2023-300005780	THOMAS, ROGER LEE	202	21,330	0	2,559	172.00	2022	2022-300005780	THOMAS, ROGER LEE	202	21,330	0	2,559	173.00	2021	2021-300005780	THOMAS, ROGER LEE	202	21,330	0	2,475	171.00	2020	2020-300005780	THOMAS, ROGER LEE	202	21,330	0	2,357	160.00	2019	2019-0005780	THOMAS, ROGER LEE	202	21,330		2,245	134.00	2018	2018-0005780	THOMAS, ROGER LEE	202	23,375		2,138	128.00	2017	2017-0005780	THOMAS, ROGER LEE	202	22,723		2,036	122.00	2016	2016-0005780	THOMAS, ROGER LEE	202	22,723		1,939	116.00	2015	2015-0005780	THOMAS, ROGER LEE	202	22,522		1,847	110.00	2014	2014-0005780	THOMAS, ROGER LEE	202	23,600		1,759	105.00	2013	2013-0005780	THOMAS, ROGER LEE	202	27,734		1,675	100.00
Tax Year	Statement Number	Billed Owner	Tax Area	Total Value	Exemptions	Taxable Value	Billed Tax																																																																																																																		
2025	2025-300005780	THOMAS, ROGER LEE	202	23,301	0	2,796	188.00																																																																																																																		
2024	2024-300005780	THOMAS, ROGER LEE	202	24,530	0	2,687	179.00																																																																																																																		
2023	2023-300005780	THOMAS, ROGER LEE	202	21,330	0	2,559	172.00																																																																																																																		
2022	2022-300005780	THOMAS, ROGER LEE	202	21,330	0	2,559	173.00																																																																																																																		
2021	2021-300005780	THOMAS, ROGER LEE	202	21,330	0	2,475	171.00																																																																																																																		
2020	2020-300005780	THOMAS, ROGER LEE	202	21,330	0	2,357	160.00																																																																																																																		
2019	2019-0005780	THOMAS, ROGER LEE	202	21,330		2,245	134.00																																																																																																																		
2018	2018-0005780	THOMAS, ROGER LEE	202	23,375		2,138	128.00																																																																																																																		
2017	2017-0005780	THOMAS, ROGER LEE	202	22,723		2,036	122.00																																																																																																																		
2016	2016-0005780	THOMAS, ROGER LEE	202	22,723		1,939	116.00																																																																																																																		
2015	2015-0005780	THOMAS, ROGER LEE	202	22,522		1,847	110.00																																																																																																																		
2014	2014-0005780	THOMAS, ROGER LEE	202	23,600		1,759	105.00																																																																																																																		
2013	2013-0005780	THOMAS, ROGER LEE	202	27,734		1,675	100.00																																																																																																																		



Harper

Assessment Property Record Card for Tax Year 2026

Data provided by SHAYLYN WEDER County Assessor

Date 02/06/2026
 Time 07:12:22
 Page 2

Lot Data	Square-Foot - LAVERNE ORIGMULTI	Primary Image
Lot Size	0 0	
Lot Count		
Units Buildable	7879	
Non-Ag Acres		
Topography		
Street Access		
Utilities		
Amenities		
Method	Square-Foot	
Base Lot Value	19,698.00 x .40 = 7,879	
Factor Value		
Adjustments		
Lot Value	7,879	

Residential Data	
Type	1 Single Family Residence
Condition	1.5 - Low
Quality	1.5 - Low
Architecture	TRAD TRADITIONAL
Style	100% One Story
Exterior Wall	100% Frame, Stucco
Base/Total Area	804 / 804
Style	100% One Story
HVAC	100% Floor Furnace
Roof Cover	1 Composition Shingle
Area on Slab	0
Fixture/RghIn	5 /
Bed/F/H Bath	2 / 1.0 /
Basement Area	
Garage Type	
Remodel	
Year/Eff Age	1940 / 112

GRM Approach
GRM Code
Gross Rent
Indicated Value

Multiple Regression
MRA Code
Adusted R
Indicated Value

Direct Comparables		
Selection Model	DEFAULT	DEFAULT SELECTION MODEL
Adjustment Model	DEFAULT	DEFAULT ADJUSTMENTS TABLE
Comparables		
Indicated Value		

Cost Approach		Manual :	
Base Cost	81.92	Total Misc Impr	+ 1,080
Roofing Adj	+ 3.70	Garage Cost	+ 0
Subfloor Adj	+ 2.23	Total RCN	= 77,782
Heat/Cool Adj	+ 1.35	Depreciation (80%)	- 62,226
Plumbing Adj	+ 6.21	Lump Sums	+ 0
Basement Adj	+ 0.00	RCNLD	= 15,556
Adj Base Cost	= 95.40	Lot Value	+ 7,879
Total Area	x 804	Indicated Value	= 23,435
Adjusted Cost	= 76,702	Value Per SqFt	29.15

Value Reconciliation		
Selected Approach	Cost Approach	
Improvements	15,556	
Lot Value	7,879	
Indicated Value	23,435	29.15 Per SqFt
Agland Value		
Site Improvements		
Total Value	23,435	29.15 Total Value Per SqFt

Miscellaneous Improvements								
Code	Description	Sketch ID	Size	Year	Units	Unit Cost	Depr	Value
RSPC	Raised Slab Porch - Covered	4448	5x4		20	30.85		617
RSPC	Raised Slab Porch - Covered	4449	5x3		15	30.86		463



Harper

Assessment Property Record Card for Tax Year 2026

Data provided by SHAYLYN WEDER County Assessor

Date 02/06/2026
Time 07:12:22
Page 3

Sketch Image

300005780

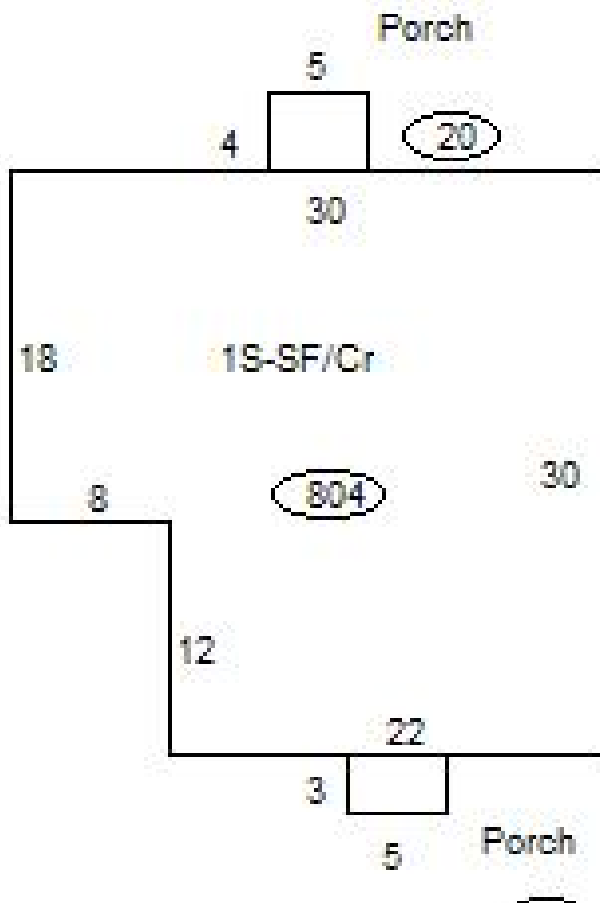

Sketch Vector Information

Sequence	Code	Type	Built Over	Scale	Section Label	Base Area	Multiplier	Total Area
1	R	1	Crawl	20	1S-SF/Cr	804	1.000	804
2	M	RSPC		20	Porch	20	1.000	20
3	M	RSPC		20	Porch	15	1.000	15
Total Building Area						804		804