



# Harper

## Assessment Property Record Card for Tax Year 2026

Data provided by SHAYLYN WEDER County Assessor

Date 02/06/2026  
 Time 07:14:10  
 Page 1

Assessment Data					Primary Image																			
Account	300005899																							
Parcel ID	2001-00-035-029-0-001-00																							
Cadastral ID	2001-035-029-00-0-001-00																							
Property Type	REAL - Real Property																							
Property Class	UR	VI Area 1																						
Tax Area	202 - 1T-LAVERNE-C																							
Name ID	15041																							
TAYLOR, STEPHEN L. & DEBBIE L. TAYLOR																								
504 SW 3RD ST LAVERNE OK 73848-0000																								
Parcel Location																								
Situs	00504 SW THIRD ST																							
Subdivision	LAVERNE ORIG.																							
Lot/Block	0029 / 0035	Parcel Size 2 - Lots																						
Sec/Twn/Rng	/ / /																							
Neighborhood	200100 - LAVERNE ORIG\MULTI																							
School District	1-LAVERN - 1-LAVERNE																							
Legal Description Lat/Long: 36.70693543 -99.89790885																								
LAVERNE ORIG BLOCK 35 LOTS 29-30																								
Building Permits																								
<table border="1"> <thead> <tr> <th>Number</th> <th>Description</th> <th>Opened</th> <th>Closed</th> <th>Amount</th> </tr> </thead> <tbody> <tr> <td> </td> <td> </td> <td> </td> <td> </td> <td> </td> </tr> </tbody> </table>					Number	Description	Opened	Closed	Amount															
Number	Description	Opened	Closed	Amount																				
Exemptions																								
<table border="1"> <thead> <tr> <th>Code</th> <th>Type</th> <th>Active</th> <th>Maximum</th> <th>Exemption</th> <th>Bk/Pg</th> <th>Grantor</th> <th>Date</th> <th>Price</th> <th>Code</th> </tr> </thead> <tbody> <tr> <td>H</td> <td>Homestead</td> <td>Yes</td> <td>1,000</td> <td>1,000</td> <td>513/107</td> <td>COATS, JERI, ETVIR</td> <td>03/20/1996</td> <td>32,000</td> <td>Q</td> </tr> </tbody> </table>					Code	Type	Active	Maximum	Exemption	Bk/Pg	Grantor	Date	Price	Code	H	Homestead	Yes	1,000	1,000	513/107	COATS, JERI, ETVIR	03/20/1996	32,000	Q
Code	Type	Active	Maximum	Exemption	Bk/Pg	Grantor	Date	Price	Code															
H	Homestead	Yes	1,000	1,000	513/107	COATS, JERI, ETVIR	03/20/1996	32,000	Q															
Sale History																								
<table border="1"> <thead> <tr> <th>Code</th> <th>Type</th> <th>Active</th> <th>Maximum</th> <th>Exemption</th> <th>Bk/Pg</th> <th>Grantor</th> <th>Date</th> <th>Price</th> <th>Code</th> </tr> </thead> <tbody> <tr> <td>H</td> <td>Homestead</td> <td>Yes</td> <td>1,000</td> <td>1,000</td> <td>513/107</td> <td>COATS, JERI, ETVIR</td> <td>03/20/1996</td> <td>32,000</td> <td>Q</td> </tr> </tbody> </table>					Code	Type	Active	Maximum	Exemption	Bk/Pg	Grantor	Date	Price	Code	H	Homestead	Yes	1,000	1,000	513/107	COATS, JERI, ETVIR	03/20/1996	32,000	Q
Code	Type	Active	Maximum	Exemption	Bk/Pg	Grantor	Date	Price	Code															
H	Homestead	Yes	1,000	1,000	513/107	COATS, JERI, ETVIR	03/20/1996	32,000	Q															
Parcel Valuation																								
Source	REAL	Fair Cash	Capped	Asmnt Level	Assessed	Levy Rate	67.190	Current Tax																
Remove Cap	2020	Land Value	2,800	2,800	12%	Assessed	4,479	300.94																
Year Frozen		Improvements	45,721	34,525		Penalty	0																	
Uncapped Value	0	Mobile Home	0	0		Exemption	1,000	-67.00																
TIF Project ID	0	Total Value	48,521	37,325		Total Taxable	3,479	234.00																
Assessment History																								
Tax Year	Statement Number	Billed Owner	Tax Area	Total Value	Exemptions	Taxable Value	Billed Tax																	
2025	2025-300005899	TAYLOR, STEPHEN L. &	202	48,521	1000	3,349	225.00																	
2024	2024-300005899	TAYLOR, STEPHEN L. &	202	51,860	1000	3,222	214.00																	
2023	2023-300005899	TAYLOR, STEPHEN L. &	202	34,159	1000	3,099	208.00																	
2022	2022-300005899	TAYLOR, STEPHEN L. &	202	34,159	1000	3,099	210.00																	
2021	2021-300005899	TAYLOR, STEPHEN L. &	202	34,159	1000	3,099	214.00																	
2020	2020-300005899	TAYLOR, STEPHEN L. &	202	34,159	1000	3,099	210.00																	
2019	2019-0005899	TAYLOR, STEPHEN L. &	202	33,954		3,074	183.00																	
2018	2018-0005899	TAYLOR, STEPHEN L. &	202	36,487		3,343	200.00																	
2017	2017-0005899	TAYLOR, STEPHEN L. &	202	35,143		3,217	192.00																	
2016	2016-0005899	TAYLOR, STEPHEN L. &	202	35,143		3,217	192.00																	
2015	2015-0005899	TAYLOR, STEPHEN L. &	202	34,734		3,168	189.00																	
2014	2014-0005899	TAYLOR, STEPHEN L. &	202	36,954		3,371	201.00																	
2013	2013-0005899	TAYLOR, STEPHEN L. &	202	42,596		3,244	194.00																	



# Harper

## Assessment Property Record Card for Tax Year 2026

Data provided by SHAYLYN WEDER County Assessor

Date 02/06/2026  
 Time 07:14:10  
 Page 2

Lot Data	Square-Foot - LAVERNE ORIGMULTI	Primary Image
Lot Size	50 x 140	<p>2001-00-035-029-0-001-00_003.JPG 2/28/2023</p>
Lot Count		
Units Buildable	2800	
Non-Ag Acres		
Topography		
Street Access		
Utilities		
Amenities		
Method	Square-Foot	
Base Lot Value	7,000.00 x .40 = 2,800	
Factor Value		
Adjustments		
Lot Value	2,800	

Residential Data	
Type	1 Single Family Residence
Condition	3 - Average
Quality	3 - Average
Architecture	TRAD TRADITIONAL
Style	100% 1 1/2 Story Finished
Exterior Wall	100% Frame, Siding, Vinyl
Base/Total Area	1,104 / 1,656
Style	100% 1 1/2 Story Finished
HVAC	100% Floor Furnace 1 Wall Air Conditioners (Cour
Roof Cover	1 Composition Shingle
Area on Slab	1,104
Fixture/RghIn	5 /
Bed/F/H Bath	2 / 1.0 /
Basement Area	
Garage Type	
Remodel	PARTIAL -
Year/Eff Age	1936 / 78

GRM Approach
GRM Code
Gross Rent Indicated Value

Multiple Regression
MRA Code
Adjusted R Indicated Value

Direct Comparables		
Selection Model	DEFAULT	DEFAULT SELECTION MODEL
Adjustment Model	DEFAULT	DEFAULT ADJUSTMENTS TABLE
Comparables Indicated Value		

Cost Approach		Manual :	
Base Cost	74.56	Total Misc Impr	+ 4,481
Roofing Adj	+ 2.88	Garage Cost	+ 0
Subfloor Adj	+ -1.38	Total RCN	= 139,677
Heat/Cool Adj	+ 1.73	Depreciation ( 76%)	- 106,155
Plumbing Adj	+ 3.85	Lump Sums	+ 0
Basement Adj	+ 0.00	RCNLD	= 33,522
Adj Base Cost	= 81.64	Lot Value	+ 2,800
Total Area	x 1,656	Indicated Value	= 36,322
Adjusted Cost	= 135,196	Value Per SqFt	21.93

Value Reconciliation		
Selected Approach	Cost Approach	
Improvements	33,522	
Lot Value	2,800	
Indicated Value	36,322	21.93 Per SqFt
Agland Value		
Site Improvements	10,938	
Total Value	47,260	28.54 Total Value Per SqFt

Miscellaneous Improvements								
Code	Description	Sketch ID	Size	Year	Units	Unit Cost	Depr	Value
RSPC	Raised Slab Porch - Covered	4823	14x8		112	40.01		4,481



Harper

Assessment Property Record Card for Tax Year 2026

Data provided by SHAYLYN WEDER County Assessor

Date 02/06/2026  
Time 07:14:10  
Page 3

Sketch Image

300005899

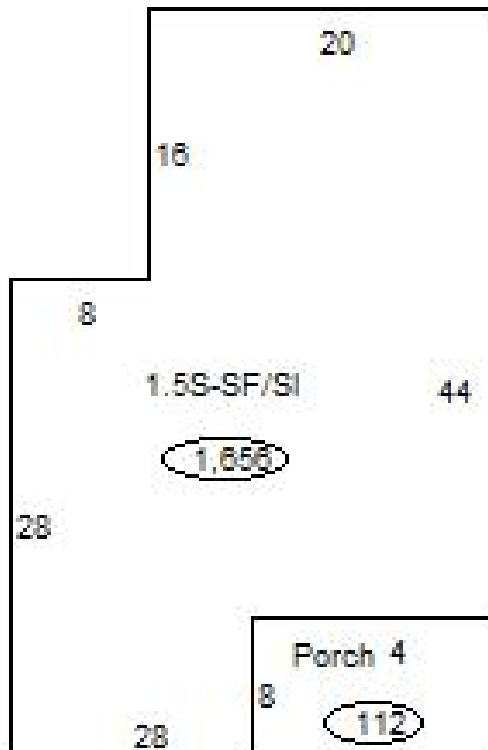

Sketch Vector Information

Sequence	Code	Type	Built Over	Scale	Section Label	Base Area	Multiplier	Total Area
1	R	5	Slab	20	1.5S-SF/SI	1,104	1.500	1,656
2	M	RSPC		20	Porch	112	1.000	112
<b>Total Building Area</b>						1,104		1,656



# Harper



## Assessment Property Record Card for Tax Year 2026

Data provided by SHAYLYN WEDER County Assessor

Date 02/06/2026  
 Time 07:14:10  
 Page 4

300005899

### Outbuildings/Site Improvements

Building Image	Code	Description	Dimensions	Floor	Roofing	Total Units	
	SHDS	Shed, Metal NEW FOR 2020	8x6x8		Galvanized Metal	48	
	Qual	3	Cond 3	Year 2020	Eff Age 6		
	<b>Valuation Summary</b>		<b>Modifier Total</b>		<b>RCN</b>	<b>Depr (28% Phys/ % Func)</b>	<b>RCNLD</b>
	Base Cost (30.06 x 48)		1,443		1,443	404	1,039
	PACN	Paving - Concrete / Sidewalk by shed	14x3x0			42	
	Qual	3	Cond 3	Year 1990	Eff Age 36		
	<b>Valuation Summary</b>		<b>Modifier Total</b>		<b>RCN</b>	<b>Depr (80% Phys/ % Func)</b>	<b>RCNLD</b>
	Base Cost (7.91 x 42)		332		332	266	66
	PACN	Paving - Concrete	16x16x0			256	
	Qual	3	Cond 3	Year 1990	Eff Age 36		
	<b>Valuation Summary</b>		<b>Modifier Total</b>		<b>RCN</b>	<b>Depr (80% Phys/ % Func)</b>	<b>RCNLD</b>
	Base Cost (4.82 x 256)		1,234		1,234	987	247
	UTIL	Utility Bldg	36x25x10		Formed Metal	900	
	Qual	3	Cond 3	Year 1990	Eff Age 36		
	<b>Valuation Summary</b>		<b>Modifier Total</b>		<b>RCN</b>	<b>Depr (62% Phys/ % Func)</b>	<b>RCNLD</b>
	Base Cost (27.14 x 900)		24,426		24,426	15,144	9,282
	PACN	Paving - Concrete /South Sidewalk	25x4x0			100	
	Qual	3	Cond 3	Year 1936	Eff Age 90		
	<b>Valuation Summary</b>		<b>Modifier Total</b>		<b>RCN</b>	<b>Depr (80% Phys/ % Func)</b>	<b>RCNLD</b>
	Base Cost (7.07 x 100)		707		707	566	141
	PACN	Paving - Concrete / East Sidewalk	30x4x0			120	
	Qual	3	Cond 3	Year 1936	Eff Age 90		
	<b>Valuation Summary</b>		<b>Modifier Total</b>		<b>RCN</b>	<b>Depr (80% Phys/ % Func)</b>	<b>RCNLD</b>
	Base Cost (6.78 x 120)		814		814	651	163