



# Harper

## Assessment Property Record Card for Tax Year 2026

Data provided by SHAYLYN WEDER County Assessor

Date 02/06/2026  
 Time 07:14:46  
 Page 1

Assessment Data					Primary Image																																																																																																																				
<b>Account</b> 300005940 <b>Parcel ID</b> 2001-00-040-013-0-001-00 <b>Cadastral ID</b> 2001-040-013-00-0-001-00 <b>Property Type</b> REAL - Real Property <b>Property Class</b> UR VI Area 2 <b>Tax Area</b> 202 - 1T-LAVERNE-C <b>Name ID</b> 15075 NEW START PROPERTIES, L.L.C.  PO BOX 22 LAVERNE OK 73848-0000  <b>Parcel Location</b> <b>Situs</b> 00124 SW SECOND ST <b>Subdivision</b> LAVERNE ORIG. <b>Lot/Block</b> 0013 / 0040 <b>Parcel Size</b> 2 - Lots <b>Sec/Twn/Rng</b> / / / <b>Neighborhood</b> 200100 - LAVERNE ORIG\MULTI <b>School District</b> 1-LAVERN - 1-LAVERNE					<p>2001-00-040-013-0-001-00 01/30/24</p>																																																																																																																				
<b>HOUSE</b> <span style="float: right;">2/1/2024</span>																																																																																																																									
<b>Legal Description</b> Lat/Long: 36.71240973 -99.89896692					<b>Building Permits</b>																																																																																																																				
LAVERNE ORIG. BLOCK 40 LOTS 13-14					<table border="1"> <thead> <tr> <th>Number</th> <th>Description</th> <th>Opened</th> <th>Closed</th> <th>Amount</th> </tr> </thead> <tbody> <tr> <td> </td> <td> </td> <td> </td> <td> </td> <td> </td> </tr> </tbody> </table>					Number	Description	Opened	Closed	Amount																																																																																																											
Number	Description	Opened	Closed	Amount																																																																																																																					
<b>Exemptions</b>					<b>Sale History</b>																																																																																																																				
<table border="1"> <thead> <tr> <th>Code</th> <th>Type</th> <th>Active</th> <th>Maximum</th> <th>Exemption</th> </tr> </thead> <tbody> <tr> <td> </td> <td> </td> <td> </td> <td> </td> <td> </td> </tr> </tbody> </table>					Code	Type	Active	Maximum	Exemption						<table border="1"> <thead> <tr> <th>Bk/Pg</th> <th>Grantor</th> <th>Date</th> <th>Price</th> <th>Code</th> </tr> </thead> <tbody> <tr> <td>523/53</td> <td>HART, ELAINE W.</td> <td>02/25/1997</td> <td>8,000</td> <td>Q</td> </tr> <tr> <td>/</td> <td>NEW START PROPERTIES, L.L.C.</td> <td> </td> <td> </td> <td> </td> </tr> </tbody> </table>					Bk/Pg	Grantor	Date	Price	Code	523/53	HART, ELAINE W.	02/25/1997	8,000	Q	/	NEW START PROPERTIES, L.L.C.																																																																																										
Code	Type	Active	Maximum	Exemption																																																																																																																					
Bk/Pg	Grantor	Date	Price	Code																																																																																																																					
523/53	HART, ELAINE W.	02/25/1997	8,000	Q																																																																																																																					
/	NEW START PROPERTIES, L.L.C.																																																																																																																								
<b>Parcel Valuation</b>																																																																																																																									
<table border="1"> <thead> <tr> <th>Source</th> <th>REAL</th> </tr> </thead> <tbody> <tr> <td>Remove Cap</td> <td> </td> </tr> <tr> <td>Year Frozen</td> <td> </td> </tr> <tr> <td>Uncapped Value</td> <td>0</td> </tr> <tr> <td>TIF Project ID</td> <td>0</td> </tr> </tbody> </table>		Source	REAL	Remove Cap		Year Frozen		Uncapped Value	0	TIF Project ID	0	<table border="1"> <thead> <tr> <th>Fair Cash</th> <th>Capped</th> <th>Asmnt Level</th> <th>Assessed</th> </tr> </thead> <tbody> <tr> <td>Land Value 2,800</td> <td>2,800</td> <td>12%</td> <td>336</td> </tr> <tr> <td>Improvements 27,503</td> <td>25,373</td> <td> </td> <td>3,045</td> </tr> <tr> <td>Mobile Home 0</td> <td>0</td> <td> </td> <td>0</td> </tr> <tr> <td>Total Value 30,303</td> <td>28,173</td> <td> </td> <td>3,381</td> </tr> </tbody> </table>			Fair Cash	Capped	Asmnt Level	Assessed	Land Value 2,800	2,800	12%	336	Improvements 27,503	25,373		3,045	Mobile Home 0	0		0	Total Value 30,303	28,173		3,381	<table border="1"> <thead> <tr> <th>Levy Rate</th> <th>Current Tax</th> </tr> </thead> <tbody> <tr> <td>67.190</td> <td> </td> </tr> <tr> <td>Assessed 3,381</td> <td>227.17</td> </tr> <tr> <td>Penalty 0</td> <td> </td> </tr> <tr> <td>Exemption 0</td> <td>0.00</td> </tr> <tr> <td>Total Taxable 3,381</td> <td>227.00</td> </tr> </tbody> </table>		Levy Rate	Current Tax	67.190		Assessed 3,381	227.17	Penalty 0		Exemption 0	0.00	Total Taxable 3,381	227.00																																																																									
Source	REAL																																																																																																																								
Remove Cap																																																																																																																									
Year Frozen																																																																																																																									
Uncapped Value	0																																																																																																																								
TIF Project ID	0																																																																																																																								
Fair Cash	Capped	Asmnt Level	Assessed																																																																																																																						
Land Value 2,800	2,800	12%	336																																																																																																																						
Improvements 27,503	25,373		3,045																																																																																																																						
Mobile Home 0	0		0																																																																																																																						
Total Value 30,303	28,173		3,381																																																																																																																						
Levy Rate	Current Tax																																																																																																																								
67.190																																																																																																																									
Assessed 3,381	227.17																																																																																																																								
Penalty 0																																																																																																																									
Exemption 0	0.00																																																																																																																								
Total Taxable 3,381	227.00																																																																																																																								
<b>Assessment History</b>																																																																																																																									
<table border="1"> <thead> <tr> <th>Tax Year</th> <th>Statement Number</th> <th>Billed Owner</th> <th>Tax Area</th> <th>Total Value</th> <th>Exemptions</th> <th>Taxable Value</th> <th>Billed Tax</th> </tr> </thead> <tbody> <tr><td>2025</td><td>2025-300005940</td><td>NEW START PROPERTIES, L.L.C.</td><td>202</td><td>30,303</td><td>0</td><td>3,220</td><td>216.00</td></tr> <tr><td>2024</td><td>2024-300005940</td><td>NEW START PROPERTIES, L.L.C.</td><td>202</td><td>37,844</td><td>0</td><td>3,067</td><td>204.00</td></tr> <tr><td>2023</td><td>2023-300005940</td><td>NEW START PROPERTIES, L.L.C.</td><td>202</td><td>32,360</td><td>0</td><td>2,921</td><td>196.00</td></tr> <tr><td>2022</td><td>2022-300005940</td><td>NEW START PROPERTIES, L.L.C.</td><td>202</td><td>23,180</td><td>0</td><td>2,782</td><td>188.00</td></tr> <tr><td>2021</td><td>2021-300005940</td><td>NEW START PROPERTIES, L.L.C.</td><td>202</td><td>23,251</td><td>0</td><td>2,790</td><td>193.00</td></tr> <tr><td>2020</td><td>2020-300005940</td><td>NEW START PROPERTIES, L.L.C.</td><td>202</td><td>22,429</td><td>0</td><td>2,691</td><td>182.00</td></tr> <tr><td>2019</td><td>2019-0005940</td><td>NEW START PROPERTIES, L.L.C.</td><td>202</td><td>22,429</td><td> </td><td>2,691</td><td>161.00</td></tr> <tr><td>2018</td><td>2018-0005940</td><td>NEW START PROPERTIES, L.L.C.</td><td>202</td><td>24,326</td><td> </td><td>2,705</td><td>161.00</td></tr> <tr><td>2017</td><td>2017-0005940</td><td>NEW START PROPERTIES, L.L.C.</td><td>202</td><td>23,374</td><td> </td><td>2,576</td><td>154.00</td></tr> <tr><td>2016</td><td>2016-0005940</td><td>NEW START PROPERTIES, L.L.C.</td><td>202</td><td>23,374</td><td> </td><td>2,454</td><td>146.00</td></tr> <tr><td>2015</td><td>2015-0005940</td><td>NEW START PROPERTIES, L.L.C.</td><td>202</td><td>23,078</td><td> </td><td>2,337</td><td>139.00</td></tr> <tr><td>2014</td><td>2014-0005940</td><td>NEW START PROPERTIES, L.L.C.</td><td>202</td><td>24,652</td><td> </td><td>2,226</td><td>133.00</td></tr> <tr><td>2013</td><td>2013-0005940</td><td>NEW START PROPERTIES, L.L.C.</td><td>202</td><td>68,284</td><td> </td><td>2,120</td><td>127.00</td></tr> </tbody> </table>										Tax Year	Statement Number	Billed Owner	Tax Area	Total Value	Exemptions	Taxable Value	Billed Tax	2025	2025-300005940	NEW START PROPERTIES, L.L.C.	202	30,303	0	3,220	216.00	2024	2024-300005940	NEW START PROPERTIES, L.L.C.	202	37,844	0	3,067	204.00	2023	2023-300005940	NEW START PROPERTIES, L.L.C.	202	32,360	0	2,921	196.00	2022	2022-300005940	NEW START PROPERTIES, L.L.C.	202	23,180	0	2,782	188.00	2021	2021-300005940	NEW START PROPERTIES, L.L.C.	202	23,251	0	2,790	193.00	2020	2020-300005940	NEW START PROPERTIES, L.L.C.	202	22,429	0	2,691	182.00	2019	2019-0005940	NEW START PROPERTIES, L.L.C.	202	22,429		2,691	161.00	2018	2018-0005940	NEW START PROPERTIES, L.L.C.	202	24,326		2,705	161.00	2017	2017-0005940	NEW START PROPERTIES, L.L.C.	202	23,374		2,576	154.00	2016	2016-0005940	NEW START PROPERTIES, L.L.C.	202	23,374		2,454	146.00	2015	2015-0005940	NEW START PROPERTIES, L.L.C.	202	23,078		2,337	139.00	2014	2014-0005940	NEW START PROPERTIES, L.L.C.	202	24,652		2,226	133.00	2013	2013-0005940	NEW START PROPERTIES, L.L.C.	202	68,284		2,120	127.00
Tax Year	Statement Number	Billed Owner	Tax Area	Total Value	Exemptions	Taxable Value	Billed Tax																																																																																																																		
2025	2025-300005940	NEW START PROPERTIES, L.L.C.	202	30,303	0	3,220	216.00																																																																																																																		
2024	2024-300005940	NEW START PROPERTIES, L.L.C.	202	37,844	0	3,067	204.00																																																																																																																		
2023	2023-300005940	NEW START PROPERTIES, L.L.C.	202	32,360	0	2,921	196.00																																																																																																																		
2022	2022-300005940	NEW START PROPERTIES, L.L.C.	202	23,180	0	2,782	188.00																																																																																																																		
2021	2021-300005940	NEW START PROPERTIES, L.L.C.	202	23,251	0	2,790	193.00																																																																																																																		
2020	2020-300005940	NEW START PROPERTIES, L.L.C.	202	22,429	0	2,691	182.00																																																																																																																		
2019	2019-0005940	NEW START PROPERTIES, L.L.C.	202	22,429		2,691	161.00																																																																																																																		
2018	2018-0005940	NEW START PROPERTIES, L.L.C.	202	24,326		2,705	161.00																																																																																																																		
2017	2017-0005940	NEW START PROPERTIES, L.L.C.	202	23,374		2,576	154.00																																																																																																																		
2016	2016-0005940	NEW START PROPERTIES, L.L.C.	202	23,374		2,454	146.00																																																																																																																		
2015	2015-0005940	NEW START PROPERTIES, L.L.C.	202	23,078		2,337	139.00																																																																																																																		
2014	2014-0005940	NEW START PROPERTIES, L.L.C.	202	24,652		2,226	133.00																																																																																																																		
2013	2013-0005940	NEW START PROPERTIES, L.L.C.	202	68,284		2,120	127.00																																																																																																																		



# Harper

## Assessment Property Record Card for Tax Year 2026

Data provided by SHAYLYN WEDER County Assessor

Date 02/06/2026  
 Time 07:14:46  
 Page 2

Lot Data	Square-Foot - LAVERNE ORIGMULTI	Primary Image
Lot Size	50 x 140	
Lot Count		
Units Buildable	2800	
Non-Ag Acres		
Topography		
Street Access		
Utilities		
Amenities		
Method	Square-Foot	
Base Lot Value	7,000.00 x .40 = 2,800	
Factor Value		
Adjustments		
Lot Value	2,800	

Residential Data	
Type	1 Single Family Residence
Condition	3.2 - Average
Quality	3 - Average
Architecture	TRAD TRADITIONAL
Style	100% One Story
Exterior Wall	100% Frame, Siding, Vinyl
Base/Total Area	1,182 / 1,182
Style	100% One Story
HVAC	100% Floor Furnace 1 Wall Air Conditioners (Cour
Roof Cover	1 Composition Shingle
Area on Slab	0
Fixture/RghIn	5 /
Bed/F/H Bath	2 / 1.0 /
Basement Area	
Garage Type	230 Attached Garage - Unfinished
Remodel	
Year/Eff Age	1940 / 83

GRM Approach		
GRM Code		
Gross Rent Indicated Value		
Multiple Regression		
MRA Code		
Adusted R Indicated Value		
Direct Comparables		
Selection Model	DEFAULT	DEFAULT SELECTION MODEL
Adjustment Model	DEFAULT	DEFAULT ADJUSTMENTS TABLE
Comparables Indicated Value		
Value Reconciliation		
Selected Approach	Cost Approach	
Improvements	27,766	
Lot Value	2,800	
Indicated Value	30,566	25.86 Per SqFt
Agland Value		
Site Improvements		
Total Value	30,566	25.86 Total Value Per SqFt

Cost Approach		Manual :	
Base Cost	88.32	Total Misc Impr	+ 458
Roofing Adj	+ 4.21	Garage Cost	+ 7,963
Subfloor Adj	+ 0.00	Total RCN	= 126,207
Heat/Cool Adj	+ 1.73	Depreciation ( 78%)	- 98,441
Plumbing Adj	+ 5.40	Lump Sums	+ 0
Basement Adj	+ 0.00	RCNLD	= 27,766
Adj Base Cost	= 99.65	Lot Value	+ 2,800
Total Area	x 1,182	Indicated Value	= 30,566
Adjusted Cost	= 117,786	Value Per SqFt	25.86

Miscellaneous Improvements								
Code	Description	Sketch ID	Size	Year	Units	Unit Cost	Depr	Value
PRCH	Slab Porch - Covered	4990	5x4		20	22.88		458



Harper

Assessment Property Record Card for Tax Year 2026

Data provided by SHAYLYN WEDER County Assessor

Date 02/06/2026  
 Time 07:14:46  
 Page 3

Sketch Image

300005940

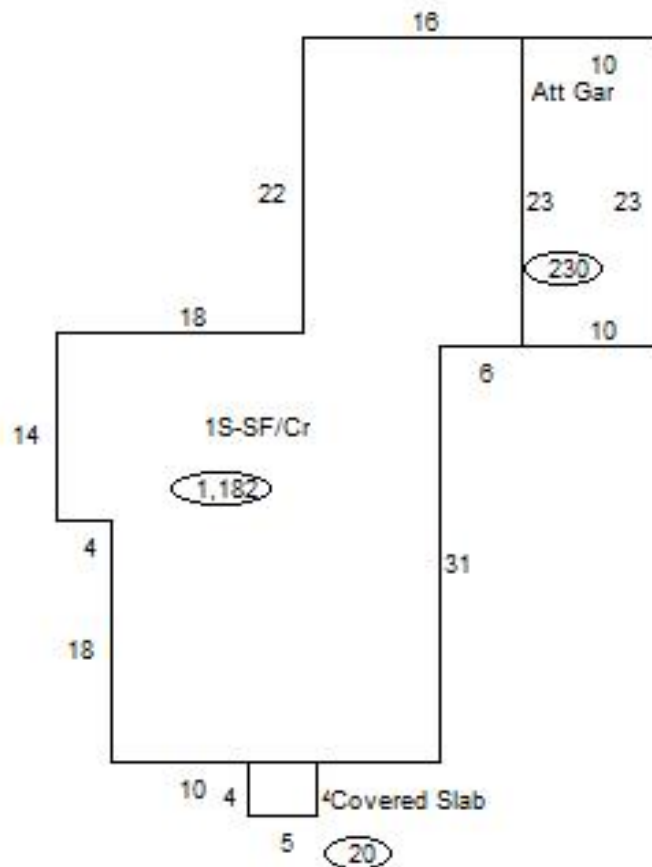

Sketch Vector Information

Sequence	Code	Type	Built Over	Scale	Section Label	Base Area	Multiplier	Total Area
1	R	1	Crawl	20	1S-SF/Cr	1,182	1.000	1,182
2	M	PRCH		20	Covered Slab	20	1.000	20
3	G	1		20	Att Gar	230	1.000	230
<b>Total Building Area</b>						1,182		1,182