



Harper

Assessment Property Record Card for Tax Year 2026

Data provided by SHAYLYN WEDER County Assessor

Date 02/06/2026
 Time 07:15:02
 Page 1

| Assessment Data | | | | | Primary Image | | | | | | | | | |
|---|-----------------------------|--------------|----------|-------------|-----------------------|----------------|------------|-------------|--------|--|--|--|--|--|
| Account | 300005959 | | | | <p>HOUSE 2/1/2024</p> | | | | | | | | | |
| Parcel ID | 2001-00-042-007-0-002-00 | | | | | | | | | | | | | |
| Cadastral ID | 2001-042-007-00-0-002-00 | | | | | | | | | | | | | |
| Property Type | REAL - Real Property | | | | | | | | | | | | | |
| Property Class | UR | VI Area | 2 | | | | | | | | | | | |
| Tax Area | 202 - 1T-LAVERNE-C | | | | | | | | | | | | | |
| Name ID | 15090 | | | | | | | | | | | | | |
| JONES, MARK | | | | | | | | | | | | | | |
| PO BOX 85 LAVERNE OK 73848-0000 | | | | | | | | | | | | | | |
| Parcel Location | | | | | | | | | | | | | | |
| Situs | 00201 S OHIO | | | | | | | | | | | | | |
| Subdivision | LAVERNE ORIG. | | | | | | | | | | | | | |
| Lot/Block | 0007 / 0042 | Parcel Size | 3 - Lots | | | | | | | | | | | |
| Sec/Twn/Rng | / / / | | | | | | | | | | | | | |
| Neighborhood | 200100 - LAVERNE ORIG\MULTI | | | | | | | | | | | | | |
| School District | 1-LAVERN - 1-LAVERNE | | | | | | | | | | | | | |
| Legal Description Lat/Long: 36.71354358 -99.88215700 | | | | | | | | | | | | | | |
| LAVERNE ORIG BLOCK 42 LOTS N 90' OF 7 THRU 12 | | | | | | | | | | | | | | |
| Building Permits | | | | | | | | | | | | | | |
| <table border="1"> <thead> <tr> <th>Number</th> <th>Description</th> <th>Opened</th> <th>Closed</th> <th>Amount</th> </tr> </thead> <tbody> <tr> <td> </td> <td> </td> <td> </td> <td> </td> <td> </td> </tr> </tbody> </table> | | | | | Number | Description | Opened | Closed | Amount | | | | | |
| Number | Description | Opened | Closed | Amount | | | | | | | | | | |
| | | | | | | | | | | | | | | |
| Exemptions | | | | | | | | | | | | | | |
| Code | Type | Active | Maximum | Exemption | Bk/Pg | Grantor | Date | Price | Code | | | | | |
| H | Homestead | Yes | 1,000 | 1,000 | 569/46 | JOHNSTON, DANA | 10/31/2001 | 37,000 | Q | | | | | |
| Parcel Valuation | | | | | | | | | | | | | | |
| Source | REAL | Fair Cash | Capped | Asmnt Level | Assessed | Levy Rate | 67.190 | Current Tax | | | | | | |
| Remove Cap | | Land Value | 5,400 | 5,400 | 12% | Assessed | 4,803 | 322.71 | | | | | | |
| Year Frozen | | Improvements | 35,118 | 34,626 | | Penalty | 0 | | | | | | | |
| Uncapped Value | 0 | Mobile Home | 0 | 0 | 0 | Exemption | 1,000 | -67.00 | | | | | | |
| TIF Project ID | 0 | Total Value | 40,518 | 40,026 | 4,803 | Total Taxable | 3,803 | 256.00 | | | | | | |
| Assessment History | | | | | | | | | | | | | | |
| Tax Year | Statement Number | Billed Owner | Tax Area | Total Value | Exemptions | Taxable Value | Billed Tax | | | | | | | |
| 2025 | 2025-300005959 | JONES, MARK | 202 | 40,518 | 1000 | 3,663 | 246.00 | | | | | | | |
| 2024 | 2024-300005959 | JONES, MARK | 202 | 42,981 | 1000 | 3,527 | 235.00 | | | | | | | |
| 2023 | 2023-300005959 | JONES, MARK | 202 | 40,665 | 1000 | 3,396 | 228.00 | | | | | | | |
| 2022 | 2022-300005959 | JONES, MARK | 202 | 35,566 | 1000 | 3,268 | 221.00 | | | | | | | |
| 2021 | 2021-300005959 | JONES, MARK | 202 | 36,093 | 1000 | 3,331 | 230.00 | | | | | | | |
| 2020 | 2020-300005959 | JONES, MARK | 202 | 36,559 | 1000 | 3,387 | 229.00 | | | | | | | |
| 2019 | 2019-0005959 | JONES, MARK | 202 | 36,559 | | 3,387 | 202.00 | | | | | | | |
| 2018 | 2018-0005959 | JONES, MARK | 202 | 39,311 | | 3,700 | 221.00 | | | | | | | |
| 2017 | 2017-0005959 | JONES, MARK | 202 | 38,033 | | 3,564 | 213.00 | | | | | | | |
| 2016 | 2016-0005959 | JONES, MARK | 202 | 38,259 | | 3,591 | 214.00 | | | | | | | |
| 2015 | 2015-0005959 | JONES, MARK | 202 | 37,861 | | 3,543 | 211.00 | | | | | | | |
| 2014 | 2014-0005959 | JONES, MARK | 202 | 39,975 | | 3,797 | 227.00 | | | | | | | |
| 2013 | 2013-0005959 | JONES, MARK | 202 | 47,453 | | 4,041 | 241.00 | | | | | | | |



Harper

Assessment Property Record Card for Tax Year 2026

Data provided by SHAYLYN WEDER County Assessor

Date 02/06/2026
 Time 07:15:02
 Page 2

| Lot Data | Square-Foot - LAVERNE ORIGMULTI | Primary Image |
|-----------------|---------------------------------|---------------|
| Lot Size | 150 x 90 | |
| Lot Count | | |
| Units Buildable | 5400 | |
| Non-Ag Acres | | |
| Topography | | |
| Street Access | | |
| Utilities | | |
| Amenities | | |
| Method | Square-Foot | |
| Base Lot Value | 13,500.00 x .40 = 5,400 | |
| Factor Value | | |
| Adjustments | | |
| Lot Value | 5,400 | |

| Residential Data | |
|------------------|-----------------------------------|
| Type | 1 Single Family Residence |
| Condition | 3 - Average |
| Quality | 3 - Average |
| Architecture | TRAD TRADITIONAL |
| Style | 100% One Story |
| Exterior Wall | 100% Frame, Plywood or Hardboard |
| Base/Total Area | 964 / 964 |
| Style | 100% One Story |
| HVAC | 100% Warmed & Cooled Air |
| Roof Cover | 1 Composition Shingle |
| Area on Slab | 0 |
| Fixture/RghIn | 5 / |
| Bed/F/H Bath | 2 / 1.0 / |
| Basement Area | |
| Garage Type | 252 Carport - Gable Roof 1 Stalls |
| Remodel | |
| Year/Eff Age | 1940 / 86 |

| | |
|-------|----------|
| HOUSE | 2/1/2024 |
|-------|----------|

| GRM Approach | |
|----------------------------|--|
| GRM Code | |
| Gross Rent Indicated Value | |

| Multiple Regression | |
|----------------------------|--|
| MRA Code | |
| Adjusted R Indicated Value | |

| Direct Comparables | |
|-----------------------------|-----------------------------------|
| Selection Model | DEFAULT DEFAULT SELECTION MODEL |
| Adjustment Model | DEFAULT DEFAULT ADJUSTMENTS TABLE |
| Comparables Indicated Value | |

| Cost Approach | | Manual : | |
|---------------|-----------|---------------------|-----------|
| Base Cost | 92.23 | Total Misc Impr | + 8,014 |
| Roofing Adj | + 4.46 | Garage Cost | + 2,112 |
| Subfloor Adj | + 0.00 | Total RCN | = 120,099 |
| Heat/Cool Adj | + 10.77 | Depreciation (80%) | - 96,079 |
| Plumbing Adj | + 6.61 | Lump Sums | + 0 |
| Basement Adj | + 0.00 | RCNLD | = 24,020 |
| Adj Base Cost | = 114.08 | Lot Value | + 5,400 |
| Total Area | x 964 | Indicated Value | = 29,420 |
| Adjusted Cost | = 109,973 | Value Per SqFt | 30.52 |

| Value Reconciliation | | | |
|----------------------|---------------|-------|----------------------|
| Selected Approach | Cost Approach | | |
| Improvements | 24,020 | | |
| Lot Value | 5,400 | | |
| Indicated Value | 29,420 | 30.52 | Per SqFt |
| Agland Value | | | |
| Site Improvements | 11,322 | | |
| Total Value | 40,742 | 42.26 | Total Value Per SqFt |

| Miscellaneous Improvements | | | | | | | | |
|----------------------------|-----------------------------|-----------|------|------|-------|-----------|------|-------|
| Code | Description | Sketch ID | Size | Year | Units | Unit Cost | Depr | Value |
| EPSW | Enclosed Porch - Solid Wall | 5035 | 15x9 | | 135 | 59.36 | | 8,014 |



Harper

Assessment Property Record Card for Tax Year 2026

Data provided by SHAYLYN WEDER County Assessor

Date 02/06/2026
Time 07:15:02
Page 3

Sketch Image

300005959

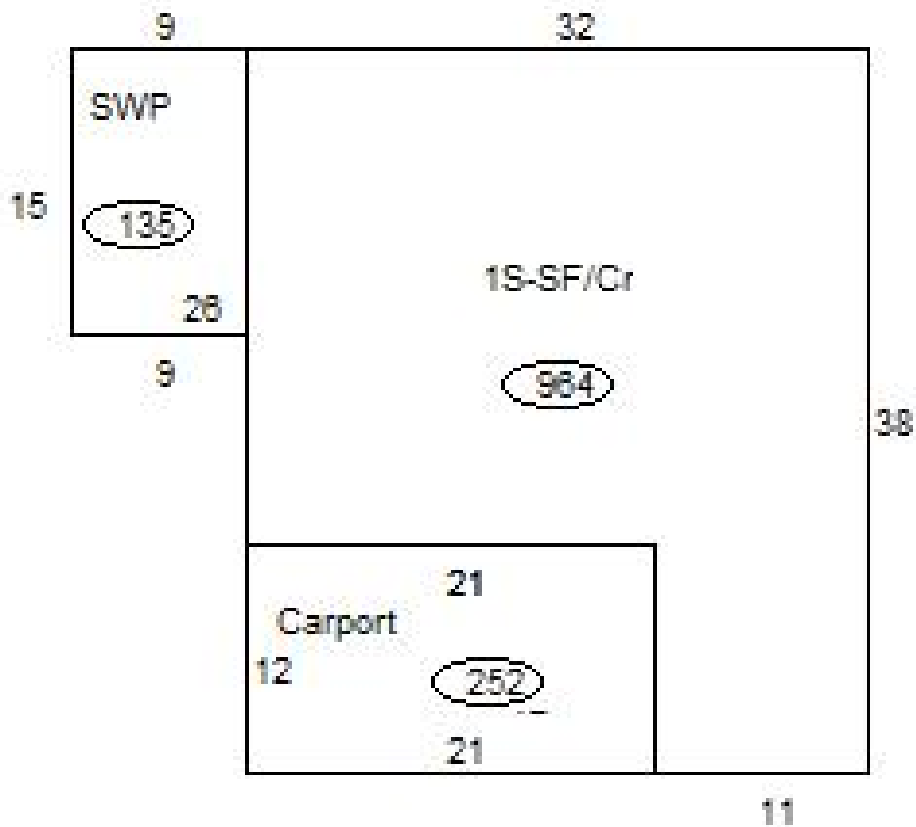

Sketch Vector Information

| Sequence | Code | Type | Built Over | Scale | Section Label | Base Area | Multiplier | Total Area |
|----------------------------|------|------|------------|-------|---------------|-----------|------------|------------|
| 1 | M | EPSW | | 20 | SWP | 135 | 1.000 | 135 |
| 2 | R | 1 | Crawl | 20 | 1S-SF/Cr | 964 | 1.000 | 964 |
| 3 | G | 3 | | 20 | Carport | 252 | 1.000 | 252 |
| Total Building Area | | | | | | 964 | | 964 |



Harper



Assessment Property Record Card for Tax Year 2026

Data provided by SHAYLYN WEDER County Assessor

Date 02/06/2026
Time 07:15:02
Page 4

300005959

Outbuildings/Site Improvements

| Building Image | Code | Description | Dimensions | Floor | Roofing | Total Units |
|--|---------------------------|--------------------------|-----------------------|------------|--------------------------------|--------------|
|  | UTIL | Utility Building | 40x30x8 | Dirt | Formed Metal | 1,200 |
| | Qual | 3 | Cond 3 | Year 1990 | Eff Age 33 | |
| | Valuation Summary | | Modifier Total | RCN | Depr (59% Phys/ % Func) | RCNLD |
| | Base Cost (22.20 x 1,200) | | 26,640 | 26,640 | 15,718 | 10,922 |
|  | PACN | Concrete Paving driveway | 40x12x0 | | | 480 |
| | Qual | 3 | Cond 3 | Year 1970 | Eff Age 56 | |
| | Valuation Summary | | Modifier Total | RCN | Depr (80% Phys/ % Func) | RCNLD |
| | Base Cost (4.17 x 480) | | 2,002 | 2,002 | 1,602 | 400 |