



Harper

Assessment Property Record Card for Tax Year 2026

Data provided by SHAYLYN WEDER County Assessor

Date 02/06/2026
 Time 07:15:48
 Page 1

Assessment Data					Primary Image														
Account 300006010 Parcel ID 2001-00-047-004-0-001-00 Cadastral ID 2001-047-004-00-0-001-00 Property Type REAL - Real Property Property Class UR VI Area 1 Tax Area 202 - 1T-LAVERNE-C Name ID 25359 DOMINGUEZ, ISMAEL AND NEOMI DOMINGUEZ (JT) P O BOX 357 LAVERNE OK 73848- Parcel Location Situs 00305 W JANE JAYROE Subdivision LAVERNE ORIG. Lot/Block 0004 / 0047 Parcel Size 3 - Lots Sec/Twn/Rng / / / Neighborhood 200100 - LAVERNE ORIG\MULTI School District 1-LAVERN - 1-LAVERNE					<p>2001-00-047-004-0-001-00 02/28/23</p>														
HOUSE 3/1/2023																			
Legal Description Lat/Long: 36.70998927 -99.90083977					Building Permits														
LAVERNE ORIG BLOCK 47 LOTS 4-5-6 BOOK 776 PAGE 617					<table border="1"> <thead> <tr> <th>Number</th> <th>Description</th> <th>Opened</th> <th>Closed</th> <th>Amount</th> </tr> </thead> <tbody> <tr> <td> </td> <td> </td> <td> </td> <td> </td> <td> </td> </tr> </tbody> </table>					Number	Description	Opened	Closed	Amount					
Number	Description	Opened	Closed	Amount															
Exemptions					Sale History														
Code	Type	Active	Maximum	Exemption	Bk/Pg	Grantor	Date	Price	Code										
					776/617	MANNING, DANNY R.	07/18/2023	15,000	14										
					/	MANNING, DANNY R.													
Parcel Valuation																			
Source	REAL		Fair Cash	Capped	Asmnt Level	Assessed	Levy Rate	67.190	Current Tax										
Remove Cap	2024		Land Value	4,200	4,200	12%	Assessed	4,425	297.32										
Year Frozen			Improvements	32,680	32,680		Penalty	0											
Uncapped Value	0		Mobile Home	0	0		Exemption	0	0.00										
TIF Project ID	0		Total Value	36,880	36,880		Total Taxable	4,425	297.00										
Assessment History																			
Tax Year	Statement Number	Billed Owner			Tax Area	Total Value	Exemptions	Taxable Value	Billed Tax										
2025	2025-300006010	DOMINGUEZ, ISMAEL AND NEOMI DOMINGUEZ			202	36,880	0	4,425	297.00										
2024	2024-300006010	DOMINGUEZ, ISMAEL AND NEOMI DOMINGUEZ			202	39,503	0	4,741	315.00										
2023	2023-300006010	DOMINGUEZ, ISMAEL AND NEOMI DOMINGUEZ			202	35,915	0	4,310	289.00										
2022	2022-300006010	MANNING, DANNY R.			202	35,915	0	4,310	292.00										
2021	2021-300006010	MANNING, DANNY R.			202	35,915	0	4,295	297.00										
2020	2020-300006010	MANNING, DANNY R.			202	35,915	0	4,090	277.00										
2019	2019-0006010	MANNING, DANNY R.			202	35,915		3,896	233.00										
2018	2018-0006010	MANNING, DANNY R.			202	38,939		3,710	221.00										
2017	2017-0006010	MANNING, DANNY R.			202	37,401		3,533	211.00										
2016	2016-0006010	MANNING, DANNY R.			202	37,401		3,365	201.00										
2015	2015-0006010	MANNING, DANNY R.			202	36,924		3,205	191.00										
2014	2014-0006010	MANNING, DANNY R.			202	39,466		3,053	182.00										
2013	2013-0006010	MANNING, DANNY R.			202	61,926		2,907	173.00										



Harper

Assessment Property Record Card for Tax Year 2026

Data provided by SHAYLYN WEDER County Assessor

Date 02/06/2026
 Time 07:15:48
 Page 2

Lot Data		Square-Foot - LAVERNE ORIGMULTI
Lot Size	75 x 140	
Lot Count		
Units Buildable	4200	
Non-Ag Acres		
Topography		
Street Access		
Utilities		
Amenities		
Method	Square-Foot	
Base Lot Value	10,500.00 x .40 = 4,200	
Factor Value		
Adjustments		
Lot Value	4,200	



HOUSE 3/1/2023

Residential Data	
Type	1 Single Family Residence
Condition	3.25 - Average
Quality	3 - Average
Architecture	TRAD TRADITIONAL
Style	100% One Story
Exterior Wall	100% Frame, Siding, Vinyl
Base/Total Area	1,456 / 1,456
Style	100% One Story
HVAC	100% Floor Furnace 1 Wall Air Conditioners (Cour
Roof Cover	1 Composition Shingle
Area on Slab	1,456
Fixture/RghIn	5 /
Bed/F/H Bath	2 / 1.0 /
Basement Area	
Garage Type	240 Detached Garage - Finished
Remodel	
Year/Eff Age	1930 / 91

GRM Approach

GRM Code	
Gross Rent Indicated Value	

Multiple Regression

MRA Code	
Adjusted R Indicated Value	

Direct Comparables

Selection Model	DEFAULT	DEFAULT SELECTION MODEL
Adjustment Model	DEFAULT	DEFAULT ADJUSTMENTS TABLE
Comparables Indicated Value		

Cost Approach		Manual :	
Base Cost	83.82	Total Misc Impr	+ 2,894
Roofing Adj	+ 4.00	Garage Cost	+ 12,402
Subfloor Adj	+ -1.91	Total RCN	= 149,248
Heat/Cool Adj	+ 1.73	Depreciation (78%)	- 116,413
Plumbing Adj	+ 4.38	Lump Sums	+ 0
Basement Adj	+ 0.00	RCNLD	= 32,835
Adj Base Cost	= 92.00	Lot Value	+ 4,200
Total Area	x 1,456	Indicated Value	= 37,035
Adjusted Cost	= 133,952	Value Per SqFt	25.44

Value Reconciliation

Selected Approach	Cost Approach		
Improvements	32,835		
Lot Value	4,200		
Indicated Value	37,035	25.44	Per SqFt
Agland Value			
Site Improvements	149		
Total Value	37,184	25.54	Total Value Per SqFt

Miscellaneous Improvements								
Code	Description	Sketch ID	Size	Year	Units	Unit Cost	Depr	Value
RSPC	Raised Slab Porch - Covered	5115	12x6		72	40.20		2,894



Harper

Assessment Property Record Card for Tax Year 2026

Data provided by SHAYLYN WEDER County Assessor

Date 02/06/2026
 Time 07:15:48
 Page 3

Sketch Image

300006010

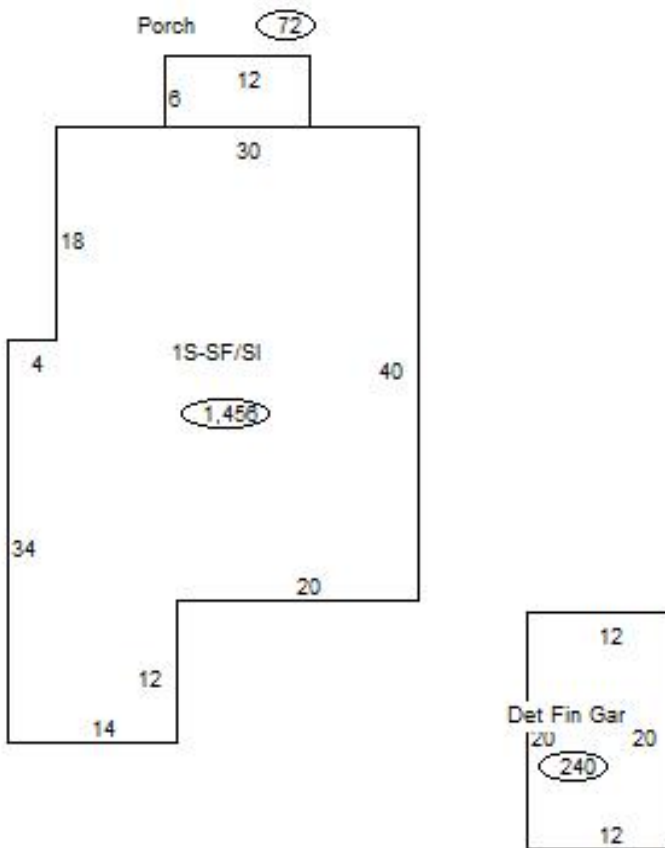

Sketch Vector Information

Sequence	Code	Type	Built Over	Scale	Section Label	Base Area	Multiplier	Total Area
1	R	1	Slab	20	1S-SF/SI	1,456	1.000	1,456
2	M	RSPC		20	Porch	72	1.000	72
3	G	6		20	Det Fin Gar	240	1.000	240
Total Building Area						1,456		1,456



Harper

Assessment Property Record Card for Tax Year 2026

Data provided by SHAYLYN WEDER County Assessor

Date 02/06/2026
Time 07:15:48
Page 4

300006010

Outbuildings/Site Improvements

Building Image	Code	Description	Dimensions	Floor	Roofing	Total Units
	PACN	Paving - Concrete / N. SIDEWALK	18x3x0			54
	Qual 3	Cond 3	Year 1930	Eff Age 96		
			0			
	Valuation Summary		Modifier Total	RCN	Depr (80% Phys/ % Func)	RCNLD
	Base Cost (7.73 x 54)		417		417	334
	PACN	Paving - Concrete / E. SIDEWALK	14x3x0			42
	Qual 3	Cond 3	Year 1930	Eff Age 96		
	Valuation Summary		Modifier Total	RCN	Depr (80% Phys/ % Func)	RCNLD
	Base Cost (7.91 x 42)		332		332	266