



# Harper

## Assessment Property Record Card for Tax Year 2026

Data provided by SHAYLYN WEDER County Assessor

Date 02/06/2026  
 Time 07:16:01  
 Page 1

Assessment Data					Primary Image																																																																																																																				
<b>Account</b> 300006024 <b>Parcel ID</b> 2001-00-048-003-0-001-00 <b>Cadastral ID</b> 2001-048-003-00-0-001-00 <b>Property Type</b> REAL - Real Property <b>Property Class</b> UR VI Area 1 <b>Tax Area</b> 202 - 1T-LAVERNE-C <b>Name ID</b> 15130 CARLISLE, CLYDE  P.O. BOX 606 LAVERNE OK 73848-0000  <b>Parcel Location</b> <b>Situs</b> 00405 W JANE JAYROE <b>Subdivision</b> LAVERNE ORIG. <b>Lot/Block</b> 0003 / 0048 <b>Parcel Size</b> 2 - Lots <b>Sec/Twn/Rng</b> / / / <b>Neighborhood</b> 200100 - LAVERNE ORIG\MULTI <b>School District</b> 1-LAVERN - 1-LAVERNE					<p>2001-00-048-003-0-001-00_001.JPG 2/28/2023</p>																																																																																																																				
<b>Legal Description</b> Lat/Long: 36.71046007 -99.90027817 LAVERNE ORIG BLOCK 48 LOTS 3-4																																																																																																																									
<b>Exemptions</b>					<b>Building Permits</b>																																																																																																																				
<table border="1"> <thead> <tr> <th>Code</th> <th>Type</th> <th>Active</th> <th>Maximum</th> <th>Exemption</th> </tr> </thead> <tbody> <tr> <td></td> <td></td> <td></td> <td></td> <td></td> </tr> </tbody> </table>					Code	Type	Active	Maximum	Exemption						<table border="1"> <thead> <tr> <th>Number</th> <th>Description</th> <th>Opened</th> <th>Closed</th> <th>Amount</th> </tr> </thead> <tbody> <tr> <td></td> <td></td> <td></td> <td></td> <td></td> </tr> </tbody> </table>					Number	Description	Opened	Closed	Amount																																																																																																	
Code	Type	Active	Maximum	Exemption																																																																																																																					
Number	Description	Opened	Closed	Amount																																																																																																																					
<table border="1"> <thead> <tr> <th>Code</th> <th>Type</th> <th>Active</th> <th>Maximum</th> <th>Exemption</th> </tr> </thead> <tbody> <tr> <td></td> <td></td> <td></td> <td></td> <td></td> </tr> </tbody> </table>					Code	Type	Active	Maximum	Exemption						<b>Sale History</b> <table border="1"> <thead> <tr> <th>Bk/Pg</th> <th>Grantor</th> <th>Date</th> <th>Price</th> <th>Code</th> </tr> </thead> <tbody> <tr> <td>489/748</td> <td>MARLYN LULA MAHAN, ETAL</td> <td>02/23/1993</td> <td>3,000</td> <td>U</td> </tr> </tbody> </table>					Bk/Pg	Grantor	Date	Price	Code	489/748	MARLYN LULA MAHAN, ETAL	02/23/1993	3,000	U																																																																																												
Code	Type	Active	Maximum	Exemption																																																																																																																					
Bk/Pg	Grantor	Date	Price	Code																																																																																																																					
489/748	MARLYN LULA MAHAN, ETAL	02/23/1993	3,000	U																																																																																																																					
<b>Parcel Valuation</b> <table border="1"> <thead> <tr> <th>Source</th> <th>REAL</th> <th>Fair Cash</th> <th>Capped</th> <th>Asmnt Level</th> <th>Assessed</th> <th>Levy Rate</th> <th>67.190</th> <th>Current Tax</th> </tr> </thead> <tbody> <tr> <td>Remove Cap</td> <td></td> <td>2,800</td> <td>2,800</td> <td>12%</td> <td>336</td> <td>Assessed</td> <td>2,772</td> <td>186.25</td> </tr> <tr> <td>Year Frozen</td> <td></td> <td>33,838</td> <td>20,296</td> <td></td> <td>2,436</td> <td>Penalty</td> <td>0</td> <td></td> </tr> <tr> <td>Uncapped Value</td> <td>0</td> <td>0</td> <td>0</td> <td></td> <td>0</td> <td>Exemption</td> <td>0</td> <td>0.00</td> </tr> <tr> <td>TIF Project ID</td> <td>0</td> <td>36,638</td> <td>23,096</td> <td></td> <td>2,772</td> <td>Total Taxable</td> <td>2,772</td> <td>186.00</td> </tr> </tbody> </table>										Source	REAL	Fair Cash	Capped	Asmnt Level	Assessed	Levy Rate	67.190	Current Tax	Remove Cap		2,800	2,800	12%	336	Assessed	2,772	186.25	Year Frozen		33,838	20,296		2,436	Penalty	0		Uncapped Value	0	0	0		0	Exemption	0	0.00	TIF Project ID	0	36,638	23,096		2,772	Total Taxable	2,772	186.00																																																																			
Source	REAL	Fair Cash	Capped	Asmnt Level	Assessed	Levy Rate	67.190	Current Tax																																																																																																																	
Remove Cap		2,800	2,800	12%	336	Assessed	2,772	186.25																																																																																																																	
Year Frozen		33,838	20,296		2,436	Penalty	0																																																																																																																		
Uncapped Value	0	0	0		0	Exemption	0	0.00																																																																																																																	
TIF Project ID	0	36,638	23,096		2,772	Total Taxable	2,772	186.00																																																																																																																	
<b>Assessment History</b> <table border="1"> <thead> <tr> <th>Tax Year</th> <th>Statement Number</th> <th>Billed Owner</th> <th>Tax Area</th> <th>Total Value</th> <th>Exemptions</th> <th>Taxable Value</th> <th>Billed Tax</th> </tr> </thead> <tbody> <tr><td>2025</td><td>2025-300006024</td><td>CARLISLE, CLYDE</td><td>202</td><td>36,638</td><td>0</td><td>2,640</td><td>177.00</td></tr> <tr><td>2024</td><td>2024-300006024</td><td>CARLISLE, CLYDE</td><td>202</td><td>27,229</td><td>0</td><td>2,514</td><td>167.00</td></tr> <tr><td>2023</td><td>2023-300006024</td><td>CARLISLE, CLYDE</td><td>202</td><td>19,953</td><td>0</td><td>2,394</td><td>161.00</td></tr> <tr><td>2022</td><td>2022-300006024</td><td>CARLISLE, CLYDE</td><td>202</td><td>19,953</td><td>0</td><td>2,394</td><td>162.00</td></tr> <tr><td>2021</td><td>2021-300006024</td><td>CARLISLE, CLYDE</td><td>202</td><td>19,953</td><td>0</td><td>2,394</td><td>165.00</td></tr> <tr><td>2020</td><td>2020-300006024</td><td>CARLISLE, CLYDE &amp;</td><td>202</td><td>19,953</td><td>0</td><td>2,394</td><td>162.00</td></tr> <tr><td>2019</td><td>2019-0006024</td><td>CARLISLE, CLYDE &amp;</td><td>202</td><td>19,959</td><td></td><td>2,395</td><td>143.00</td></tr> <tr><td>2018</td><td>2018-0006024</td><td>CARLISLE, CLYDE &amp;</td><td>202</td><td>21,651</td><td></td><td>2,312</td><td>138.00</td></tr> <tr><td>2017</td><td>2017-0006024</td><td>CARLISLE, CLYDE &amp;</td><td>202</td><td>20,825</td><td></td><td>2,202</td><td>131.00</td></tr> <tr><td>2016</td><td>2016-0006024</td><td>CARLISLE, CLYDE &amp;</td><td>202</td><td>20,825</td><td></td><td>2,097</td><td>125.00</td></tr> <tr><td>2015</td><td>2015-0006024</td><td>CARLISLE, CLYDE &amp;</td><td>202</td><td>20,569</td><td></td><td>1,998</td><td>119.00</td></tr> <tr><td>2014</td><td>2014-0006024</td><td>CARLISLE, CLYDE &amp;</td><td>202</td><td>21,935</td><td></td><td>1,901</td><td>113.00</td></tr> <tr><td>2013</td><td>2013-0006024</td><td>CARLISLE, CLYDE &amp;</td><td>202</td><td>27,702</td><td></td><td>1,812</td><td>108.00</td></tr> </tbody> </table>										Tax Year	Statement Number	Billed Owner	Tax Area	Total Value	Exemptions	Taxable Value	Billed Tax	2025	2025-300006024	CARLISLE, CLYDE	202	36,638	0	2,640	177.00	2024	2024-300006024	CARLISLE, CLYDE	202	27,229	0	2,514	167.00	2023	2023-300006024	CARLISLE, CLYDE	202	19,953	0	2,394	161.00	2022	2022-300006024	CARLISLE, CLYDE	202	19,953	0	2,394	162.00	2021	2021-300006024	CARLISLE, CLYDE	202	19,953	0	2,394	165.00	2020	2020-300006024	CARLISLE, CLYDE &	202	19,953	0	2,394	162.00	2019	2019-0006024	CARLISLE, CLYDE &	202	19,959		2,395	143.00	2018	2018-0006024	CARLISLE, CLYDE &	202	21,651		2,312	138.00	2017	2017-0006024	CARLISLE, CLYDE &	202	20,825		2,202	131.00	2016	2016-0006024	CARLISLE, CLYDE &	202	20,825		2,097	125.00	2015	2015-0006024	CARLISLE, CLYDE &	202	20,569		1,998	119.00	2014	2014-0006024	CARLISLE, CLYDE &	202	21,935		1,901	113.00	2013	2013-0006024	CARLISLE, CLYDE &	202	27,702		1,812	108.00
Tax Year	Statement Number	Billed Owner	Tax Area	Total Value	Exemptions	Taxable Value	Billed Tax																																																																																																																		
2025	2025-300006024	CARLISLE, CLYDE	202	36,638	0	2,640	177.00																																																																																																																		
2024	2024-300006024	CARLISLE, CLYDE	202	27,229	0	2,514	167.00																																																																																																																		
2023	2023-300006024	CARLISLE, CLYDE	202	19,953	0	2,394	161.00																																																																																																																		
2022	2022-300006024	CARLISLE, CLYDE	202	19,953	0	2,394	162.00																																																																																																																		
2021	2021-300006024	CARLISLE, CLYDE	202	19,953	0	2,394	165.00																																																																																																																		
2020	2020-300006024	CARLISLE, CLYDE &	202	19,953	0	2,394	162.00																																																																																																																		
2019	2019-0006024	CARLISLE, CLYDE &	202	19,959		2,395	143.00																																																																																																																		
2018	2018-0006024	CARLISLE, CLYDE &	202	21,651		2,312	138.00																																																																																																																		
2017	2017-0006024	CARLISLE, CLYDE &	202	20,825		2,202	131.00																																																																																																																		
2016	2016-0006024	CARLISLE, CLYDE &	202	20,825		2,097	125.00																																																																																																																		
2015	2015-0006024	CARLISLE, CLYDE &	202	20,569		1,998	119.00																																																																																																																		
2014	2014-0006024	CARLISLE, CLYDE &	202	21,935		1,901	113.00																																																																																																																		
2013	2013-0006024	CARLISLE, CLYDE &	202	27,702		1,812	108.00																																																																																																																		



# Harper

## Assessment Property Record Card for Tax Year 2026

Data provided by SHAYLYN WEDER County Assessor

Date 02/06/2026  
 Time 07:16:01  
 Page 2

Lot Data	Square-Foot - LAVERNE ORIGMULTI	Primary Image
Lot Size	50 x 140	
Lot Count		
Units Buildable	2800	
Non-Ag Acres		
Topography		
Street Access		
Utilities		
Amenities		
Method	Square-Foot	
Base Lot Value	7,000.00 x .40 = 2,800	
Factor Value		
Adjustments		
Lot Value	2,800	

Residential Data	
Type	1 Single Family Residence
Condition	4 - Good
Quality	3 - Average
Architecture	TRAD TRADITIONAL
Style	100% One Story
Exterior Wall	100% Frame, Siding, Wood
Base/Total Area	1,008 / 1,008
Style	100% One Story
HVAC	100% Floor Furnace
Roof Cover	1 Composition Shingle
Area on Slab	0
Fixture/RghIn	5 /
Bed/F/H Bath	2 / 1.0 /
Basement Area	
Garage Type	
Remodel	
Year/Eff Age	1930 / 77



2001-00-048-003-0-001-00\_001.JPG 2/28/2023

GRM Approach	
GRM Code	
Gross Rent	
Indicated Value	

Multiple Regression	
MRA Code	
Adjusted R	
Indicated Value	

Direct Comparables	
Selection Model	DEFAULT DEFAULT SELECTION MODEL
Adjustment Model	DEFAULT DEFAULT ADJUSTMENTS TABLE
Comparables	
Indicated Value	

Cost Approach		Manual :	
Base Cost	93.10	Total Misc Impr	+ 4,798
Roofing Adj	+ 4.41	Garage Cost	+ 0
Subfloor Adj	+ 0.00	Total RCN	= 111,202
Heat/Cool Adj	+ 1.73	Depreciation ( 70%)	- 77,841
Plumbing Adj	+ 6.32	Lump Sums	+ 0
Basement Adj	+ 0.00	RCNLD	= 33,361
Adj Base Cost	= 105.56	Lot Value	+ 2,800
Total Area	x 1,008	Indicated Value	= 36,161
Adjusted Cost	= 106,404	Value Per SqFt	35.87

Value Reconciliation			
Selected Approach	Cost Approach		
Improvements	33,361		
Lot Value	2,800		
Indicated Value	36,161	35.87	Per SqFt
Agland Value			
Site Improvements	756		
Total Value	36,917	36.62	Total Value Per SqFt

Miscellaneous Improvements							
Code	Description	Sketch ID	Size	Year	Units	Unit Cost	Depr Value
RSPC	Raised Slab Porch - Covered	5156	20x6		120	39.98	4,798



Harper

Assessment Property Record Card for Tax Year 2026

Data provided by SHAYLYN WEDER County Assessor

Date 02/06/2026  
Time 07:16:01  
Page 3

Sketch Image

300006024

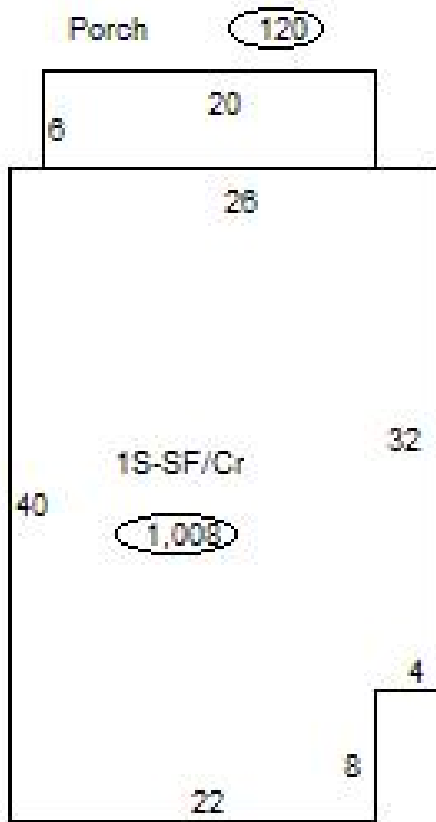

Sketch Vector Information

Sequence	Code	Type	Built Over	Scale	Section Label	Base Area	Multiplier	Total Area
1	R	1	Crawl	20	1S-SF/Cr	1,008	1.000	1,008
2	M	RSPC		20	Porch	120	1.000	120
<b>Total Building Area</b>						<b>1,008</b>		<b>1,008</b>



# Harper

## Assessment Property Record Card for Tax Year 2026

Data provided by SHAYLYN WEDER County Assessor

Date 02/06/2026  
Time 07:16:01  
Page 4

300006024

### Outbuildings/Site Improvements

Building Image	Code	Description	Dimensions	Floor	Roofing	Total Units
	SHDS	Yard Shed - Metal	12x10x6		Composition Roll	120
	<b>Qual</b> 3	<b>Cond</b> 3	<b>Year</b> 1990	<b>Eff Age</b> 36		

Valuation Summary	Modifier Total	RCN	Depr (80% Phys/ % Func)	RCNLD
Base Cost (22.67 x 120)	2,720		2,720	544



PACN	Paving - Concrete / FRONT SIDEWALK	16x3x0			48
<b>Qual</b> 3	<b>Cond</b> 3	<b>Year</b> 1930	<b>Eff Age</b> 96		

Valuation Summary	Modifier Total	RCN	Depr (80% Phys/ % Func)	RCNLD
Base Cost (7.82 x 48)	375		375	75

PACN	Paving - Concrete / E. SIDEWALK	32x3x0			96
<b>Qual</b> 3	<b>Cond</b> 3	<b>Year</b> 1930	<b>Eff Age</b> 96		

Valuation Summary	Modifier Total	RCN	Depr (80% Phys/ % Func)	RCNLD
Base Cost (7.12 x 96)	684		684	137