



# Harper

## Assessment Property Record Card for Tax Year 2026

Data provided by SHAYLYN WEDER County Assessor

Date 02/06/2026  
Time 07:17:47  
Page 1

Assessment Data					Primary Image				
Account	300006142				<p>FRONT OF HOUSE 4/30/2025</p>				
Parcel ID	2001-00-061-007-0-001-00								
Cadastral ID	2001-061-007-00-0-001-00								
Property Type	REAL - Real Property								
Property Class	UR	VI Area	3						
Tax Area	202 - 1T-LAVERNE-C								
Name ID	15208								
DOMINGUEZ, ISMAEL & NOEMI DOMINGUEZ									
P O BOX 357 LAVERNE OK 73848-0000									
Parcel Location									
Situs	00315 NW SECOND ST								
Subdivision	LAVERNE ORIG.								
Lot/Block	0007 / 0061	Parcel Size	2 - Lots						
Sec/Twn/Rng	/ / /								
Neighborhood	200100 - LAVERNE ORIG\MULTI								
School District	1-LAVERN - 1-LAVERNE								
Legal Description	Lat/Long: 36.71408270 -99.89442847				Building Permits				
LAVERNE ORIG BLOCK 61 LOTS 7-8					Number	Description	Opened	Closed	Amount
Exemptions					Sale History				
Code	Type	Active	Maximum	Exemption	Bk/Pg	Grantor	Date	Price	Code
					718/44	MANNING, DANNY RAY &	05/17/2016	11,000	16
					595/188	MCKINNEY, CHARLES R.	07/30/2004	9,500	U
Parcel Valuation									
Source	REAL		Fair Cash	Capped	Asmnt Level	Assessed	Levy Rate	67.190	Current Tax
Remove Cap		Land Value	2,800	2,201	12%	264	Assessed	2,047	137.54
Year Frozen		Improvements	24,392	14,858		1,783	Penalty	0	
Uncapped Value	0	Mobile Home	0	0		0	Exemption	0	0.00
TIF Project ID	0	Total Value	27,192	17,059		2,047	Total Taxable	2,047	138.00
Assessment History									
Tax Year	Statement Number	Billed Owner			Tax Area	Total Value	Exemptions	Taxable Value	Billed Tax
2025	2025-300006142	DOMINGUEZ, ISMAEL &			202	27,192	0	1,950	131.00
2024	2024-300006142	DOMINGUEZ, ISMAEL &			202	29,267	0	1,857	124.00
2023	2023-300006142	DOMINGUEZ, ISMAEL &			202	26,622	0	1,768	119.00
2022	2022-300006142	DOMINGUEZ, ISMAEL &			202	22,361	0	1,684	114.00
2021	2021-300006142	DOMINGUEZ, ISMAEL &			202	20,439	0	1,605	111.00
2020	2020-300006142	DOMINGUEZ, ISMAEL &			202	20,439	0	1,528	104.00
2019	2019-0006142	DOMINGUEZ, ISMAEL &			202	20,439		1,455	87.00
2018	2018-0006142	DOMINGUEZ, ISMAEL &			202	22,167		1,386	83.00
2017	2017-0006142	DOMINGUEZ, ISMAEL &			202	11,000		1,320	79.00
2016	2016-0006142	DOMINGUEZ, ISMAEL &			202	21,319		2,466	147.00
2015	2015-0006142	MANNING, DANNY RAY &			202	21,057		2,348	140.00
2014	2014-0006142	MANNING, DANNY RAY &			202	22,459		2,237	134.00
2013	2013-0006142	MANNING, DANNY RAY &			202	31,383		2,131	127.00



# Harper

## Assessment Property Record Card for Tax Year 2026

Data provided by SHAYLYN WEDER County Assessor

Date 02/06/2026  
 Time 07:17:47  
 Page 2

Lot Data		Square-Foot - LAVERNE ORIGMULTI	
Lot Size	50 x 140		
Lot Count			
Units Buildable	2800		
Non-Ag Acres			
Topography			
Street Access			
Utilities			
Amenities			
Method	Square-Foot		
Base Lot Value	7,000.00 x .40 = 2,800		
Factor Value			
Adjustments			
Lot Value	2,800		



FRONT OF HOUSE 4/30/2025

Residential Data	
Type	1 Single Family Residence
Condition	3 - Average
Quality	3 - Average
Architecture	TRAD TRADITIONAL
Style	100% One Story
Exterior Wall	100% Frame, Stucco
Base/Total Area	854 / 854
Style	100% One Story
HVAC	100% Floor Furnace 1 Wall Air Conditioners (Cour
Roof Cover	1 Composition Shingle
Area on Slab	854
Fixture/RghIn	5 /
Bed/F/H Bath	2 / 1.0 /
Basement Area	
Garage Type	200 Detached Garage - Unfinished
Remodel	
Year/Eff Age	1930 / 96

### GRM Approach

GRM Code	
Gross Rent Indicated Value	

### Multiple Regression

MRA Code	
Adusted R Indicated Value	

### Direct Comparables

Selection Model	DEFAULT	DEFAULT SELECTION MODEL
Adjustment Model	DEFAULT	DEFAULT ADJUSTMENTS TABLE
Comparables Indicated Value		

Cost Approach		Manual :	
Base Cost	99.53	Total Misc Impr	+ 18,034
Roofing Adj	+ 4.64	Garage Cost	+ 9,338
Subfloor Adj	+ -2.16	Total RCN	= 122,345
Heat/Cool Adj	+ 1.73	Depreciation ( 80%)	- 97,876
Plumbing Adj	+ 7.47	Lump Sums	+ 0
Basement Adj	+ 0.00	RCNLD	= 24,469
Adj Base Cost	= 111.21	Lot Value	+ 2,800
Total Area	x 854	Indicated Value	= 27,269
Adjusted Cost	= 94,973	Value Per SqFt	31.93

### Value Reconciliation

Selected Approach	Cost Approach		
Improvements	24,469		
Lot Value	2,800		
Indicated Value	27,269	31.93	Per SqFt
Agland Value			
Site Improvements			
Total Value	27,269	31.93	Total Value Per SqFt

### Miscellaneous Improvements

Code	Description	Sketch ID	Size	Year	Units	Unit Cost	Depr	Value
EPSW	Enclosed Porch - Solid Wall	5416	22x13		286	58.30		16,674
PATO	Raised Slab Porch - Open	8020	16x4		64	9.78		626
PATO	Slab Porch - Open	8021	15x5		75	9.78		734



Harper

Assessment Property Record Card for Tax Year 2026

Data provided by SHAYLYN WEDER County Assessor

Date 02/06/2026  
Time 07:17:47  
Page 3

Sketch Image

300006142

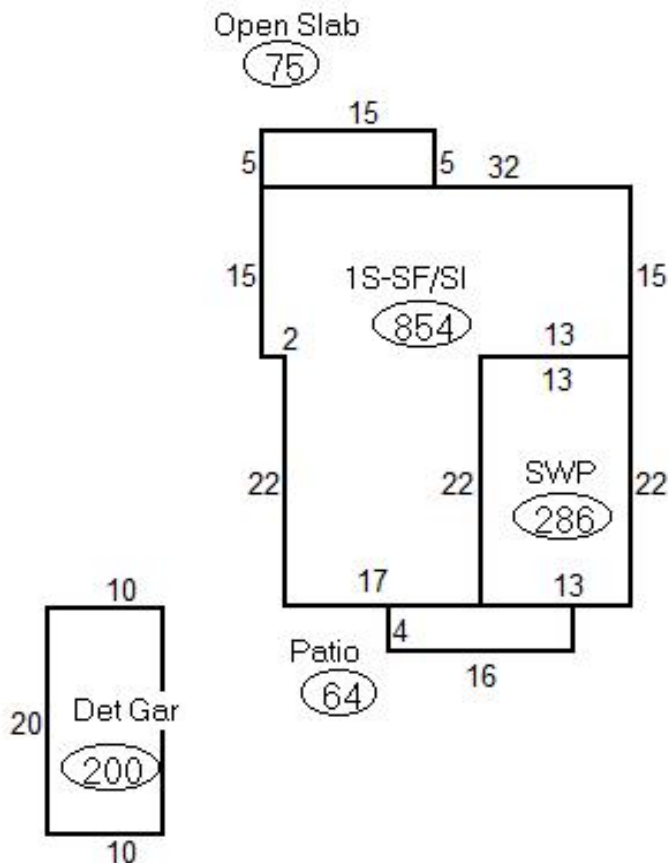

Sketch Vector Information

Sequence	Code	Type	Built Over	Scale	Section Label	Base Area	Multiplier	Total Area
1	M	EPSW		20	SWP	286	1.000	286
2	R	1	Slab	20	1S-SF/SI	854	1.000	854
3	G	2		20	Det Gar	200	1.000	200
4	M	PATO		20	Patio	64	1.000	64
5	M	PATO		20	Open Slab	75	1.000	75
<b>Total Building Area</b>						<b>854</b>		<b>854</b>