



Harper

Assessment Property Record Card for Tax Year 2026

Data provided by SHAYLYN WEDER County Assessor

Date 02/06/2026
 Time 07:18:44
 Page 1

Assessment Data					Primary Image																																																																																																															
Account	300006205																																																																																																																			
Parcel ID	2001-00-067-007-0-001-00																																																																																																																			
Cadastral ID	2001-067-007-00-0-001-00																																																																																																																			
Property Type	REAL - Real Property																																																																																																																			
Property Class	UR	VI Area	3																																																																																																																	
Tax Area	202 - 1T-LAVERNE-C																																																																																																																			
Name ID	25083																																																																																																																			
HATHCOCK, DYLAN																																																																																																																				
217 NW 3RD LAVERNE OK 73848-																																																																																																																				
Parcel Location Situs 00217 NW THIRD ST Subdivision LAVERNE ORIG. Lot/Block 0007 / 0067 Parcel Size 3 - Lots Sec/Twn/Rng / / / Neighborhood 200100 - LAVERNE ORIG\MULTI School District 1-LAVERN - 1-LAVERNE																																																																																																																				
HOUSE 4/24/2025																																																																																																																				
Legal Description Lat/Long: 36.70824139 -99.89138496																																																																																																																				
Building Permits <table border="1"> <thead> <tr> <th>Number</th> <th>Description</th> <th>Opened</th> <th>Closed</th> <th>Amount</th> </tr> </thead> <tbody> <tr> <td colspan="5"> </td> </tr> </tbody> </table>					Number	Description	Opened	Closed	Amount																																																																																																											
Number	Description	Opened	Closed	Amount																																																																																																																
Exemptions <table border="1"> <thead> <tr> <th>Code</th> <th>Type</th> <th>Active</th> <th>Maximum</th> <th>Exemption</th> </tr> </thead> <tbody> <tr> <td colspan="5"> </td> </tr> </tbody> </table>					Code	Type	Active	Maximum	Exemption																																																																																																											
Code	Type	Active	Maximum	Exemption																																																																																																																
Sale History <table border="1"> <thead> <tr> <th>Bk/Pg</th> <th>Grantor</th> <th>Date</th> <th>Price</th> <th>Code</th> </tr> </thead> <tbody> <tr> <td>768/14</td> <td>HARRIS, TREVOR</td> <td>05/05/2022</td> <td>55,000</td> <td>Q</td> </tr> <tr> <td>722/636</td> <td>PRIEST, LARRY AND</td> <td>03/15/2016</td> <td>50,000</td> <td>Q</td> </tr> <tr> <td>569/154</td> <td>HOCH, LAURA A.</td> <td>10/23/2001</td> <td>42,053</td> <td>PQ</td> </tr> </tbody> </table>					Bk/Pg	Grantor	Date	Price	Code	768/14	HARRIS, TREVOR	05/05/2022	55,000	Q	722/636	PRIEST, LARRY AND	03/15/2016	50,000	Q	569/154	HOCH, LAURA A.	10/23/2001	42,053	PQ																																																																																												
Bk/Pg	Grantor	Date	Price	Code																																																																																																																
768/14	HARRIS, TREVOR	05/05/2022	55,000	Q																																																																																																																
722/636	PRIEST, LARRY AND	03/15/2016	50,000	Q																																																																																																																
569/154	HOCH, LAURA A.	10/23/2001	42,053	PQ																																																																																																																
Parcel Valuation <table border="1"> <thead> <tr> <th>Source</th> <th>REAL</th> <th>Fair Cash</th> <th>Capped</th> <th>Asmnt Level</th> <th>Assessed</th> <th>Levy Rate</th> <th>67.190</th> <th>Current Tax</th> </tr> </thead> <tbody> <tr> <td>Remove Cap</td> <td>2023</td> <td>Land Value 4,200</td> <td>4,200</td> <td>12%</td> <td>504</td> <td>Assessed 6,810</td> <td>6,810</td> <td>457.56</td> </tr> <tr> <td>Year Frozen</td> <td></td> <td>Improvements 52,552</td> <td>52,552</td> <td></td> <td>6,306</td> <td>Penalty 0</td> <td>0</td> <td></td> </tr> <tr> <td>Uncapped Value</td> <td>0</td> <td>Mobile Home 0</td> <td>0</td> <td></td> <td>0</td> <td>Exemption 0</td> <td>0</td> <td>0.00</td> </tr> <tr> <td>TIF Project ID</td> <td>0</td> <td>Total Value 56,752</td> <td>56,752</td> <td></td> <td>6,810</td> <td>Total Taxable 6,810</td> <td>6,810</td> <td>458.00</td> </tr> </tbody> </table>					Source	REAL	Fair Cash	Capped	Asmnt Level	Assessed	Levy Rate	67.190	Current Tax	Remove Cap	2023	Land Value 4,200	4,200	12%	504	Assessed 6,810	6,810	457.56	Year Frozen		Improvements 52,552	52,552		6,306	Penalty 0	0		Uncapped Value	0	Mobile Home 0	0		0	Exemption 0	0	0.00	TIF Project ID	0	Total Value 56,752	56,752		6,810	Total Taxable 6,810	6,810	458.00																																																																			
Source	REAL	Fair Cash	Capped	Asmnt Level	Assessed	Levy Rate	67.190	Current Tax																																																																																																												
Remove Cap	2023	Land Value 4,200	4,200	12%	504	Assessed 6,810	6,810	457.56																																																																																																												
Year Frozen		Improvements 52,552	52,552		6,306	Penalty 0	0																																																																																																													
Uncapped Value	0	Mobile Home 0	0		0	Exemption 0	0	0.00																																																																																																												
TIF Project ID	0	Total Value 56,752	56,752		6,810	Total Taxable 6,810	6,810	458.00																																																																																																												
Assessment History <table border="1"> <thead> <tr> <th>Tax Year</th> <th>Statement Number</th> <th>Billed Owner</th> <th>Tax Area</th> <th>Total Value</th> <th>Exemptions</th> <th>Taxable Value</th> <th>Billed Tax</th> </tr> </thead> <tbody> <tr><td>2025</td><td>2025-300006205</td><td>HATHCOCK, DYLAN</td><td>202</td><td>56,752</td><td>0</td><td>6,810</td><td>458.00</td></tr> <tr><td>2024</td><td>2024-300006205</td><td>HATHCOCK, DYLAN</td><td>202</td><td>60,653</td><td>0</td><td>6,930</td><td>461.00</td></tr> <tr><td>2023</td><td>2023-300006205</td><td>HATHCOCK, DYLAN</td><td>202</td><td>55,000</td><td>0</td><td>6,600</td><td>443.00</td></tr> <tr><td>2022</td><td>2022-300006205</td><td>HATHCOCK, DYLAN</td><td>202</td><td>48,495</td><td>0</td><td>5,819</td><td>394.00</td></tr> <tr><td>2021</td><td>2021-300006205</td><td>HARRIS, TREVOR</td><td>202</td><td>47,421</td><td>0</td><td>5,691</td><td>393.00</td></tr> <tr><td>2020</td><td>2020-300006205</td><td>HARRIS, TREVOR</td><td>202</td><td>47,421</td><td>0</td><td>5,691</td><td>386.00</td></tr> <tr><td>2019</td><td>2019-0006205</td><td>HARRIS, TREVOR</td><td>202</td><td>47,421</td><td></td><td>5,691</td><td>340.00</td></tr> <tr><td>2018</td><td>2018-0006205</td><td>HARRIS, TREVOR</td><td>202</td><td>50,901</td><td></td><td>6,108</td><td>365.00</td></tr> <tr><td>2017</td><td>2017-0006205</td><td>HARRIS, TREVOR</td><td>202</td><td>50,000</td><td></td><td>6,000</td><td>358.00</td></tr> <tr><td>2016</td><td>2016-0006205</td><td>PRIEST, LARRY AND</td><td>202</td><td>49,082</td><td></td><td>5,890</td><td>352.00</td></tr> <tr><td>2015</td><td>2015-0006205</td><td>PRIEST, LARRY AND</td><td>202</td><td>48,525</td><td></td><td>5,823</td><td>348.00</td></tr> <tr><td>2014</td><td>2014-0006205</td><td>PRIEST, LARRY AND</td><td>202</td><td>51,532</td><td></td><td>6,184</td><td>369.00</td></tr> <tr><td>2013</td><td>2013-0006205</td><td>PRIEST, LARRY AND</td><td>202</td><td>49,843</td><td></td><td>4,981</td><td>297.00</td></tr> </tbody> </table>					Tax Year	Statement Number	Billed Owner	Tax Area	Total Value	Exemptions	Taxable Value	Billed Tax	2025	2025-300006205	HATHCOCK, DYLAN	202	56,752	0	6,810	458.00	2024	2024-300006205	HATHCOCK, DYLAN	202	60,653	0	6,930	461.00	2023	2023-300006205	HATHCOCK, DYLAN	202	55,000	0	6,600	443.00	2022	2022-300006205	HATHCOCK, DYLAN	202	48,495	0	5,819	394.00	2021	2021-300006205	HARRIS, TREVOR	202	47,421	0	5,691	393.00	2020	2020-300006205	HARRIS, TREVOR	202	47,421	0	5,691	386.00	2019	2019-0006205	HARRIS, TREVOR	202	47,421		5,691	340.00	2018	2018-0006205	HARRIS, TREVOR	202	50,901		6,108	365.00	2017	2017-0006205	HARRIS, TREVOR	202	50,000		6,000	358.00	2016	2016-0006205	PRIEST, LARRY AND	202	49,082		5,890	352.00	2015	2015-0006205	PRIEST, LARRY AND	202	48,525		5,823	348.00	2014	2014-0006205	PRIEST, LARRY AND	202	51,532		6,184	369.00	2013	2013-0006205	PRIEST, LARRY AND	202	49,843		4,981	297.00
Tax Year	Statement Number	Billed Owner	Tax Area	Total Value	Exemptions	Taxable Value	Billed Tax																																																																																																													
2025	2025-300006205	HATHCOCK, DYLAN	202	56,752	0	6,810	458.00																																																																																																													
2024	2024-300006205	HATHCOCK, DYLAN	202	60,653	0	6,930	461.00																																																																																																													
2023	2023-300006205	HATHCOCK, DYLAN	202	55,000	0	6,600	443.00																																																																																																													
2022	2022-300006205	HATHCOCK, DYLAN	202	48,495	0	5,819	394.00																																																																																																													
2021	2021-300006205	HARRIS, TREVOR	202	47,421	0	5,691	393.00																																																																																																													
2020	2020-300006205	HARRIS, TREVOR	202	47,421	0	5,691	386.00																																																																																																													
2019	2019-0006205	HARRIS, TREVOR	202	47,421		5,691	340.00																																																																																																													
2018	2018-0006205	HARRIS, TREVOR	202	50,901		6,108	365.00																																																																																																													
2017	2017-0006205	HARRIS, TREVOR	202	50,000		6,000	358.00																																																																																																													
2016	2016-0006205	PRIEST, LARRY AND	202	49,082		5,890	352.00																																																																																																													
2015	2015-0006205	PRIEST, LARRY AND	202	48,525		5,823	348.00																																																																																																													
2014	2014-0006205	PRIEST, LARRY AND	202	51,532		6,184	369.00																																																																																																													
2013	2013-0006205	PRIEST, LARRY AND	202	49,843		4,981	297.00																																																																																																													



Harper

Assessment Property Record Card for Tax Year 2026

Data provided by SHAYLYN WEDER County Assessor

Date 02/06/2026
 Time 07:18:45
 Page 2

Lot Data	Square-Foot - LAVERNE ORIGMULTI	Primary Image
Lot Size	75 x 140	
Lot Count		
Units Buildable	4200	
Non-Ag Acres		
Topography		
Street Access		
Utilities		
Amenities		
Method	Square-Foot	
Base Lot Value	10,500.00 x .40 = 4,200	
Factor Value		
Adjustments		
Lot Value	4,200	

Residential Data	
Type	1 Single Family Residence
Condition	3 - Average
Quality	2.75 - Fair
Architecture	TRAD TRADITIONAL
Style	100% One Story
Exterior Wall	100% Frame, Siding, Wood
Base/Total Area	1,456 / 1,456
Style	100% One Story
HVAC	100% Floor Furnace
Roof Cover	1 Composition Shingle
Area on Slab	0
Fixture/RghIn	5 /
Bed/F/H Bath	2 / 1.0 /
Basement Area	780 Total
Garage Type	
Remodel	PARTIAL -
Year/Eff Age	1940 / 66

HOUSE	4/24/2025
-------	-----------

GRM Approach	
GRM Code	
Gross Rent	
Indicated Value	

Multiple Regression	
MRA Code	
Adjusted R	
Indicated Value	

Direct Comparables	
Selection Model	DEFAULT DEFAULT SELECTION MODEL
Adjustment Model	DEFAULT DEFAULT ADJUSTMENTS TABLE
Comparables	
Indicated Value	

Value Reconciliation			
Selected Approach	Cost Approach		
Improvements	52,892		
Lot Value	4,200		
Indicated Value	57,092	39.21	Per SqFt
Agland Value			
Site Improvements	5,881		
Total Value	62,973	43.25	Total Value Per SqFt

Cost Approach		Manual :	
Base Cost	81.57	Total Misc Impr	+ 13,820
Roofing Adj	+ 3.81	Garage Cost	+ 0
Subfloor Adj	+ 0.48	Total RCN	= 165,288
Heat/Cool Adj	+ 1.65	Depreciation (68%)	- 112,396
Plumbing Adj	+ 4.17	Lump Sums	+ 0
Basement Adj	+ 12.36	RCNLD	= 52,892
Adj Base Cost	= 104.03	Lot Value	+ 4,200
Total Area	x 1,456	Indicated Value	= 57,092
Adjusted Cost	= 151,468	Value Per SqFt	39.21

Miscellaneous Improvements								
Code	Description	Sketch ID	Size	Year	Units	Unit Cost	Depr	Value
FPR1	Fireplace - Residential 1 Story	0		1940	1	4,562.09		4,562
RSPC	Raised Slab Porch - Covered	5652	20x8	1940	160	37.91		6,066
WODO	Wood Deck - Open	13463	20x8	2025	160	19.95		3,192



Harper

Assessment Property Record Card for Tax Year 2026

Data provided by SHAYLYN WEDER County Assessor

Date 02/06/2026
Time 07:18:45
Page 3

Sketch Image

300006205

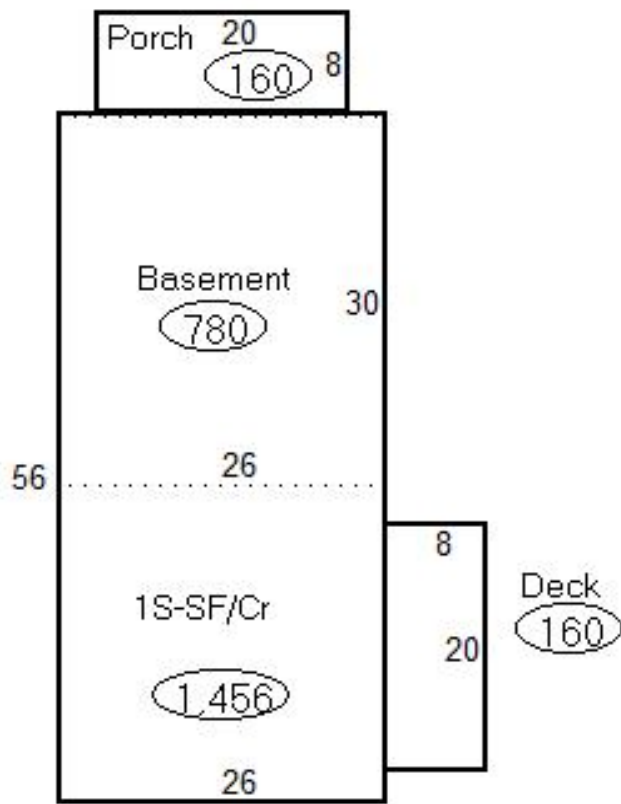

Sketch Vector Information

Sequence	Code	Type	Built Over	Scale	Section Label	Base Area	Multiplier	Total Area
1	R	1	Crawl	20	1S-SF/Cr	1,456	1.000	1,456
2	B	1		20	Basement	780	1.000	780
3	M	RSPC		20	Porch	160	1.000	160
4	M	WODO		20	Deck	160	1.000	160
Total Building Area						1,456		1,456



Harper

Assessment Property Record Card for Tax Year 2026

Data provided by SHAYLYN WEDER County Assessor

Date 02/06/2026
 Time 07:18:45
 Page 4

300006205

Outbuildings/Site Improvements

Building Image	Code	Description	Dimensions	Floor	Roofing	Total Units
	SHDS	Shed - Small	16x12x8	Base	Formed Metal	192
	Qual	3	Cond 3	Year 2014	Eff Age 12	
	Valuation Summary		Modifier Total	RCN	Depr (46% Phys/ % Func)	RCNLD
	Base Cost (21.04 x 192)		4,040	4,040	1,858	2,182
	CPDT	Carport - Detached	24x24x10	Gravel	Composition Roll	576
	Qual	2.75	Cond 3	Year 2010	Eff Age 16	
	Valuation Summary		Modifier Total	RCN	Depr (60% Phys/ % Func)	RCNLD
	Base Cost (5.84 x 576)		3,364	3,364	2,018	1,346
	SHDS	Shed - Small	14x16x8	Base	Composition Shingle	224
	Qual	3	Cond 3	Year 2006	Eff Age 20	
	Valuation Summary		Modifier Total	RCN	Depr (59% Phys/ % Func)	RCNLD
	Base Cost (19.62 x 224)		4,395	4,395	2,593	1,802
	SHDS	Yard Shed - Metal	12x10x6		Formed Metal	120
	Qual	3	Cond 3	Year 1990	Eff Age 36	
	Valuation Summary		Modifier Total	RCN	Depr (80% Phys/ % Func)	RCNLD
	Base Cost (22.95 x 120)		2,754	2,754	2,203	551