



Harper

Assessment Property Record Card for Tax Year 2026

Data provided by SHAYLYN WEDER County Assessor

Date 02/06/2026
 Time 07:21:48
 Page 1

Assessment Data					Primary Image														
Account 300006404 Parcel ID 2060-00-017-023-0-001-00 Cadastral ID 2060-017-023-00-0-001-00 Property Type REAL - Real Property Property Class UR VI Area 1 Tax Area 202 - 1T-LAVERNE-C Name ID 15385 CRISSUP, STACY J PO BOX 691 LAVERNE OK 73848-0000 Parcel Location Situs 00501 S OKLAHOMA Subdivision TERBUSH ADDN Lot/Block 0023 / 0017 Parcel Size 2 - Lots Sec/Twn/Rng / / / Neighborhood 200100 - LAVERNE ORIG\MULTI School District 1-LAVERN - 1-LAVERNE					<p>2060-00-017-023-0-001-00 03/10/23</p>														
HOUSE 3/13/2023																			
Legal Description Lat/Long: 36.70786008 -99.89456688					Building Permits														
TERBUSH ADD BLOCK 17 LOTS 23-24					<table border="1"> <thead> <tr> <th>Number</th> <th>Description</th> <th>Opened</th> <th>Closed</th> <th>Amount</th> </tr> </thead> <tbody> <tr> <td> </td> <td> </td> <td> </td> <td> </td> <td> </td> </tr> </tbody> </table>					Number	Description	Opened	Closed	Amount					
Number	Description	Opened	Closed	Amount															
Exemptions					Sale History														
Code	Type	Active	Maximum	Exemption	Bk/Pg	Grantor	Date	Price	Code										
					704/797	STRAIN, NORMA	01/12/2015	63,500	21										
Parcel Valuation																			
Source	REAL	Fair Cash	Capped	Asmnt Level	Assessed	Levy Rate	67.190	Current Tax											
Remove Cap		Land Value	2,800	2,800	12%	336	Assessed	7,916	531.88										
Year Frozen		Improvements	63,163	63,163		7,580	Penalty	0											
Uncapped Value	0	Mobile Home	0	0		0	Exemption	0	0.00										
TIF Project ID	0	Total Value	65,963	65,963		7,916	Total Taxable	7,916	532.00										
Assessment History																			
Tax Year	Statement Number	Billed Owner	Tax Area	Total Value	Exemptions	Taxable Value	Billed Tax												
2025	2025-300006404	CRISSUP, STACY J	202	65,963	0	7,916	532.00												
2024	2024-300006404	CRISSUP, STACY J	202	70,906	0	7,802	519.00												
2023	2023-300006404	CRISSUP, STACY J	202	61,918	0	7,430	499.00												
2022	2022-300006404	CRISSUP, STACY J	202	61,918	0	7,430	503.00												
2021	2021-300006404	CRISSUP, STACY J	202	61,918	0	7,430	513.00												
2020	2020-300006404	CRISSUP, STACY J	202	61,918	0	7,430	503.00												
2019	2019-0006404	CRISSUP, STACY J	202	63,500		7,620	455.00												
2018	2018-0006404	CRISSUP, STACY J	202	63,500		7,620	455.00												
2017	2017-0006404	CRISSUP, STACY J	202	63,500		7,620	455.00												
2016	2016-0006404	CRISSUP, STACY J	202	63,500		7,620	455.00												
2015	2015-0006404	CRISSUP, STACY J	202	49,887		4,931	294.00												
2014	2014-0006404	STRAIN, NORMA &	202	54,388		4,698	280.00												
2013	2013-0006404	STRAIN, NORMA AND	202	75,858		4,474	267.00												



Harper

Assessment Property Record Card for Tax Year 2026

Data provided by SHAYLYN WEDER County Assessor

Date 02/06/2026
 Time 07:21:48
 Page 2

Lot Data	Square-Foot - LAVERNE ORIGMULTI	Primary Image
Lot Size	50 x 140	
Lot Count		
Units Buildable	2800	
Non-Ag Acres		
Topography		
Street Access		
Utilities		
Amenities		
Method	Square-Foot	
Base Lot Value	7,000.00 x .40 = 2,800	
Factor Value		
Adjustments		
Lot Value	2,800	

Residential Data	
Type	1 Single Family Residence
Condition	3 - Average
Quality	3 - Average
Architecture	TRAD TRADITIONAL
Style	100% One Story
Exterior Wall	100% Veneer, Masonry
Base/Total Area	1,107 / 1,107
Style	100% One Story
HVAC	100% Warmed & Cooled Air
Roof Cover	1 Composition Shingle
Area on Slab	0
Fixture/RghIn	5 /
Bed/F/H Bath	2 / 1.0 /
Basement Area	
Garage Type	294 Attached Garage - Unfinished
Remodel	ROOF -
Year/Eff Age	1962 / 64

HOUSE	3/13/2023
-------	-----------

GRM Approach	
GRM Code	
Gross Rent	
Indicated Value	

Multiple Regression	
MRA Code	
Adusted R	
Indicated Value	

Direct Comparables	
Selection Model	DEFAULT DEFAULT SELECTION MODEL
Adjustment Model	DEFAULT DEFAULT ADJUSTMENTS TABLE
Comparables	
Indicated Value	

Cost Approach		Manual :	
Base Cost	98.63	Total Misc Impr	+ 2,255
Roofing Adj	+ 4.31	Garage Cost	+ 9,347
Subfloor Adj	+ 0.00	Total RCN	= 143,855
Heat/Cool Adj	+ 10.77	Depreciation (65%)	- 93,505
Plumbing Adj	+ 5.75	Lump Sums	+ 0
Basement Adj	+ 0.00	RCNLD	= 50,350
Adj Base Cost	= 119.47	Lot Value	+ 2,800
Total Area	x 1,107	Indicated Value	= 53,150
Adjusted Cost	= 132,253	Value Per SqFt	48.01

Value Reconciliation			
Selected Approach	Cost Approach		
Improvements	50,350		
Lot Value	2,800		
Indicated Value	53,150	48.01	Per SqFt
Agland Value			
Site Improvements	11,571		
Total Value	64,721	58.47	Total Value Per SqFt

Miscellaneous Improvements								
Code	Description	Sketch ID	Size	Year	Units	Unit Cost	Depr	Value
RSPC	Raised Slab Porch - Covered	6187	14x4		56	40.27		2,255



Harper

Assessment Property Record Card for Tax Year 2026

Data provided by SHAYLYN WEDER County Assessor

Date 02/06/2026
 Time 07:21:48
 Page 3

Sketch Image

300006404

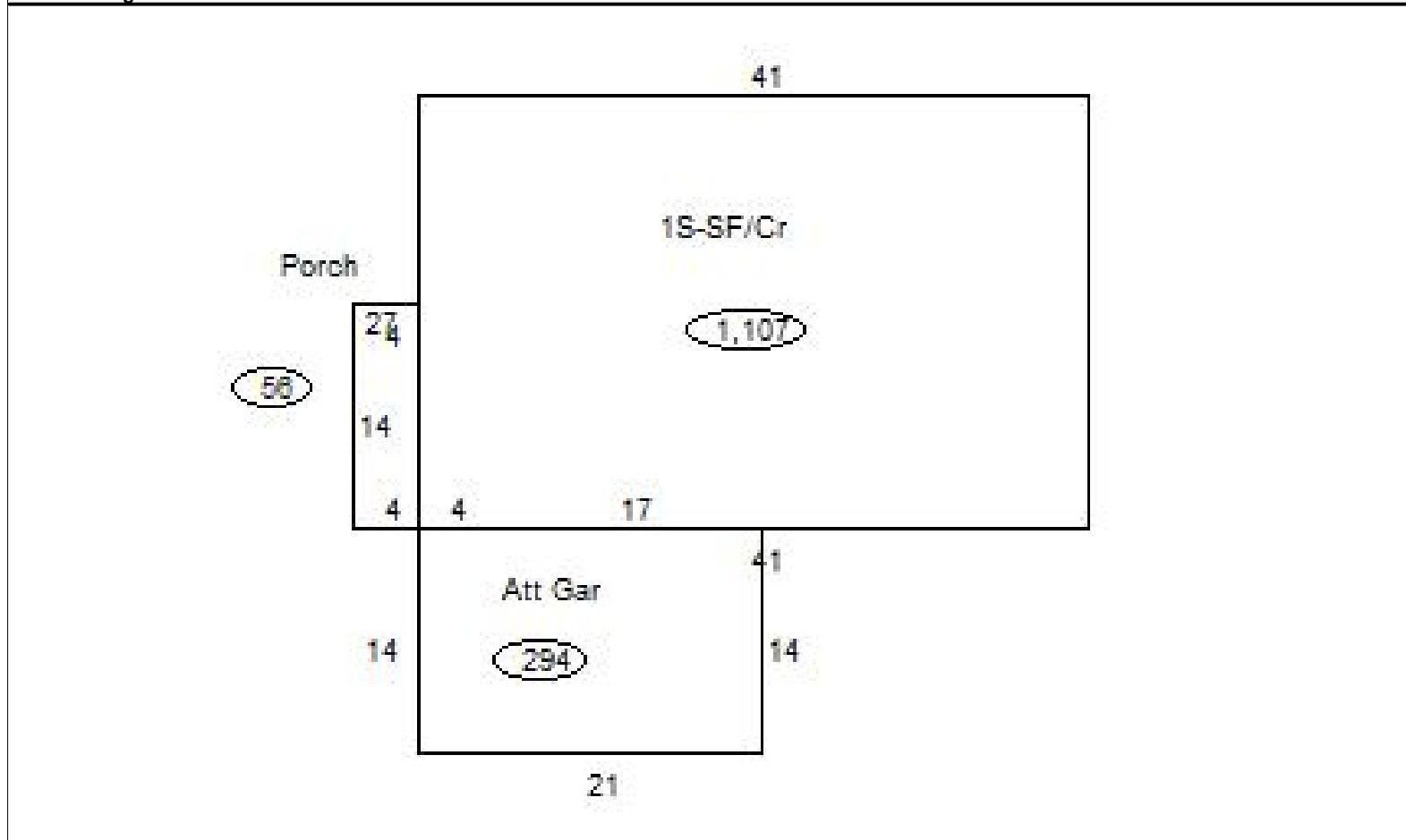

Sketch Vector Information

Sequence	Code	Type	Built Over	Scale	Section Label	Base Area	Multiplier	Total Area
1	M	RSPC		20	Porch	56	1.000	56
2	G	1		20	Att Gar	294	1.000	294
3	R	1	Crawl	20	1S-SF/Cr	1,107	1.000	1,107
Total Building Area						1,107		1,107



Harper

Assessment Property Record Card for Tax Year 2026

Data provided by SHAYLYN WEDER County Assessor

Date 02/06/2026
 Time 07:21:48
 Page 4

300006404

Outbuildings/Site Improvements

Building Image	Code	Description	Dimensions	Floor	Roofing	Total Units	
	CPDT	Carport - Detached	12x24x8		Formed Metal	288	
	Qual	3	Cond 3	Year 1995	Eff Age 31		
	Valuation Summary		Modifier Total	RCN	Depr (80% Phys/ % Func)	RCNLD	
	Base Cost (7.94 x 288)		2,287		2,287	1,830	457
	UTIL	Utility Building	25x40x10		Formed Metal	1,000	
	Qual	3	Cond 3	Year 1990	Eff Age 36		
	Valuation Summary		Modifier Total	RCN	Depr (62% Phys/ % Func)	RCNLD	
	Base Cost (27.14 x 1,000)		27,140		27,140	16,827	10,313
	PACN	Paving - Concrete / DRIVEWAY	35x12x0			420	
	Qual	3	Cond 3	Year 1985	Eff Age 41		
	Valuation Summary		Modifier Total	RCN	Depr (80% Phys/ % Func)	RCNLD	
	Base Cost (4.17 x 420)		1,751		1,751	1,401	350
	SHDS	Yard Shed - Metal	10x10x6		Galvanized Metal	100	
	Qual	3	Cond 3	Year 1985	Eff Age 41		
	Valuation Summary		Modifier Total	RCN	Depr (80% Phys/ % Func)	RCNLD	
	Base Cost (22.53 x 100)		2,253		2,253	1,802	451