



Harper

Assessment Property Record Card for Tax Year 2026

Data provided by SHAYLYN WEDER County Assessor

Date 02/06/2026
 Time 07:22:42
 Page 1

Assessment Data					Primary Image																																																																																																																				
Account 300006470 Parcel ID 2120-00-001-005-0-001-00 Cadastral ID 2120-001-005-00-0-001-00 Property Type REAL - Real Property Property Class UR VI Area 4 Tax Area 202 - 1T-LAVERNE-C Name ID 25462 HICKMON, ROBERT & MARY LOU REV TRUST 12501 CARRIAGE WAY OKLAHOMA CITY OK 73142- Parcel Location Situs 00615 SW FIRST ST Subdivision PARKVIEW ADDN Lot/Block 0005 / 0001 Parcel Size 2 - Lots Sec/Twn/Rng / / / Neighborhood 200200 - SHUMANS\PARKWEID School District 1-LAVERNE - 1-LAVERNE																																																																																																																									
Legal Description Lat/Long: 36.70588112 -99.89265873 PARKVIEW ADD BLOCK 1 LOTS W2 OF 5; ALL 6 BOOK 779 PAGE 203 QCD																																																																																																																									
Exemptions <table border="1"> <thead> <tr> <th>Code</th> <th>Type</th> <th>Active</th> <th>Maximum</th> <th>Exemption</th> </tr> </thead> <tbody> <tr> <td>H</td> <td>Homestead</td> <td>No</td> <td>1,000</td> <td></td> </tr> </tbody> </table>					Code	Type	Active	Maximum	Exemption	H	Homestead	No	1,000		Building Permits <table border="1"> <thead> <tr> <th>Number</th> <th>Description</th> <th>Opened</th> <th>Closed</th> <th>Amount</th> </tr> </thead> <tbody> <tr> <td></td> <td></td> <td></td> <td></td> <td></td> </tr> </tbody> </table>					Number	Description	Opened	Closed	Amount																																																																																																	
Code	Type	Active	Maximum	Exemption																																																																																																																					
H	Homestead	No	1,000																																																																																																																						
Number	Description	Opened	Closed	Amount																																																																																																																					
Parcel Valuation <table border="1"> <thead> <tr> <th>Source</th> <th>REAL</th> <th>Fair Cash</th> <th>Capped</th> <th>Asmnt Level</th> <th>Assessed</th> <th>Levy Rate</th> <th>67.190</th> <th>Current Tax</th> </tr> </thead> <tbody> <tr> <td>Remove Cap</td> <td></td> <td>4,725</td> <td>4,140</td> <td>12%</td> <td>497</td> <td>Assessed</td> <td>7,574</td> <td>508.90</td> </tr> <tr> <td>Year Frozen</td> <td></td> <td>Improvements</td> <td>66,690</td> <td>58,970</td> <td>7,077</td> <td>Penalty</td> <td>0</td> <td></td> </tr> <tr> <td>Uncapped Value</td> <td>0</td> <td>Mobile Home</td> <td>0</td> <td>0</td> <td>0</td> <td>Exemption</td> <td>0</td> <td>0.00</td> </tr> <tr> <td>TIF Project ID</td> <td>0</td> <td>Total Value</td> <td>71,415</td> <td>63,110</td> <td>7,574</td> <td>Total Taxable</td> <td>7,574</td> <td>509.00</td> </tr> </tbody> </table>					Source	REAL	Fair Cash	Capped	Asmnt Level	Assessed	Levy Rate	67.190	Current Tax	Remove Cap		4,725	4,140	12%	497	Assessed	7,574	508.90	Year Frozen		Improvements	66,690	58,970	7,077	Penalty	0		Uncapped Value	0	Mobile Home	0	0	0	Exemption	0	0.00	TIF Project ID	0	Total Value	71,415	63,110	7,574	Total Taxable	7,574	509.00	Sale History <table border="1"> <thead> <tr> <th>Bk/Pg</th> <th>Grantor</th> <th>Date</th> <th>Price</th> <th>Code</th> </tr> </thead> <tbody> <tr> <td>779/203</td> <td>HICKMON, ROBERT LELAND</td> <td>12/18/2023</td> <td></td> <td>04</td> </tr> </tbody> </table>					Bk/Pg	Grantor	Date	Price	Code	779/203	HICKMON, ROBERT LELAND	12/18/2023		04																																																									
Source	REAL	Fair Cash	Capped	Asmnt Level	Assessed	Levy Rate	67.190	Current Tax																																																																																																																	
Remove Cap		4,725	4,140	12%	497	Assessed	7,574	508.90																																																																																																																	
Year Frozen		Improvements	66,690	58,970	7,077	Penalty	0																																																																																																																		
Uncapped Value	0	Mobile Home	0	0	0	Exemption	0	0.00																																																																																																																	
TIF Project ID	0	Total Value	71,415	63,110	7,574	Total Taxable	7,574	509.00																																																																																																																	
Bk/Pg	Grantor	Date	Price	Code																																																																																																																					
779/203	HICKMON, ROBERT LELAND	12/18/2023		04																																																																																																																					
Assessment History <table border="1"> <thead> <tr> <th>Tax Year</th> <th>Statement Number</th> <th>Billed Owner</th> <th>Tax Area</th> <th>Total Value</th> <th>Exemptions</th> <th>Taxable Value</th> <th>Billed Tax</th> </tr> </thead> <tbody> <tr><td>2025</td><td>2025-300006470</td><td>HICKMON, ROBERT & MARY LOU REV TRUST</td><td>202</td><td>71,415</td><td>0</td><td>7,212</td><td>485.00</td></tr> <tr><td>2024</td><td>2024-300006470</td><td>HICKMON, ROBERT & MARY LOU REV TRUST</td><td>202</td><td>78,514</td><td>0</td><td>6,869</td><td>457.00</td></tr> <tr><td>2023</td><td>2023-300006470</td><td>HICKMON, ROBERT L. ETUX</td><td>202</td><td>73,371</td><td>1000</td><td>5,542</td><td>372.00</td></tr> <tr><td>2022</td><td>2022-300006470</td><td>HICKMON, ROBERT L. ETUX</td><td>202</td><td>70,668</td><td>1000</td><td>5,352</td><td>362.00</td></tr> <tr><td>2021</td><td>2021-300006470</td><td>HICKMON, ROBERT L. ETUX</td><td>202</td><td>70,668</td><td>1000</td><td>5,166</td><td>357.00</td></tr> <tr><td>2020</td><td>2020-300006470</td><td>HICKMON, ROBERT L. ETUX</td><td>202</td><td>70,668</td><td>1000</td><td>4,987</td><td>338.00</td></tr> <tr><td>2019</td><td>2019-0006470</td><td>HICKMON, ROBERT L. ETUX</td><td>202</td><td>70,668</td><td></td><td>4,813</td><td>287.00</td></tr> <tr><td>2018</td><td>2018-0006470</td><td>HICKMON, ROBERT L. ETUX</td><td>202</td><td>70,668</td><td></td><td>4,643</td><td>277.00</td></tr> <tr><td>2017</td><td>2017-0006470</td><td>HICKMON, ROBERT L. ETUX</td><td>202</td><td>67,197</td><td></td><td>4,479</td><td>267.00</td></tr> <tr><td>2016</td><td>2016-0006470</td><td>HICKMON, ROBERT L. ETUX</td><td>202</td><td>67,197</td><td></td><td>4,320</td><td>258.00</td></tr> <tr><td>2015</td><td>2015-0006470</td><td>HICKMON, ROBERT L. ETUX</td><td>202</td><td>69,006</td><td></td><td>4,165</td><td>249.00</td></tr> <tr><td>2014</td><td>2014-0006470</td><td>HICKMON, ROBERT L. ETUX</td><td>202</td><td>69,006</td><td></td><td>4,014</td><td>240.00</td></tr> <tr><td>2013</td><td>2013-0006470</td><td>HICKMON, ROBERT L. ETUX</td><td>202</td><td>82,111</td><td></td><td>3,868</td><td>231.00</td></tr> </tbody> </table>										Tax Year	Statement Number	Billed Owner	Tax Area	Total Value	Exemptions	Taxable Value	Billed Tax	2025	2025-300006470	HICKMON, ROBERT & MARY LOU REV TRUST	202	71,415	0	7,212	485.00	2024	2024-300006470	HICKMON, ROBERT & MARY LOU REV TRUST	202	78,514	0	6,869	457.00	2023	2023-300006470	HICKMON, ROBERT L. ETUX	202	73,371	1000	5,542	372.00	2022	2022-300006470	HICKMON, ROBERT L. ETUX	202	70,668	1000	5,352	362.00	2021	2021-300006470	HICKMON, ROBERT L. ETUX	202	70,668	1000	5,166	357.00	2020	2020-300006470	HICKMON, ROBERT L. ETUX	202	70,668	1000	4,987	338.00	2019	2019-0006470	HICKMON, ROBERT L. ETUX	202	70,668		4,813	287.00	2018	2018-0006470	HICKMON, ROBERT L. ETUX	202	70,668		4,643	277.00	2017	2017-0006470	HICKMON, ROBERT L. ETUX	202	67,197		4,479	267.00	2016	2016-0006470	HICKMON, ROBERT L. ETUX	202	67,197		4,320	258.00	2015	2015-0006470	HICKMON, ROBERT L. ETUX	202	69,006		4,165	249.00	2014	2014-0006470	HICKMON, ROBERT L. ETUX	202	69,006		4,014	240.00	2013	2013-0006470	HICKMON, ROBERT L. ETUX	202	82,111		3,868	231.00
Tax Year	Statement Number	Billed Owner	Tax Area	Total Value	Exemptions	Taxable Value	Billed Tax																																																																																																																		
2025	2025-300006470	HICKMON, ROBERT & MARY LOU REV TRUST	202	71,415	0	7,212	485.00																																																																																																																		
2024	2024-300006470	HICKMON, ROBERT & MARY LOU REV TRUST	202	78,514	0	6,869	457.00																																																																																																																		
2023	2023-300006470	HICKMON, ROBERT L. ETUX	202	73,371	1000	5,542	372.00																																																																																																																		
2022	2022-300006470	HICKMON, ROBERT L. ETUX	202	70,668	1000	5,352	362.00																																																																																																																		
2021	2021-300006470	HICKMON, ROBERT L. ETUX	202	70,668	1000	5,166	357.00																																																																																																																		
2020	2020-300006470	HICKMON, ROBERT L. ETUX	202	70,668	1000	4,987	338.00																																																																																																																		
2019	2019-0006470	HICKMON, ROBERT L. ETUX	202	70,668		4,813	287.00																																																																																																																		
2018	2018-0006470	HICKMON, ROBERT L. ETUX	202	70,668		4,643	277.00																																																																																																																		
2017	2017-0006470	HICKMON, ROBERT L. ETUX	202	67,197		4,479	267.00																																																																																																																		
2016	2016-0006470	HICKMON, ROBERT L. ETUX	202	67,197		4,320	258.00																																																																																																																		
2015	2015-0006470	HICKMON, ROBERT L. ETUX	202	69,006		4,165	249.00																																																																																																																		
2014	2014-0006470	HICKMON, ROBERT L. ETUX	202	69,006		4,014	240.00																																																																																																																		
2013	2013-0006470	HICKMON, ROBERT L. ETUX	202	82,111		3,868	231.00																																																																																																																		



Harper

Assessment Property Record Card for Tax Year 2026

Data provided by SHAYLYN WEDER County Assessor

Date 02/06/2026
 Time 07:22:42
 Page 2

Lot Data	Square-Foot - SHUMANS\PARK\WEID	Primary Image
Lot Size	75 x 140	<p>2120-00-001-005-0-001-00 6470 04/12/22</p>
Lot Count		
Units Buildable	4725	
Non-Ag Acres		
Topography		
Street Access		
Utilities		
Amenities		
Method	Square-Foot	
Base Lot Value	10,500.00 x .45 = 4,725	
Factor Value		
Adjustments		
Lot Value	4,725	

Residential Data	
Type	1 Single Family Residence
Condition	3 - Average
Quality	3 - Average
Architecture	TRAD TRADITIONAL
Style	100% One Story
Exterior Wall	75% Frame, Siding, Wood 25% Veneer, Masonry
Base/Total Area	1,860 / 1,860
Style	100% One Story
HVAC	100% Warmed & Cooled Air
Roof Cover	1 Composition Shingle
Area on Slab	0
Fixture/RghIn	5 /
Bed/F/H Bath	2 / 1.0 /
Basement Area	
Garage Type	576 Detached Garage - Unfinished
Remodel	
Year/Eff Age	1958 / 68

1 HOUSE 4/14/2022

GRM Approach	
GRM Code	
Gross Rent	
Indicated Value	

Multiple Regression	
MRA Code	
Adusted R	
Indicated Value	

Direct Comparables	
Selection Model	DEFAULT DEFAULT SELECTION MODEL
Adjustment Model	DEFAULT DEFAULT ADJUSTMENTS TABLE
Comparables	
Indicated Value	

Cost Approach		Manual :	
Base Cost	81.71	Total Misc Impr	+ 647
Roofing Adj	+ 3.79	Garage Cost	+ 19,775
Subfloor Adj	+ 0.00	Total RCN	= 205,864
Heat/Cool Adj	+ 10.77	Depreciation (68%)	- 139,988
Plumbing Adj	+ 3.43	Lump Sums	+ 0
Basement Adj	+ 0.00	RCNLD	= 65,876
Adj Base Cost	= 99.70	Lot Value	+ 4,725
Total Area	x 1,860	Indicated Value	= 70,601
Adjusted Cost	= 185,442	Value Per SqFt	37.96

Value Reconciliation			
Selected Approach	Cost Approach		
Improvements	65,876		
Lot Value	4,725		
Indicated Value	70,601	37.96	Per SqFt
Agland Value			
Site Improvements	1,224		
Total Value	71,825	38.62	Total Value Per SqFt

Miscellaneous Improvements								
Code	Description	Sketch ID	Size	Year	Units	Unit Cost	Depr	Value
RSPC	Raised Slab Porch - Covered	6317	4x4		16	40.46		647



Harper

Assessment Property Record Card for Tax Year 2026

Data provided by SHAYLYN WEDER County Assessor

Date 02/06/2026

Time 07:22:42

Page 3

Sketch Image

300006470

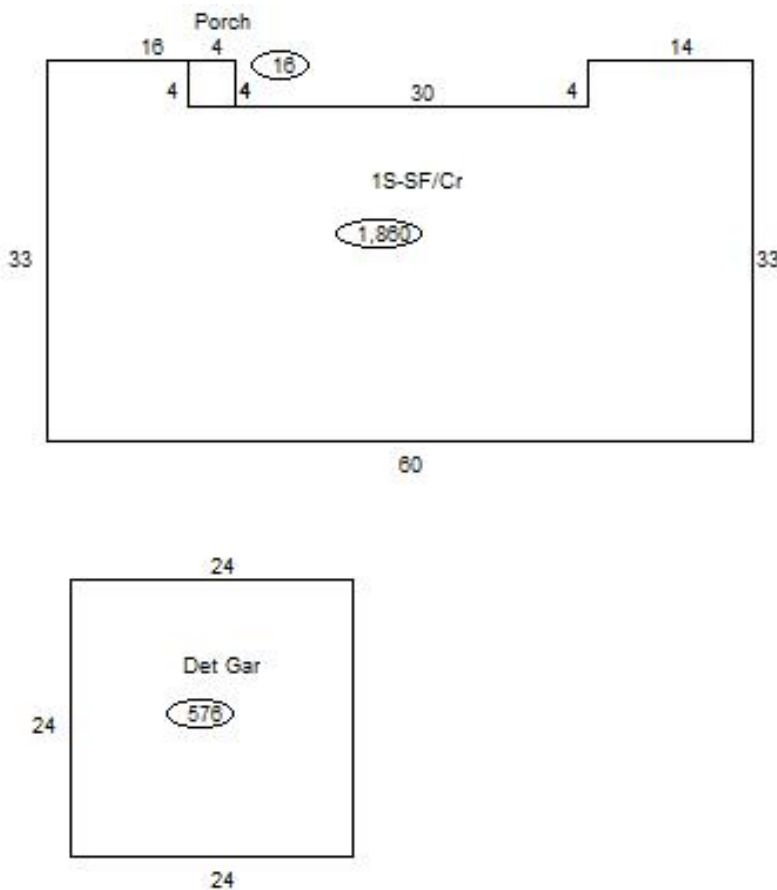

Sketch Vector Information

Sequence	Code	Type	Built Over	Scale	Section Label	Base Area	Multiplier	Total Area
1	R	1	Crawl	20	1S-SF/Cr	1,860	1.000	1,860
2	M	RSPC		20	Porch	16	1.000	16
3	G	2		20	Det Gar	576	1.000	576
Total Building Area						1,860		1,860



Harper

Assessment Property Record Card for Tax Year 2026

Data provided by SHAYLYN WEDER County Assessor

Date 02/06/2026
Time 07:22:42
Page 4

300006470

Outbuildings/Site Improvements

Building Image	Code	Description	Dimensions	Floor	Roofing	Total Units
	PACN	Paving - Concrete Sidewalk	41x3x0			123
	Qual 3	Cond 3	Year 1970	Eff Age 56		
			0			
	Valuation Summary		Modifier Total	RCN	Depr (80% Phys/ % Func)	RCNLD
	Base Cost (6.74 x 123)		829		829	663
						166
	PACN	Paving - Concrete sidewalk	27x3x0			81
	Qual 3	Cond 3	Year 1960	Eff Age 66		
			0			
			0			
	Valuation Summary		Modifier Total	RCN	Depr (80% Phys/ % Func)	RCNLD
	Base Cost (7.34 x 81)		595		595	476
						119
	PACN	Paving - Concrete Garage	24x3x0			72
	Qual 3	Cond 3	Year 1960	Eff Age 66		
			0			
			0			
	Valuation Summary		Modifier Total	RCN	Depr (80% Phys/ % Func)	RCNLD
	Base Cost (7.47 x 72)		538		538	430
						108
	PACN	Paving - Concrete Yard	20x20x0			400
	Qual 3	Cond 3	Year 1960	Eff Age 66		
			0			
			0			
			0			
	Valuation Summary		Modifier Total	RCN	Depr (80% Phys/ % Func)	RCNLD
	Base Cost (4.17 x 400)		1,668		1,668	1,334
						334
	PACN	Paving - Concrete Driveway	40x15x0			600
	Qual 3	Cond 3	Year 1960	Eff Age 66		
			0			
			0			
	Valuation Summary		Modifier Total	RCN	Depr (80% Phys/ % Func)	RCNLD
	Base Cost (4.14 x 600)		2,484		2,484	1,987
						497