



Harper

Assessment Property Record Card for Tax Year 2026

Data provided by SHAYLYN WEDER County Assessor

Date 02/06/2026
 Time 07:23:27
 Page 1

Assessment Data					Primary Image																																																																																																																				
Account 300006521 Parcel ID 2142-00-001-009-0-001-00 Cadastral ID 2142-001-009-00-0-001-00 Property Type REAL - Real Property Property Class UR VI Area 3 Tax Area 202 - 1T-LAVERNE-C Name ID 15465 WETZEL, TIMOTHY ALAN & AMYJO KRISTEN WETZEL 821 KLINGER ST LAVERNE OK 73848-0000 Parcel Location Situs 00821 KLINGER Subdivision SHUMAN'S 2ND ADDN Lot/Block 0009 / 0001 Parcel Size 1 - Lots Sec/Twn/Rng / / / Neighborhood 200200 - SHUMANS\PARKWEID School District 1-LAVERN - 1-LAVERNE					<p>FRONT OF HOUSE 4/30/2025</p>																																																																																																																				
Legal Description Lat/Long: 36.70778475 -99.90190665 SHUMAN'S 2ND ADD BLOCK 1 LOT 9																																																																																																																									
Exemptions					Building Permits																																																																																																																				
<table border="1"> <thead> <tr> <th>Code</th> <th>Type</th> <th>Active</th> <th>Maximum</th> <th>Exemption</th> </tr> </thead> <tbody> <tr> <td></td> <td></td> <td></td> <td></td> <td></td> </tr> </tbody> </table>					Code	Type	Active	Maximum	Exemption						<table border="1"> <thead> <tr> <th>Number</th> <th>Description</th> <th>Opened</th> <th>Closed</th> <th>Amount</th> </tr> </thead> <tbody> <tr> <td></td> <td></td> <td></td> <td></td> <td></td> </tr> </tbody> </table>					Number	Description	Opened	Closed	Amount																																																																																																	
Code	Type	Active	Maximum	Exemption																																																																																																																					
Number	Description	Opened	Closed	Amount																																																																																																																					
<table border="1"> <thead> <tr> <th>Code</th> <th>Type</th> <th>Active</th> <th>Maximum</th> <th>Exemption</th> </tr> </thead> <tbody> <tr> <td></td> <td></td> <td></td> <td></td> <td></td> </tr> </tbody> </table>					Code	Type	Active	Maximum	Exemption						Sale History <table border="1"> <thead> <tr> <th>Bk/Pg</th> <th>Grantor</th> <th>Date</th> <th>Price</th> <th>Code</th> </tr> </thead> <tbody> <tr> <td>720/632</td> <td>RIGGS, ADAM A. AND</td> <td>09/21/2016</td> <td>35,000</td> <td>Q</td> </tr> <tr> <td>619/349</td> <td>LAVERNE CHURCH OF CHRIST</td> <td>11/15/2006</td> <td>30,000</td> <td>PQ</td> </tr> </tbody> </table>					Bk/Pg	Grantor	Date	Price	Code	720/632	RIGGS, ADAM A. AND	09/21/2016	35,000	Q	619/349	LAVERNE CHURCH OF CHRIST	11/15/2006	30,000	PQ																																																																																							
Code	Type	Active	Maximum	Exemption																																																																																																																					
Bk/Pg	Grantor	Date	Price	Code																																																																																																																					
720/632	RIGGS, ADAM A. AND	09/21/2016	35,000	Q																																																																																																																					
619/349	LAVERNE CHURCH OF CHRIST	11/15/2006	30,000	PQ																																																																																																																					
Parcel Valuation <table border="1"> <thead> <tr> <th>Source</th> <th>REAL</th> <th>Fair Cash</th> <th>Capped</th> <th>Asmnt Level</th> <th>Assessed</th> <th>Levy Rate</th> <th>67.190</th> <th>Current Tax</th> </tr> </thead> <tbody> <tr> <td>Remove Cap</td> <td></td> <td>Land Value 3,949</td> <td>3,949</td> <td>12%</td> <td>474</td> <td>Assessed</td> <td>6,515</td> <td>437.74</td> </tr> <tr> <td>Year Frozen</td> <td></td> <td>Improvements 66,987</td> <td>50,344</td> <td></td> <td>6,041</td> <td>Penalty</td> <td>0</td> <td></td> </tr> <tr> <td>Uncapped Value</td> <td>0</td> <td>Mobile Home 0</td> <td>0</td> <td></td> <td>0</td> <td>Exemption</td> <td>0</td> <td>0.00</td> </tr> <tr> <td>TIF Project ID</td> <td>0</td> <td>Total Value 70,936</td> <td>54,293</td> <td></td> <td>6,515</td> <td>Total Taxable</td> <td>6,515</td> <td>438.00</td> </tr> </tbody> </table>										Source	REAL	Fair Cash	Capped	Asmnt Level	Assessed	Levy Rate	67.190	Current Tax	Remove Cap		Land Value 3,949	3,949	12%	474	Assessed	6,515	437.74	Year Frozen		Improvements 66,987	50,344		6,041	Penalty	0		Uncapped Value	0	Mobile Home 0	0		0	Exemption	0	0.00	TIF Project ID	0	Total Value 70,936	54,293		6,515	Total Taxable	6,515	438.00																																																																			
Source	REAL	Fair Cash	Capped	Asmnt Level	Assessed	Levy Rate	67.190	Current Tax																																																																																																																	
Remove Cap		Land Value 3,949	3,949	12%	474	Assessed	6,515	437.74																																																																																																																	
Year Frozen		Improvements 66,987	50,344		6,041	Penalty	0																																																																																																																		
Uncapped Value	0	Mobile Home 0	0		0	Exemption	0	0.00																																																																																																																	
TIF Project ID	0	Total Value 70,936	54,293		6,515	Total Taxable	6,515	438.00																																																																																																																	
Assessment History <table border="1"> <thead> <tr> <th>Tax Year</th> <th>Statement Number</th> <th>Billed Owner</th> <th>Tax Area</th> <th>Total Value</th> <th>Exemptions</th> <th>Taxable Value</th> <th>Billed Tax</th> </tr> </thead> <tbody> <tr><td>2025</td><td>2025-300006521</td><td>WETZEL, TIMOTHY ALAN &</td><td>202</td><td>70,936</td><td>0</td><td>6,205</td><td>417.00</td></tr> <tr><td>2024</td><td>2024-300006521</td><td>WETZEL, TIMOTHY ALAN &</td><td>202</td><td>76,880</td><td>0</td><td>5,910</td><td>393.00</td></tr> <tr><td>2023</td><td>2023-300006521</td><td>WETZEL, TIMOTHY ALAN &</td><td>202</td><td>70,074</td><td>0</td><td>5,628</td><td>378.00</td></tr> <tr><td>2022</td><td>2022-300006521</td><td>WETZEL, TIMOTHY ALAN &</td><td>202</td><td>59,360</td><td>0</td><td>5,360</td><td>363.00</td></tr> <tr><td>2021</td><td>2021-300006521</td><td>WETZEL, TIMOTHY ALAN &</td><td>202</td><td>56,482</td><td>0</td><td>5,105</td><td>352.00</td></tr> <tr><td>2020</td><td>2020-300006521</td><td>WETZEL, TIMOTHY ALAN &</td><td>202</td><td>56,482</td><td>0</td><td>4,862</td><td>329.00</td></tr> <tr><td>2019</td><td>2019-0006521</td><td>WETZEL, TIMOTHY ALAN &</td><td>202</td><td>56,482</td><td></td><td>4,631</td><td>276.00</td></tr> <tr><td>2018</td><td>2018-0006521</td><td>WETZEL, TIMOTHY ALAN &</td><td>202</td><td>57,727</td><td></td><td>4,410</td><td>263.00</td></tr> <tr><td>2017</td><td>2017-0006521</td><td>WETZEL, TIMOTHY ALAN &</td><td>202</td><td>35,000</td><td></td><td>4,200</td><td>251.00</td></tr> <tr><td>2016</td><td>2016-0006521</td><td>WETZEL, TIMOTHY ALAN &</td><td>202</td><td>58,447</td><td></td><td>5,065</td><td>302.00</td></tr> <tr><td>2015</td><td>2015-0006521</td><td>RIGGS, ADAM A. AND</td><td>202</td><td>61,135</td><td></td><td>4,824</td><td>288.00</td></tr> <tr><td>2014</td><td>2014-0006521</td><td>RIGGS, ADAM A. AND</td><td>202</td><td>62,347</td><td></td><td>4,595</td><td>274.00</td></tr> <tr><td>2013</td><td>2013-0006521</td><td>RIGGS, ADAM A. AND</td><td>202</td><td>73,038</td><td></td><td>4,376</td><td>261.00</td></tr> </tbody> </table>										Tax Year	Statement Number	Billed Owner	Tax Area	Total Value	Exemptions	Taxable Value	Billed Tax	2025	2025-300006521	WETZEL, TIMOTHY ALAN &	202	70,936	0	6,205	417.00	2024	2024-300006521	WETZEL, TIMOTHY ALAN &	202	76,880	0	5,910	393.00	2023	2023-300006521	WETZEL, TIMOTHY ALAN &	202	70,074	0	5,628	378.00	2022	2022-300006521	WETZEL, TIMOTHY ALAN &	202	59,360	0	5,360	363.00	2021	2021-300006521	WETZEL, TIMOTHY ALAN &	202	56,482	0	5,105	352.00	2020	2020-300006521	WETZEL, TIMOTHY ALAN &	202	56,482	0	4,862	329.00	2019	2019-0006521	WETZEL, TIMOTHY ALAN &	202	56,482		4,631	276.00	2018	2018-0006521	WETZEL, TIMOTHY ALAN &	202	57,727		4,410	263.00	2017	2017-0006521	WETZEL, TIMOTHY ALAN &	202	35,000		4,200	251.00	2016	2016-0006521	WETZEL, TIMOTHY ALAN &	202	58,447		5,065	302.00	2015	2015-0006521	RIGGS, ADAM A. AND	202	61,135		4,824	288.00	2014	2014-0006521	RIGGS, ADAM A. AND	202	62,347		4,595	274.00	2013	2013-0006521	RIGGS, ADAM A. AND	202	73,038		4,376	261.00
Tax Year	Statement Number	Billed Owner	Tax Area	Total Value	Exemptions	Taxable Value	Billed Tax																																																																																																																		
2025	2025-300006521	WETZEL, TIMOTHY ALAN &	202	70,936	0	6,205	417.00																																																																																																																		
2024	2024-300006521	WETZEL, TIMOTHY ALAN &	202	76,880	0	5,910	393.00																																																																																																																		
2023	2023-300006521	WETZEL, TIMOTHY ALAN &	202	70,074	0	5,628	378.00																																																																																																																		
2022	2022-300006521	WETZEL, TIMOTHY ALAN &	202	59,360	0	5,360	363.00																																																																																																																		
2021	2021-300006521	WETZEL, TIMOTHY ALAN &	202	56,482	0	5,105	352.00																																																																																																																		
2020	2020-300006521	WETZEL, TIMOTHY ALAN &	202	56,482	0	4,862	329.00																																																																																																																		
2019	2019-0006521	WETZEL, TIMOTHY ALAN &	202	56,482		4,631	276.00																																																																																																																		
2018	2018-0006521	WETZEL, TIMOTHY ALAN &	202	57,727		4,410	263.00																																																																																																																		
2017	2017-0006521	WETZEL, TIMOTHY ALAN &	202	35,000		4,200	251.00																																																																																																																		
2016	2016-0006521	WETZEL, TIMOTHY ALAN &	202	58,447		5,065	302.00																																																																																																																		
2015	2015-0006521	RIGGS, ADAM A. AND	202	61,135		4,824	288.00																																																																																																																		
2014	2014-0006521	RIGGS, ADAM A. AND	202	62,347		4,595	274.00																																																																																																																		
2013	2013-0006521	RIGGS, ADAM A. AND	202	73,038		4,376	261.00																																																																																																																		



Harper

Assessment Property Record Card for Tax Year 2026

Data provided by SHAYLYN WEDER County Assessor

Date 02/06/2026
 Time 07:23:27
 Page 2

Lot Data		Square-Foot - SHUMANS\PARK\WEID	
Lot Size	65	x	135
Lot Count			
Units Buildable	3949		
Non-Ag Acres			
Topography			
Street Access			
Utilities			
Amenities			
Method	Square-Foot		
Base Lot Value	8,775.00 x .45 = 3,949		
Factor Value			
Adjustments			
Lot Value	3,949		



Residential Data	
Type	1 Single Family Residence
Condition	3 - Average
Quality	3 - Average
Architecture	TRAD TRADITIONAL
Style	100% One Story
Exterior Wall	88% Frame, Siding, Vinyl 12% Veneer, Masonry
Base/Total Area	1,372 / 1,372
Style	100% One Story
HVAC	2 Wall Air Conditioners (Count)
Roof Cover	4 Metal, Preformed
Area on Slab	0
Fixture/RghIn	5 /
Bed/F/H Bath	3 / 1.0 /
Basement Area	
Garage Type	
Remodel	REFRESH -
Year/Eff Age	1975 / 46

GRM Approach

GRM Code	
Gross Rent	
Indicated Value	

Multiple Regression

MRA Code	
Adjusted R	
Indicated Value	

Direct Comparables

Selection Model	DEFAULT	DEFAULT SELECTION MODEL
Adjustment Model	DEFAULT	DEFAULT ADJUSTMENTS TABLE
Comparables		
Indicated Value		

Value Reconciliation

Selected Approach	Cost Approach		
Improvements	65,148		
Lot Value	3,949		
Indicated Value	69,097	50.36	Per SqFt
Agland Value			
Site Improvements	1,828		
Total Value	70,925	51.69	Total Value Per SqFt

Cost Approach		Manual :	
Base Cost	86.09	Total Misc Impr	+ 1,930
Roofing Adj	+ 4.76	Garage Cost	+
Subfloor Adj	+ 0.00	Total RCN	= 132,956
Heat/Cool Adj	+ 0.00	Depreciation (51%)	- 67,808
Plumbing Adj	+ 4.65	Lump Sums	+ 0
Basement Adj	+ 0.00	RCNLD	= 65,148
Adj Base Cost	= 95.50	Lot Value	+ 3,949
Total Area	x 1,372	Indicated Value	= 69,097
Adjusted Cost	= 131,026	Value Per SqFt	50.36

Miscellaneous Improvements

Code	Description	Sketch ID	Size	Year	Units	Unit Cost	Depr	Value
PRCH	Slab Porch - Covered	6522	17x5		85	22.71		1,930



Harper

Assessment Property Record Card for Tax Year 2026

Data provided by SHAYLYN WEDER County Assessor

Date 02/06/2026
Time 07:23:27
Page 3

Sketch Image

300006521

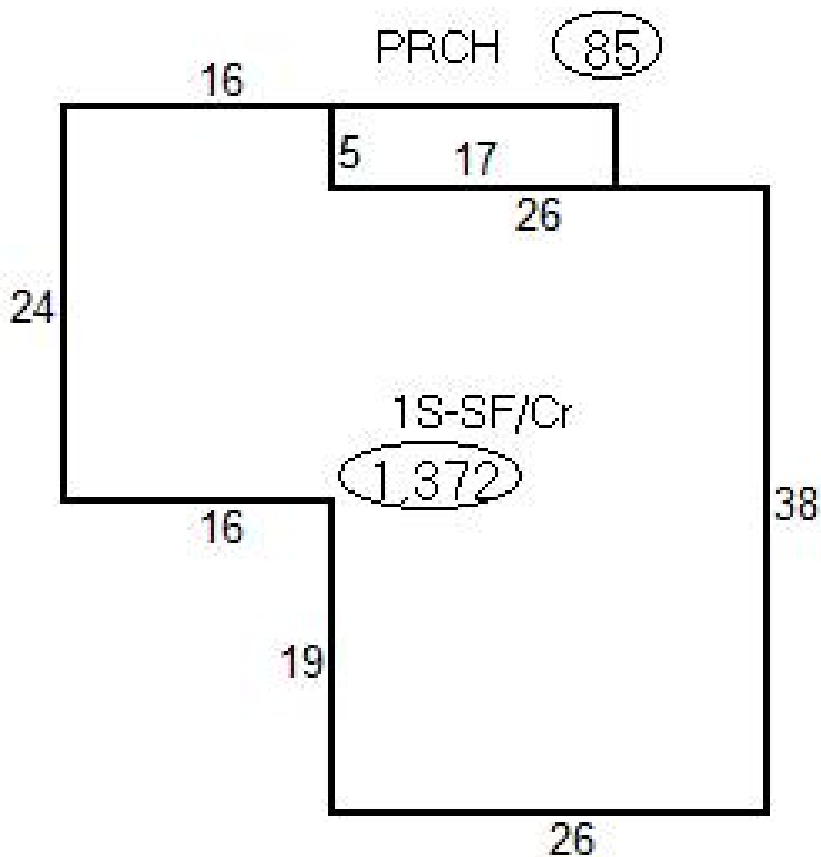

Sketch Vector Information

Sequence	Code	Type	Built Over	Scale	Section Label	Base Area	Multiplier	Total Area
1	R	1	Crawl	20	1S-SF/Cr	1,372	1.000	1,372
2	M	PRCH		20	PRCH	85	1.000	85
Total Building Area						1,372		1,372



Harper



Assessment Property Record Card for Tax Year 2026

Data provided by SHAYLYN WEDER County Assessor

Date 02/06/2026
Time 07:23:27
Page 4

300006521

Outbuildings/Site Improvements

Building Image	Code	Description	Dimensions	Floor	Roofing	Total Units
	SHDS	Yard Shed - Metal	12x10x0			120
	Qual	3	Cond 3	Year 2007	Eff Age 19	
	Valuation Summary		Modifier Total	RCN	Depr (57% Phys/ 0% Func)	RCNLD
	Base Cost (22.67 x 120)	2,720		2,720	1,550	1,170
	PACN	Paving - Concrete DRIVEWAY	40x20x0			800
	Qual	3	Cond 3	Year 1975	Eff Age 51	
	Valuation Summary		Modifier Total	RCN	Depr (80% Phys/ % Func)	RCNLD
	Base Cost (4.11 x 800)	3,288		3,288	2,630	658