



# Harper

## Assessment Property Record Card for Tax Year 2026

Data provided by SHAYLYN WEDER County Assessor

Date 02/06/2026  
 Time 07:24:21  
 Page 1

Assessment Data				Primary Image																																																																																																																					
<b>Account</b> 300006573 <b>Parcel ID</b> 2150-00-001-018-0-001-00 <b>Cadastral ID</b> 2150-001-018-00-0-001-00 <b>Property Type</b> REAL - Real Property <b>Property Class</b> UR VI Area 4 <b>Tax Area</b> 202 - 1T-LAVERNE-C <b>Name ID</b> 25476 QUINO, HECTOR VENTURA & ANASTACIA CAC SICAJAU  PO BOX 642 LAVERNE OK 73848-  <b>Parcel Location</b> <b>Situs</b> 00107 EIGHTH ST <b>Subdivision</b> SOUTH PARK ADDN <b>Lot/Block</b> 0018 / 0001 <b>Parcel Size</b> 1 - Lots <b>Sec/Twn/Rng</b> / / / <b>Neighborhood</b> 200300 - SOUTHPARK <b>School District</b> 1-LAVERN - 1-LAVERNE																																																																																																																									
				2150-00-001-018-0-001-00 6573 04/12/22  1 HOUSE <span style="float: right;">4/14/2022</span>																																																																																																																					
Legal Description				Building Permits																																																																																																																					
SOUTH PARK AD BLOCK 1 LOT 18 BOOK 787 PAGE 195				<table border="1"> <thead> <tr> <th>Number</th> <th>Description</th> <th>Opened</th> <th>Closed</th> <th>Amount</th> </tr> </thead> <tbody> <tr> <td colspan="5"> </td> </tr> </tbody> </table>						Number	Description	Opened	Closed	Amount																																																																																																											
Number	Description	Opened	Closed	Amount																																																																																																																					
Exemptions				Sale History																																																																																																																					
<table border="1"> <thead> <tr> <th>Code</th> <th>Type</th> <th>Active</th> <th>Maximum</th> <th>Exemption</th> </tr> </thead> <tbody> <tr> <td colspan="5"> </td> </tr> </tbody> </table>				Code	Type	Active	Maximum	Exemption						<table border="1"> <thead> <tr> <th>Bk/Pg</th> <th>Grantor</th> <th>Date</th> <th>Price</th> <th>Code</th> </tr> </thead> <tbody> <tr> <td>787/195</td> <td>CURTIS, BRANDON L.</td> <td>02/04/2025</td> <td>120,000</td> <td>Q</td> </tr> <tr> <td>711/618</td> <td>MERKERISON, PETE W.</td> <td>09/24/2015</td> <td>24,000</td> <td>10</td> </tr> <tr> <td>603/470</td> <td>CARLISLE, ALLETTA</td> <td>06/08/2005</td> <td>62,000</td> <td>V</td> </tr> <tr> <td>546/67</td> <td>JUHL, ALAN D., ETUX</td> <td>10/19/1998</td> <td>39,000</td> <td>PQ</td> </tr> <tr> <td>498/718</td> <td>SPARKS, J. BEN, ETUX</td> <td>08/31/1994</td> <td>43,000</td> <td>QV</td> </tr> </tbody> </table>						Bk/Pg	Grantor	Date	Price	Code	787/195	CURTIS, BRANDON L.	02/04/2025	120,000	Q	711/618	MERKERISON, PETE W.	09/24/2015	24,000	10	603/470	CARLISLE, ALLETTA	06/08/2005	62,000	V	546/67	JUHL, ALAN D., ETUX	10/19/1998	39,000	PQ	498/718	SPARKS, J. BEN, ETUX	08/31/1994	43,000	QV																																																																								
Code	Type	Active	Maximum	Exemption																																																																																																																					
Bk/Pg	Grantor	Date	Price	Code																																																																																																																					
787/195	CURTIS, BRANDON L.	02/04/2025	120,000	Q																																																																																																																					
711/618	MERKERISON, PETE W.	09/24/2015	24,000	10																																																																																																																					
603/470	CARLISLE, ALLETTA	06/08/2005	62,000	V																																																																																																																					
546/67	JUHL, ALAN D., ETUX	10/19/1998	39,000	PQ																																																																																																																					
498/718	SPARKS, J. BEN, ETUX	08/31/1994	43,000	QV																																																																																																																					
Parcel Valuation																																																																																																																									
<table border="1"> <thead> <tr> <th>Source</th> <th>REAL</th> </tr> </thead> <tbody> <tr> <td>Remove Cap</td> <td>2026</td> </tr> <tr> <td>Year Frozen</td> <td></td> </tr> <tr> <td>Uncapped Value</td> <td>0</td> </tr> <tr> <td>TIF Project ID</td> <td>0</td> </tr> </tbody> </table>		Source	REAL	Remove Cap	2026	Year Frozen		Uncapped Value	0	TIF Project ID	0	<table border="1"> <thead> <tr> <th>Fair Cash</th> <th>Capped</th> <th>Asmnt Level</th> <th>Assessed</th> </tr> </thead> <tbody> <tr> <td>Land Value</td> <td>4,500</td> <td>4,500</td> <td>540</td> </tr> <tr> <td>Improvements</td> <td>85,021</td> <td>85,021</td> <td>10,202</td> </tr> <tr> <td>Mobile Home</td> <td>0</td> <td>0</td> <td>0</td> </tr> <tr> <td>Total Value</td> <td>89,521</td> <td>89,521</td> <td>10,742</td> </tr> </tbody> </table>			Fair Cash	Capped	Asmnt Level	Assessed	Land Value	4,500	4,500	540	Improvements	85,021	85,021	10,202	Mobile Home	0	0	0	Total Value	89,521	89,521	10,742	<table border="1"> <thead> <tr> <th>Levy Rate</th> <th>Current Tax</th> </tr> </thead> <tbody> <tr> <td>67.190</td> <td>721.75</td> </tr> <tr> <td>Assessed</td> <td>10,742</td> </tr> <tr> <td>Penalty</td> <td>0</td> </tr> <tr> <td>Exemption</td> <td>0</td> </tr> <tr> <td>Total Taxable</td> <td>10,742</td> </tr> <tr> <td></td> <td>722.00</td> </tr> </tbody> </table>		Levy Rate	Current Tax	67.190	721.75	Assessed	10,742	Penalty	0	Exemption	0	Total Taxable	10,742		722.00																																																																							
Source	REAL																																																																																																																								
Remove Cap	2026																																																																																																																								
Year Frozen																																																																																																																									
Uncapped Value	0																																																																																																																								
TIF Project ID	0																																																																																																																								
Fair Cash	Capped	Asmnt Level	Assessed																																																																																																																						
Land Value	4,500	4,500	540																																																																																																																						
Improvements	85,021	85,021	10,202																																																																																																																						
Mobile Home	0	0	0																																																																																																																						
Total Value	89,521	89,521	10,742																																																																																																																						
Levy Rate	Current Tax																																																																																																																								
67.190	721.75																																																																																																																								
Assessed	10,742																																																																																																																								
Penalty	0																																																																																																																								
Exemption	0																																																																																																																								
Total Taxable	10,742																																																																																																																								
	722.00																																																																																																																								
Assessment History																																																																																																																									
<table border="1"> <thead> <tr> <th>Tax Year</th> <th>Statement Number</th> <th>Billed Owner</th> <th>Tax Area</th> <th>Total Value</th> <th>Exemptions</th> <th>Taxable Value</th> <th>Billed Tax</th> </tr> </thead> <tbody> <tr> <td>2025</td> <td>2025-300006573</td> <td>QUINO, HECTOR VENTURA &amp;</td> <td>202</td> <td>89,521</td> <td>0</td> <td>9,772</td> <td>657.00</td> </tr> <tr> <td>2024</td> <td>2024-300006573</td> <td>CURTIS, BRANDON L.</td> <td>202</td> <td>97,337</td> <td>0</td> <td>9,308</td> <td>619.00</td> </tr> <tr> <td>2023</td> <td>2023-300006573</td> <td>CURTIS, BRANDON L.</td> <td>202</td> <td>90,235</td> <td>0</td> <td>8,864</td> <td>595.00</td> </tr> <tr> <td>2022</td> <td>2022-300006573</td> <td>CURTIS, BRANDON L.</td> <td>202</td> <td>70,350</td> <td>0</td> <td>8,442</td> <td>572.00</td> </tr> <tr> <td>2021</td> <td>2021-300006573</td> <td>CURTIS, BRANDON L.</td> <td>202</td> <td>70,350</td> <td>0</td> <td>8,442</td> <td>583.00</td> </tr> <tr> <td>2020</td> <td>2020-300006573</td> <td>CURTIS, BRANDON L.</td> <td>202</td> <td>70,350</td> <td>0</td> <td>8,442</td> <td>572.00</td> </tr> <tr> <td>2019</td> <td>2019-0006573</td> <td>CURTIS, BRANDON L.</td> <td>202</td> <td>69,048</td> <td></td> <td>8,286</td> <td>495.00</td> </tr> <tr> <td>2018</td> <td>2018-0006573</td> <td>CURTIS, BRANDON L.</td> <td>202</td> <td>69,146</td> <td></td> <td>8,297</td> <td>495.00</td> </tr> <tr> <td>2017</td> <td>2017-0006573</td> <td>CURTIS, BRANDON L.</td> <td>202</td> <td>70,117</td> <td></td> <td>8,414</td> <td>502.00</td> </tr> <tr> <td>2016</td> <td>2016-0006573</td> <td>CURTIS, BRANDON L.</td> <td>202</td> <td>71,492</td> <td></td> <td>8,579</td> <td>512.00</td> </tr> <tr> <td>2015</td> <td>2015-0006573</td> <td>CURTIS, BRANDON L.</td> <td>202</td> <td>76,027</td> <td></td> <td>7,964</td> <td>475.00</td> </tr> <tr> <td>2014</td> <td>2014-0006573</td> <td>MERKERISON, PETE W.</td> <td>202</td> <td>78,166</td> <td></td> <td>7,703</td> <td>460.00</td> </tr> <tr> <td>2013</td> <td>2013-0006573</td> <td>MERKERISON, PETE W.</td> <td>202</td> <td>76,655</td> <td></td> <td>7,449</td> <td>445.00</td> </tr> </tbody> </table>										Tax Year	Statement Number	Billed Owner	Tax Area	Total Value	Exemptions	Taxable Value	Billed Tax	2025	2025-300006573	QUINO, HECTOR VENTURA &	202	89,521	0	9,772	657.00	2024	2024-300006573	CURTIS, BRANDON L.	202	97,337	0	9,308	619.00	2023	2023-300006573	CURTIS, BRANDON L.	202	90,235	0	8,864	595.00	2022	2022-300006573	CURTIS, BRANDON L.	202	70,350	0	8,442	572.00	2021	2021-300006573	CURTIS, BRANDON L.	202	70,350	0	8,442	583.00	2020	2020-300006573	CURTIS, BRANDON L.	202	70,350	0	8,442	572.00	2019	2019-0006573	CURTIS, BRANDON L.	202	69,048		8,286	495.00	2018	2018-0006573	CURTIS, BRANDON L.	202	69,146		8,297	495.00	2017	2017-0006573	CURTIS, BRANDON L.	202	70,117		8,414	502.00	2016	2016-0006573	CURTIS, BRANDON L.	202	71,492		8,579	512.00	2015	2015-0006573	CURTIS, BRANDON L.	202	76,027		7,964	475.00	2014	2014-0006573	MERKERISON, PETE W.	202	78,166		7,703	460.00	2013	2013-0006573	MERKERISON, PETE W.	202	76,655		7,449	445.00
Tax Year	Statement Number	Billed Owner	Tax Area	Total Value	Exemptions	Taxable Value	Billed Tax																																																																																																																		
2025	2025-300006573	QUINO, HECTOR VENTURA &	202	89,521	0	9,772	657.00																																																																																																																		
2024	2024-300006573	CURTIS, BRANDON L.	202	97,337	0	9,308	619.00																																																																																																																		
2023	2023-300006573	CURTIS, BRANDON L.	202	90,235	0	8,864	595.00																																																																																																																		
2022	2022-300006573	CURTIS, BRANDON L.	202	70,350	0	8,442	572.00																																																																																																																		
2021	2021-300006573	CURTIS, BRANDON L.	202	70,350	0	8,442	583.00																																																																																																																		
2020	2020-300006573	CURTIS, BRANDON L.	202	70,350	0	8,442	572.00																																																																																																																		
2019	2019-0006573	CURTIS, BRANDON L.	202	69,048		8,286	495.00																																																																																																																		
2018	2018-0006573	CURTIS, BRANDON L.	202	69,146		8,297	495.00																																																																																																																		
2017	2017-0006573	CURTIS, BRANDON L.	202	70,117		8,414	502.00																																																																																																																		
2016	2016-0006573	CURTIS, BRANDON L.	202	71,492		8,579	512.00																																																																																																																		
2015	2015-0006573	CURTIS, BRANDON L.	202	76,027		7,964	475.00																																																																																																																		
2014	2014-0006573	MERKERISON, PETE W.	202	78,166		7,703	460.00																																																																																																																		
2013	2013-0006573	MERKERISON, PETE W.	202	76,655		7,449	445.00																																																																																																																		



# Harper

## Assessment Property Record Card for Tax Year 2026

Data provided by SHAYLYN WEDER County Assessor

Date 02/06/2026  
 Time 07:24:21  
 Page 2

Lot Data	Square-Foot - SOUTHPARK ADD	Primary Image
Lot Size	75 x 120	
Lot Count		
Units Buildable	4500	
Non-Ag Acres		
Topography		
Street Access		
Utilities		
Amenities		
Method	Square-Foot	
Base Lot Value	9,000.00 x .50 = 4,500	
Factor Value		
Adjustments		
Lot Value	4,500	

Residential Data	
Type	1 Single Family Residence
Condition	4 - Good
Quality	4 - Good
Architecture	TRAD TRADITIONAL
Style	100% One Story
Exterior Wall	100% Masonry, Brick/Stone
Base/Total Area	1,297 / 1,297
Style	100% One Story
HVAC	100% Warmed & Cooled Air
Roof Cover	1 Composition Shingle
Area on Slab	0
Fixture/RghIn	9 /
Bed/F/H Bath	3 / 2.0 /
Basement Area	
Garage Type	504 Attached Garage - Unfinished
Remodel	PARTIAL -
Year/Eff Age	1976 / 29

1 HOUSE 4/14/2022

GRM Approach	
GRM Code	
Gross Rent	
Indicated Value	

Multiple Regression	
MRA Code	
Adjusted R	
Indicated Value	

Direct Comparables	
Selection Model	DEFAULT DEFAULT SELECTION MODEL
Adjustment Model	DEFAULT DEFAULT ADJUSTMENTS TABLE
Comparables	
Indicated Value	

Cost Approach		Manual :	
Base Cost	102.21	Total Misc Impr	+ 6,919
Roofing Adj	+ 5.29	Garage Cost	+ 20,811
Subfloor Adj	+ 0.00	Total RCN	= 199,284
Heat/Cool Adj	+ 13.89	Depreciation ( 36%)	- 71,742
Plumbing Adj	+ 10.88	Lump Sums	+ 0
Basement Adj	+ 0.00	RCNLD	= 127,542
Adj Base Cost	= 132.27	Lot Value	+ 4,500
Total Area	x 1,297	Indicated Value	= 132,042
Adjusted Cost	= 171,554	Value Per SqFt	101.81

Value Reconciliation			
Selected Approach	Cost Approach		
Improvements	127,542		
Lot Value	4,500		
Indicated Value	132,042	101.81	Per SqFt
Agland Value			
Site Improvements	503		
Total Value	132,545	102.19	Total Value Per SqFt

Miscellaneous Improvements								
Code	Description	Sketch ID	Size	Year	Units	Unit Cost	Depr	Value
FPR1	1 1st Msn Cls A	0		1	1	6,170.47		6,170
RSPC	Raised Slab Porch - Covered	6722	5x3		15	49.90		749



Harper

Assessment Property Record Card for Tax Year 2026

Data provided by SHAYLYN WEDER County Assessor

Date 02/06/2026  
 Time 07:24:21  
 Page 3

Sketch Image

300006573

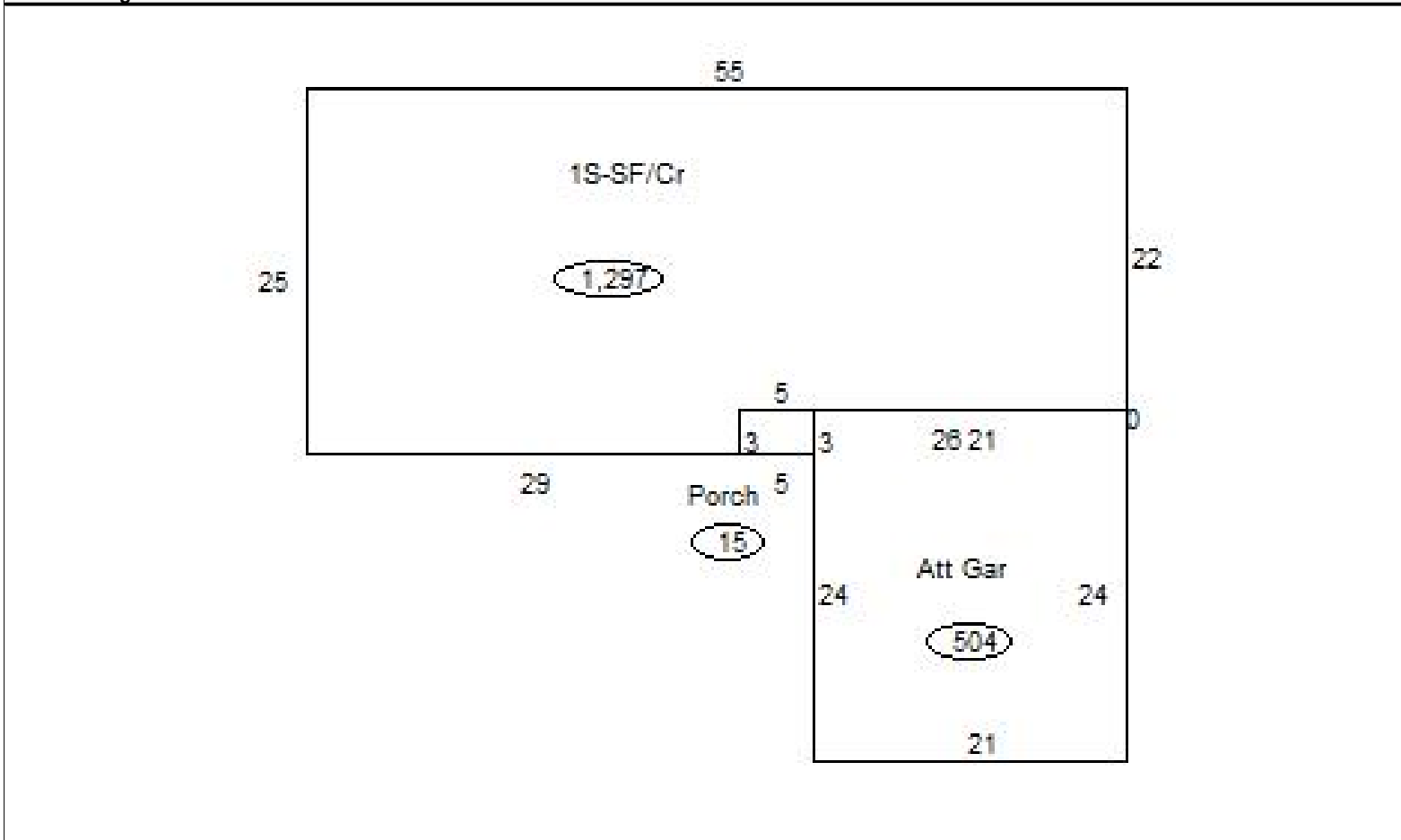

Sketch Vector Information

Sequence	Code	Type	Built Over	Scale	Section Label	Base Area	Multiplier	Total Area
1	M	RSPC		20	Porch	15	1.000	15
2	R	1	Crawl	20	1S-SF/Cr	1,297	1.000	1,297
3	G	1		20	Att Gar	504	1.000	504
<b>Total Building Area</b>						1,297		1,297



# Harper

## Assessment Property Record Card for Tax Year 2026

Data provided by SHAYLYN WEDER County Assessor

Date 02/06/2026  
 Time 07:24:21  
 Page 4

300006573

### Outbuildings/Site Improvements

Building Image	Code	Description	Dimensions	Floor	Roofing	Total Units
	PACN	Paving - Concrete Driveway	38x16x0			608
	Qual	3	Cond 3	Year 1980	Eff Age 46	
				0		
				0		
				0		
<b>Valuation Summary</b>		<b>Modifier Total</b>	<b>RCN</b>	<b>Depr (80% Phys/ % Func)</b>		<b>RCNLD</b>
Base Cost (4.14 x 608)		2,517		2,517		503

3100-00-001-012-0-001-00  
 0075 04/12/21