



# Harper

## Assessment Property Record Card for Tax Year 2026

Data provided by SHAYLYN WEDER County Assessor

Date 02/06/2026  
 Time 07:24:30  
 Page 1

Assessment Data					Primary Image									
Account	300006582													
Parcel ID	2150-00-002-009-0-001-00													
Cadastral ID	2150-002-009-00-0-001-00													
Property Type	REAL - Real Property													
Property Class	UR	VI Area	4											
Tax Area	202 - 1T-LAVERNE-C													
Name ID	15511													
CADY, STEVEN LAWRENCE & MARSHA D. CADY														
928 S. COLORADO DR LAVERNE OK 73848-0000														
Parcel Location														
Situs	00928 COLORADO DR													
Subdivision	SOUTH PARK ADDN													
Lot/Block	0009 / 0002	Parcel Size	2 - Lots											
Sec/Twn/Rng	/ / /													
Neighborhood	200300 - SOUTHPARK													
School District	1-LAVERN - 1-LAVERNE													
Legal Description Lat/Long: 36.70091430 -99.89477389														
SOUTH PARK ADD BLK 2 LOTS S. 60' OF 9; ALL OF 10; N45' OF 11														
Building Permits														
<table border="1"> <thead> <tr> <th>Number</th> <th>Description</th> <th>Opened</th> <th>Closed</th> <th>Amount</th> </tr> </thead> <tbody> <tr> <td colspan="5"> </td> </tr> </tbody> </table>					Number	Description	Opened	Closed	Amount					
Number	Description	Opened	Closed	Amount										
Exemptions														
Code	Type	Active	Maximum	Exemption										
H	Homestead	Yes	1,000	1,000										
Sale History														
Bk/Pg	Grantor	Date	Price	Code										
/	CADY, STEVEN LAWRENCE &													
Parcel Valuation														
Source	REAL	Fair Cash	Capped	Asmnt Level	Assessed	Levy Rate	67.190	Current Tax						
Remove Cap		Land Value	10,800	8,008	12%	961	Assessed	16,167	1,086.26					
Year Frozen		Improvements	172,474	126,717		15,206	Penalty	0						
Uncapped Value	0	Mobile Home	0	0		0	Exemption	1,000	-67.00					
TIF Project ID	0	Total Value	183,274	134,725		16,167	Total Taxable	15,167	1,019.00					
Assessment History														
Tax Year	Statement Number	Billed Owner	Tax Area	Total Value	Exemptions	Taxable Value	Billed Tax							
2025	2025-300006582	CADY, STEVEN LAWRENCE &	202	183,274	1000	14,697	987.00							
2024	2024-300006582	CADY, STEVEN LAWRENCE &	202	201,378	1000	14,239	947.00							
2023	2023-300006582	CADY, STEVEN LAWRENCE &	202	185,546	1000	13,795	926.00							
2022	2022-300006582	CADY, STEVEN LAWRENCE &	202	181,095	1000	12,699	860.00							
2021	2021-300006582	CADY, STEVEN LAWRENCE &	202	181,095	1000	12,301	849.00							
2020	2020-300006582	CADY, STEVEN LAWRENCE &	202	181,095	1000	11,913	807.00							
2019	2019-0006582	CADY, STEVEN LAWRENCE &	202	178,507		11,538	689.00							
2018	2018-0006582	CADY, STEVEN LAWRENCE &	202	178,912		11,172	667.00							
2017	2017-0006582	CADY, STEVEN LAWRENCE &	202	178,645		10,817	646.00							
2016	2016-0006582	CADY, STEVEN LAWRENCE &	202	180,913		10,473	625.00							
2015	2015-0006582	CADY, STEVEN LAWRENCE &	202	191,430		10,139	605.00							
2014	2014-0006582	CADY, STEVEN LAWRENCE &	202	198,019		9,815	586.00							
2013	2013-0006582	CADY, STEVEN LAWRENCE &	202	164,227		9,500	567.00							



# Harper

## Assessment Property Record Card for Tax Year 2026

Data provided by SHAYLYN WEDER County Assessor

Date 02/06/2026  
 Time 07:24:30  
 Page 2

Lot Data	Square-Foot - SOUTHPARK ADD	Primary Image
Lot Size	180 x 120	
Lot Count		
Units Buildable	10800	
Non-Ag Acres		
Topography		
Street Access		
Utilities		
Amenities		
Method	Square-Foot	
Base Lot Value	21,600.00 x .50 = 10,800	
Factor Value		
Adjustments		
Lot Value	10,800	

Residential Data	
Type	1 Single Family Residence
Condition	3 - Average
Quality	3 - Average
Architecture	TRAD TRADITIONAL
Style	100% One Story
Exterior Wall	100% Veneer, Masonry
Base/Total Area	2,245 / 2,245
Style	100% One Story
HVAC	100% Warmed & Cooled Air % Hot Water
Roof Cover	1 Composition Shingle
Area on Slab	0
Fixture/RghIn	8 /
Bed/F/H Bath	3 / 2.0 /
Basement Area	
Garage Type	616 Attached Garage - Unfinished
Remodel	
Year/Eff Age	1994 / 32

HOUSE 4/14/2022

### GRM Approach

GRM Code	
Gross Rent Indicated Value	

### Multiple Regression

MRA Code	
Adjusted R Indicated Value	

### Direct Comparables

Selection Model	DEFAULT	DEFAULT SELECTION MODEL
Adjustment Model	DEFAULT	DEFAULT ADJUSTMENTS TABLE
Comparables Indicated Value		

### Value Reconciliation

Selected Approach	Cost Approach		
Improvements	163,920		
Lot Value	10,800		
Indicated Value	174,720	77.83	Per SqFt
Agland Value			
Site Improvements	7,121		
Total Value	181,841	81.00	Total Value Per SqFt

Cost Approach		Manual :	
Base Cost	87.70	Total Misc Impr	+ 3,383
Roofing Adj	+ 3.83	Garage Cost	+ 15,975
Subfloor Adj	+ 0.00	Total RCN	= 273,200
Heat/Cool Adj	+ 17.16	Depreciation ( 40%)	- 109,280
Plumbing Adj	+ 4.37	Lump Sums	+ 0
Basement Adj	+ 0.00	RCNLD	= 163,920
Adj Base Cost	= 113.07	Lot Value	+ 10,800
Total Area	x 2,245	Indicated Value	= 174,720
Adjusted Cost	= 253,842	Value Per SqFt	77.83

### Miscellaneous Improvements

Code	Description	Sketch ID	Size	Year	Units	Unit Cost	Depr	Value
PATO	Raised Slab Porch - Open	6752	6x4		24	9.78		235
PATC	Patio - Covered	6753	20x10		200	15.74		3,148



Harper

Assessment Property Record Card for Tax Year 2026

Data provided by SHAYLYN WEDER County Assessor

Date 02/06/2026  
 Time 07:24:30  
 Page 3

Sketch Image

300006582

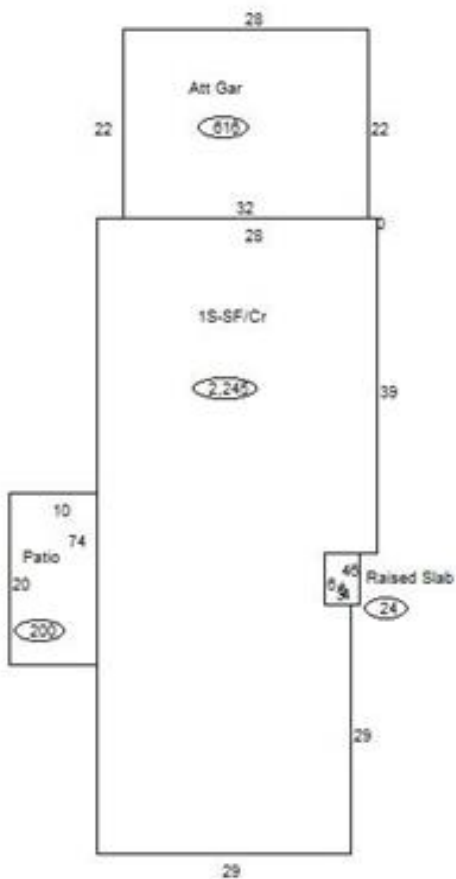

Sketch Vector Information

Sequence	Code	Type	Built Over	Scale	Section Label	Base Area	Multiplier	Total Area
1	R	1	Crawl	20	1S-SF/Cr	2,245	1.000	2,245
2	G	1		20	Att Gar	616	1.000	616
3	M	PATO		20	Raised Slab	24	1.000	24
4	M	PATC		20	Patio	200	1.000	200
<b>Total Building Area</b>						2,245		2,245



# Harper



## Assessment Property Record Card for Tax Year 2026

Data provided by SHAYLYN WEDER County Assessor

Date 02/06/2026  
 Time 07:24:30  
 Page 4

300006582

### Outbuildings/Site Improvements

Building Image	Code	Description	Dimensions	Floor	Roofing	Total Units
	SHDS	Yard Shed - Metal	18x18x8	Base	Formed Metal	324
	Qual	4	Cond	4	Year	2023
					Eff Age	2
						0
<b>Valuation Summary</b>		<b>Modifier Total</b>		<b>RCN</b>	<b>Depr (10% Phys/ % Func)</b>	<b>RCNLD</b>
Base Cost (20.09 x 324)		6,509		6,509	651	5,858
	PACN	Paving - Concrete dRIVEWAY	40x27x0			1,080
	Qual	3	Cond	3	Year	1994
					Eff Age	32
						0
<b>Valuation Summary</b>		<b>Modifier Total</b>		<b>RCN</b>	<b>Depr (80% Phys/ % Func)</b>	<b>RCNLD</b>
Base Cost (4.07 x 1,080)		4,396		4,396	3,517	879
	PACN	Paving - Concrete Sidewalk	39x3x0			117
	Qual	3	Cond	3	Year	1994
					Eff Age	32
						0
<b>Valuation Summary</b>		<b>Modifier Total</b>		<b>RCN</b>	<b>Depr (80% Phys/ % Func)</b>	<b>RCNLD</b>
Base Cost (6.83 x 117)		799		799	639	160
	PACN	Paving - Concrete Sidewalk	33x6x0			198
	Qual	3	Cond	3	Year	1994
					Eff Age	32
						0
<b>Valuation Summary</b>		<b>Modifier Total</b>		<b>RCN</b>	<b>Depr (80% Phys/ % Func)</b>	<b>RCNLD</b>
Base Cost (5.66 x 198)		1,121		1,121	897	224