



Harper

Assessment Property Record Card for Tax Year 2026

Data provided by SHAYLYN WEDER County Assessor

Date 02/06/2026
 Time 07:25:38
 Page 1

Assessment Data					Primary Image																																																																																																																				
Account 300006660 Parcel ID 2150-00-007-003-0-001-00 Cadastral ID 2150-007-003-00-0-001-00 Property Type REAL - Real Property Property Class UR VI Area 4 Tax Area 202 - 1T-LAVERNE-C Name ID 15473 HERNANDEZ, MIRIAM CAMPUZANO P O BOX 11 LAVERNE OK 73848-0000 Parcel Location Situs 00802 OKLAHOMA DR Subdivision SOUTH PARK ADDN Lot/Block 0003 / 0007 Parcel Size 1 - Lots Sec/Twn/Rng / / / Neighborhood 200300 - SOUTHPARK School District 1-LAVERN - 1-LAVERNE					<p>2150-00-007-003-0-001-00 4/25/2022 ACCT. #6660</p> <p>house/garage/driveway/carport/front porch 4/26/2022</p>																																																																																																																				
Legal Description Lat/Long: 36.69886170 -99.88616676 SOUTH PARK ADD BLOCK 7 LOT 3																																																																																																																									
Exemptions <table border="1"> <thead> <tr> <th>Code</th> <th>Type</th> <th>Active</th> <th>Maximum</th> <th>Exemption</th> </tr> </thead> <tbody> <tr> <td></td> <td></td> <td></td> <td></td> <td></td> </tr> </tbody> </table>					Code	Type	Active	Maximum	Exemption						Building Permits <table border="1"> <thead> <tr> <th>Number</th> <th>Description</th> <th>Opened</th> <th>Closed</th> <th>Amount</th> </tr> </thead> <tbody> <tr> <td></td> <td></td> <td></td> <td></td> <td></td> </tr> </tbody> </table>					Number	Description	Opened	Closed	Amount																																																																																																	
Code	Type	Active	Maximum	Exemption																																																																																																																					
Number	Description	Opened	Closed	Amount																																																																																																																					
Parcel Valuation <table border="1"> <thead> <tr> <th>Source</th> <th>REAL</th> <th>Fair Cash</th> <th>Capped</th> <th>Asmnt Level</th> <th>Assessed</th> <th>Levy Rate</th> <th>67.190</th> <th>Current Tax</th> </tr> </thead> <tbody> <tr> <td>Remove Cap</td> <td>2026</td> <td>Land Value 5,750</td> <td>5,750</td> <td>12%</td> <td>690</td> <td>Assessed</td> <td>12,450</td> <td>836.52</td> </tr> <tr> <td>Year Frozen</td> <td></td> <td>Improvements 98,005</td> <td>98,005</td> <td></td> <td>11,760</td> <td>Penalty</td> <td>0</td> <td></td> </tr> <tr> <td>Uncapped Value</td> <td>0</td> <td>Mobile Home 0</td> <td>0</td> <td></td> <td>0</td> <td>Exemption</td> <td>0</td> <td>0.00</td> </tr> <tr> <td>TIF Project ID</td> <td>0</td> <td>Total Value 103,755</td> <td>103,755</td> <td></td> <td>12,450</td> <td>Total Taxable</td> <td>12,450</td> <td>837.00</td> </tr> </tbody> </table>					Source	REAL	Fair Cash	Capped	Asmnt Level	Assessed	Levy Rate	67.190	Current Tax	Remove Cap	2026	Land Value 5,750	5,750	12%	690	Assessed	12,450	836.52	Year Frozen		Improvements 98,005	98,005		11,760	Penalty	0		Uncapped Value	0	Mobile Home 0	0		0	Exemption	0	0.00	TIF Project ID	0	Total Value 103,755	103,755		12,450	Total Taxable	12,450	837.00	Sale History <table border="1"> <thead> <tr> <th>Bk/Pg</th> <th>Grantor</th> <th>Date</th> <th>Price</th> <th>Code</th> </tr> </thead> <tbody> <tr> <td>790/26</td> <td>MELENDEZ, DELMAR AGUILAR &</td> <td>06/12/2025</td> <td>125,000</td> <td>Q</td> </tr> <tr> <td>711/659</td> <td>SIRVA RELOCATION CREDIT L</td> <td>09/24/2015</td> <td>80,000</td> <td>21</td> </tr> <tr> <td>711/657</td> <td>CERROS PORTILLO, JESUS AN</td> <td>09/24/2015</td> <td>80,000</td> <td>21</td> </tr> <tr> <td>644/423</td> <td>KIRKHART, LEONA M.</td> <td>10/31/2008</td> <td>110,000</td> <td>PQ</td> </tr> <tr> <td>555/722</td> <td>ROACH, NELLON H.</td> <td>05/10/2000</td> <td>63,500</td> <td>QV</td> </tr> </tbody> </table>					Bk/Pg	Grantor	Date	Price	Code	790/26	MELENDEZ, DELMAR AGUILAR &	06/12/2025	125,000	Q	711/659	SIRVA RELOCATION CREDIT L	09/24/2015	80,000	21	711/657	CERROS PORTILLO, JESUS AN	09/24/2015	80,000	21	644/423	KIRKHART, LEONA M.	10/31/2008	110,000	PQ	555/722	ROACH, NELLON H.	05/10/2000	63,500	QV																																					
Source	REAL	Fair Cash	Capped	Asmnt Level	Assessed	Levy Rate	67.190	Current Tax																																																																																																																	
Remove Cap	2026	Land Value 5,750	5,750	12%	690	Assessed	12,450	836.52																																																																																																																	
Year Frozen		Improvements 98,005	98,005		11,760	Penalty	0																																																																																																																		
Uncapped Value	0	Mobile Home 0	0		0	Exemption	0	0.00																																																																																																																	
TIF Project ID	0	Total Value 103,755	103,755		12,450	Total Taxable	12,450	837.00																																																																																																																	
Bk/Pg	Grantor	Date	Price	Code																																																																																																																					
790/26	MELENDEZ, DELMAR AGUILAR &	06/12/2025	125,000	Q																																																																																																																					
711/659	SIRVA RELOCATION CREDIT L	09/24/2015	80,000	21																																																																																																																					
711/657	CERROS PORTILLO, JESUS AN	09/24/2015	80,000	21																																																																																																																					
644/423	KIRKHART, LEONA M.	10/31/2008	110,000	PQ																																																																																																																					
555/722	ROACH, NELLON H.	05/10/2000	63,500	QV																																																																																																																					
Assessment History <table border="1"> <thead> <tr> <th>Tax Year</th> <th>Statement Number</th> <th>Billed Owner</th> <th>Tax Area</th> <th>Total Value</th> <th>Exemptions</th> <th>Taxable Value</th> <th>Billed Tax</th> </tr> </thead> <tbody> <tr> <td>2025</td> <td>2025-300006660</td> <td>HERNANDEZ, MIRIAM CAMPUZANO</td> <td>202</td> <td>103,755</td> <td>0</td> <td>11,244</td> <td>755.00</td> </tr> <tr> <td>2024</td> <td>2024-300006660</td> <td>MELENDEZ, DELMAR AGUILAR &</td> <td>202</td> <td>113,710</td> <td>0</td> <td>10,709</td> <td>712.00</td> </tr> <tr> <td>2023</td> <td>2023-300006660</td> <td>MELENDEZ, DELMAR AGUILAR &</td> <td>202</td> <td>103,343</td> <td>0</td> <td>10,199</td> <td>685.00</td> </tr> <tr> <td>2022</td> <td>2022-300006660</td> <td>MELENDEZ, DELMAR AGUILAR &</td> <td>202</td> <td>80,944</td> <td>0</td> <td>9,713</td> <td>658.00</td> </tr> <tr> <td>2021</td> <td>2021-300006660</td> <td>MELENDEZ, DELMAR AGUILAR &</td> <td>202</td> <td>80,944</td> <td>0</td> <td>9,713</td> <td>671.00</td> </tr> <tr> <td>2020</td> <td>2020-300006660</td> <td>MELENDEZ, DELMAR AGUILAR &</td> <td>202</td> <td>80,944</td> <td>0</td> <td>9,713</td> <td>658.00</td> </tr> <tr> <td>2019</td> <td>2019-0006660</td> <td>MELENDEZ, DELMAR AGUILAR &</td> <td>202</td> <td>79,825</td> <td></td> <td>9,579</td> <td>572.00</td> </tr> <tr> <td>2018</td> <td>2018-0006660</td> <td>MELENDEZ, DELMAR AGUILAR &</td> <td>202</td> <td>80,364</td> <td></td> <td>9,644</td> <td>576.00</td> </tr> <tr> <td>2017</td> <td>2017-0006660</td> <td>MELENDEZ, DELMAR AGUILAR &</td> <td>202</td> <td>78,420</td> <td></td> <td>9,410</td> <td>562.00</td> </tr> <tr> <td>2016</td> <td>2016-0006660</td> <td>MELENDEZ, DELMAR AGUILAR &</td> <td>202</td> <td>80,280</td> <td></td> <td>9,633</td> <td>575.00</td> </tr> <tr> <td>2015</td> <td>2015-0006660</td> <td>MELENDEZ, DELMAR AGUILAR &</td> <td>202</td> <td>127,509</td> <td></td> <td>14,481</td> <td>864.00</td> </tr> <tr> <td>2014</td> <td>2014-0006660</td> <td>CERROS PORTILLO, JESUS AND</td> <td>202</td> <td>132,611</td> <td></td> <td>13,792</td> <td>823.00</td> </tr> <tr> <td>2013</td> <td>2013-0006660</td> <td>CERROS PORTILLO, JESUS AND</td> <td>202</td> <td>109,460</td> <td></td> <td>13,135</td> <td>784.00</td> </tr> </tbody> </table>										Tax Year	Statement Number	Billed Owner	Tax Area	Total Value	Exemptions	Taxable Value	Billed Tax	2025	2025-300006660	HERNANDEZ, MIRIAM CAMPUZANO	202	103,755	0	11,244	755.00	2024	2024-300006660	MELENDEZ, DELMAR AGUILAR &	202	113,710	0	10,709	712.00	2023	2023-300006660	MELENDEZ, DELMAR AGUILAR &	202	103,343	0	10,199	685.00	2022	2022-300006660	MELENDEZ, DELMAR AGUILAR &	202	80,944	0	9,713	658.00	2021	2021-300006660	MELENDEZ, DELMAR AGUILAR &	202	80,944	0	9,713	671.00	2020	2020-300006660	MELENDEZ, DELMAR AGUILAR &	202	80,944	0	9,713	658.00	2019	2019-0006660	MELENDEZ, DELMAR AGUILAR &	202	79,825		9,579	572.00	2018	2018-0006660	MELENDEZ, DELMAR AGUILAR &	202	80,364		9,644	576.00	2017	2017-0006660	MELENDEZ, DELMAR AGUILAR &	202	78,420		9,410	562.00	2016	2016-0006660	MELENDEZ, DELMAR AGUILAR &	202	80,280		9,633	575.00	2015	2015-0006660	MELENDEZ, DELMAR AGUILAR &	202	127,509		14,481	864.00	2014	2014-0006660	CERROS PORTILLO, JESUS AND	202	132,611		13,792	823.00	2013	2013-0006660	CERROS PORTILLO, JESUS AND	202	109,460		13,135	784.00
Tax Year	Statement Number	Billed Owner	Tax Area	Total Value	Exemptions	Taxable Value	Billed Tax																																																																																																																		
2025	2025-300006660	HERNANDEZ, MIRIAM CAMPUZANO	202	103,755	0	11,244	755.00																																																																																																																		
2024	2024-300006660	MELENDEZ, DELMAR AGUILAR &	202	113,710	0	10,709	712.00																																																																																																																		
2023	2023-300006660	MELENDEZ, DELMAR AGUILAR &	202	103,343	0	10,199	685.00																																																																																																																		
2022	2022-300006660	MELENDEZ, DELMAR AGUILAR &	202	80,944	0	9,713	658.00																																																																																																																		
2021	2021-300006660	MELENDEZ, DELMAR AGUILAR &	202	80,944	0	9,713	671.00																																																																																																																		
2020	2020-300006660	MELENDEZ, DELMAR AGUILAR &	202	80,944	0	9,713	658.00																																																																																																																		
2019	2019-0006660	MELENDEZ, DELMAR AGUILAR &	202	79,825		9,579	572.00																																																																																																																		
2018	2018-0006660	MELENDEZ, DELMAR AGUILAR &	202	80,364		9,644	576.00																																																																																																																		
2017	2017-0006660	MELENDEZ, DELMAR AGUILAR &	202	78,420		9,410	562.00																																																																																																																		
2016	2016-0006660	MELENDEZ, DELMAR AGUILAR &	202	80,280		9,633	575.00																																																																																																																		
2015	2015-0006660	MELENDEZ, DELMAR AGUILAR &	202	127,509		14,481	864.00																																																																																																																		
2014	2014-0006660	CERROS PORTILLO, JESUS AND	202	132,611		13,792	823.00																																																																																																																		
2013	2013-0006660	CERROS PORTILLO, JESUS AND	202	109,460		13,135	784.00																																																																																																																		



Harper

Assessment Property Record Card for Tax Year 2026

Data provided by SHAYLYN WEDER County Assessor

Date 02/06/2026
 Time 07:25:39
 Page 2

Lot Data	Square-Foot - SOUTHPARK ADD	Primary Image
Lot Size	0 0	
Lot Count		
Units Buildable	5750	
Non-Ag Acres		
Topography		
Street Access		
Utilities		
Amenities		
Method	Square-Foot	
Base Lot Value	11,499.00 x .50 = 5,750	
Factor Value		
Adjustments		
Lot Value	5,750	

Residential Data	
Type	1 Single Family Residence
Condition	3 - Average
Quality	3 - Average
Architecture	TRAD TRADITIONAL
Style	100% One Story
Exterior Wall	100% Veneer, Masonry
Base/Total Area	1,910 / 1,910
Style	100% One Story
HVAC	100% Warmed & Cooled Air
Roof Cover	1 Composition Shingle
Area on Slab	0
Fixture/RghIn	5 /
Bed/F/H Bath	2 / 1.0 /
Basement Area	
Garage Type	273 Built-In Garage
Remodel	PARTIAL -
Year/Eff Age	1965 / 44

house/garage/driveway/carport/front porch 4/26/2022

GRM Approach	
GRM Code	
Gross Rent	
Indicated Value	

Multiple Regression	
MRA Code	
Adjusted R	
Indicated Value	

Direct Comparables	
Selection Model	DEFAULT DEFAULT SELECTION MODEL
Adjustment Model	DEFAULT DEFAULT ADJUSTMENTS TABLE
Comparables	
Indicated Value	

Cost Approach		Manual :	
Base Cost	86.22	Total Misc Impr	+ 5,465
Roofing Adj	+ 3.77	Garage Cost	+ 7,569
Subfloor Adj	+ 0.00	Total RCN	= 211,846
Heat/Cool Adj	+ 10.77	Depreciation (49%)	- 103,805
Plumbing Adj	+ 3.34	Lump Sums	+ 0
Basement Adj	+ 0.00	RCNLD	= 108,041
Adj Base Cost	= 104.09	Lot Value	+ 5,750
Total Area	x 1,910	Indicated Value	= 113,791
Adjusted Cost	= 198,812	Value Per SqFt	59.58

Value Reconciliation			
Selected Approach	Cost Approach		
Improvements	108,041		
Lot Value	5,750		
Indicated Value	113,791	59.58	Per SqFt
Agland Value			
Site Improvements	3,440		
Total Value	117,231	61.38	Total Value Per SqFt

Miscellaneous Improvements							
Code	Description	Sketch ID	Size	Year	Units	Unit Cost	Depr Value
RSPC	Raised Slab Porch - Covered	7111	137		137	39.89	5,465



Harper

Assessment Property Record Card for Tax Year 2026

Data provided by SHAYLYN WEDER County Assessor

Date 02/06/2026
Time 07:25:39
Page 3

Sketch Image

300006660

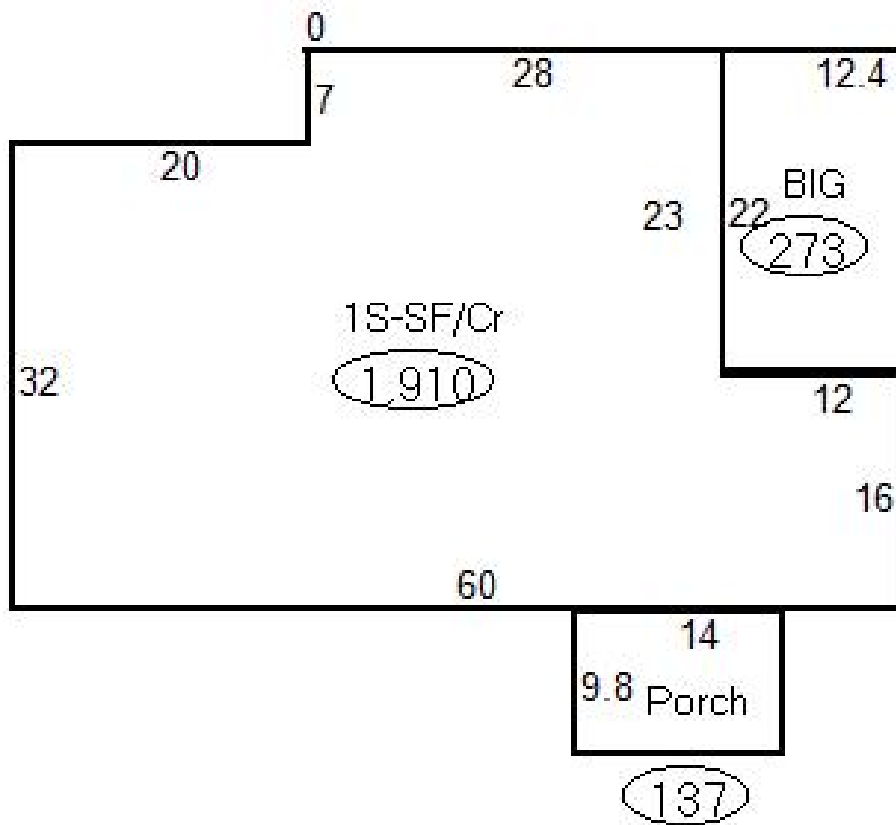

Sketch Vector Information

Sequence	Code	Type	Built Over	Scale	Section Label	Base Area	Multiplier	Total Area
1	R	1	Crawl	20	1S-SF/Cr	1,910	1.000	1,910
2	G	8		20	BIG	273	1.000	273
3	M	RSPC		20	Porch	137	1.000	137
Total Building Area						1,910		1,910



Harper

Assessment Property Record Card for Tax Year 2026

Data provided by SHAYLYN WEDER County Assessor

Date 02/06/2026
 Time 07:25:39
 Page 4

300006660

Outbuildings/Site Improvements

Building Image	Code	Description	Dimensions	Floor	Roofing	Total Units	
	SHDS	Yard Shed - Wood	22x16x8		Composition Roll	352	
	Qual	3	Cond 3	Year 1990	Eff Age 36		
	Valuation Summary		Modifier Total		RCN	Depr (80% Phys/ % Func)	RCNLD
	Base Cost (18.09 x 352)		6,368		6,368	5,094	1,274
	CPAT	Carport - Attached	28x12x10		Composition Roll	336	
	Qual	4	Cond 4	Year 1965	Eff Age 49		
	Valuation Summary		Modifier Total		RCN	Depr (80% Phys/ % Func)	RCNLD
	Base Cost (10.97 x 336)		3,686		3,686	2,949	737
	PACN	Paving - Concrete / Driveway	42x20x0			840	
	Qual	3	Cond 3	Year 1965	Eff Age 61		
	Valuation Summary		Modifier Total		RCN	Depr (80% Phys/ % Func)	RCNLD
	Base Cost (4.11 x 840)		3,452		3,452	2,762	690
	PACN	Paving - Concrete / Driveway under Carpor	28x12x0			336	
	Qual	3	Cond 3	Year 1965	Eff Age 61		
	Valuation Summary		Modifier Total		RCN	Depr (80% Phys/ % Func)	RCNLD
	Base Cost (4.18 x 336)		1,404		1,404	1,123	281
	PACN	Paving - Concrete / Front Sidewalk	18x3x0			54	
	Qual	3	Cond 3	Year 1965	Eff Age 61		
	Valuation Summary		Modifier Total		RCN	Depr (80% Phys/ % Func)	RCNLD
	Base Cost (7.73 x 54)		417		417	334	83
	PACN	Paving - Concrete / Circle Driveway	45x10x0			450	
	Qual	3	Cond 3	Year 1965	Eff Age 61		
	Valuation Summary		Modifier Total		RCN	Depr (80% Phys/ % Func)	RCNLD
	Base Cost (4.17 x 450)		1,877		1,877	1,502	375