



Rogers

Assessment Property Record Card for Tax Year 2026

Data provided by LISA DELOZIER County Assessor

Date 04/17/2026
 Time 03:14:30
 Page 1

Assessment Data					Primary Image																																																																																																																				
Account 660000038 Parcel ID 19N16E-01-4-00000-000-0000 Cadastral ID 01-19-16-03600 Property Type REAL - Real Property Property Class RR VI Area 3 Tax Area 2 - INOLA RURAL Name ID 323089 LAMOREAUX, DANIEL J & KAREN J 15723 E 600 RD INOLA OK 74036-0000 Parcel Location Situs 15723 E 600 RD Subdivision Lot/Block / Parcel Size 4 - Acres Sec/Twn/Rng 1 / 19 / 16 / 4 Neighborhood 1916 - UNPLATTED School District S005 - INOLA SCHOOLS					<p>\\\\tsclient\C\Users\Randy Necessary\Pictures\101_0913\IMG_0018. 9/17/2021</p>																																																																																																																				
Legal Description Lat/Long: 36.14842165 -95.55078058 W 528' S 330' SW SE SE																																																																																																																									
					Building Permits <table border="1"> <thead> <tr> <th>Number</th> <th>Description</th> <th>Opened</th> <th>Closed</th> <th>Amount</th> </tr> </thead> <tbody> <tr> <td>8041</td> <td>R4-METAL BUILDING</td> <td>05/2003</td> <td>01/2004</td> <td>12,000</td> </tr> </tbody> </table>					Number	Description	Opened	Closed	Amount	8041	R4-METAL BUILDING	05/2003	01/2004	12,000																																																																																																						
Number	Description	Opened	Closed	Amount																																																																																																																					
8041	R4-METAL BUILDING	05/2003	01/2004	12,000																																																																																																																					
Exemptions <table border="1"> <thead> <tr> <th>Code</th> <th>Type</th> <th>Active</th> <th>Maximum</th> <th>Exemption</th> </tr> </thead> <tbody> <tr> <td>H</td> <td>Homestead</td> <td>Yes</td> <td>1,000</td> <td>1,000</td> </tr> <tr> <td>H</td> <td>Homestead</td> <td>No</td> <td>1,000</td> <td></td> </tr> </tbody> </table>					Code	Type	Active	Maximum	Exemption	H	Homestead	Yes	1,000	1,000	H	Homestead	No	1,000		Sale History <table border="1"> <thead> <tr> <th>Bk/Pg</th> <th>Grantor</th> <th>Date</th> <th>Price</th> <th>Code</th> </tr> </thead> <tbody> <tr> <td>2674/378</td> <td>LITTLEFIELD, WILLA MAE</td> <td>11/07/2017</td> <td>165,500</td> <td>YES</td> </tr> <tr> <td>2640/15</td> <td>LITTLEFIELD, LESTER D JR</td> <td>06/12/2017</td> <td>0</td> <td>4</td> </tr> </tbody> </table>					Bk/Pg	Grantor	Date	Price	Code	2674/378	LITTLEFIELD, WILLA MAE	11/07/2017	165,500	YES	2640/15	LITTLEFIELD, LESTER D JR	06/12/2017	0	4																																																																																		
Code	Type	Active	Maximum	Exemption																																																																																																																					
H	Homestead	Yes	1,000	1,000																																																																																																																					
H	Homestead	No	1,000																																																																																																																						
Bk/Pg	Grantor	Date	Price	Code																																																																																																																					
2674/378	LITTLEFIELD, WILLA MAE	11/07/2017	165,500	YES																																																																																																																					
2640/15	LITTLEFIELD, LESTER D JR	06/12/2017	0	4																																																																																																																					
Parcel Valuation <table border="1"> <thead> <tr> <th>Source</th> <th>REAL</th> <th>Fair Cash</th> <th>Capped</th> <th>Asmnt Level</th> <th>Assessed</th> <th>Levy Rate</th> <th>80.060</th> <th>Current Tax</th> </tr> </thead> <tbody> <tr> <td>Remove Cap</td> <td>2018</td> <td>Land Value 105,120</td> <td>49,402</td> <td>11%</td> <td>5,434</td> <td>Assessed</td> <td>21,902</td> <td>1,753.47</td> </tr> <tr> <td>Year Frozen</td> <td>2005</td> <td>Improvements 163,240</td> <td>149,706</td> <td></td> <td>16,468</td> <td>Penalty</td> <td>0</td> <td></td> </tr> <tr> <td>Uncapped Value</td> <td>0</td> <td>Mobile Home 0</td> <td>0</td> <td></td> <td>0</td> <td>Exemption</td> <td>1,000</td> <td>-80.00</td> </tr> <tr> <td>TIF Project ID</td> <td>0</td> <td>Total Value 268,360</td> <td>199,108</td> <td></td> <td>21,902</td> <td>Total Taxable</td> <td>20,902</td> <td>1,673.00</td> </tr> </tbody> </table>										Source	REAL	Fair Cash	Capped	Asmnt Level	Assessed	Levy Rate	80.060	Current Tax	Remove Cap	2018	Land Value 105,120	49,402	11%	5,434	Assessed	21,902	1,753.47	Year Frozen	2005	Improvements 163,240	149,706		16,468	Penalty	0		Uncapped Value	0	Mobile Home 0	0		0	Exemption	1,000	-80.00	TIF Project ID	0	Total Value 268,360	199,108		21,902	Total Taxable	20,902	1,673.00																																																																			
Source	REAL	Fair Cash	Capped	Asmnt Level	Assessed	Levy Rate	80.060	Current Tax																																																																																																																	
Remove Cap	2018	Land Value 105,120	49,402	11%	5,434	Assessed	21,902	1,753.47																																																																																																																	
Year Frozen	2005	Improvements 163,240	149,706		16,468	Penalty	0																																																																																																																		
Uncapped Value	0	Mobile Home 0	0		0	Exemption	1,000	-80.00																																																																																																																	
TIF Project ID	0	Total Value 268,360	199,108		21,902	Total Taxable	20,902	1,673.00																																																																																																																	
Assessment History <table border="1"> <thead> <tr> <th>Tax Year</th> <th>Statement Number</th> <th>Billed Owner</th> <th>Tax Area</th> <th>Total Value</th> <th>Exemptions</th> <th>Taxable Value</th> <th>Billed Tax</th> </tr> </thead> <tbody> <tr><td>2025</td><td>2025-660000038</td><td>LAMOREAUX, DANIEL J &</td><td>2</td><td>201,093</td><td>1000</td><td>20,264</td><td>1,622.00</td></tr> <tr><td>2024</td><td>2024-660000038</td><td>LAMOREAUX, DANIEL J &</td><td>2</td><td>209,536</td><td>1000</td><td>19,645</td><td>1,580.00</td></tr> <tr><td>2023</td><td>2023-660000038</td><td>LAMOREAUX, DANIEL J &</td><td>2</td><td>182,214</td><td>1000</td><td>19,043</td><td>1,534.00</td></tr> <tr><td>2022</td><td>2022-660000038</td><td>LAMOREAUX, DANIEL J &</td><td>2</td><td>182,278</td><td>1000</td><td>18,334</td><td>1,487.00</td></tr> <tr><td>2021</td><td>2021-660000038</td><td>LAMOREAUX, DANIEL J &</td><td>2</td><td>182,981</td><td>1000</td><td>17,771</td><td>1,424.00</td></tr> <tr><td>2020</td><td>2020-660000038</td><td>LAMOREAUX, DANIEL J &</td><td>2</td><td>171,232</td><td>1000</td><td>17,224</td><td>1,391.00</td></tr> <tr><td>2019</td><td>2019-660000038</td><td>LAMOREAUX, DANIEL J &</td><td>2</td><td>160,849</td><td>1000</td><td>16,693</td><td>1,379.00</td></tr> <tr><td>2018</td><td>2018-660000038</td><td>LAMOREAUX, DANIEL J &</td><td>2</td><td>165,023</td><td>1000</td><td>17,152</td><td>1,432.00</td></tr> <tr><td>2017</td><td>2017-660000038</td><td>LITTLEFIELD, WILLA MAE</td><td>2</td><td>139,968</td><td>1000</td><td>8,482</td><td>714.00</td></tr> <tr><td>2016</td><td>2016-660000038</td><td>LITTLEFIELD, LESTER D JR</td><td>2</td><td>136,893</td><td>1000</td><td>8,482</td><td>722.00</td></tr> <tr><td>2015</td><td>2015-660000038</td><td>LITTLEFIELD, LESTER D JR</td><td>2</td><td>135,573</td><td>1000</td><td>8,482</td><td>736.00</td></tr> <tr><td>2014</td><td>2014-660000038</td><td>LITTLEFIELD, LESTER D JR</td><td>2</td><td>136,738</td><td>1000</td><td>8,482</td><td>762.00</td></tr> <tr><td>2013</td><td>2013-660000038</td><td>LITTLEFIELD, LESTER D JR</td><td>2</td><td>129,349</td><td>1000</td><td>8,481</td><td>714.00</td></tr> </tbody> </table>										Tax Year	Statement Number	Billed Owner	Tax Area	Total Value	Exemptions	Taxable Value	Billed Tax	2025	2025-660000038	LAMOREAUX, DANIEL J &	2	201,093	1000	20,264	1,622.00	2024	2024-660000038	LAMOREAUX, DANIEL J &	2	209,536	1000	19,645	1,580.00	2023	2023-660000038	LAMOREAUX, DANIEL J &	2	182,214	1000	19,043	1,534.00	2022	2022-660000038	LAMOREAUX, DANIEL J &	2	182,278	1000	18,334	1,487.00	2021	2021-660000038	LAMOREAUX, DANIEL J &	2	182,981	1000	17,771	1,424.00	2020	2020-660000038	LAMOREAUX, DANIEL J &	2	171,232	1000	17,224	1,391.00	2019	2019-660000038	LAMOREAUX, DANIEL J &	2	160,849	1000	16,693	1,379.00	2018	2018-660000038	LAMOREAUX, DANIEL J &	2	165,023	1000	17,152	1,432.00	2017	2017-660000038	LITTLEFIELD, WILLA MAE	2	139,968	1000	8,482	714.00	2016	2016-660000038	LITTLEFIELD, LESTER D JR	2	136,893	1000	8,482	722.00	2015	2015-660000038	LITTLEFIELD, LESTER D JR	2	135,573	1000	8,482	736.00	2014	2014-660000038	LITTLEFIELD, LESTER D JR	2	136,738	1000	8,482	762.00	2013	2013-660000038	LITTLEFIELD, LESTER D JR	2	129,349	1000	8,481	714.00
Tax Year	Statement Number	Billed Owner	Tax Area	Total Value	Exemptions	Taxable Value	Billed Tax																																																																																																																		
2025	2025-660000038	LAMOREAUX, DANIEL J &	2	201,093	1000	20,264	1,622.00																																																																																																																		
2024	2024-660000038	LAMOREAUX, DANIEL J &	2	209,536	1000	19,645	1,580.00																																																																																																																		
2023	2023-660000038	LAMOREAUX, DANIEL J &	2	182,214	1000	19,043	1,534.00																																																																																																																		
2022	2022-660000038	LAMOREAUX, DANIEL J &	2	182,278	1000	18,334	1,487.00																																																																																																																		
2021	2021-660000038	LAMOREAUX, DANIEL J &	2	182,981	1000	17,771	1,424.00																																																																																																																		
2020	2020-660000038	LAMOREAUX, DANIEL J &	2	171,232	1000	17,224	1,391.00																																																																																																																		
2019	2019-660000038	LAMOREAUX, DANIEL J &	2	160,849	1000	16,693	1,379.00																																																																																																																		
2018	2018-660000038	LAMOREAUX, DANIEL J &	2	165,023	1000	17,152	1,432.00																																																																																																																		
2017	2017-660000038	LITTLEFIELD, WILLA MAE	2	139,968	1000	8,482	714.00																																																																																																																		
2016	2016-660000038	LITTLEFIELD, LESTER D JR	2	136,893	1000	8,482	722.00																																																																																																																		
2015	2015-660000038	LITTLEFIELD, LESTER D JR	2	135,573	1000	8,482	736.00																																																																																																																		
2014	2014-660000038	LITTLEFIELD, LESTER D JR	2	136,738	1000	8,482	762.00																																																																																																																		
2013	2013-660000038	LITTLEFIELD, LESTER D JR	2	129,349	1000	8,481	714.00																																																																																																																		



Rogers

Assessment Property Record Card for Tax Year 2026

Data provided by LISA DELOZIER County Assessor

Date 04/17/2026
Time 03:14:30
Page 2

Lot Data		Square-Foot - NBHD 1916 #1		Primary Image				
Lot Size				<p>\\tsclient\C\Users\Randy Necessary\Pictures\101_0913\IMG_0018. 9/17/2021</p>				
Lot Count								
Units Buildable	4							
Non-Ag Acres	4.0556							
Topography								
Street Access								
Utilities								
Amenities	LAND QUALITY	1						
Method	Square-Foot							
Base Lot Value	176,662.00 x .48 = 84,096							
Factor Value	21,024							
Adjustments								
Lot Value	105,120							
Residential Data								
Type	1 Single Family Residence							
Condition	4 - Good							
Quality	3 - Average							
Architecture	TRAD TRADITIONAL							
Style	100% One Story							
Exterior Wall	100% Veneer, Masonry							
Base/Total Area	1,579 / 1,579							
Style	100% One Story							
HVAC	100% Warmed & Cooled Air							
Roof Cover	4 Metal, Preformed							
Area on Slab	1,579							
Fixture/RghIn	11 /							
Bed/F/H Bath	3 / 2.0 /							
Basement Area								
Garage Type	480 Attached Garage - Finished							
Remodel								
Year/Eff Age	1973 / 32							
Cost Approach		Manual : 01/2025						
Base Cost	112,73	Total Misc Impr	+	12,794				
Roofing Adj	+ 5.78	Garage Cost	+	19,330				
Subfloor Adj	+ -2.31	Total RCN	=	251,084				
Heat/Cool Adj	+ 12.64	Depreciation (40%)	-	100,434				
Plumbing Adj	+ 9.83	Lump Sums	+	0				
Basement Adj	+ 0.00	RCNLD	=	150,650				
Adj Base Cost	= 138.67	Lot Value	+	105,120				
Total Area	x 1,579	Indicated Value	=	255,770				
Adjusted Cost	= 218,960	Value Per SqFt		161.98				
Value Reconciliation								
Selected Approach		Cost Approach						
Improvements	150,650							
Lot Value	105,120							
Indicated Value	255,770	161.98	Per SqFt					
Agland Value								
Site Improvements	12,590							
Total Value	268,360	169.96	Total Value Per SqFt					
Miscellaneous Improvements								
Code	Description	Sketch ID	Size	Year	Units	Unit Cost	Depr	Value
FPR1	FIREPLACE - RESIDENTIAL 1 STORY	0		1	1	5,615.40		5,615
SHLT	STORM SHELTER	0		1	2021	0.00		
PRCH	Porch	103		99	99	26.62		2,635
CPDT	Carport - Detached	104	20x20		400	11.36		4,544



Rogers

Assessment Property Record Card for Tax Year 2026

Data provided by LISA DELOZIER County Assessor

Date 04/17/2026

Time 03:14:30

Page 3

Sketch Image

660000038

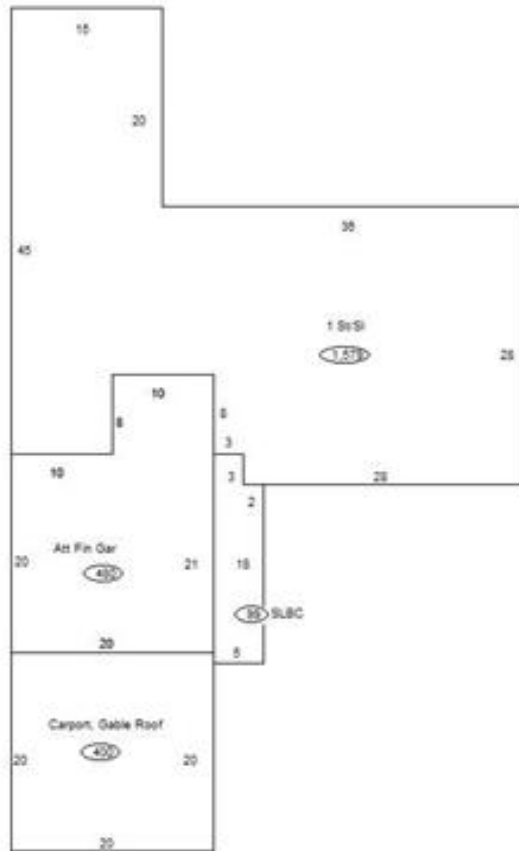

Sketch Vector Information

Sequence	Code	Type	Built Over	Scale	Section Label	Base Area	Multiplier	Total Area
1	R	1	Slab	13	1 St/Sl	1,579	1.000	1,579
2	G	5		13	Att Fin Gar	480	1.000	480
3	M	PRCH		13	SLBC	99	1.000	99
4	G	3		13	Carport, Gable Roof	400	1.000	400
Total Building Area						1,579		1,579



Rogers

Assessment Property Record Card for Tax Year 2026

Data provided by LISA DELOZIER County Assessor

Date 04/17/2026
Time 03:14:30
Page 4

660000038

Outbuildings/Site Improvements

Building Image	Code	Description	Dimensions	Floor	Roofing	Total Units
	SHDS	Shed - Small	10x20x6	Plank	Formed Metal	200
	Qual	3.5	Cond 3	Year 2010	Eff Age 12	

Valuation Summary		Modifier Total	RCN	Depr (46% Phys/ % Func)	RCNLD
Base Cost (24.53 x 200)	4,906		4,906	2,257	2,649

UTIL	Utility Building	30x16x10	Concrete	Formed Metal	480
Qual	3	Cond 3	Year 2003	Eff Age 17	

Valuation Summary		Modifier Total	RCN	Depr (40% Phys/ % Func)	RCNLD
Base Cost (31.86 x 480)	15,293		15,293	6,117	9,176

CPDT	Carport - Detached	14x25x0	Gravel	Formed Metal	350
Qual	3	Cond 3	Year 2000	Eff Age 20	

Valuation Summary		Modifier Total	RCN	Depr (69% Phys/ % Func)	RCNLD
Base Cost (7.05 x 350)	2,468		2,468	1,703	765