



Rogers

Assessment Property Record Card for Tax Year 2026

Data provided by LISA DELOZIER County Assessor

Date 04/17/2026
 Time 02:20:50
 Page 1

Assessment Data					Primary Image																																																																																																																				
Account 660000105 Parcel ID 000000-00-0-00357-001-0001 Cadastral ID 01-20-15-03610 Property Type REAL - Real Property Property Class RRP VI Area 3 Tax Area 4 - VERDIGRIS/VERD FIRE Name ID 172184 HILL, CARL E AND IRMA J 9988 E MIRAGE LN CLAREMORE OK 74019-0000 Parcel Location Situs 09988 MIRAGE LN Subdivision GREEN OASIS Lot/Block 0001 / 0001 Parcel Size 1 - Lots Sec/Twn/Rng 1 / 20 / 15 / 5 Neighborhood 1083 - R-V01-SW CLAREMORE School District S008 - VERDIGRIS SCHOOLS																																																																																																																									
Legal Description Lot/Long: 36.23855086 -95.65541813																																																																																																																									
LOT 1 BLOCK 1 GREEN OASIS					Building Permits <table border="1"> <thead> <tr> <th>Number</th> <th>Description</th> <th>Opened</th> <th>Closed</th> <th>Amount</th> </tr> </thead> <tbody> <tr> <td> </td> <td> </td> <td> </td> <td> </td> <td> </td> </tr> </tbody> </table>					Number	Description	Opened	Closed	Amount																																																																																																											
Number	Description	Opened	Closed	Amount																																																																																																																					
Exemptions <table border="1"> <thead> <tr> <th>Code</th> <th>Type</th> <th>Active</th> <th>Maximum</th> <th>Exemption</th> </tr> </thead> <tbody> <tr> <td>H</td> <td>Homestead</td> <td>Yes</td> <td>1,000</td> <td>1,000</td> </tr> </tbody> </table>					Code	Type	Active	Maximum	Exemption	H	Homestead	Yes	1,000	1,000	Sale History <table border="1"> <thead> <tr> <th>Bk/Pg</th> <th>Grantor</th> <th>Date</th> <th>Price</th> <th>Code</th> </tr> </thead> <tbody> <tr> <td> </td> <td> </td> <td> </td> <td> </td> <td> </td> </tr> </tbody> </table>					Bk/Pg	Grantor	Date	Price	Code																																																																																																	
Code	Type	Active	Maximum	Exemption																																																																																																																					
H	Homestead	Yes	1,000	1,000																																																																																																																					
Bk/Pg	Grantor	Date	Price	Code																																																																																																																					
Parcel Valuation <table border="1"> <thead> <tr> <th>Source</th> <th>REAL</th> <th>Fair Cash</th> <th>Capped</th> <th>Asmnt Level</th> <th>Assessed</th> <th>Levy Rate</th> <th>104.132</th> <th>Current Tax</th> </tr> </thead> <tbody> <tr> <td>Remove Cap</td> <td>0</td> <td>Land Value 58,279</td> <td>18,378</td> <td>11%</td> <td>2,022</td> <td>Assessed</td> <td>14,754</td> <td>1,536.36</td> </tr> <tr> <td>Year Frozen</td> <td>0</td> <td>Improvements 175,920</td> <td>115,745</td> <td></td> <td>12,732</td> <td>Penalty</td> <td>0</td> <td></td> </tr> <tr> <td>Uncapped Value</td> <td>0</td> <td>Mobile Home 0</td> <td>0</td> <td></td> <td>0</td> <td>Exemption</td> <td>1,000</td> <td>-87.00</td> </tr> <tr> <td>TIF Project ID</td> <td>0</td> <td>Total Value 234,199</td> <td>134,123</td> <td></td> <td>14,754</td> <td>Total Taxable</td> <td>13,754</td> <td>1,449.00</td> </tr> </tbody> </table>										Source	REAL	Fair Cash	Capped	Asmnt Level	Assessed	Levy Rate	104.132	Current Tax	Remove Cap	0	Land Value 58,279	18,378	11%	2,022	Assessed	14,754	1,536.36	Year Frozen	0	Improvements 175,920	115,745		12,732	Penalty	0		Uncapped Value	0	Mobile Home 0	0		0	Exemption	1,000	-87.00	TIF Project ID	0	Total Value 234,199	134,123		14,754	Total Taxable	13,754	1,449.00																																																																			
Source	REAL	Fair Cash	Capped	Asmnt Level	Assessed	Levy Rate	104.132	Current Tax																																																																																																																	
Remove Cap	0	Land Value 58,279	18,378	11%	2,022	Assessed	14,754	1,536.36																																																																																																																	
Year Frozen	0	Improvements 175,920	115,745		12,732	Penalty	0																																																																																																																		
Uncapped Value	0	Mobile Home 0	0		0	Exemption	1,000	-87.00																																																																																																																	
TIF Project ID	0	Total Value 234,199	134,123		14,754	Total Taxable	13,754	1,449.00																																																																																																																	
Assessment History <table border="1"> <thead> <tr> <th>Tax Year</th> <th>Statement Number</th> <th>Billed Owner</th> <th>Tax Area</th> <th>Total Value</th> <th>Exemptions</th> <th>Taxable Value</th> <th>Billed Tax</th> </tr> </thead> <tbody> <tr><td>2025</td><td>2025-660000105</td><td>HILL, CARL E AND IRMA J</td><td>4</td><td>220,386</td><td>1000</td><td>13,324</td><td>1,404.00</td></tr> <tr><td>2024</td><td>2024-660000105</td><td>HILL, CARL E AND IRMA J</td><td>4</td><td>225,668</td><td>1000</td><td>12,907</td><td>1,247.00</td></tr> <tr><td>2023</td><td>2023-660000105</td><td>HILL, CARL E</td><td>4</td><td>172,274</td><td>1000</td><td>12,502</td><td>1,190.00</td></tr> <tr><td>2022</td><td>2022-660000105</td><td>HILL, CARL E</td><td>4</td><td>174,788</td><td>1000</td><td>11,727</td><td>1,137.00</td></tr> <tr><td>2021</td><td>2021-660000105</td><td>HILL, CARL E</td><td>4</td><td>179,436</td><td>1000</td><td>11,356</td><td>1,073.00</td></tr> <tr><td>2020</td><td>2020-660000105</td><td>HILL, CARL E</td><td>4</td><td>178,519</td><td>1000</td><td>10,997</td><td>1,042.00</td></tr> <tr><td>2019</td><td>2019-660000105</td><td>HILL, CARL E</td><td>4</td><td>169,697</td><td>1000</td><td>10,647</td><td>1,024.00</td></tr> <tr><td>2018</td><td>2018-660000105</td><td>HILL, CARL E</td><td>4</td><td>174,716</td><td>1000</td><td>10,308</td><td>992.00</td></tr> <tr><td>2017</td><td>2017-660000105</td><td>HILL, CARL E</td><td>4</td><td>173,283</td><td>1000</td><td>9,979</td><td>964.00</td></tr> <tr><td>2016</td><td>2016-660000105</td><td>HILL, CARL E</td><td>4</td><td>168,774</td><td>1000</td><td>9,659</td><td>936.00</td></tr> <tr><td>2015</td><td>2015-660000105</td><td>HILL, CARL E</td><td>4</td><td>164,410</td><td>1000</td><td>9,348</td><td>913.00</td></tr> <tr><td>2014</td><td>2014-660000105</td><td>HILL, CARL E</td><td>4</td><td>167,489</td><td>1000</td><td>9,047</td><td>838.00</td></tr> <tr><td>2013</td><td>2013-660000105</td><td>HILL, CARL E</td><td>4</td><td>153,063</td><td>1000</td><td>8,754</td><td>839.00</td></tr> </tbody> </table>										Tax Year	Statement Number	Billed Owner	Tax Area	Total Value	Exemptions	Taxable Value	Billed Tax	2025	2025-660000105	HILL, CARL E AND IRMA J	4	220,386	1000	13,324	1,404.00	2024	2024-660000105	HILL, CARL E AND IRMA J	4	225,668	1000	12,907	1,247.00	2023	2023-660000105	HILL, CARL E	4	172,274	1000	12,502	1,190.00	2022	2022-660000105	HILL, CARL E	4	174,788	1000	11,727	1,137.00	2021	2021-660000105	HILL, CARL E	4	179,436	1000	11,356	1,073.00	2020	2020-660000105	HILL, CARL E	4	178,519	1000	10,997	1,042.00	2019	2019-660000105	HILL, CARL E	4	169,697	1000	10,647	1,024.00	2018	2018-660000105	HILL, CARL E	4	174,716	1000	10,308	992.00	2017	2017-660000105	HILL, CARL E	4	173,283	1000	9,979	964.00	2016	2016-660000105	HILL, CARL E	4	168,774	1000	9,659	936.00	2015	2015-660000105	HILL, CARL E	4	164,410	1000	9,348	913.00	2014	2014-660000105	HILL, CARL E	4	167,489	1000	9,047	838.00	2013	2013-660000105	HILL, CARL E	4	153,063	1000	8,754	839.00
Tax Year	Statement Number	Billed Owner	Tax Area	Total Value	Exemptions	Taxable Value	Billed Tax																																																																																																																		
2025	2025-660000105	HILL, CARL E AND IRMA J	4	220,386	1000	13,324	1,404.00																																																																																																																		
2024	2024-660000105	HILL, CARL E AND IRMA J	4	225,668	1000	12,907	1,247.00																																																																																																																		
2023	2023-660000105	HILL, CARL E	4	172,274	1000	12,502	1,190.00																																																																																																																		
2022	2022-660000105	HILL, CARL E	4	174,788	1000	11,727	1,137.00																																																																																																																		
2021	2021-660000105	HILL, CARL E	4	179,436	1000	11,356	1,073.00																																																																																																																		
2020	2020-660000105	HILL, CARL E	4	178,519	1000	10,997	1,042.00																																																																																																																		
2019	2019-660000105	HILL, CARL E	4	169,697	1000	10,647	1,024.00																																																																																																																		
2018	2018-660000105	HILL, CARL E	4	174,716	1000	10,308	992.00																																																																																																																		
2017	2017-660000105	HILL, CARL E	4	173,283	1000	9,979	964.00																																																																																																																		
2016	2016-660000105	HILL, CARL E	4	168,774	1000	9,659	936.00																																																																																																																		
2015	2015-660000105	HILL, CARL E	4	164,410	1000	9,348	913.00																																																																																																																		
2014	2014-660000105	HILL, CARL E	4	167,489	1000	9,047	838.00																																																																																																																		
2013	2013-660000105	HILL, CARL E	4	153,063	1000	8,754	839.00																																																																																																																		



Rogers

Assessment Property Record Card for Tax Year 2026

Data provided by LISA DELOZIER County Assessor

Date 04/17/2026
Time 02:20:50
Page 2

Lot Data	Square-Foot - NBHD 1083 #1	Primary Image
Lot Size Lot Count Units Buildable 1 Non-Ag Acres 1.6693 Topography Street Access Utilities Amenities LAND QUALITY 0 0 Method Square-Foot Base Lot Value 72,717.00 x 1.07 = 77,705 Factor Value Adjustments 0.7500 Lot Value 58,279		

Residential Data	
Type	1 Single Family Residence
Condition	3 - Average
Quality	3 - Average
Architecture	TRAD TRADITIONAL
Style	100% One Story
Exterior Wall	50% Veneer, Masonry 50% Frame, Siding, Wood
Base/Total Area	2,339 / 2,339
Style	100% One Story
HVAC	100% Warmed & Cooled Air
Roof Cover	1 Composition Shingle
Area on Slab	2,339
Fixture/RghIn	15 /
Bed/F/H Bath	3 / 2.0 /
Basement Area	
Garage Type	
Remodel	
Year/Eff Age	1978 / 36

660000105_001.JPG	9/24/2025
-------------------	-----------

GRM Approach	
GRM Code	
Gross Rent	0.00
Indicated Value	

Multiple Regression			
MRA Code	1	Test	
Adusted R	0.8445		
Indicated Value	200,042	85.52	Per SqFt

Direct Comparables			
Selection Model	A	Adam Test	
Adjustment Model	1	2022 Residential	
Comparables	6		
Indicated Value	233,640		Per SqFt

Value Reconciliation			
Selected Approach	Cost Approach		
Improvements	172,916		
Lot Value	58,279		
Indicated Value	231,195	98.84	Per SqFt
Agland Value			
Site Improvements	3,004		
Total Value	234,199	100.13	Total Value Per SqFt

Cost Approach				Manual : 01/2025			
Base Cost	100.21	Total Misc Impr	+ 13,022				
Roofing Adj	+ 4.55	Garage Cost	+ 0				
Subfloor Adj	+ -2.19	Total RCN	= 303,362				
Heat/Cool Adj	+ 12.64	Depreciation (43%)	- 130,446				
Plumbing Adj	+ 8.92	Lump Sums	+ 0				
Basement Adj	+ 0.00	RCNLD	= 172,916				
Adj Base Cost	= 124.13	Lot Value	+ 58,279				
Total Area	x 2,339	Indicated Value	= 231,195				
Adjusted Cost	= 290,340	Value Per SqFt	98.84				

Miscellaneous Improvements								
Code	Description	Sketch ID	Size	Year	Units	Unit Cost	Depr	Value
FPR1	FIREPLACE - RESIDENTIAL 1 STORY	0		1	1	5,615.40		5,615
PRCH	SLAB PORCH - COVERED	274		100	100	26.62		2,662
PRCH	SLAB PORCH - COVERED	275	18x10		180	26.36		4,745



Rogers
Assessment Property Record Card for Tax Year 2026

Data provided by LISA DELOZIER County Assessor

Date 04/17/2026
 Time 02:20:50
 Page 3

Sketch Image

660000105

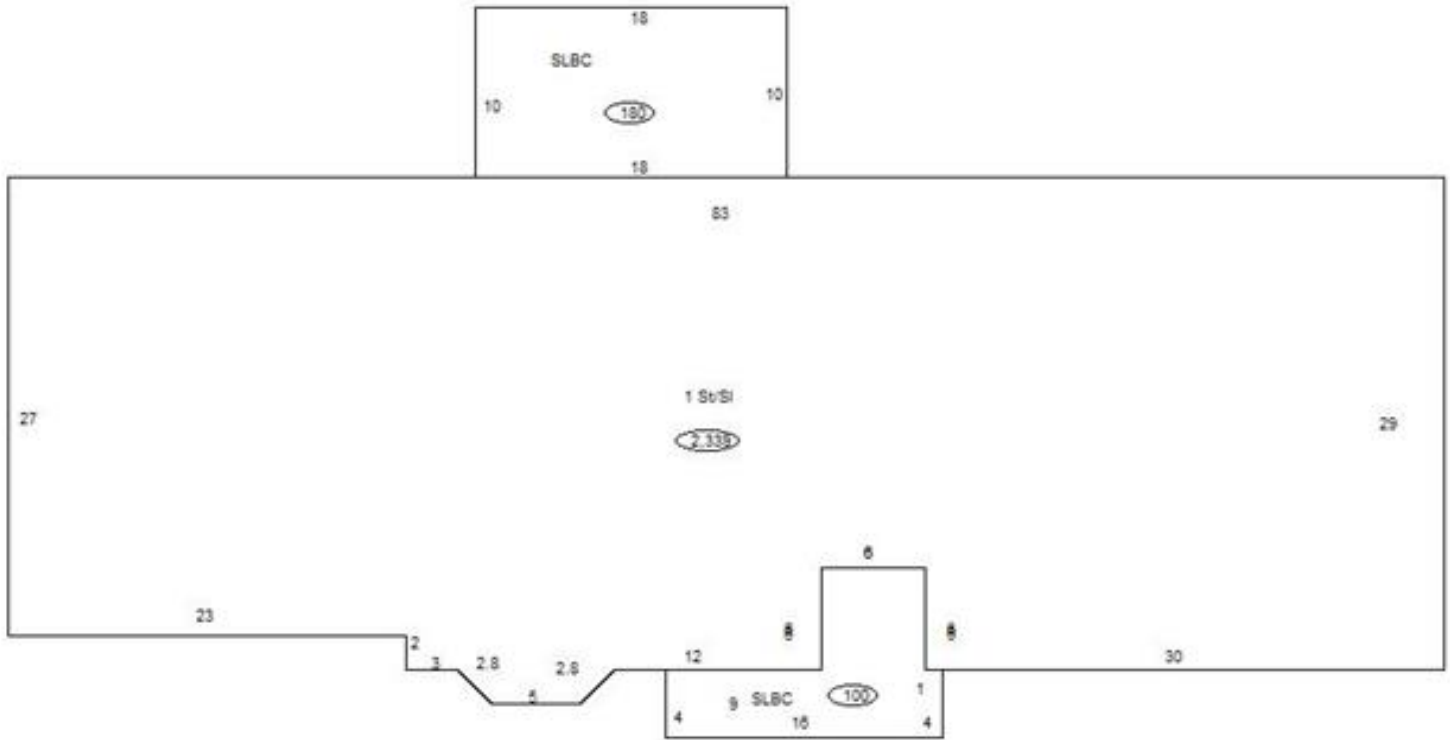

Sketch Vector Information

Sequence	Code	Type	Built Over	Scale	Section Label	Base Area	Multiplier	Total Area
1	R	1	Slab	10	1 St/SI	2,339	1.000	2,339
2	M	PRCH		10	SLBC	100	1.000	100
3	M	PRCH		10	SLBC	180	1.000	180
Total Building Area						2,339		2,339



Rogers



Assessment Property Record Card for Tax Year 2026

Data provided by LISA DELOZIER County Assessor

Date 04/17/2026
Time 02:20:50
Page 4

660000105

Outbuildings/Site Improvements

Building Image	Code	Description	Dimensions	Floor	Roofing	Total Units
	SHDS	Shed - Small	12x14x8	Plank	Composition Shingle	168
	Qual	3	Cond 3	Year 2010	Eff Age 12	
	Valuation Summary		Modifier Total	RCN	Depr (46% Phys/ % Func)	RCNLD
	Base Cost (24.35 x 168)		4,091	4,091	1,882	2,209
	WODO	Wood Deck - Open	0x0x0	Plank		77
	Qual	2	Cond 2	Year 2010	Eff Age 16	
	Valuation Summary		Modifier Total	RCN	Depr (59% Phys/ % Func)	RCNLD
	Base Cost (25.20 x 77)		1,940	1,940	1,145	795