



Rogers

Assessment Property Record Card for Tax Year 2026

Data provided by LISA DELOZIER County Assessor

Date 04/17/2026
 Time 18:26:57
 Page 1

Assessment Data					Primary Image																																																																																																																				
Account 660000246 Parcel ID 000000-00-0-00738-001-0025 Cadastral ID 01-20-15-05030 Property Type REAL - Real Property Property Class URP VI Area 3 Tax Area 80 - VERDIGRIS TOWN/ VERDIGRI Name ID 301864 ACCONGIO, CHRISTOPHER J REVOCABLE LIVING TRUST 25354 S HOLIDAY DR CLAREMORE OK 74019-0000 Parcel Location Situs 25354 S HOLLIDAY DR Subdivision SHEPHERD VALLEY Lot/Block 0025 / 0001 Parcel Size 1 - Lots Sec/Twn/Rng 1 / 20 / 15 / 5 Neighborhood 1117 - R-V04-SW VERDIGRIS School District S008 - VERDIGRIS SCHOOLS					<p>660000246_001.JPG 9/25/2025</p>																																																																																																																				
Legal Description Lot/Long: 36.24450059 -95.66895192																																																																																																																									
Building Permits <table border="1"> <thead> <tr> <th>Number</th> <th>Description</th> <th>Opened</th> <th>Closed</th> <th>Amount</th> </tr> </thead> <tbody> <tr> <td colspan="5"> </td> </tr> </tbody> </table>					Number	Description	Opened	Closed	Amount																																																																																																																
Number	Description	Opened	Closed	Amount																																																																																																																					
Exemptions <table border="1"> <thead> <tr> <th>Code</th> <th>Type</th> <th>Active</th> <th>Maximum</th> <th>Exemption</th> </tr> </thead> <tbody> <tr> <td>H</td> <td>Homestead</td> <td>Yes</td> <td>1,000</td> <td>1,000</td> </tr> </tbody> </table>					Code	Type	Active	Maximum	Exemption	H	Homestead	Yes	1,000	1,000	Sale History <table border="1"> <thead> <tr> <th>Bk/Pg</th> <th>Grantor</th> <th>Date</th> <th>Price</th> <th>Code</th> </tr> </thead> <tbody> <tr> <td>2072/806</td> <td>STRICKLAND, JOYCE M</td> <td>11/23/2009</td> <td>165,000</td> <td>YES</td> </tr> <tr> <td>1865/795</td> <td>SMITH, MICHAEL J &</td> <td>05/07/2007</td> <td>0</td> <td>4</td> </tr> <tr> <td>929/855</td> <td>DAVIS, JOHN K JR &</td> <td>09/22/1993</td> <td>105,000</td> <td>Yes</td> </tr> <tr> <td>906/730</td> <td>VERDIGRIS VALLEY~CONSTRUCTION</td> <td>01/29/1993</td> <td>10,500</td> <td>Yes</td> </tr> <tr> <td>858/374</td> <td></td> <td></td> <td>190,000</td> <td>No</td> </tr> </tbody> </table>					Bk/Pg	Grantor	Date	Price	Code	2072/806	STRICKLAND, JOYCE M	11/23/2009	165,000	YES	1865/795	SMITH, MICHAEL J &	05/07/2007	0	4	929/855	DAVIS, JOHN K JR &	09/22/1993	105,000	Yes	906/730	VERDIGRIS VALLEY~CONSTRUCTION	01/29/1993	10,500	Yes	858/374			190,000	No																																																																								
Code	Type	Active	Maximum	Exemption																																																																																																																					
H	Homestead	Yes	1,000	1,000																																																																																																																					
Bk/Pg	Grantor	Date	Price	Code																																																																																																																					
2072/806	STRICKLAND, JOYCE M	11/23/2009	165,000	YES																																																																																																																					
1865/795	SMITH, MICHAEL J &	05/07/2007	0	4																																																																																																																					
929/855	DAVIS, JOHN K JR &	09/22/1993	105,000	Yes																																																																																																																					
906/730	VERDIGRIS VALLEY~CONSTRUCTION	01/29/1993	10,500	Yes																																																																																																																					
858/374			190,000	No																																																																																																																					
Parcel Valuation <table border="1"> <thead> <tr> <th>Source</th> <th>REAL</th> <th>Fair Cash</th> <th>Capped</th> <th>Asmnt Level</th> <th>Assessed</th> <th>Levy Rate</th> <th>104.132</th> <th>Current Tax</th> </tr> </thead> <tbody> <tr> <td>Remove Cap</td> <td>2010</td> <td>Land Value 32,955</td> <td>24,991</td> <td>11%</td> <td>2,749</td> <td>Assessed</td> <td>23,018</td> <td>2,396.91</td> </tr> <tr> <td>Year Frozen</td> <td>2024</td> <td>Improvements 242,984</td> <td>184,265</td> <td></td> <td>20,269</td> <td>Penalty</td> <td>0</td> <td></td> </tr> <tr> <td>Uncapped Value</td> <td>0</td> <td>Mobile Home 0</td> <td>0</td> <td></td> <td>0</td> <td>Exemption</td> <td>1,000</td> <td>-87.00</td> </tr> <tr> <td>TIF Project ID</td> <td>0</td> <td>Total Value 275,939</td> <td>209,256</td> <td></td> <td>23,018</td> <td>Total Taxable</td> <td>22,018</td> <td>2,310.00</td> </tr> </tbody> </table>										Source	REAL	Fair Cash	Capped	Asmnt Level	Assessed	Levy Rate	104.132	Current Tax	Remove Cap	2010	Land Value 32,955	24,991	11%	2,749	Assessed	23,018	2,396.91	Year Frozen	2024	Improvements 242,984	184,265		20,269	Penalty	0		Uncapped Value	0	Mobile Home 0	0		0	Exemption	1,000	-87.00	TIF Project ID	0	Total Value 275,939	209,256		23,018	Total Taxable	22,018	2,310.00																																																																			
Source	REAL	Fair Cash	Capped	Asmnt Level	Assessed	Levy Rate	104.132	Current Tax																																																																																																																	
Remove Cap	2010	Land Value 32,955	24,991	11%	2,749	Assessed	23,018	2,396.91																																																																																																																	
Year Frozen	2024	Improvements 242,984	184,265		20,269	Penalty	0																																																																																																																		
Uncapped Value	0	Mobile Home 0	0		0	Exemption	1,000	-87.00																																																																																																																	
TIF Project ID	0	Total Value 275,939	209,256		23,018	Total Taxable	22,018	2,310.00																																																																																																																	
Assessment History <table border="1"> <thead> <tr> <th>Tax Year</th> <th>Statement Number</th> <th>Billed Owner</th> <th>Tax Area</th> <th>Total Value</th> <th>Exemptions</th> <th>Taxable Value</th> <th>Billed Tax</th> </tr> </thead> <tbody> <tr><td>2025</td><td>2025-660000246</td><td>ACCONGIO, CHRISTOPHER J</td><td>80</td><td>261,842</td><td>1000</td><td>22,018</td><td>2,309.00</td></tr> <tr><td>2024</td><td>2024-660000246</td><td>ACCONGIO, CHRISTOPHER J</td><td>80</td><td>282,264</td><td>1000</td><td>22,018</td><td>2,121.00</td></tr> <tr><td>2023</td><td>2023-660000246</td><td>ACCONGIO, CHRISTOPHER J</td><td>80</td><td>203,162</td><td>1000</td><td>21,348</td><td>2,025.00</td></tr> <tr><td>2022</td><td>2022-660000246</td><td>ACCONGIO, CHRISTOPHER J</td><td>80</td><td>200,642</td><td>1000</td><td>20,660</td><td>1,996.00</td></tr> <tr><td>2021</td><td>2021-660000246</td><td>ACCONGIO, CHRISTOPHER J</td><td>80</td><td>196,495</td><td>1000</td><td>20,029</td><td>1,885.00</td></tr> <tr><td>2020</td><td>2020-660000246</td><td>ACCONGIO, CHRISTOPHER J</td><td>80</td><td>188,110</td><td>1000</td><td>19,417</td><td>1,831.00</td></tr> <tr><td>2019</td><td>2019-660000246</td><td>ACCONGIO, CHRISTOPHER J</td><td>80</td><td>180,201</td><td>1000</td><td>18,822</td><td>1,803.00</td></tr> <tr><td>2018</td><td>2018-660000246</td><td>ACCONGIO, CHRISTOPHER J</td><td>80</td><td>187,774</td><td>1000</td><td>19,655</td><td>1,884.00</td></tr> <tr><td>2017</td><td>2017-660000246</td><td>ACCONGIO, CHRISTOPHER J</td><td>80</td><td>186,044</td><td>1000</td><td>19,465</td><td>1,870.00</td></tr> <tr><td>2016</td><td>2016-660000246</td><td>ACCONGIO, CHRISTOPHER J</td><td>80</td><td>180,898</td><td>1000</td><td>18,899</td><td>1,821.00</td></tr> <tr><td>2015</td><td>2015-660000246</td><td>ACCONGIO, CHRISTOPHER J</td><td>80</td><td>177,707</td><td>1000</td><td>18,548</td><td>1,801.00</td></tr> <tr><td>2014</td><td>2014-660000246</td><td>ACCONGIO, CHRISTOPHER J</td><td>80</td><td>184,294</td><td>1000</td><td>18,056</td><td>1,660.00</td></tr> <tr><td>2013</td><td>2013-660000246</td><td>ACCONGIO, CHRISTOPHER J</td><td>80</td><td>174,053</td><td>1000</td><td>17,501</td><td>1,668.00</td></tr> </tbody> </table>										Tax Year	Statement Number	Billed Owner	Tax Area	Total Value	Exemptions	Taxable Value	Billed Tax	2025	2025-660000246	ACCONGIO, CHRISTOPHER J	80	261,842	1000	22,018	2,309.00	2024	2024-660000246	ACCONGIO, CHRISTOPHER J	80	282,264	1000	22,018	2,121.00	2023	2023-660000246	ACCONGIO, CHRISTOPHER J	80	203,162	1000	21,348	2,025.00	2022	2022-660000246	ACCONGIO, CHRISTOPHER J	80	200,642	1000	20,660	1,996.00	2021	2021-660000246	ACCONGIO, CHRISTOPHER J	80	196,495	1000	20,029	1,885.00	2020	2020-660000246	ACCONGIO, CHRISTOPHER J	80	188,110	1000	19,417	1,831.00	2019	2019-660000246	ACCONGIO, CHRISTOPHER J	80	180,201	1000	18,822	1,803.00	2018	2018-660000246	ACCONGIO, CHRISTOPHER J	80	187,774	1000	19,655	1,884.00	2017	2017-660000246	ACCONGIO, CHRISTOPHER J	80	186,044	1000	19,465	1,870.00	2016	2016-660000246	ACCONGIO, CHRISTOPHER J	80	180,898	1000	18,899	1,821.00	2015	2015-660000246	ACCONGIO, CHRISTOPHER J	80	177,707	1000	18,548	1,801.00	2014	2014-660000246	ACCONGIO, CHRISTOPHER J	80	184,294	1000	18,056	1,660.00	2013	2013-660000246	ACCONGIO, CHRISTOPHER J	80	174,053	1000	17,501	1,668.00
Tax Year	Statement Number	Billed Owner	Tax Area	Total Value	Exemptions	Taxable Value	Billed Tax																																																																																																																		
2025	2025-660000246	ACCONGIO, CHRISTOPHER J	80	261,842	1000	22,018	2,309.00																																																																																																																		
2024	2024-660000246	ACCONGIO, CHRISTOPHER J	80	282,264	1000	22,018	2,121.00																																																																																																																		
2023	2023-660000246	ACCONGIO, CHRISTOPHER J	80	203,162	1000	21,348	2,025.00																																																																																																																		
2022	2022-660000246	ACCONGIO, CHRISTOPHER J	80	200,642	1000	20,660	1,996.00																																																																																																																		
2021	2021-660000246	ACCONGIO, CHRISTOPHER J	80	196,495	1000	20,029	1,885.00																																																																																																																		
2020	2020-660000246	ACCONGIO, CHRISTOPHER J	80	188,110	1000	19,417	1,831.00																																																																																																																		
2019	2019-660000246	ACCONGIO, CHRISTOPHER J	80	180,201	1000	18,822	1,803.00																																																																																																																		
2018	2018-660000246	ACCONGIO, CHRISTOPHER J	80	187,774	1000	19,655	1,884.00																																																																																																																		
2017	2017-660000246	ACCONGIO, CHRISTOPHER J	80	186,044	1000	19,465	1,870.00																																																																																																																		
2016	2016-660000246	ACCONGIO, CHRISTOPHER J	80	180,898	1000	18,899	1,821.00																																																																																																																		
2015	2015-660000246	ACCONGIO, CHRISTOPHER J	80	177,707	1000	18,548	1,801.00																																																																																																																		
2014	2014-660000246	ACCONGIO, CHRISTOPHER J	80	184,294	1000	18,056	1,660.00																																																																																																																		
2013	2013-660000246	ACCONGIO, CHRISTOPHER J	80	174,053	1000	17,501	1,668.00																																																																																																																		



Rogers

Assessment Property Record Card for Tax Year 2026

Data provided by LISA DELOZIER County Assessor

Date 04/17/2026
 Time 18:26:58
 Page 2

Lot Data		Square-Foot - NBHD 1117 #1	
Lot Size			
Lot Count			
Units Buildable	1		
Non-Ag Acres	0.445		
Topography			
Street Access			
Utilities			
Amenities	LAND QUALITY	0	
		0	
Method	Square-Foot		
Base Lot Value	19,385.00 x 1.70 = 32,955		
Factor Value			
Adjustments	1.0000		
Lot Value	32,955		



Residential Data	
Type	1 Single Family Residence
Condition	3 - Average
Quality	3 - Average
Architecture	TRAD TRADITIONAL
Style	79% 1 1/2 Story Finished 21% 1 1/2 Story Unfinish
Exterior Wall	30% Veneer, Masonry 70% Frame, Siding, Vinyl
Base/Total Area	2,143 / 2,759
Style	79% 1 1/2 Story Finished - 21% 1 1/2 Story Unfinis
HVAC	100% Warmed & Cooled Air
Roof Cover	1 Composition Shingle
Area on Slab	1,563
Fixture/RghIn	17 /
Bed/F/H Bath	3 / 2.0 /
Basement Area	
Garage Type	620 Attached Garage - Finished 3 Stalls
Remodel	
Year/Eff Age	1993 / 25

GRM Approach	
GRM Code	
Gross Rent	0.00
Indicated Value	

Multiple Regression			
MRA Code	1	Test	
Adusted R	0.8445		
Indicated Value	302,362	109.59	Per SqFt

Direct Comparables	
Selection Model	A Adam Test
Adjustment Model	1 2022 Residential
Comparables	
Indicated Value	

Cost Approach				Manual : 01/2025	
Base Cost	90.59	Total Misc Impr	+	8,242	
Roofing Adj	+ 3.59	Garage Cost	+	23,641	
Subfloor Adj	+ -1.24	Total RCN	=	346,712	
Heat/Cool Adj	+ 12.64	Depreciation (31%)	-	107,481	
Plumbing Adj	+ 8.53	Lump Sums	+	0	
Basement Adj	+ 0.00	RCNLD	=	239,231	
Adj Base Cost	= 114.11	Lot Value	+	32,955	
Total Area	x 2,759	Indicated Value	=	272,186	
Adjusted Cost	= 314,829	Value Per SqFt		98.65	

Value Reconciliation			
Selected Approach	Cost Approach		
Improvements	239,231		
Lot Value	32,955		
Indicated Value	272,186	98.65	Per SqFt
Agland Value			
Site Improvements	3,753		
Total Value	275,939	100.01	Total Value Per SqFt

Miscellaneous Improvements								
Code	Description	Sketch ID	Size	Year	Units	Unit Cost	Depr	Value
FPR1	FIREPLACE - RESIDENTIAL 1 STORY	0		1	1	5,615.40		5,615
PRCH	SLAB PORCH - COVERED	775	10x4		40	26.80		1,072
PATO	SLAB PORCH - OPEN	778	140		140	11.11		1,555



Sketch Image

660000246

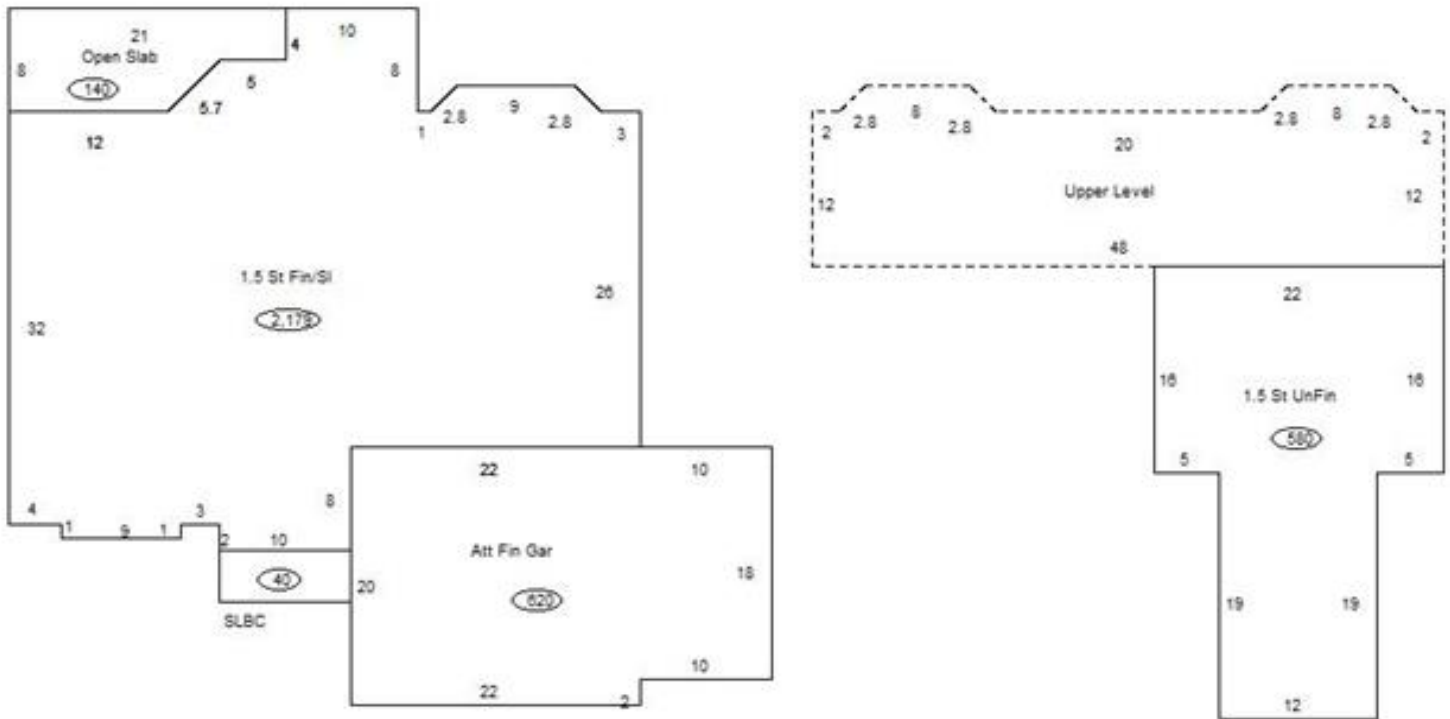

Sketch Vector Information

Sequence	Code	Type	Built Over	Scale	Section Label	Base Area	Multiplier	Total Area
1	R	5	Slab	13	1.5 St Fin/SI	1,563	1.394	2,179
2	G	5		13	Att Fin Gar	620	1.000	620
3	M	PRCH		13	SLBC	40	1.000	40
4	R	6		13	1.5 St UnFin	580	1.000	580
5	U	^UL	Overhang	13	Upper Level	616	1.000	616
6	M	PATO		13	Open Slab	140	1.000	140
Total Building Area						2,143		2,759



Rogers



Assessment Property Record Card for Tax Year 2026

Data provided by LISA DELOZIER County Assessor

Date 04/17/2026
Time 18:26:58
Page 4

660000246

Outbuildings/Site Improvements

Building Image	Code	Description	Dimensions	Floor	Roofing	Total Units
	SHDS	Shed - Small	10x12x8	Plank	Composition Shingle	120
	Qual	2	Cond 3	Year 2010	Eff Age 12	
	Valuation Summary		Modifier Total	RCN	Depr (46% Phys/ % Func)	RCNLD
	Base Cost (20.98 x 120)		2,518	2,518	1,158	1,360
	WODC	Wood Deck - Covered	12x10x8	Plank	Formed Metal	120
	Qual	3	Cond 3	Year 2010	Eff Age 12	
	Valuation Summary		Modifier Total	RCN	Depr (54% Phys/ % Func)	RCNLD
	Base Cost (43.35 x 120)		5,202	5,202	2,809	2,393