



# Rogers

## Assessment Property Record Card for Tax Year 2026

Data provided by LISA DELOZIER County Assessor

Date 04/17/2026  
Time 02:02:22  
Page 1

Assessment Data					Primary Image																																																																																																																				
<b>Account</b> 660000312 <b>Parcel ID</b> 000000-00-0-00738-005-0005 <b>Cadastral ID</b> 01-20-15-05690 <b>Property Type</b> REAL - Real Property <b>Property Class</b> URP VI Area 3 <b>Tax Area</b> 80 - VERDIGRIS TOWN/ VERDIGRI <b>Name ID</b> 282925 LEHO, LOUISE A  9324 E MULBERRY LN CLAREMORE OK 74019-0000  <b>Parcel Location</b> <b>Situs</b> 09324 E MULBERRY LN <b>Subdivision</b> SHEPHERD VALLEY <b>Lot/Block</b> 0005 / 0005 Parcel Size 1 - Lots <b>Sec/Twn/Rng</b> 1 / 20 / 15 / 5 <b>Neighborhood</b> 1117 - R-V04-SW VERDIGRIS <b>School District</b> S008 - VERDIGRIS SCHOOLS					<p>660000312_001.JPG 9/28/2025</p>																																																																																																																				
<b>Legal Description</b> Lot/Long: 36.24736564 -95.66582945 LOT 5 BLOCK 5 SHEPHERD VALLEY																																																																																																																									
<b>Exemptions</b> <table border="1"> <thead> <tr> <th>Code</th> <th>Type</th> <th>Active</th> <th>Maximum</th> <th>Exemption</th> </tr> </thead> <tbody> <tr> <td>H</td> <td>Homestead</td> <td>Yes</td> <td>1,000</td> <td>1,000</td> </tr> </tbody> </table>					Code	Type	Active	Maximum	Exemption	H	Homestead	Yes	1,000	1,000	<b>Building Permits</b> <table border="1"> <thead> <tr> <th>Number</th> <th>Description</th> <th>Opened</th> <th>Closed</th> <th>Amount</th> </tr> </thead> <tbody> <tr> <td></td> <td></td> <td></td> <td></td> <td></td> </tr> </tbody> </table>					Number	Description	Opened	Closed	Amount																																																																																																	
Code	Type	Active	Maximum	Exemption																																																																																																																					
H	Homestead	Yes	1,000	1,000																																																																																																																					
Number	Description	Opened	Closed	Amount																																																																																																																					
<b>Parcel Valuation</b> <table border="1"> <thead> <tr> <th>Source</th> <th>REAL</th> <th>Fair Cash</th> <th>Capped</th> <th>Asmnt Level</th> <th>Assessed</th> <th>Levy Rate</th> <th>104.132</th> <th>Current Tax</th> </tr> </thead> <tbody> <tr> <td>Remove Cap</td> <td>2004</td> <td>Land Value 28,679</td> <td>21,823</td> <td>11%</td> <td>2,401</td> <td>Assessed</td> <td>11,276</td> <td>1,174.19</td> </tr> <tr> <td>Year Frozen</td> <td>0</td> <td>Improvements 125,271</td> <td>80,682</td> <td></td> <td>8,875</td> <td>Penalty</td> <td>0</td> <td></td> </tr> <tr> <td>Uncapped Value</td> <td>0</td> <td>Mobile Home 0</td> <td>0</td> <td></td> <td>0</td> <td>Exemption</td> <td>1,000</td> <td>-87.00</td> </tr> <tr> <td>TIF Project ID</td> <td>0</td> <td>Total Value 153,950</td> <td>102,505</td> <td></td> <td>11,276</td> <td>Total Taxable</td> <td>10,276</td> <td>1,087.00</td> </tr> </tbody> </table>					Source	REAL	Fair Cash	Capped	Asmnt Level	Assessed	Levy Rate	104.132	Current Tax	Remove Cap	2004	Land Value 28,679	21,823	11%	2,401	Assessed	11,276	1,174.19	Year Frozen	0	Improvements 125,271	80,682		8,875	Penalty	0		Uncapped Value	0	Mobile Home 0	0		0	Exemption	1,000	-87.00	TIF Project ID	0	Total Value 153,950	102,505		11,276	Total Taxable	10,276	1,087.00	<b>Sale History</b> <table border="1"> <thead> <tr> <th>Bk/Pg</th> <th>Grantor</th> <th>Date</th> <th>Price</th> <th>Code</th> </tr> </thead> <tbody> <tr> <td>1491/544</td> <td>BEAMS, TINA DEE</td> <td>06/24/2003</td> <td>84,000</td> <td>YES</td> </tr> <tr> <td>899/318</td> <td>BEAMS, GEORGE R</td> <td>11/19/1992</td> <td>0</td> <td>No</td> </tr> </tbody> </table>					Bk/Pg	Grantor	Date	Price	Code	1491/544	BEAMS, TINA DEE	06/24/2003	84,000	YES	899/318	BEAMS, GEORGE R	11/19/1992	0	No																																																				
Source	REAL	Fair Cash	Capped	Asmnt Level	Assessed	Levy Rate	104.132	Current Tax																																																																																																																	
Remove Cap	2004	Land Value 28,679	21,823	11%	2,401	Assessed	11,276	1,174.19																																																																																																																	
Year Frozen	0	Improvements 125,271	80,682		8,875	Penalty	0																																																																																																																		
Uncapped Value	0	Mobile Home 0	0		0	Exemption	1,000	-87.00																																																																																																																	
TIF Project ID	0	Total Value 153,950	102,505		11,276	Total Taxable	10,276	1,087.00																																																																																																																	
Bk/Pg	Grantor	Date	Price	Code																																																																																																																					
1491/544	BEAMS, TINA DEE	06/24/2003	84,000	YES																																																																																																																					
899/318	BEAMS, GEORGE R	11/19/1992	0	No																																																																																																																					
<b>Assessment History</b> <table border="1"> <thead> <tr> <th>Tax Year</th> <th>Statement Number</th> <th>Billed Owner</th> <th>Tax Area</th> <th>Total Value</th> <th>Exemptions</th> <th>Taxable Value</th> <th>Billed Tax</th> </tr> </thead> <tbody> <tr><td>2025</td><td>2025-660000312</td><td>LEHO, LOUISE A</td><td>80</td><td>142,279</td><td>1000</td><td>9,948</td><td>1,052.00</td></tr> <tr><td>2024</td><td>2024-660000312</td><td>LEHO, LOUISE A</td><td>80</td><td>153,261</td><td>1000</td><td>9,629</td><td>933.00</td></tr> <tr><td>2023</td><td>2023-660000312</td><td>LEHO, LOUISE A</td><td>80</td><td>93,808</td><td>1000</td><td>9,319</td><td>890.00</td></tr> <tr><td>2022</td><td>2022-660000312</td><td>LEHO, LOUISE A</td><td>80</td><td>95,400</td><td>1000</td><td>9,494</td><td>923.00</td></tr> <tr><td>2021</td><td>2021-660000312</td><td>LEHO, LOUISE A</td><td>80</td><td>131,271</td><td>1000</td><td>12,931</td><td>1,221.00</td></tr> <tr><td>2020</td><td>2020-660000312</td><td>LEHO, LOUISE A</td><td>80</td><td>125,555</td><td>1000</td><td>12,526</td><td>1,185.00</td></tr> <tr><td>2019</td><td>2019-660000312</td><td>LEHO, LOUISE A</td><td>80</td><td>119,379</td><td>1000</td><td>12,132</td><td>1,166.00</td></tr> <tr><td>2018</td><td>2018-660000312</td><td>LEHO, LOUISE A</td><td>80</td><td>124,183</td><td>1000</td><td>11,983</td><td>1,153.00</td></tr> <tr><td>2017</td><td>2017-660000312</td><td>LEHO, LOUISE A</td><td>80</td><td>123,153</td><td>1000</td><td>11,604</td><td>1,119.00</td></tr> <tr><td>2016</td><td>2016-660000312</td><td>LEHO, LOUISE A</td><td>80</td><td>119,921</td><td>1000</td><td>11,237</td><td>1,087.00</td></tr> <tr><td>2015</td><td>2015-660000312</td><td>LEHO, LOUISE A</td><td>80</td><td>116,817</td><td>1000</td><td>10,881</td><td>1,061.00</td></tr> <tr><td>2014</td><td>2014-660000312</td><td>LEHO, LOUISE A</td><td>80</td><td>124,746</td><td>1000</td><td>10,535</td><td>973.00</td></tr> <tr><td>2013</td><td>2013-660000312</td><td>LEHO, LOUISE A</td><td>80</td><td>112,505</td><td>1000</td><td>10,199</td><td>976.00</td></tr> </tbody> </table>										Tax Year	Statement Number	Billed Owner	Tax Area	Total Value	Exemptions	Taxable Value	Billed Tax	2025	2025-660000312	LEHO, LOUISE A	80	142,279	1000	9,948	1,052.00	2024	2024-660000312	LEHO, LOUISE A	80	153,261	1000	9,629	933.00	2023	2023-660000312	LEHO, LOUISE A	80	93,808	1000	9,319	890.00	2022	2022-660000312	LEHO, LOUISE A	80	95,400	1000	9,494	923.00	2021	2021-660000312	LEHO, LOUISE A	80	131,271	1000	12,931	1,221.00	2020	2020-660000312	LEHO, LOUISE A	80	125,555	1000	12,526	1,185.00	2019	2019-660000312	LEHO, LOUISE A	80	119,379	1000	12,132	1,166.00	2018	2018-660000312	LEHO, LOUISE A	80	124,183	1000	11,983	1,153.00	2017	2017-660000312	LEHO, LOUISE A	80	123,153	1000	11,604	1,119.00	2016	2016-660000312	LEHO, LOUISE A	80	119,921	1000	11,237	1,087.00	2015	2015-660000312	LEHO, LOUISE A	80	116,817	1000	10,881	1,061.00	2014	2014-660000312	LEHO, LOUISE A	80	124,746	1000	10,535	973.00	2013	2013-660000312	LEHO, LOUISE A	80	112,505	1000	10,199	976.00
Tax Year	Statement Number	Billed Owner	Tax Area	Total Value	Exemptions	Taxable Value	Billed Tax																																																																																																																		
2025	2025-660000312	LEHO, LOUISE A	80	142,279	1000	9,948	1,052.00																																																																																																																		
2024	2024-660000312	LEHO, LOUISE A	80	153,261	1000	9,629	933.00																																																																																																																		
2023	2023-660000312	LEHO, LOUISE A	80	93,808	1000	9,319	890.00																																																																																																																		
2022	2022-660000312	LEHO, LOUISE A	80	95,400	1000	9,494	923.00																																																																																																																		
2021	2021-660000312	LEHO, LOUISE A	80	131,271	1000	12,931	1,221.00																																																																																																																		
2020	2020-660000312	LEHO, LOUISE A	80	125,555	1000	12,526	1,185.00																																																																																																																		
2019	2019-660000312	LEHO, LOUISE A	80	119,379	1000	12,132	1,166.00																																																																																																																		
2018	2018-660000312	LEHO, LOUISE A	80	124,183	1000	11,983	1,153.00																																																																																																																		
2017	2017-660000312	LEHO, LOUISE A	80	123,153	1000	11,604	1,119.00																																																																																																																		
2016	2016-660000312	LEHO, LOUISE A	80	119,921	1000	11,237	1,087.00																																																																																																																		
2015	2015-660000312	LEHO, LOUISE A	80	116,817	1000	10,881	1,061.00																																																																																																																		
2014	2014-660000312	LEHO, LOUISE A	80	124,746	1000	10,535	973.00																																																																																																																		
2013	2013-660000312	LEHO, LOUISE A	80	112,505	1000	10,199	976.00																																																																																																																		



# Rogers

## Assessment Property Record Card for Tax Year 2026

Data provided by LISA DELOZIER County Assessor

Date 04/17/2026  
 Time 02:02:22  
 Page 2

Lot Data	Square-Foot - NBHD 1117 #1	Primary Image
Lot Size		
Lot Count		
Units Buildable	1	
Non-Ag Acres	0.3873	
Topography		
Street Access		
Utilities		
Amenities	LAND QUALITY	
	0	
	0	
Method	Square-Foot	
Base Lot Value	16,870.00 x 1.70 = 28,679	
Factor Value		
Adjustments	1.0000	
Lot Value	28,679	

Residential Data	
Type	1 Single Family Residence
Condition	3 - Average
Quality	3 - Average
Architecture	TRAD TRADITIONAL
Style	100% 1 1/2 Story Finished
Exterior Wall	30% Veneer, Masonry 70% Frame, Siding, Vinyl
Base/Total Area	936 / 1,376
Style	100% 1 1/2 Story Finished
HVAC	100% Warmed & Cooled Air
Roof Cover	1 Composition Shingle
Area on Slab	936
Fixture/RghIn	11 /
Bed/F/H Bath	3 / 2.0 /
Basement Area	
Garage Type	462 Attached Garage - Finished 2 Stalls
Remodel	
Year/Eff Age	1984 / 32



GRM Approach	
GRM Code	
Gross Rent	0.00
Indicated Value	

Multiple Regression			
MRA Code	1	Test	
Adusted R	0.8445		
Indicated Value	182,511	132.64	Per SqFt

Direct Comparables			
Selection Model	A	Adam Test	
Adjustment Model	1	2022 Residential	
Comparables	2		
Indicated Value	131,620		Per SqFt

Cost Approach				Manual : 01/2025			
Base Cost	93.93	Total Misc Impr	+	9,641			
Roofing Adj	+ 3.60	Garage Cost	+	18,817			
Subfloor Adj	+ -1.67	Total RCN	=	193,262			
Heat/Cool Adj	+ 12.64	Depreciation ( 40%)	-	77,305			
Plumbing Adj	+ 11.27	Lump Sums	+	0			
Basement Adj	+ 0.00	RCNLD	=	115,957			
Adj Base Cost	= 119.77	Lot Value	+	28,679			
Total Area	x 1,376	Indicated Value	=	144,636			
Adjusted Cost	= 164,804	Value Per SqFt		105.11			

Value Reconciliation			
Selected Approach	Cost Approach		
Improvements	115,957		
Lot Value	28,679		
Indicated Value	144,636	105.11	Per SqFt
Agland Value			
Site Improvements	9,314		
Total Value	153,950	111.88	Total Value Per SqFt

Miscellaneous Improvements								
Code	Description	Sketch ID	Size	Year	Units	Unit Cost	Depr	Value
FPR1	FIREPLACE - RESIDENTIAL 1 STORY	0		1	1	5,615.40		5,615
PRCH	SLAB PORCH - COVERED	1053	15x5		75	26.69		2,002
PATO	SLAB PORCH - OPEN	1054	19x10		190	10.65		2,024



# Rogers

## Assessment Property Record Card for Tax Year 2026

Data provided by LISA DELOZIER County Assessor

Date 04/17/2026

Time 02:02:22

Page 3

### Sketch Image

660000312

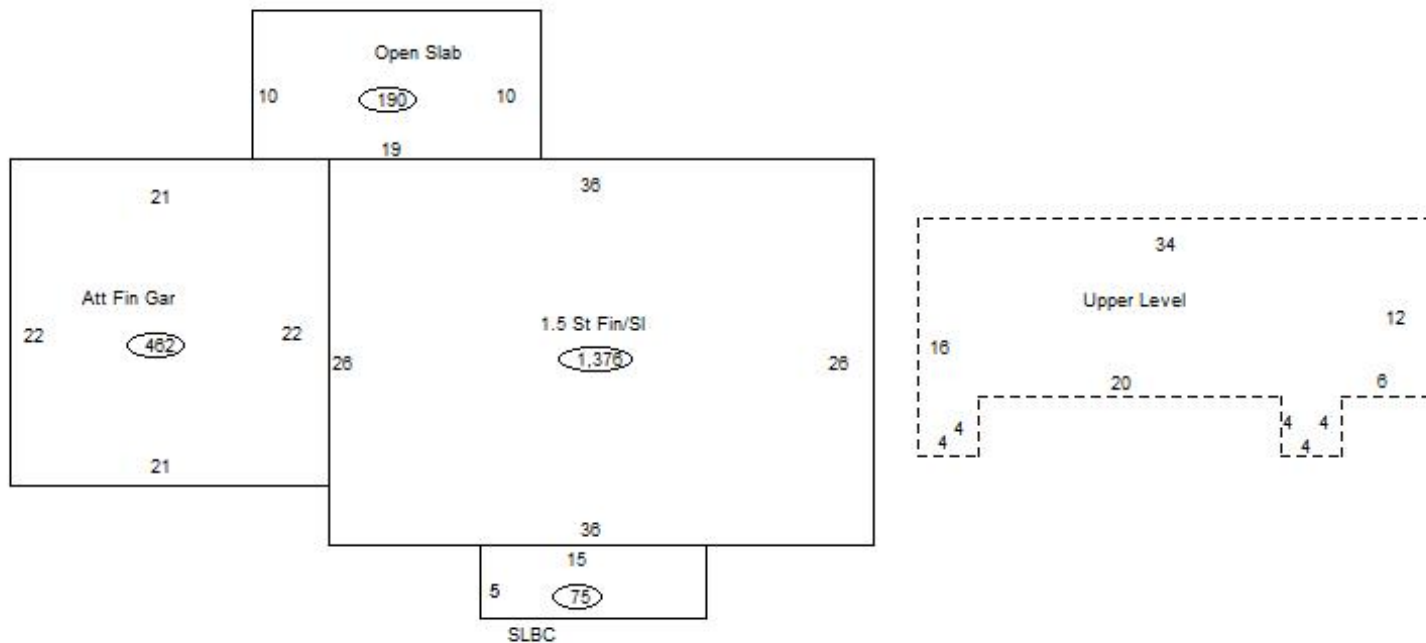

### Sketch Vector Information

Sequence	Code	Type	Built Over	Scale	Section Label	Base Area	Multiplier	Total Area
1	R	5	Slab	13	1.5 St Fin/SI	936	1.470	1,376
2	G	5		13	Att Fin Gar	462	1.000	462
3	M	PRCH		13	SLBC	75	1.000	75
4	M	PATO		13	Open Slab	190	1.000	190
5	U	^UL	Overhang	13	Upper Level	440	1.000	440
<b>Total Building Area</b>						936		1,376



# Rogers





## Assessment Property Record Card for Tax Year 2026

Data provided by LISA DELOZIER County Assessor

Date 04/17/2026  
 Time 02:02:22  
 Page 4

660000312

### Outbuildings/Site Improvements

Building Image	Code	Description	Dimensions	Floor	Roofing	Total Units
	SHDS	Shed - Small	10x28x8	Plank	Formed Metal	280
	Qual	3	Cond 3	Year 2021	Eff Age 4	
	<b>Valuation Summary</b>		<b>Modifier Total</b>	<b>RCN</b>	<b>Depr (19% Phys/ % Func)</b>	<b>RCNLD</b>
	Base Cost (21.57 x 280)		6,040	6,040	1,148	4,892
	SHDS	Shed - Small PLASTIC - NCV	8x18x6	Base		144
	Qual	2	Cond 2	Year 2020	Eff Age 6	
	<b>Valuation Summary</b>		<b>Modifier Total</b>	<b>RCN</b>	<b>Depr (28% Phys/ 100% Func)</b>	<b>RCNLD</b>
	Base Cost (19.57 x 144)		2,818	2,818	2,818	
	WODO	Wood Deck - Open AROUND POOL	0x0x0	Plank		157
	Qual	3	Cond 3	Year 2020	Eff Age 5	
	<b>Valuation Summary</b>		<b>Modifier Total</b>	<b>RCN</b>	<b>Depr (27% Phys/ % Func)</b>	<b>RCNLD</b>
	Base Cost (24.22 x 157)		3,803	3,803	1,027	2,776
	SHDS	Shed - Small	12x10x6	Plank	Formed Metal	120
	Qual	2	Cond 3	Year 2015	Eff Age 8	
	<b>Valuation Summary</b>		<b>Modifier Total</b>	<b>RCN</b>	<b>Depr (37% Phys/ % Func)</b>	<b>RCNLD</b>
	Base Cost (21.77 x 120)		2,612	2,612	966	1,646