



# Rogers

## Assessment Property Record Card for Tax Year 2026

Data provided by LISA DELOZIER County Assessor

Date 04/17/2026  
Time 02:02:56  
Page 1

Assessment Data					Primary Image																																																																																																																				
<b>Account</b> 660000372 <b>Parcel ID</b> 000000-00-0-00738-010-0002 <b>Cadastral ID</b> 01-20-15-06290 <b>Property Type</b> REAL - Real Property <b>Property Class</b> URP VI Area 3 <b>Tax Area</b> 80 - VERDIGRIS TOWN/ VERDIGRI <b>Name ID</b> 312870 BUTCHER, DEREK & LISA  9176 E HOLIDAY DR CLAREMORE OK 74019-0000  <b>Parcel Location</b> <b>Situs</b> 09176 S HOLLIDAY DR <b>Subdivision</b> SHEPHERD VALLEY <b>Lot/Block</b> 0002 / 0010 <b>Parcel Size</b> 1 - Lots <b>Sec/Twn/Rng</b> 1 / 20 / 15 / 5 <b>Neighborhood</b> 1117 - R-V04-SW VERDIGRIS <b>School District</b> S008 - VERDIGRIS SCHOOLS					<p>660000372_001.JPG 9/28/2025</p>																																																																																																																				
<b>Legal Description</b> Lot/Long: 36.24689361 -95.66872552																																																																																																																									
<b>Building Permits</b>					<table border="1"> <thead> <tr> <th>Number</th> <th>Description</th> <th>Opened</th> <th>Closed</th> <th>Amount</th> </tr> </thead> <tbody> <tr> <td colspan="5" style="height: 100px;"> </td> </tr> </tbody> </table>					Number	Description	Opened	Closed	Amount																																																																																																											
Number	Description	Opened	Closed	Amount																																																																																																																					
<b>Exemptions</b>					<b>Sale History</b>																																																																																																																				
<table border="1"> <thead> <tr> <th>Code</th> <th>Type</th> <th>Active</th> <th>Maximum</th> <th>Exemption</th> </tr> </thead> <tbody> <tr> <td>H</td> <td>Homestead</td> <td>No</td> <td>1,000</td> <td></td> </tr> </tbody> </table>					Code	Type	Active	Maximum	Exemption	H	Homestead	No	1,000		<table border="1"> <thead> <tr> <th>Bk/Pg</th> <th>Grantor</th> <th>Date</th> <th>Price</th> <th>Code</th> </tr> </thead> <tbody> <tr> <td>2417/60</td> <td>NEWHART, JAMIE L</td> <td>08/01/2014</td> <td>118,000</td> <td>YES</td> </tr> <tr> <td>1277/159</td> <td>PRESTON LAKES, LLC</td> <td>03/05/2001</td> <td>41,000</td> <td>No</td> </tr> <tr> <td>1014/97</td> <td>FREEMAN CONSTRUCTION CO</td> <td>01/23/1996</td> <td>0</td> <td>No</td> </tr> <tr> <td>1003/551</td> <td>VERDIGRIS VALLEY~CONSTRUCTION</td> <td>10/02/1995</td> <td>0</td> <td>No</td> </tr> </tbody> </table>					Bk/Pg	Grantor	Date	Price	Code	2417/60	NEWHART, JAMIE L	08/01/2014	118,000	YES	1277/159	PRESTON LAKES, LLC	03/05/2001	41,000	No	1014/97	FREEMAN CONSTRUCTION CO	01/23/1996	0	No	1003/551	VERDIGRIS VALLEY~CONSTRUCTION	10/02/1995	0	No																																																																													
Code	Type	Active	Maximum	Exemption																																																																																																																					
H	Homestead	No	1,000																																																																																																																						
Bk/Pg	Grantor	Date	Price	Code																																																																																																																					
2417/60	NEWHART, JAMIE L	08/01/2014	118,000	YES																																																																																																																					
1277/159	PRESTON LAKES, LLC	03/05/2001	41,000	No																																																																																																																					
1014/97	FREEMAN CONSTRUCTION CO	01/23/1996	0	No																																																																																																																					
1003/551	VERDIGRIS VALLEY~CONSTRUCTION	10/02/1995	0	No																																																																																																																					
<b>Parcel Valuation</b>																																																																																																																									
<table border="1"> <thead> <tr> <th>Source</th> <th>REAL</th> <th>Fair Cash</th> <th>Capped</th> <th>Asmnt Level</th> <th>Assessed</th> <th>Levy Rate</th> <th>104.132</th> <th>Current Tax</th> </tr> </thead> <tbody> <tr> <td>Remove Cap</td> <td>2015</td> <td>Land Value 26,297</td> <td>24,503</td> <td>11%</td> <td>2,695</td> <td>Assessed</td> <td>18,289</td> <td>1,904.47</td> </tr> <tr> <td>Year Frozen</td> <td>0</td> <td>Improvements 149,619</td> <td>141,762</td> <td></td> <td>15,594</td> <td>Penalty</td> <td>0</td> <td></td> </tr> <tr> <td>Uncapped Value</td> <td>0</td> <td>Mobile Home 0</td> <td>0</td> <td></td> <td>0</td> <td>Exemption</td> <td>0</td> <td>0.00</td> </tr> <tr> <td>TIF Project ID</td> <td>0</td> <td>Total Value 175,916</td> <td>166,265</td> <td></td> <td>18,289</td> <td>Total Taxable</td> <td>18,289</td> <td>1,904.00</td> </tr> </tbody> </table>		Source	REAL	Fair Cash	Capped	Asmnt Level	Assessed	Levy Rate	104.132	Current Tax	Remove Cap	2015	Land Value 26,297	24,503	11%	2,695	Assessed	18,289	1,904.47	Year Frozen	0	Improvements 149,619	141,762		15,594	Penalty	0		Uncapped Value	0	Mobile Home 0	0		0	Exemption	0	0.00	TIF Project ID	0	Total Value 175,916	166,265		18,289	Total Taxable	18,289	1,904.00	<b>Assessment History</b>																																																																										
Source	REAL	Fair Cash	Capped	Asmnt Level	Assessed	Levy Rate	104.132	Current Tax																																																																																																																	
Remove Cap	2015	Land Value 26,297	24,503	11%	2,695	Assessed	18,289	1,904.47																																																																																																																	
Year Frozen	0	Improvements 149,619	141,762		15,594	Penalty	0																																																																																																																		
Uncapped Value	0	Mobile Home 0	0		0	Exemption	0	0.00																																																																																																																	
TIF Project ID	0	Total Value 175,916	166,265		18,289	Total Taxable	18,289	1,904.00																																																																																																																	
<table border="1"> <thead> <tr> <th>Tax Year</th> <th>Statement Number</th> <th>Billed Owner</th> <th>Tax Area</th> <th>Total Value</th> <th>Exemptions</th> <th>Taxable Value</th> <th>Billed Tax</th> </tr> </thead> <tbody> <tr><td>2025</td><td>2025-660000372</td><td>BUTCHER, DEREK &amp; LISA</td><td>80</td><td>161,676</td><td>0</td><td>17,418</td><td>1,814.00</td></tr> <tr><td>2024</td><td>2024-660000372</td><td>BUTCHER, DEREK &amp; LISA</td><td>80</td><td>173,930</td><td>0</td><td>16,589</td><td>1,590.00</td></tr> <tr><td>2023</td><td>2023-660000372</td><td>BUTCHER, DEREK &amp; LISA</td><td>80</td><td>143,627</td><td>0</td><td>15,799</td><td>1,492.00</td></tr> <tr><td>2022</td><td>2022-660000372</td><td>BUTCHER, DEREK &amp; LISA</td><td>80</td><td>143,693</td><td>0</td><td>15,297</td><td>1,471.00</td></tr> <tr><td>2021</td><td>2021-660000372</td><td>BUTCHER, DEREK &amp; LISA</td><td>80</td><td>133,264</td><td>0</td><td>14,568</td><td>1,363.00</td></tr> <tr><td>2020</td><td>2020-660000372</td><td>BUTCHER, DEREK &amp; LISA</td><td>80</td><td>126,130</td><td>0</td><td>13,874</td><td>1,301.00</td></tr> <tr><td>2019</td><td>2019-660000372</td><td>BUTCHER, DEREK &amp; LISA</td><td>80</td><td>122,363</td><td>0</td><td>13,460</td><td>1,282.00</td></tr> <tr><td>2018</td><td>2018-660000372</td><td>BUTCHER, DEREK &amp; LISA</td><td>80</td><td>125,859</td><td>0</td><td>13,844</td><td>1,320.00</td></tr> <tr><td>2017</td><td>2017-660000372</td><td>BUTCHER, DEREK &amp; LISA</td><td>80</td><td>124,780</td><td>0</td><td>13,726</td><td>1,311.00</td></tr> <tr><td>2016</td><td>2016-660000372</td><td>BUTCHER, DEREK &amp; LISA</td><td>80</td><td>121,492</td><td>0</td><td>13,364</td><td>1,281.00</td></tr> <tr><td>2015</td><td>2015-660000372</td><td>BUTCHER, DEREK &amp; LISA</td><td>80</td><td>119,758</td><td>0</td><td>13,173</td><td>1,272.00</td></tr> <tr><td>2014</td><td>2014-660000372</td><td>BUTCHER, DEREK &amp; LISA</td><td>80</td><td>138,554</td><td>1000</td><td>13,172</td><td>1,214.00</td></tr> <tr><td>2013</td><td>2013-660000372</td><td>NEWHART, JAMIE L</td><td>80</td><td>130,432</td><td>1000</td><td>12,759</td><td>1,219.00</td></tr> </tbody> </table>										Tax Year	Statement Number	Billed Owner	Tax Area	Total Value	Exemptions	Taxable Value	Billed Tax	2025	2025-660000372	BUTCHER, DEREK & LISA	80	161,676	0	17,418	1,814.00	2024	2024-660000372	BUTCHER, DEREK & LISA	80	173,930	0	16,589	1,590.00	2023	2023-660000372	BUTCHER, DEREK & LISA	80	143,627	0	15,799	1,492.00	2022	2022-660000372	BUTCHER, DEREK & LISA	80	143,693	0	15,297	1,471.00	2021	2021-660000372	BUTCHER, DEREK & LISA	80	133,264	0	14,568	1,363.00	2020	2020-660000372	BUTCHER, DEREK & LISA	80	126,130	0	13,874	1,301.00	2019	2019-660000372	BUTCHER, DEREK & LISA	80	122,363	0	13,460	1,282.00	2018	2018-660000372	BUTCHER, DEREK & LISA	80	125,859	0	13,844	1,320.00	2017	2017-660000372	BUTCHER, DEREK & LISA	80	124,780	0	13,726	1,311.00	2016	2016-660000372	BUTCHER, DEREK & LISA	80	121,492	0	13,364	1,281.00	2015	2015-660000372	BUTCHER, DEREK & LISA	80	119,758	0	13,173	1,272.00	2014	2014-660000372	BUTCHER, DEREK & LISA	80	138,554	1000	13,172	1,214.00	2013	2013-660000372	NEWHART, JAMIE L	80	130,432	1000	12,759	1,219.00
Tax Year	Statement Number	Billed Owner	Tax Area	Total Value	Exemptions	Taxable Value	Billed Tax																																																																																																																		
2025	2025-660000372	BUTCHER, DEREK & LISA	80	161,676	0	17,418	1,814.00																																																																																																																		
2024	2024-660000372	BUTCHER, DEREK & LISA	80	173,930	0	16,589	1,590.00																																																																																																																		
2023	2023-660000372	BUTCHER, DEREK & LISA	80	143,627	0	15,799	1,492.00																																																																																																																		
2022	2022-660000372	BUTCHER, DEREK & LISA	80	143,693	0	15,297	1,471.00																																																																																																																		
2021	2021-660000372	BUTCHER, DEREK & LISA	80	133,264	0	14,568	1,363.00																																																																																																																		
2020	2020-660000372	BUTCHER, DEREK & LISA	80	126,130	0	13,874	1,301.00																																																																																																																		
2019	2019-660000372	BUTCHER, DEREK & LISA	80	122,363	0	13,460	1,282.00																																																																																																																		
2018	2018-660000372	BUTCHER, DEREK & LISA	80	125,859	0	13,844	1,320.00																																																																																																																		
2017	2017-660000372	BUTCHER, DEREK & LISA	80	124,780	0	13,726	1,311.00																																																																																																																		
2016	2016-660000372	BUTCHER, DEREK & LISA	80	121,492	0	13,364	1,281.00																																																																																																																		
2015	2015-660000372	BUTCHER, DEREK & LISA	80	119,758	0	13,173	1,272.00																																																																																																																		
2014	2014-660000372	BUTCHER, DEREK & LISA	80	138,554	1000	13,172	1,214.00																																																																																																																		
2013	2013-660000372	NEWHART, JAMIE L	80	130,432	1000	12,759	1,219.00																																																																																																																		



# Rogers

## Assessment Property Record Card for Tax Year 2026

Data provided by LISA DELOZIER County Assessor

Date 04/17/2026  
 Time 02:02:57  
 Page 2

Lot Data	Square-Foot - NBHD 1117 #1	Primary Image
Lot Size		
Lot Count		
Units Buildable	1	
Non-Ag Acres	0.3551	
Topography		
Street Access		
Utilities		
Amenities	LAND QUALITY	
	0	
	0	
Method	Square-Foot	
Base Lot Value	15,469.00 x 1.70 = 26,297	
Factor Value		
Adjustments	1.0000	
Lot Value	26,297	

Residential Data	
Type	1 Single Family Residence
Condition	3 - Average
Quality	2.5 - Fair
Architecture	TRAD TRADITIONAL
Style	100% One Story
Exterior Wall	20% Veneer, Masonry 80% Frame, Siding, Wood
Base/Total Area	1,464 / 1,464
Style	100% One Story
HVAC	100% Warmed & Cooled Air
Roof Cover	1 Composition Shingle
Area on Slab	1,464
Fixture/RghIn	11 /
Bed/F/H Bath	3 / 2.0 /
Basement Area	
Garage Type	440 Attached Garage - Finished 2 Stalls
Remodel	
Year/Eff Age	1995 / 23

660000372	9/28/2025
660000372_001.JPG	

GRM Approach	
GRM Code	
Gross Rent	0.00
Indicated Value	

Multiple Regression			
MRA Code	1	Test	
Adjusted R	0.8445		
Indicated Value	172,580	117.88	Per SqFt

Direct Comparables			
Selection Model	A	Adam Test	
Adjustment Model	1	2022 Residential	
Comparables	8		
Indicated Value	173,120		Per SqFt

Cost Approach				Manual : 01/2025			
Base Cost	100.44	Total Misc Impr	+	19,962			
Roofing Adj	+ 4.55	Garage Cost	+	15,646			
Subfloor Adj	+ -1.18	Total RCN	=	218,447			
Heat/Cool Adj	+ 11.47	Depreciation ( 32%)	-	69,903			
Plumbing Adj	+ 9.61	Lump Sums	+	0			
Basement Adj	+ 0.00	RCNLD	=	148,544			
Adj Base Cost	= 124.89	Lot Value	+	26,297			
Total Area	x 1,464	Indicated Value	=	174,841			
Adjusted Cost	= 182,839	Value Per SqFt		119.43			

Value Reconciliation			
Selected Approach	Cost Approach		
Improvements	148,544		
Lot Value	26,297		
Indicated Value	174,841	119.43	Per SqFt
Agland Value			
Site Improvements	1,075		
Total Value	175,916	120.16	Total Value Per SqFt

Miscellaneous Improvements								
Code	Description	Sketch ID	Size	Year	Units	Unit Cost	Depr	Value
FPR1	FIREPLACE - RESIDENTIAL 1 STORY	0		1	1	5,095.98		5,096
PATC	Patio - Covered	1287	56x14		784	14.24		11,164
PRCH	SLAB PORCH - COVERED	1288	26x6		156	23.73		3,702



# Rogers

## Assessment Property Record Card for Tax Year 2026

Data provided by LISA DELOZIER County Assessor

Date 04/17/2026  
 Time 02:02:57  
 Page 3

### Sketch Image

660000372

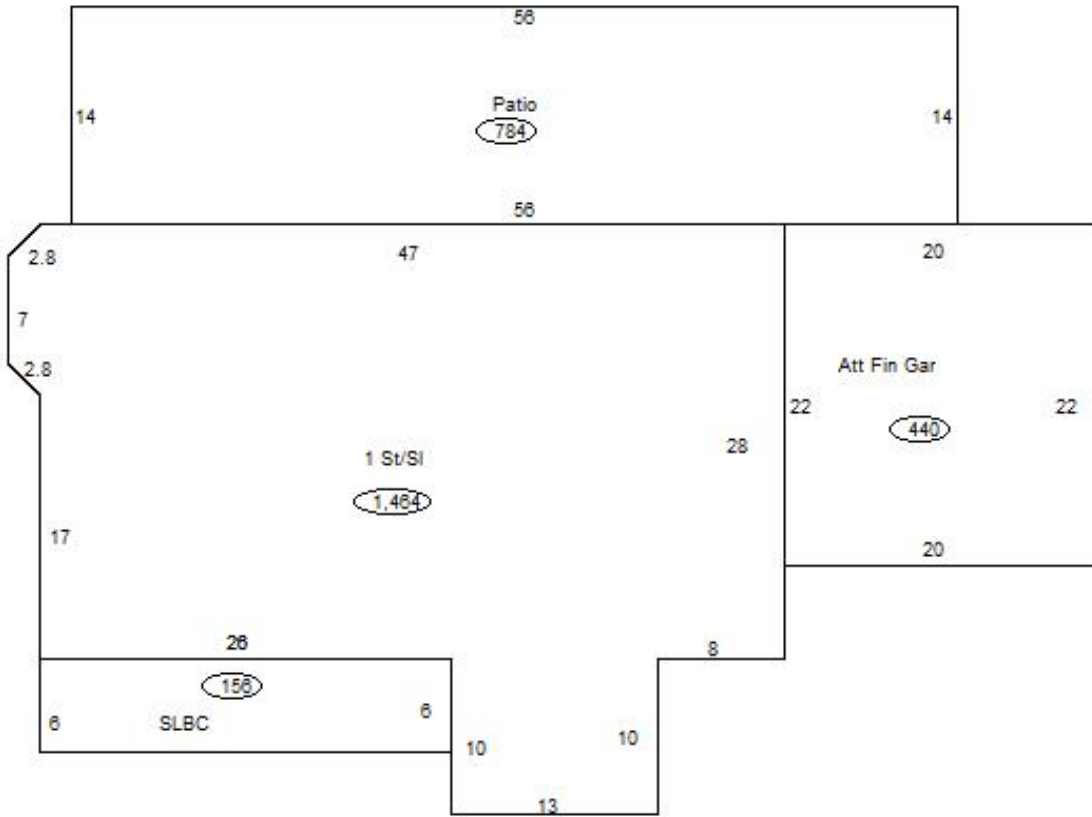

### Sketch Vector Information

Sequence	Code	Type	Built Over	Scale	Section Label	Base Area	Multiplier	Total Area
1	R	1	Slab	13	1 St/SI	1,464	1.000	1,464
2	G	5		13	Att Fin Gar	440	1.000	440
3	M	PATC		13	Patio	784	1.000	784
4	M	PRCH		13	SLBC	156	1.000	156
<b>Total Building Area</b>						1,464		1,464



# Rogers

## Assessment Property Record Card for Tax Year 2026

Data provided by LISA DELOZIER County Assessor

Date 04/17/2026  
Time 02:02:57  
Page 4

660000372

### Outbuildings/Site Improvements

Building Image	Code	Description	Dimensions	Floor	Roofing	Total Units
	SHDS	Shed - Small	8x10x8	Plank	Composition Shingle	80
	Qual	2	Cond 3	Year 2010	Eff Age 12	
<b>Valuation Summary</b>		<b>Modifier Total</b>		<b>RCN</b>	<b>Depr (46% Phys/ % Func)</b>	<b>RCNLD</b>
Base Cost (24.87 x 80)		1,990		1,990	915	1,075