



# Rogers

## Assessment Property Record Card for Tax Year 2026

Data provided by LISA DELOZIER County Assessor

Date 04/17/2026  
Time 03:05:39  
Page 1

Assessment Data					Primary Image														
<b>Account</b> 660000444 <b>Parcel ID</b> 000000-00-0-00468-001-0012 <b>Cadastral ID</b> 01-21-14-01180 <b>Property Type</b> REAL - Real Property <b>Property Class</b> RRP VI Area 4 <b>Tax Area</b> 7 - OWASSO/LIMESTONE FIRE <b>Name ID</b> 269678 VINES PROPERTIES INC  PO BOX 498 OWASSO OK 74055-0000  <b>Parcel Location</b> <b>Situs</b> 11821 N 191ST E AVE <b>Subdivision</b> LOOKING GLASS ESTATE <b>Lot/Block</b> 0012 / 0001 Parcel Size 1 - Lots <b>Sec/Twn/Rng</b> 1 / 21 / 14 / 5 <b>Neighborhood</b> 1014 - R-V04-SW OWASSO <b>School District</b> S021 - OWASSO SCHOOLS					 <p>\\tsclient\T\LOGAN\LOGAN RESIDENTIAL VI\2202-4-1\IMG_0049. 4/4/2022</p>														
<b>Legal Description</b> Lat/Long: 36.32686262 -95.76096357																			
LOT 12 BLOCK 1 LOOKING GLASS ESTATES					<b>Building Permits</b> <table border="1"> <thead> <tr> <th>Number</th> <th>Description</th> <th>Opened</th> <th>Closed</th> <th>Amount</th> </tr> </thead> <tbody> <tr> <td></td> <td></td> <td></td> <td></td> <td></td> </tr> </tbody> </table>					Number	Description	Opened	Closed	Amount					
Number	Description	Opened	Closed	Amount															
<b>Exemptions</b>					<b>Sale History</b>														
<b>Code</b>	<b>Type</b>	<b>Active</b>	<b>Maximum</b>	<b>Exemption</b>	<b>Bk/Pg</b>	<b>Grantor</b>	<b>Date</b>	<b>Price</b>	<b>Code</b>										
					/	KENT, MARK O &	05/04/2020	40,000	WB										
					842/369			63,000	No										
<b>Parcel Valuation</b>																			
<b>Source</b>	<b>REAL</b>		<b>Fair Cash</b>	<b>Capped</b>	<b>Asmnt Level</b>	<b>Assessed</b>	<b>Levy Rate</b>	108.538	<b>Current Tax</b>										
<b>Remove Cap</b>	2021		<b>Land Value</b>	30,831	21,997	11%	2,420	<b>Assessed</b>	6,311										
<b>Year Frozen</b>	0		<b>Improvements</b>	35,377	35,377		3,891	<b>Penalty</b>	0										
<b>Uncapped Value</b>	0		<b>Mobile Home</b>	0	0		0	<b>Exemption</b>	0										
<b>TIF Project ID</b>	0		<b>Total Value</b>	66,208	57,374		6,311	<b>Total Taxable</b>	6,311										
<b>Assessment History</b>																			
<b>Tax Year</b>	<b>Statement Number</b>	<b>Billed Owner</b>			<b>Tax Area</b>	<b>Total Value</b>	<b>Exemptions</b>	<b>Taxable Value</b>	<b>Billed Tax</b>										
2025	2025-660000444	VINES PROPERTIES INC			7	67,128	0	6,011	653.00										
2024	2024-660000444	VINES PROPERTIES INC			7	74,589	0	5,724	632.00										
2023	2023-660000444	VINES PROPERTIES INC			7	49,562	0	5,452	589.00										
2022	2022-660000444	VINES PROPERTIES INC			7	49,577	0	5,453	612.00										
2021	2021-660000444	VINES PROPERTIES INC			7	58,027	0	6,383	708.00										
2020	2020-660000444	VINES PROPERTIES INC			7	174,075	1000	10,610	1,191.00										
2019	2019-660000444	KENT, MARK O &			7	167,486	1000	10,272	1,154.00										
2018	2018-660000444	KENT, MARK O &			7	170,128	1000	9,944	1,082.00										
2017	2017-660000444	KENT, MARK O &			7	168,674	1000	9,624	1,057.00										
2016	2016-660000444	KENT, MARK O &			7	163,993	1000	9,315	1,024.00										
2015	2015-660000444	KENT, MARK O &			7	163,440	1000	9,015	998.00										
2014	2014-660000444	KENT, MARK O &			7	164,783	1000	8,723	974.00										
2013	2013-660000444	KENT, MARK O &			7	160,190	1000	8,440	926.00										



# Rogers

## Assessment Property Record Card for Tax Year 2026

Data provided by LISA DELOZIER County Assessor

Date 04/17/2026  
Time 03:05:39  
Page 2

Lot Data	Square-Foot - NBHD 1014 #1	Primary Image
Lot Size		
Lot Count		
Units Buildable	1	
Non-Ag Acres	0.3909	
Topography		
Street Access		
Utilities		
Amenities	LAND QUALITY	
	0	
	0	
Method	Square-Foot	
Base Lot Value	17,028.00 x 1.81 = 30,831	
Factor Value		
Adjustments	1.0000	
Lot Value	30,831	

Residential Data	
Type	1 Single Family Residence
Condition	1 - Low
Quality	3 - Average
Architecture	
Style	100% 1 1/2 Story Finished
Exterior Wall	100% Veneer, Masonry
Base/Total Area	1,606 / 2,618
Style	100% 1 1/2 Story Finished
HVAC	100% Electric Baseboard
Roof Cover	1 Composition Shingle
Area on Slab	1,606
Fixture/RghIn	14 /
Bed/F/H Bath	4 / 3.0 /
Basement Area	
Garage Type	420 Attached Garage - Unfinished
Remodel	
Year/Eff Age	1971 / 77

\\tsclient\T\LOGAN\LOGAN RESIDENTIAL VI\2202-4-1\IMG\_0049. 4/4/2022

GRM Approach	
GRM Code	
Gross Rent	0.00
Indicated Value	

Multiple Regression			
MRA Code	1	Test	
Adusted R	0.8445		
Indicated Value	248,827	95.04	Per SqFt

Direct Comparables			
Selection Model	A	Adam Test	
Adjustment Model	1	2022 Residential	
Comparables	1		
Indicated Value	3,650		Per SqFt

Cost Approach				Manual : 01/2025			
Base Cost	93.59	Total Misc Impr	+	9,536			
Roofing Adj	+ 3.01	Garage Cost	+	14,049			
Subfloor Adj	+ -1.42	Total RCN	=	294,810			
Heat/Cool Adj	+ 0.97	Depreciation ( 88%)	-	259,433			
Plumbing Adj	+ 7.45	Lump Sums	+	0			
Basement Adj	+ 0.00	RCNLD	=	35,377			
Adj Base Cost	= 103.60	Lot Value	+	30,831			
Total Area	x 2,618	Indicated Value	=	66,208			
Adjusted Cost	= 271,225	Value Per SqFt		25.29			

Value Reconciliation			
Selected Approach	Cost Approach		
Improvements	35,377		
Lot Value	30,831		
Indicated Value	66,208	25.29	Per SqFt
Agland Value			
Site Improvements			
Total Value	66,208	25.29	Total Value Per SqFt

Miscellaneous Improvements								
Code	Description	Sketch ID	Size	Year	Units	Unit Cost	Depr	Value
FPR1	FIREPLACE - RESIDENTIAL 1 STORY	0		1	1	5,615.40		5,615
PRCH	SLAB PORCH - COVERED	1418		30	30	26.84		805
PRCH	SLAB PORCH - COVERED	1419	10x4		40	26.80		1,072
PATO	SLAB PORCH - OPEN	1420	20x6		120	11.29		1,355
PATO	SLAB PORCH - OPEN	1421	10x6		60	11.48		689



# Rogers

## Assessment Property Record Card for Tax Year 2026

Data provided by LISA DELOZIER County Assessor

Date 04/17/2026

Time 03:05:39

Page 3

### Sketch Image

660000444

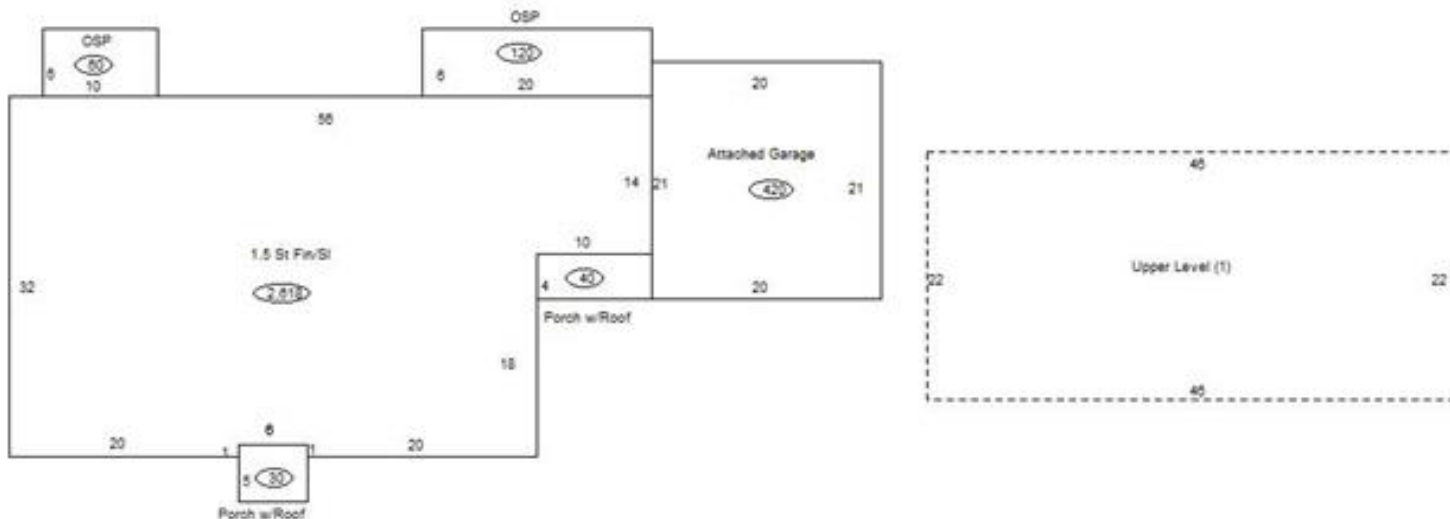

### Sketch Vector Information

Sequence	Code	Type	Built Over	Scale	Section Label	Base Area	Multiplier	Total Area
1	R	5	Slab	13	1.5 St Fin/Sl	1,606	1.630	2,618
2	G	1		13	Attached Garage	420	1.000	420
3	M	PRCH		13	SLBC	30	1.000	30
4	M	PRCH		13	SLBC	40	1.000	40
5	M	PATO		13	Open Slab	120	1.000	120
6	M	PATO		13	Open Slab	60	1.000	60
7	U	^UL		13	Upper Level (1)	1,012	1.000	1,012
<b>Total Building Area</b>						<b>1,606</b>		<b>2,618</b>