



# Rogers

## Assessment Property Record Card for Tax Year 2026

Data provided by LISA DELOZIER County Assessor

Date 04/17/2026  
Time 03:05:56  
Page 1

Assessment Data					Primary Image																																																																																																																				
<b>Account</b> 660000528 <b>Parcel ID</b> 000000-00-0-00468-006-0010 <b>Cadastral ID</b> 01-21-14-02030 <b>Property Type</b> REAL - Real Property <b>Property Class</b> RRP VI Area 4 <b>Tax Area</b> 7 - OWASSO/LIMESTONE FIRE <b>Name ID</b> 113274 MCCLAIN, HAROLD J &  DEBORAH K 19103 S 4079 RD CLAREMORE OK 74019-0000																																																																																																																									
<b>Parcel Location</b> <b>Situs</b> 11719 N 191ST E PL <b>Subdivision</b> LOOKING GLASS ESTATE <b>Lot/Block</b> 0010 / 0006 <b>Parcel Size</b> 1 - Lots <b>Sec/Twn/Rng</b> 1 / 21 / 14 / 5 <b>Neighborhood</b> 1014 - R-V04-SW OWASSO <b>School District</b> S021 - OWASSO SCHOOLS																																																																																																																									
<b>Legal Description</b> Lat/Long: 36.32462111 -95.75984996 LOT 10 BLOCK 6 LOOKING GLASS ESTATES					<b>Building Permits</b> <table border="1"> <thead> <tr> <th>Number</th> <th>Description</th> <th>Opened</th> <th>Closed</th> <th>Amount</th> </tr> </thead> <tbody> <tr> <td></td> <td></td> <td></td> <td></td> <td></td> </tr> </tbody> </table>					Number	Description	Opened	Closed	Amount																																																																																																											
Number	Description	Opened	Closed	Amount																																																																																																																					
<b>Exemptions</b> <table border="1"> <thead> <tr> <th>Code</th> <th>Type</th> <th>Active</th> <th>Maximum</th> <th>Exemption</th> </tr> </thead> <tbody> <tr> <td></td> <td></td> <td></td> <td></td> <td></td> </tr> </tbody> </table>					Code	Type	Active	Maximum	Exemption						<b>Sale History</b> <table border="1"> <thead> <tr> <th>Bk/Pg</th> <th>Grantor</th> <th>Date</th> <th>Price</th> <th>Code</th> </tr> </thead> <tbody> <tr> <td>967/472</td> <td>WEST, RICKY O</td> <td>08/31/1994</td> <td>43,000</td> <td>Yes</td> </tr> <tr> <td>857/766</td> <td></td> <td></td> <td>39,500</td> <td>No</td> </tr> </tbody> </table>					Bk/Pg	Grantor	Date	Price	Code	967/472	WEST, RICKY O	08/31/1994	43,000	Yes	857/766			39,500	No																																																																																							
Code	Type	Active	Maximum	Exemption																																																																																																																					
Bk/Pg	Grantor	Date	Price	Code																																																																																																																					
967/472	WEST, RICKY O	08/31/1994	43,000	Yes																																																																																																																					
857/766			39,500	No																																																																																																																					
<b>Parcel Valuation</b> <table border="1"> <thead> <tr> <th>Source</th> <th>REAL</th> <th>Fair Cash</th> <th>Capped</th> <th>Asmnt Level</th> <th>Assessed</th> <th>Levy Rate</th> <th>108.538</th> <th>Current Tax</th> </tr> </thead> <tbody> <tr> <td>Remove Cap</td> <td>0</td> <td>Land Value 26,039</td> <td>20,692</td> <td>11%</td> <td>2,276</td> <td>Assessed</td> <td>8,898</td> <td>965.77</td> </tr> <tr> <td>Year Frozen</td> <td>0</td> <td>Improvements 62,132</td> <td>60,197</td> <td></td> <td>6,622</td> <td>Penalty</td> <td>0</td> <td></td> </tr> <tr> <td>Uncapped Value</td> <td>0</td> <td>Mobile Home 0</td> <td>0</td> <td></td> <td>0</td> <td>Exemption</td> <td>0</td> <td>0.00</td> </tr> <tr> <td>TIF Project ID</td> <td>0</td> <td>Total Value 88,171</td> <td>80,889</td> <td></td> <td>8,898</td> <td>Total Taxable</td> <td>8,898</td> <td>966.00</td> </tr> </tbody> </table>										Source	REAL	Fair Cash	Capped	Asmnt Level	Assessed	Levy Rate	108.538	Current Tax	Remove Cap	0	Land Value 26,039	20,692	11%	2,276	Assessed	8,898	965.77	Year Frozen	0	Improvements 62,132	60,197		6,622	Penalty	0		Uncapped Value	0	Mobile Home 0	0		0	Exemption	0	0.00	TIF Project ID	0	Total Value 88,171	80,889		8,898	Total Taxable	8,898	966.00																																																																			
Source	REAL	Fair Cash	Capped	Asmnt Level	Assessed	Levy Rate	108.538	Current Tax																																																																																																																	
Remove Cap	0	Land Value 26,039	20,692	11%	2,276	Assessed	8,898	965.77																																																																																																																	
Year Frozen	0	Improvements 62,132	60,197		6,622	Penalty	0																																																																																																																		
Uncapped Value	0	Mobile Home 0	0		0	Exemption	0	0.00																																																																																																																	
TIF Project ID	0	Total Value 88,171	80,889		8,898	Total Taxable	8,898	966.00																																																																																																																	
<b>Assessment History</b> <table border="1"> <thead> <tr> <th>Tax Year</th> <th>Statement Number</th> <th>Billed Owner</th> <th>Tax Area</th> <th>Total Value</th> <th>Exemptions</th> <th>Taxable Value</th> <th>Billed Tax</th> </tr> </thead> <tbody> <tr><td>2025</td><td>2025-660000528</td><td>MCCLAIN, HAROLD J &amp;</td><td>7</td><td>87,110</td><td>0</td><td>8,474</td><td>920.00</td></tr> <tr><td>2024</td><td>2024-660000528</td><td>MCCLAIN, HAROLD J &amp;</td><td>7</td><td>94,630</td><td>0</td><td>8,071</td><td>890.00</td></tr> <tr><td>2023</td><td>2023-660000528</td><td>MCCLAIN, HAROLD J &amp;</td><td>7</td><td>74,986</td><td>0</td><td>7,686</td><td>830.00</td></tr> <tr><td>2022</td><td>2022-660000528</td><td>MCCLAIN, HAROLD J &amp;</td><td>7</td><td>74,983</td><td>0</td><td>7,321</td><td>822.00</td></tr> <tr><td>2021</td><td>2021-660000528</td><td>MCCLAIN, HAROLD J &amp;</td><td>7</td><td>77,871</td><td>0</td><td>6,972</td><td>774.00</td></tr> <tr><td>2020</td><td>2020-660000528</td><td>MCCLAIN, HAROLD J &amp;</td><td>7</td><td>78,354</td><td>0</td><td>6,640</td><td>736.00</td></tr> <tr><td>2019</td><td>2019-660000528</td><td>MCCLAIN, HAROLD J &amp;</td><td>7</td><td>74,992</td><td>0</td><td>6,323</td><td>701.00</td></tr> <tr><td>2018</td><td>2018-660000528</td><td>MCCLAIN, HAROLD J &amp;</td><td>7</td><td>73,618</td><td>0</td><td>6,023</td><td>647.00</td></tr> <tr><td>2017</td><td>2017-660000528</td><td>MCCLAIN, HAROLD J &amp;</td><td>7</td><td>73,041</td><td>0</td><td>5,736</td><td>622.00</td></tr> <tr><td>2016</td><td>2016-660000528</td><td>MCCLAIN, HAROLD J &amp;</td><td>7</td><td>71,306</td><td>0</td><td>5,463</td><td>592.00</td></tr> <tr><td>2015</td><td>2015-660000528</td><td>MCCLAIN, HAROLD J &amp;</td><td>7</td><td>75,174</td><td>0</td><td>5,203</td><td>567.00</td></tr> <tr><td>2014</td><td>2014-660000528</td><td>MCCLAIN, HAROLD J &amp;</td><td>7</td><td>75,690</td><td>0</td><td>4,955</td><td>545.00</td></tr> <tr><td>2013</td><td>2013-660000528</td><td>MCCLAIN, HAROLD J &amp;</td><td>7</td><td>78,939</td><td>0</td><td>4,719</td><td>509.00</td></tr> </tbody> </table>										Tax Year	Statement Number	Billed Owner	Tax Area	Total Value	Exemptions	Taxable Value	Billed Tax	2025	2025-660000528	MCCLAIN, HAROLD J &	7	87,110	0	8,474	920.00	2024	2024-660000528	MCCLAIN, HAROLD J &	7	94,630	0	8,071	890.00	2023	2023-660000528	MCCLAIN, HAROLD J &	7	74,986	0	7,686	830.00	2022	2022-660000528	MCCLAIN, HAROLD J &	7	74,983	0	7,321	822.00	2021	2021-660000528	MCCLAIN, HAROLD J &	7	77,871	0	6,972	774.00	2020	2020-660000528	MCCLAIN, HAROLD J &	7	78,354	0	6,640	736.00	2019	2019-660000528	MCCLAIN, HAROLD J &	7	74,992	0	6,323	701.00	2018	2018-660000528	MCCLAIN, HAROLD J &	7	73,618	0	6,023	647.00	2017	2017-660000528	MCCLAIN, HAROLD J &	7	73,041	0	5,736	622.00	2016	2016-660000528	MCCLAIN, HAROLD J &	7	71,306	0	5,463	592.00	2015	2015-660000528	MCCLAIN, HAROLD J &	7	75,174	0	5,203	567.00	2014	2014-660000528	MCCLAIN, HAROLD J &	7	75,690	0	4,955	545.00	2013	2013-660000528	MCCLAIN, HAROLD J &	7	78,939	0	4,719	509.00
Tax Year	Statement Number	Billed Owner	Tax Area	Total Value	Exemptions	Taxable Value	Billed Tax																																																																																																																		
2025	2025-660000528	MCCLAIN, HAROLD J &	7	87,110	0	8,474	920.00																																																																																																																		
2024	2024-660000528	MCCLAIN, HAROLD J &	7	94,630	0	8,071	890.00																																																																																																																		
2023	2023-660000528	MCCLAIN, HAROLD J &	7	74,986	0	7,686	830.00																																																																																																																		
2022	2022-660000528	MCCLAIN, HAROLD J &	7	74,983	0	7,321	822.00																																																																																																																		
2021	2021-660000528	MCCLAIN, HAROLD J &	7	77,871	0	6,972	774.00																																																																																																																		
2020	2020-660000528	MCCLAIN, HAROLD J &	7	78,354	0	6,640	736.00																																																																																																																		
2019	2019-660000528	MCCLAIN, HAROLD J &	7	74,992	0	6,323	701.00																																																																																																																		
2018	2018-660000528	MCCLAIN, HAROLD J &	7	73,618	0	6,023	647.00																																																																																																																		
2017	2017-660000528	MCCLAIN, HAROLD J &	7	73,041	0	5,736	622.00																																																																																																																		
2016	2016-660000528	MCCLAIN, HAROLD J &	7	71,306	0	5,463	592.00																																																																																																																		
2015	2015-660000528	MCCLAIN, HAROLD J &	7	75,174	0	5,203	567.00																																																																																																																		
2014	2014-660000528	MCCLAIN, HAROLD J &	7	75,690	0	4,955	545.00																																																																																																																		
2013	2013-660000528	MCCLAIN, HAROLD J &	7	78,939	0	4,719	509.00																																																																																																																		



# Rogers

## Assessment Property Record Card for Tax Year 2026

Data provided by LISA DELOZIER County Assessor

Date 04/17/2026  
 Time 03:05:57  
 Page 2

Lot Data		Square-Foot - NBHD 1014 #1	
Lot Size			
Lot Count			
Units Buildable	1		
Non-Ag Acres	0.3231		
Topography			
Street Access			
Utilities			
Amenities	LAND QUALITY	0	0
Method	Square-Foot		
Base Lot Value	14,075.00 x 1.85 = 26,039		
Factor Value			
Adjustments	1.0000		
Lot Value	26,039		

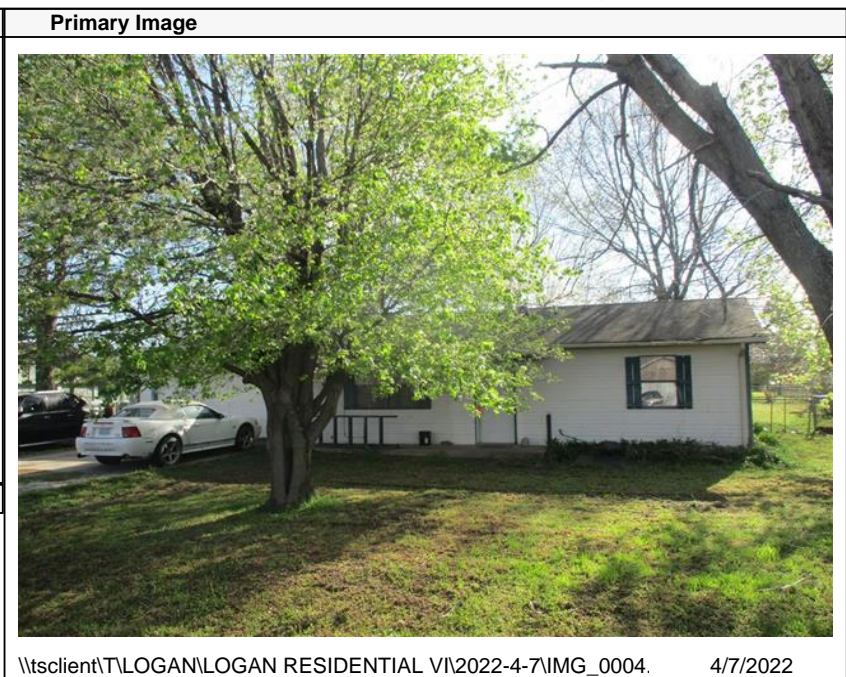

\\tsclient\T\LOGAN\LOGAN RESIDENTIAL VI\2022-4-7\IMG\_0004. 4/7/2022

Residential Data	
Type	1 Single Family Residence
Condition	2.5 - Fair
Quality	2 - Fair
Architecture	
Style	100% One Story
Exterior Wall	100% Frame, Siding, Wood
Base/Total Area	864 / 864
Style	100% One Story
HVAC	100% Warmed & Cooled Air
Roof Cover	1 Composition Shingle
Area on Slab	864
Fixture/RghIn	4 /
Bed/F/H Bath	3 / 1.0 /
Basement Area	
Garage Type	440 Attached Garage - Unfinished
Remodel	
Year/Eff Age	1984 / 37

GRM Approach	
GRM Code	
Gross Rent	0.00
Indicated Value	

Multiple Regression			
MRA Code	1	Test	
Adusted R	0.8445		
Indicated Value	112,339	130.02	Per SqFt

Direct Comparables	
Selection Model	A Adam Test
Adjustment Model	1 2022 Residential
Comparables	
Indicated Value	

Cost Approach				Manual : 01/2025	
Base Cost	98.76	Total Misc Impr	+	5,822	
Roofing Adj	+ 4.42	Garage Cost	+	10,613	
Subfloor Adj	+ 0.00	Total RCN	=	119,484	
Heat/Cool Adj	+ 10.30	Depreciation ( 48%)	-	57,352	
Plumbing Adj	+ 5.79	Lump Sums	+	0	
Basement Adj	+ 0.00	RCNLD	=	62,132	
Adj Base Cost	= 119.27	Lot Value	+	26,039	
Total Area	x 864	Indicated Value	=	88,171	
Adjusted Cost	= 103,049	Value Per SqFt		102.05	

Value Reconciliation			
Selected Approach	Cost Approach		
Improvements	62,132		
Lot Value	26,039		
Indicated Value	88,171	102.05	Per SqFt
Agland Value			
Site Improvements			
Total Value	88,171	102.05	Total Value Per SqFt

Miscellaneous Improvements								
Code	Description	Sketch ID	Size	Year	Units	Unit Cost	Depr	Value
PRCH	SLAB PORCH - COVERED	1624	16x12		192	20.69		3,972
PRCH	SLAB PORCH - COVERED	1625	22x4		88	21.02		1,850



# Rogers

## Assessment Property Record Card for Tax Year 2026

Data provided by LISA DELOZIER County Assessor

Date 04/17/2026  
 Time 03:05:57  
 Page 3

### Sketch Image

660000528

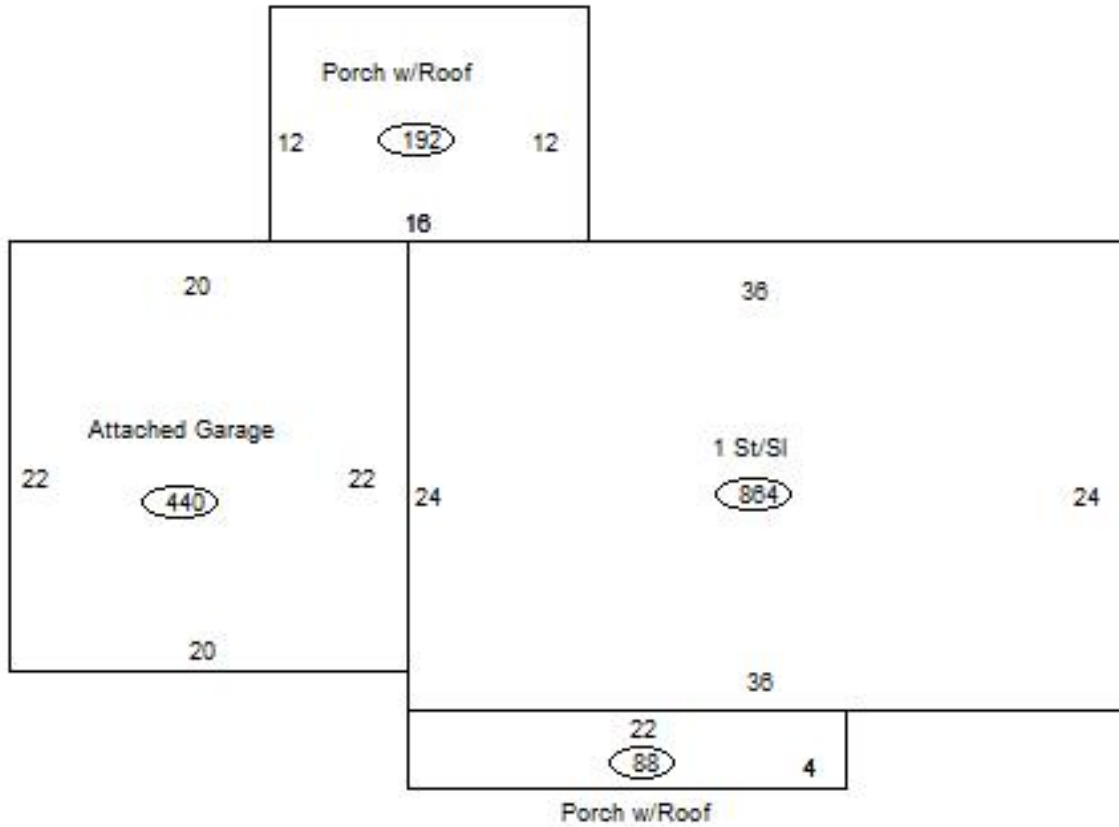

### Sketch Vector Information

Sequence	Code	Type	Built Over	Scale	Section Label	Base Area	Multiplier	Total Area
1	R	1	Slab	13	1 St/Sl	864	1.000	864
2	G	1		13	Attached Garage	440	1.000	440
3	M	PRCH		13	SLBC	192	1.000	192
4	M	PRCH		13	SLBC	88	1.000	88
<b>Total Building Area</b>						864		864



# Rogers

## Assessment Property Record Card for Tax Year 2026

Data provided by LISA DELOZIER County Assessor

Date 04/17/2026  
Time 03:05:57  
Page 4

660000528

### Outbuildings/Site Improvements

Building Image	Code	Description	Dimensions	Floor	Roofing	Total Units
	STF Qual	STG FAIR Cond	0x0x0 Year		Eff Age	
<b>Valuation Summary</b>		<b>Modifier Total</b>	<b>RCN</b>	<b>Depr (100% Phys/ % Func)</b>	<b>RCNLD</b>	
Base Cost (4.68 x )						