



# Rogers

## Assessment Property Record Card for Tax Year 2026

Data provided by LISA DELOZIER County Assessor

Date 04/17/2026  
Time 09:27:35  
Page 1

Assessment Data					Primary Image																																																																																																																				
<b>Account</b> 660000539 <b>Parcel ID</b> 000000-00-0-00468-006-0021 <b>Cadastral ID</b> 01-21-14-02140 <b>Property Type</b> REAL - Real Property <b>Property Class</b> RRP VI Area 4 <b>Tax Area</b> 7 - OWASSO/LIMESTONE FIRE <b>Name ID</b> 346793 GUENTHER, ETHAN H & JUDITH M  11606 N 192ND E AVE COLLINSVILLE OK 74021-0000  <b>Parcel Location</b> <b>Situs</b> 11606 N 192ND E AVE <b>Subdivision</b> LOOKING GLASS ESTATE <b>Lot/Block</b> 0021 / 0006 Parcel Size 1 - Lots <b>Sec/Twn/Rng</b> 1 / 21 / 14 / 5 <b>Neighborhood</b> 1014 - R-V04-SW OWASSO <b>School District</b> S021 - OWASSO SCHOOLS					<p>\\tsclient\T\LOGAN\LOGAN RESIDENTIAL VI\2022-4-7\IMG_0045. 4/8/2022</p>																																																																																																																				
<b>Legal Description</b> Lot/Long: 36.32246121 -95.75940399																																																																																																																									
<b>Building Permits</b>					<table border="1"> <thead> <tr> <th>Number</th> <th>Description</th> <th>Opened</th> <th>Closed</th> <th>Amount</th> </tr> </thead> <tbody> <tr> <td>R19</td> <td>R21- NEW 30X35 DTCH ACC BLDG</td> <td>11/2019</td> <td>06/2020</td> <td>35,000</td> </tr> <tr> <td>R19</td> <td>R20- SPLIT</td> <td>10/2018</td> <td>08/2019</td> <td></td> </tr> </tbody> </table>					Number	Description	Opened	Closed	Amount	R19	R21- NEW 30X35 DTCH ACC BLDG	11/2019	06/2020	35,000	R19	R20- SPLIT	10/2018	08/2019																																																																																																		
Number	Description	Opened	Closed	Amount																																																																																																																					
R19	R21- NEW 30X35 DTCH ACC BLDG	11/2019	06/2020	35,000																																																																																																																					
R19	R20- SPLIT	10/2018	08/2019																																																																																																																						
<b>Exemptions</b>					<b>Sale History</b>																																																																																																																				
<table border="1"> <thead> <tr> <th>Code</th> <th>Type</th> <th>Active</th> <th>Maximum</th> <th>Exemption</th> </tr> </thead> <tbody> <tr> <td>H</td> <td>Homestead</td> <td>No</td> <td>1,000</td> <td></td> </tr> </tbody> </table>					Code	Type	Active	Maximum	Exemption	H	Homestead	No	1,000		<table border="1"> <thead> <tr> <th>Bk/Pg</th> <th>Grantor</th> <th>Date</th> <th>Price</th> <th>Code</th> </tr> </thead> <tbody> <tr> <td>/</td> <td>BRITTON, JARED &amp;</td> <td>03/26/2025</td> <td>321,000</td> <td>WG</td> </tr> <tr> <td>/</td> <td>BRITTON, CLAY H</td> <td>08/19/2022</td> <td>0</td> <td>4</td> </tr> <tr> <td>/</td> <td>NEW AGE HOMES LLC</td> <td>08/09/2019</td> <td>165,000</td> <td>YES</td> </tr> <tr> <td>/</td> <td>BRITTON PROPERTIES INC</td> <td>03/19/2019</td> <td>18,000</td> <td>15</td> </tr> <tr> <td>/</td> <td>BRITTON ENTERPRISES LLC</td> <td>09/13/2018</td> <td>0</td> <td>4</td> </tr> <tr> <td>/</td> <td>STATE OF OK DEPT OF-TRANSPORT,</td> <td>09/01/2018</td> <td>55,800</td> <td>WG</td> </tr> </tbody> </table>					Bk/Pg	Grantor	Date	Price	Code	/	BRITTON, JARED &	03/26/2025	321,000	WG	/	BRITTON, CLAY H	08/19/2022	0	4	/	NEW AGE HOMES LLC	08/09/2019	165,000	YES	/	BRITTON PROPERTIES INC	03/19/2019	18,000	15	/	BRITTON ENTERPRISES LLC	09/13/2018	0	4	/	STATE OF OK DEPT OF-TRANSPORT,	09/01/2018	55,800	WG																																																																			
Code	Type	Active	Maximum	Exemption																																																																																																																					
H	Homestead	No	1,000																																																																																																																						
Bk/Pg	Grantor	Date	Price	Code																																																																																																																					
/	BRITTON, JARED &	03/26/2025	321,000	WG																																																																																																																					
/	BRITTON, CLAY H	08/19/2022	0	4																																																																																																																					
/	NEW AGE HOMES LLC	08/09/2019	165,000	YES																																																																																																																					
/	BRITTON PROPERTIES INC	03/19/2019	18,000	15																																																																																																																					
/	BRITTON ENTERPRISES LLC	09/13/2018	0	4																																																																																																																					
/	STATE OF OK DEPT OF-TRANSPORT,	09/01/2018	55,800	WG																																																																																																																					
<b>Parcel Valuation</b>																																																																																																																									
<table border="1"> <thead> <tr> <th>Source</th> <th>REAL</th> </tr> </thead> <tbody> <tr> <td>Remove Cap</td> <td>2026</td> </tr> <tr> <td>Year Frozen</td> <td>0</td> </tr> <tr> <td>Uncapped Value</td> <td>0</td> </tr> <tr> <td>TIF Project ID</td> <td>0</td> </tr> </tbody> </table>		Source	REAL	Remove Cap	2026	Year Frozen	0	Uncapped Value	0	TIF Project ID	0	<table border="1"> <thead> <tr> <th>Fair Cash</th> <th>Capped</th> <th>Asmnt Level</th> <th>Assessed</th> </tr> </thead> <tbody> <tr> <td>Land Value</td> <td>47,880</td> <td>47,880</td> <td>5,267</td> </tr> <tr> <td>Improvements</td> <td>201,606</td> <td>201,606</td> <td>22,177</td> </tr> <tr> <td>Mobile Home</td> <td>0</td> <td>0</td> <td>0</td> </tr> <tr> <td>Total Value</td> <td>249,486</td> <td>249,486</td> <td>27,444</td> </tr> </tbody> </table>			Fair Cash	Capped	Asmnt Level	Assessed	Land Value	47,880	47,880	5,267	Improvements	201,606	201,606	22,177	Mobile Home	0	0	0	Total Value	249,486	249,486	27,444	<table border="1"> <thead> <tr> <th>Levy Rate</th> <th>Current Tax</th> </tr> </thead> <tbody> <tr> <td>108.538</td> <td></td> </tr> <tr> <td>Assessed</td> <td>27,444</td> </tr> <tr> <td>Penalty</td> <td>0</td> </tr> <tr> <td>Exemption</td> <td>0</td> </tr> <tr> <td>Total Taxable</td> <td>27,444</td> </tr> </tbody> </table>		Levy Rate	Current Tax	108.538		Assessed	27,444	Penalty	0	Exemption	0	Total Taxable	27,444																																																																									
Source	REAL																																																																																																																								
Remove Cap	2026																																																																																																																								
Year Frozen	0																																																																																																																								
Uncapped Value	0																																																																																																																								
TIF Project ID	0																																																																																																																								
Fair Cash	Capped	Asmnt Level	Assessed																																																																																																																						
Land Value	47,880	47,880	5,267																																																																																																																						
Improvements	201,606	201,606	22,177																																																																																																																						
Mobile Home	0	0	0																																																																																																																						
Total Value	249,486	249,486	27,444																																																																																																																						
Levy Rate	Current Tax																																																																																																																								
108.538																																																																																																																									
Assessed	27,444																																																																																																																								
Penalty	0																																																																																																																								
Exemption	0																																																																																																																								
Total Taxable	27,444																																																																																																																								
<b>Assessment History</b>																																																																																																																									
<table border="1"> <thead> <tr> <th>Tax Year</th> <th>Statement Number</th> <th>Billed Owner</th> <th>Tax Area</th> <th>Total Value</th> <th>Exemptions</th> <th>Taxable Value</th> <th>Billed Tax</th> </tr> </thead> <tbody> <tr><td>2025</td><td>2025-660000539</td><td>GUENTHER, ETHAN H &amp;</td><td>7</td><td>242,157</td><td>0</td><td>25,609</td><td>2,780.00</td></tr> <tr><td>2024</td><td>2024-660000539</td><td>BRITTON, JARED &amp;</td><td>7</td><td>260,185</td><td>0</td><td>24,390</td><td>2,691.00</td></tr> <tr><td>2023</td><td>2023-660000539</td><td>BRITTON, JARED &amp;</td><td>7</td><td>226,807</td><td>0</td><td>23,228</td><td>2,509.00</td></tr> <tr><td>2022</td><td>2022-660000539</td><td>BRITTON, JARED &amp;</td><td>7</td><td>228,730</td><td>1000</td><td>21,122</td><td>2,385.00</td></tr> <tr><td>2021</td><td>2021-660000539</td><td>BRITTON, CLAY H</td><td>7</td><td>195,255</td><td>1000</td><td>20,478</td><td>2,288.00</td></tr> <tr><td>2020</td><td>2020-660000539</td><td>BRITTON, CLAY H</td><td>7</td><td>168,942</td><td>0</td><td>18,584</td><td>2,060.00</td></tr> <tr><td>2019</td><td>2019-660000539</td><td>BRITTON, CLAY H</td><td>7</td><td>20,000</td><td>0</td><td>2,200</td><td>244.00</td></tr> <tr><td>2018</td><td>2018-660000539</td><td>BRITTON PROPERTIES INC</td><td>7</td><td>15,000</td><td>0</td><td></td><td>.00</td></tr> <tr><td>2017</td><td>2017-660000539</td><td>STATE OF OK DEPT OF TRANSPORTATION</td><td>7</td><td>15,000</td><td>0</td><td></td><td>.00</td></tr> <tr><td>2016</td><td>2016-660000539</td><td>STATE OF OK DEPT OF TRANSPORTATION</td><td>7</td><td>15,000</td><td>0</td><td></td><td>.00</td></tr> <tr><td>2015</td><td>2015-660000539</td><td>STATE OF OK DEPT OF TRANSPORTATION</td><td>7</td><td>20,000</td><td>0</td><td></td><td>.00</td></tr> <tr><td>2014</td><td>2014-660000539</td><td>STATE OF OK DEPT OF TRANSPORTATION</td><td>7</td><td>20,000</td><td>0</td><td></td><td>.00</td></tr> <tr><td>2013</td><td>2013-660000539</td><td>STATE OF OK DEPT OF TRANSPORTATION</td><td>7</td><td>25,000</td><td>0</td><td></td><td>.00</td></tr> </tbody> </table>										Tax Year	Statement Number	Billed Owner	Tax Area	Total Value	Exemptions	Taxable Value	Billed Tax	2025	2025-660000539	GUENTHER, ETHAN H &	7	242,157	0	25,609	2,780.00	2024	2024-660000539	BRITTON, JARED &	7	260,185	0	24,390	2,691.00	2023	2023-660000539	BRITTON, JARED &	7	226,807	0	23,228	2,509.00	2022	2022-660000539	BRITTON, JARED &	7	228,730	1000	21,122	2,385.00	2021	2021-660000539	BRITTON, CLAY H	7	195,255	1000	20,478	2,288.00	2020	2020-660000539	BRITTON, CLAY H	7	168,942	0	18,584	2,060.00	2019	2019-660000539	BRITTON, CLAY H	7	20,000	0	2,200	244.00	2018	2018-660000539	BRITTON PROPERTIES INC	7	15,000	0		.00	2017	2017-660000539	STATE OF OK DEPT OF TRANSPORTATION	7	15,000	0		.00	2016	2016-660000539	STATE OF OK DEPT OF TRANSPORTATION	7	15,000	0		.00	2015	2015-660000539	STATE OF OK DEPT OF TRANSPORTATION	7	20,000	0		.00	2014	2014-660000539	STATE OF OK DEPT OF TRANSPORTATION	7	20,000	0		.00	2013	2013-660000539	STATE OF OK DEPT OF TRANSPORTATION	7	25,000	0		.00
Tax Year	Statement Number	Billed Owner	Tax Area	Total Value	Exemptions	Taxable Value	Billed Tax																																																																																																																		
2025	2025-660000539	GUENTHER, ETHAN H &	7	242,157	0	25,609	2,780.00																																																																																																																		
2024	2024-660000539	BRITTON, JARED &	7	260,185	0	24,390	2,691.00																																																																																																																		
2023	2023-660000539	BRITTON, JARED &	7	226,807	0	23,228	2,509.00																																																																																																																		
2022	2022-660000539	BRITTON, JARED &	7	228,730	1000	21,122	2,385.00																																																																																																																		
2021	2021-660000539	BRITTON, CLAY H	7	195,255	1000	20,478	2,288.00																																																																																																																		
2020	2020-660000539	BRITTON, CLAY H	7	168,942	0	18,584	2,060.00																																																																																																																		
2019	2019-660000539	BRITTON, CLAY H	7	20,000	0	2,200	244.00																																																																																																																		
2018	2018-660000539	BRITTON PROPERTIES INC	7	15,000	0		.00																																																																																																																		
2017	2017-660000539	STATE OF OK DEPT OF TRANSPORTATION	7	15,000	0		.00																																																																																																																		
2016	2016-660000539	STATE OF OK DEPT OF TRANSPORTATION	7	15,000	0		.00																																																																																																																		
2015	2015-660000539	STATE OF OK DEPT OF TRANSPORTATION	7	20,000	0		.00																																																																																																																		
2014	2014-660000539	STATE OF OK DEPT OF TRANSPORTATION	7	20,000	0		.00																																																																																																																		
2013	2013-660000539	STATE OF OK DEPT OF TRANSPORTATION	7	25,000	0		.00																																																																																																																		



# Rogers

## Assessment Property Record Card for Tax Year 2026

Data provided by LISA DELOZIER County Assessor

Date 04/17/2026  
 Time 09:27:35  
 Page 2

Lot Data		Square-Foot - NBHD 1014 #1	
Lot Size			
Lot Count			
Units Buildable	1		
Non-Ag Acres	0.3111		
Topography			
Street Access			
Utilities			
Amenities	LAND QUALITY	0	0
Method	Square-Foot		
Base Lot Value	13,553.00 x 1.85 = 25,073		
Factor Value			
Adjustments	1.9096		
Lot Value	47,880		



\\tsclient\T\LOGAN\LOGAN RESIDENTIAL VI\2022-4-7\IMG\_0045. 4/8/2022

Residential Data	
Type	1 Single Family Residence
Condition	3 - Average
Quality	2.5 - Fair
Architecture	
Style	100% One Story
Exterior Wall	30% Frame, Siding, Wood 70% Veneer, Masonry
Base/Total Area	1,467 / 1,467
Style	100% One Story
HVAC	100% Warmed & Cooled Air
Roof Cover	1 Composition Shingle
Area on Slab	1,467
Fixture/RghIn	11 /
Bed/F/H Bath	3 / 2.0 /
Basement Area	
Garage Type	440 Attached Garage - Unfinished
Remodel	
Year/Eff Age	2019 / 5

GRM Approach	
GRM Code	
Gross Rent	0.00
Indicated Value	

Multiple Regression			
MRA Code	1	Test	
Adjusted R	0.8445		
Indicated Value	209,321	142.69	Per SqFt

Direct Comparables	
Selection Model	A Adam Test
Adjustment Model	1 2022 Residential
Comparables	
Indicated Value	

Cost Approach				Manual : 01/2025			
Base Cost	104.85	Total Misc Impr	+ 10,076				
Roofing Adj	+ 4.54	Garage Cost	+ 12,487				
Subfloor Adj	+ -1.17	Total RCN	= 212,217				
Heat/Cool Adj	+ 11.47	Depreciation ( 5%)	- 10,611				
Plumbing Adj	+ 9.59	Lump Sums	+ 0				
Basement Adj	+ 0.00	RCNLD	= 201,606				
Adj Base Cost	= 129.28	Lot Value	+ 47,880				
Total Area	x 1,467	Indicated Value	= 249,486				
Adjusted Cost	= 189,654	Value Per SqFt	170.07				

Value Reconciliation			
Selected Approach	Cost Approach		
Improvements	201,606		
Lot Value	47,880		
Indicated Value	249,486	170.07	Per SqFt
Agland Value			
Site Improvements			
Total Value	249,486	170.07	Total Value Per SqFt

Miscellaneous Improvements								
Code	Description	Sketch ID	Size	Year	Units	Unit Cost	Depr	Value
PRCH	SLAB PORCH - COVERED	141898	18x10		180	23.64		4,255
PRCH	SLAB PORCH - COVERED	141899	6x5		30	24.17		725
FPR1	FIREPLACE - RESIDENTIAL 1 STORY			1	1	5,095.98		5,096



# Rogers

## Assessment Property Record Card for Tax Year 2026

Data provided by LISA DELOZIER County Assessor

Date 04/17/2026  
 Time 09:27:35  
 Page 3

Sketch Image

660000539

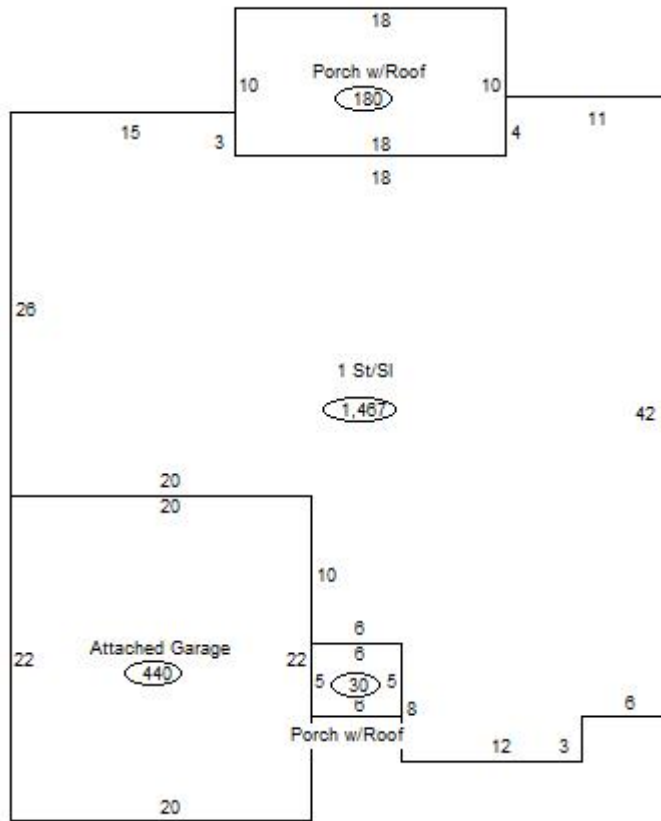

### Sketch Vector Information

Sequence	Code	Type	Built Over	Scale	Section Label	Base Area	Multiplier	Total Area
1	R	1	Slab	13	1 St/Sl	1,467	1.000	1,467
2	G	1		13	Attached Garage	440	1.000	440
3	M	PRCH		13	SLBC	180	1.000	180
4	M	PRCH		13	SLBC	30	1.000	30
<b>Total Building Area</b>						1,467		1,467