



Rogers

Assessment Property Record Card for Tax Year 2026

Data provided by LISA DELOZIER County Assessor

Date 04/18/2026
 Time 05:45:10
 Page 1

Assessment Data					Primary Image																																																																																																																				
Account 660000590 Parcel ID 000000-00-0-00546-001-0009 Cadastral ID 01-21-15-03350 Property Type REAL - Real Property Property Class RRP VI Area 4 Tax Area 8 - CLAREMORE/ NW FIRE Name ID 342226 HERRMAN, JORDON & HEATHER VANDERWEIDE 9865 E NORTHGLEN CLAREMORE OK 74017-0000 Parcel Location Situs 09865 E NORTHGLEN Subdivision NORTHAVEN 3 Lot/Block 0009 / 0001 Parcel Size 1 - Lots Sec/Twn/Rng 1 / 21 / 15 / 5 Neighborhood 1114 - R-V01,4-NW OOLOGAH School District S001 - CLAREMORE SCHOOLS					<p>\\tsclient\C\Users\Randy Necessary\Pictures\101_0316\IMG_0033. 3/17/2022</p>																																																																																																																				
Legal Description Lot/Long: 36.33409666 -95.65332457 LOT 9 BLOCK 1 NORTHAVEN THIRD																																																																																																																									
Exemptions <table border="1"> <thead> <tr> <th>Code</th> <th>Type</th> <th>Active</th> <th>Maximum</th> <th>Exemption</th> </tr> </thead> <tbody> <tr> <td>H</td> <td>Homestead</td> <td>Yes</td> <td>1,000</td> <td>1,000</td> </tr> </tbody> </table>					Code	Type	Active	Maximum	Exemption	H	Homestead	Yes	1,000	1,000	Building Permits <table border="1"> <thead> <tr> <th>Number</th> <th>Description</th> <th>Opened</th> <th>Closed</th> <th>Amount</th> </tr> </thead> <tbody> <tr> <td></td> <td></td> <td></td> <td></td> <td></td> </tr> </tbody> </table>					Number	Description	Opened	Closed	Amount																																																																																																	
Code	Type	Active	Maximum	Exemption																																																																																																																					
H	Homestead	Yes	1,000	1,000																																																																																																																					
Number	Description	Opened	Closed	Amount																																																																																																																					
Parcel Valuation <table border="1"> <thead> <tr> <th>Source</th> <th>REAL</th> <th>Fair Cash</th> <th>Capped</th> <th>Asmnt Level</th> <th>Assessed</th> <th>Levy Rate</th> <th>106.442</th> <th>Current Tax</th> </tr> </thead> <tbody> <tr> <td>Remove Cap</td> <td>2024</td> <td>Land Value 81,731</td> <td>81,731</td> <td>11%</td> <td>8,990</td> <td>Assessed</td> <td>21,757</td> <td>2,315.85</td> </tr> <tr> <td>Year Frozen</td> <td>0</td> <td>Improvements 116,067</td> <td>116,067</td> <td></td> <td>12,767</td> <td>Penalty</td> <td>0</td> <td></td> </tr> <tr> <td>Uncapped Value</td> <td>0</td> <td>Mobile Home 0</td> <td>0</td> <td></td> <td>0</td> <td>Exemption</td> <td>1,000</td> <td>-93.00</td> </tr> <tr> <td>TIF Project ID</td> <td>0</td> <td>Total Value 197,798</td> <td>197,798</td> <td></td> <td>21,757</td> <td>Total Taxable</td> <td>20,757</td> <td>2,223.00</td> </tr> </tbody> </table>					Source	REAL	Fair Cash	Capped	Asmnt Level	Assessed	Levy Rate	106.442	Current Tax	Remove Cap	2024	Land Value 81,731	81,731	11%	8,990	Assessed	21,757	2,315.85	Year Frozen	0	Improvements 116,067	116,067		12,767	Penalty	0		Uncapped Value	0	Mobile Home 0	0		0	Exemption	1,000	-93.00	TIF Project ID	0	Total Value 197,798	197,798		21,757	Total Taxable	20,757	2,223.00	Sale History <table border="1"> <thead> <tr> <th>Bk/Pg</th> <th>Grantor</th> <th>Date</th> <th>Price</th> <th>Code</th> </tr> </thead> <tbody> <tr> <td>/</td> <td>9865 E NORTHGLEN LLC</td> <td>08/01/2023</td> <td>207,000</td> <td>YES</td> </tr> <tr> <td>/</td> <td>STEINMITZ, SHANNON T &</td> <td>09/05/2019</td> <td>155,500</td> <td>YES</td> </tr> <tr> <td>2352/188</td> <td>HANCOCK BUILDERS OF OK LLC</td> <td>08/22/2013</td> <td>81,000</td> <td>YES</td> </tr> <tr> <td>2295/640</td> <td>CROSSWAY REALTY LTD</td> <td>12/28/2012</td> <td>52,500</td> <td>15</td> </tr> <tr> <td>2181/597</td> <td>DEUTSCHE BANK NATIONAL-TRUST</td> <td>07/01/2011</td> <td>49,000</td> <td>3</td> </tr> <tr> <td>2111/320</td> <td>CALVERT, STEPHEN E &-SHARON</td> <td>06/17/2010</td> <td>0</td> <td>10</td> </tr> </tbody> </table>					Bk/Pg	Grantor	Date	Price	Code	/	9865 E NORTHGLEN LLC	08/01/2023	207,000	YES	/	STEINMITZ, SHANNON T &	09/05/2019	155,500	YES	2352/188	HANCOCK BUILDERS OF OK LLC	08/22/2013	81,000	YES	2295/640	CROSSWAY REALTY LTD	12/28/2012	52,500	15	2181/597	DEUTSCHE BANK NATIONAL-TRUST	07/01/2011	49,000	3	2111/320	CALVERT, STEPHEN E &-SHARON	06/17/2010	0	10																																
Source	REAL	Fair Cash	Capped	Asmnt Level	Assessed	Levy Rate	106.442	Current Tax																																																																																																																	
Remove Cap	2024	Land Value 81,731	81,731	11%	8,990	Assessed	21,757	2,315.85																																																																																																																	
Year Frozen	0	Improvements 116,067	116,067		12,767	Penalty	0																																																																																																																		
Uncapped Value	0	Mobile Home 0	0		0	Exemption	1,000	-93.00																																																																																																																	
TIF Project ID	0	Total Value 197,798	197,798		21,757	Total Taxable	20,757	2,223.00																																																																																																																	
Bk/Pg	Grantor	Date	Price	Code																																																																																																																					
/	9865 E NORTHGLEN LLC	08/01/2023	207,000	YES																																																																																																																					
/	STEINMITZ, SHANNON T &	09/05/2019	155,500	YES																																																																																																																					
2352/188	HANCOCK BUILDERS OF OK LLC	08/22/2013	81,000	YES																																																																																																																					
2295/640	CROSSWAY REALTY LTD	12/28/2012	52,500	15																																																																																																																					
2181/597	DEUTSCHE BANK NATIONAL-TRUST	07/01/2011	49,000	3																																																																																																																					
2111/320	CALVERT, STEPHEN E &-SHARON	06/17/2010	0	10																																																																																																																					
Assessment History <table border="1"> <thead> <tr> <th>Tax Year</th> <th>Statement Number</th> <th>Billed Owner</th> <th>Tax Area</th> <th>Total Value</th> <th>Exemptions</th> <th>Taxable Value</th> <th>Billed Tax</th> </tr> </thead> <tbody> <tr><td>2025</td><td>2025-660000590</td><td>HERRMAN, JORDON &</td><td>8</td><td>193,984</td><td>0</td><td>21,338</td><td>2,271.00</td></tr> <tr><td>2024</td><td>2024-660000590</td><td>HERRMAN, JORDON &</td><td>8</td><td>207,118</td><td>0</td><td>22,783</td><td>2,425.00</td></tr> <tr><td>2023</td><td>2023-660000590</td><td>HERRMAN, JORDON &</td><td>8</td><td>170,391</td><td>0</td><td>17,843</td><td>1,884.00</td></tr> <tr><td>2022</td><td>2022-660000590</td><td>9865 E NORTHGLEN LLC</td><td>8</td><td>154,489</td><td>0</td><td>16,994</td><td>1,806.00</td></tr> <tr><td>2021</td><td>2021-660000590</td><td>9865 E NORTHGLEN LLC</td><td>8</td><td>160,797</td><td>0</td><td>17,688</td><td>1,803.00</td></tr> <tr><td>2020</td><td>2020-660000590</td><td>9865 E NORTHGLEN LLC</td><td>8</td><td>158,275</td><td>0</td><td>17,410</td><td>1,839.00</td></tr> <tr><td>2019</td><td>2019-660000590</td><td>9865 E NORTHGLEN LLC</td><td>8</td><td>108,511</td><td>0</td><td>11,936</td><td>1,274.00</td></tr> <tr><td>2018</td><td>2018-660000590</td><td>STEINMITZ, SHANNON T &</td><td>8</td><td>110,525</td><td>0</td><td>11,789</td><td>1,256.00</td></tr> <tr><td>2017</td><td>2017-660000590</td><td>STEINMITZ, SHANNON T &</td><td>8</td><td>109,727</td><td>0</td><td>11,227</td><td>1,177.00</td></tr> <tr><td>2016</td><td>2016-660000590</td><td>STEINMITZ, SHANNON T &</td><td>8</td><td>107,202</td><td>0</td><td>10,693</td><td>1,153.00</td></tr> <tr><td>2015</td><td>2015-660000590</td><td>STEINMITZ, SHANNON T &</td><td>8</td><td>106,448</td><td>0</td><td>10,184</td><td>1,048.00</td></tr> <tr><td>2014</td><td>2014-660000590</td><td>STEINMITZ, SHANNON T &</td><td>8</td><td>88,170</td><td>0</td><td>9,699</td><td>1,013.00</td></tr> <tr><td>2013</td><td>2013-660000590</td><td>STEINMITZ, SHANNON T &</td><td>8</td><td>89,874</td><td>0</td><td>9,886</td><td>1,019.00</td></tr> </tbody> </table>										Tax Year	Statement Number	Billed Owner	Tax Area	Total Value	Exemptions	Taxable Value	Billed Tax	2025	2025-660000590	HERRMAN, JORDON &	8	193,984	0	21,338	2,271.00	2024	2024-660000590	HERRMAN, JORDON &	8	207,118	0	22,783	2,425.00	2023	2023-660000590	HERRMAN, JORDON &	8	170,391	0	17,843	1,884.00	2022	2022-660000590	9865 E NORTHGLEN LLC	8	154,489	0	16,994	1,806.00	2021	2021-660000590	9865 E NORTHGLEN LLC	8	160,797	0	17,688	1,803.00	2020	2020-660000590	9865 E NORTHGLEN LLC	8	158,275	0	17,410	1,839.00	2019	2019-660000590	9865 E NORTHGLEN LLC	8	108,511	0	11,936	1,274.00	2018	2018-660000590	STEINMITZ, SHANNON T &	8	110,525	0	11,789	1,256.00	2017	2017-660000590	STEINMITZ, SHANNON T &	8	109,727	0	11,227	1,177.00	2016	2016-660000590	STEINMITZ, SHANNON T &	8	107,202	0	10,693	1,153.00	2015	2015-660000590	STEINMITZ, SHANNON T &	8	106,448	0	10,184	1,048.00	2014	2014-660000590	STEINMITZ, SHANNON T &	8	88,170	0	9,699	1,013.00	2013	2013-660000590	STEINMITZ, SHANNON T &	8	89,874	0	9,886	1,019.00
Tax Year	Statement Number	Billed Owner	Tax Area	Total Value	Exemptions	Taxable Value	Billed Tax																																																																																																																		
2025	2025-660000590	HERRMAN, JORDON &	8	193,984	0	21,338	2,271.00																																																																																																																		
2024	2024-660000590	HERRMAN, JORDON &	8	207,118	0	22,783	2,425.00																																																																																																																		
2023	2023-660000590	HERRMAN, JORDON &	8	170,391	0	17,843	1,884.00																																																																																																																		
2022	2022-660000590	9865 E NORTHGLEN LLC	8	154,489	0	16,994	1,806.00																																																																																																																		
2021	2021-660000590	9865 E NORTHGLEN LLC	8	160,797	0	17,688	1,803.00																																																																																																																		
2020	2020-660000590	9865 E NORTHGLEN LLC	8	158,275	0	17,410	1,839.00																																																																																																																		
2019	2019-660000590	9865 E NORTHGLEN LLC	8	108,511	0	11,936	1,274.00																																																																																																																		
2018	2018-660000590	STEINMITZ, SHANNON T &	8	110,525	0	11,789	1,256.00																																																																																																																		
2017	2017-660000590	STEINMITZ, SHANNON T &	8	109,727	0	11,227	1,177.00																																																																																																																		
2016	2016-660000590	STEINMITZ, SHANNON T &	8	107,202	0	10,693	1,153.00																																																																																																																		
2015	2015-660000590	STEINMITZ, SHANNON T &	8	106,448	0	10,184	1,048.00																																																																																																																		
2014	2014-660000590	STEINMITZ, SHANNON T &	8	88,170	0	9,699	1,013.00																																																																																																																		
2013	2013-660000590	STEINMITZ, SHANNON T &	8	89,874	0	9,886	1,019.00																																																																																																																		



Rogers

Assessment Property Record Card for Tax Year 2026

Data provided by LISA DELOZIER County Assessor

Date 04/18/2026
Time 05:45:10
Page 2

Lot Data	Square-Foot - NBHD 1114 #1	Primary Image
Lot Size		
Lot Count	1	
Units Buildable	1	
Non-Ag Acres	1.1562	
Topography		
Street Access		
Utilities		
Amenities	LAND VALUE	
	0	
	0	
Method	Square-Foot	
Base Lot Value	50,366.00 x 1.44 = 72,418	
Factor Value		
Adjustments	1.1286	
Lot Value	81,731	

Residential Data	
Type	1 Single Family Residence
Condition	3 - Average
Quality	2 - Fair
Architecture	
Style	100% One Story
Exterior Wall	80% Frame, Siding, Wood 20% Veneer, Stone
Base/Total Area	1,704 / 1,704
Style	100% One Story
HVAC	100% Warmed & Cooled Air
Roof Cover	1 Composition Shingle
Area on Slab	1,704
Fixture/RghIn	11 /
Bed/F/H Bath	3 / 2.0 /
Basement Area	
Garage Type	525 Attached Garage - Unfinished
Remodel	
Year/Eff Age	1979 / 35



\\tsclient\C\Users\Randy Necessary\Pictures\101_0316\IMG_0033. 3/17/2022

GRM Approach	
GRM Code	
Gross Rent	0.00
Indicated Value	

Multiple Regression			
MRA Code	1	Test	
Adjusted R	0.8445		
Indicated Value	157,978	92.71	Per SqFt

Direct Comparables	
Selection Model	A Adam Test
Adjustment Model	1 2022 Residential
Comparables	3
Indicated Value	253,160 Per SqFt

Cost Approach				Manual : 01/2025			
Base Cost	88.35	Total Misc Impr	+	12,428			
Roofing Adj	+ 3.87	Garage Cost	+	12,122			
Subfloor Adj	+ 0.00	Total RCN	=	211,888			
Heat/Cool Adj	+ 10.30	Depreciation (46%)	-	97,468			
Plumbing Adj	+ 7.42	Lump Sums	+	0			
Basement Adj	+ 0.00	RCNLD	=	114,420			
Adj Base Cost	= 109.94	Lot Value	+	81,731			
Total Area	x 1,704	Indicated Value	=	196,151			
Adjusted Cost	= 187,338	Value Per SqFt		115.11			

Value Reconciliation			
Selected Approach	Cost Approach		
Improvements	114,420		
Lot Value	81,731		
Indicated Value	196,151	115.11	Per SqFt
Agland Value			
Site Improvements	1,647		
Total Value	197,798	116.08	Total Value Per SqFt

Miscellaneous Improvements								
Code	Description	Sketch ID	Size	Year	Units	Unit Cost	Depr	Value
FPR1	FIREPLACE - RESIDENTIAL 1 STORY	0		1	1	4,576.55		4,577
PRCH	SLAB PORCH - COVERED	1778		236	236	20.55		4,850
PRCH	SLAB PORCH - COVERED	1779	12x12		144	20.84		3,001



Rogers

Assessment Property Record Card for Tax Year 2026

Data provided by LISA DELOZIER County Assessor

Date 04/18/2026

Time 05:45:10

Page 3

Sketch Image

660000590

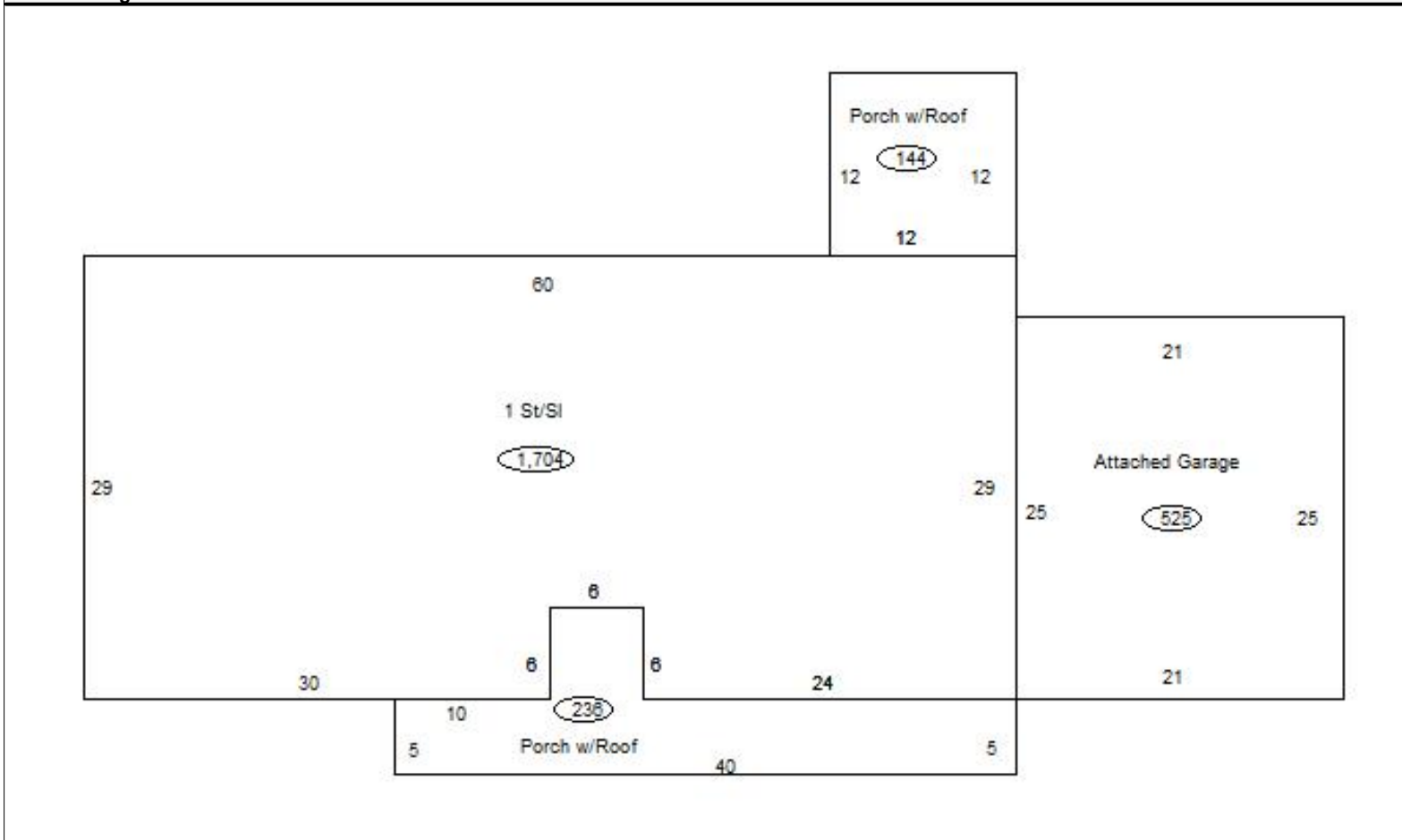

Sketch Vector Information

Sequence	Code	Type	Built Over	Scale	Section Label	Base Area	Multiplier	Total Area
1	R	1	Slab	13	1 St/Sl	1,704	1.000	1,704
2	G	1		13	Attached Garage	525	1.000	525
3	M	PRCH		13	SLBC	236	1.000	236
4	M	PRCH		13	SLBC	144	1.000	144
Total Building Area						1,704		1,704



Rogers

Assessment Property Record Card for Tax Year 2026

Data provided by LISA DELOZIER County Assessor

Date 04/18/2026
Time 05:45:11
Page 4

660000590

Outbuildings/Site Improvements

Building Image	Code	Description	Dimensions	Floor	Roofing	Total Units
	STF	STG FAIR	16x22x0			352
	Qual	2	Cond 3	Year 2018	Eff Age 6	
Valuation Summary		Modifier Total		RCN	Depr (0% Phys/ % Func)	RCNLD
Base Cost (4.68 x 352)		1,647			1,647	1,647