



# Rogers

## Assessment Property Record Card for Tax Year 2026

Data provided by LISA DELOZIER County Assessor

Date 04/17/2026  
Time 12:32:34  
Page 1

Assessment Data					Primary Image																																																																																																																				
<b>Account</b> 660000606 <b>Parcel ID</b> 000000-00-0-00414-001-0005 <b>Cadastral ID</b> 01-21-16-00140 <b>Property Type</b> REAL - Real Property <b>Property Class</b> RRP VI Area 1 <b>Tax Area</b> 93 - JUSTUS/TRI-DISTRICT FIRE <b>Name ID</b> 324963 WHITETAIL LLC  13947 E CRESTVIEW DR CLAREMORE OK 74019-0000  <b>Parcel Location</b> <b>Situs</b> 15055 E 480 RD <b>Subdivision</b> KINGS RIDGE ESTATE <b>Lot/Block</b> 0005 / 0001 <b>Parcel Size</b> 1 - Lots <b>Sec/Twn/Rng</b> 1 / 21 / 16 / 5 <b>Neighborhood</b> 1109 - R-V03-SW VERDIGRIS <b>School District</b> S009 - JUSTUS-TIAWAH SCHOOLS																																																																																																																									
<b>Legal Description</b> Lot/Long: 36.32224854 -95.56054036																																																																																																																									
<b>Building Permits</b>					<table border="1"> <thead> <tr> <th>Number</th> <th>Description</th> <th>Opened</th> <th>Closed</th> <th>Amount</th> </tr> </thead> <tbody> <tr> <td colspan="5"> </td> </tr> </tbody> </table>					Number	Description	Opened	Closed	Amount																																																																																																											
Number	Description	Opened	Closed	Amount																																																																																																																					
<b>Exemptions</b>					<b>Sale History</b>																																																																																																																				
<table border="1"> <thead> <tr> <th>Code</th> <th>Type</th> <th>Active</th> <th>Maximum</th> <th>Exemption</th> </tr> </thead> <tbody> <tr> <td colspan="5"> </td> </tr> </tbody> </table>					Code	Type	Active	Maximum	Exemption						<table border="1"> <thead> <tr> <th>Bk/Pg</th> <th>Grantor</th> <th>Date</th> <th>Price</th> <th>Code</th> </tr> </thead> <tbody> <tr> <td>2720/860</td> <td>SL LLC</td> <td>06/29/2018</td> <td>514,000</td> <td>WB</td> </tr> <tr> <td>1317/189</td> <td>MCDANIEL, STANLEY A &amp;</td> <td>08/28/2001</td> <td>0</td> <td>4</td> </tr> <tr> <td>866/492</td> <td></td> <td>11/01/1991</td> <td>59,000</td> <td>No</td> </tr> </tbody> </table>					Bk/Pg	Grantor	Date	Price	Code	2720/860	SL LLC	06/29/2018	514,000	WB	1317/189	MCDANIEL, STANLEY A &	08/28/2001	0	4	866/492		11/01/1991	59,000	No																																																																																		
Code	Type	Active	Maximum	Exemption																																																																																																																					
Bk/Pg	Grantor	Date	Price	Code																																																																																																																					
2720/860	SL LLC	06/29/2018	514,000	WB																																																																																																																					
1317/189	MCDANIEL, STANLEY A &	08/28/2001	0	4																																																																																																																					
866/492		11/01/1991	59,000	No																																																																																																																					
<b>Parcel Valuation</b>																																																																																																																									
<table border="1"> <thead> <tr> <th>Source</th> <th>REAL</th> <th>Fair Cash</th> <th>Capped</th> <th>Asmnt Level</th> <th>Assessed</th> <th>Levy Rate</th> <th>93.050</th> <th>Current Tax</th> </tr> </thead> <tbody> <tr> <td>Remove Cap</td> <td>2019</td> <td>Land Value</td> <td>72,579</td> <td>41,438</td> <td>11%</td> <td>4,558</td> <td>Assessed</td> <td>17,987</td> <td>1,673.69</td> </tr> <tr> <td>Year Frozen</td> <td>0</td> <td>Improvements</td> <td>126,455</td> <td>122,079</td> <td></td> <td>13,429</td> <td>Penalty</td> <td>0</td> <td></td> </tr> <tr> <td>Uncapped Value</td> <td>0</td> <td>Mobile Home</td> <td>0</td> <td>0</td> <td></td> <td>0</td> <td>Exemption</td> <td>0</td> <td>0.00</td> </tr> <tr> <td>TIF Project ID</td> <td>0</td> <td>Total Value</td> <td>199,034</td> <td>163,517</td> <td></td> <td>17,987</td> <td>Total Taxable</td> <td>17,987</td> <td>1,674.00</td> </tr> </tbody> </table>		Source	REAL	Fair Cash	Capped	Asmnt Level	Assessed	Levy Rate	93.050	Current Tax	Remove Cap	2019	Land Value	72,579	41,438	11%	4,558	Assessed	17,987	1,673.69	Year Frozen	0	Improvements	126,455	122,079		13,429	Penalty	0		Uncapped Value	0	Mobile Home	0	0		0	Exemption	0	0.00	TIF Project ID	0	Total Value	199,034	163,517		17,987	Total Taxable	17,987	1,674.00																																																																							
Source	REAL	Fair Cash	Capped	Asmnt Level	Assessed	Levy Rate	93.050	Current Tax																																																																																																																	
Remove Cap	2019	Land Value	72,579	41,438	11%	4,558	Assessed	17,987	1,673.69																																																																																																																
Year Frozen	0	Improvements	126,455	122,079		13,429	Penalty	0																																																																																																																	
Uncapped Value	0	Mobile Home	0	0		0	Exemption	0	0.00																																																																																																																
TIF Project ID	0	Total Value	199,034	163,517		17,987	Total Taxable	17,987	1,674.00																																																																																																																
<b>Assessment History</b>																																																																																																																									
<table border="1"> <thead> <tr> <th>Tax Year</th> <th>Statement Number</th> <th>Billed Owner</th> <th>Tax Area</th> <th>Total Value</th> <th>Exemptions</th> <th>Taxable Value</th> <th>Billed Tax</th> </tr> </thead> <tbody> <tr><td>2025</td><td>2025-660000606</td><td>WHITETAIL LLC</td><td>93</td><td>194,951</td><td>0</td><td>17,130</td><td>1,594.00</td></tr> <tr><td>2024</td><td>2024-660000606</td><td>WHITETAIL LLC</td><td>93</td><td>194,709</td><td>0</td><td>16,314</td><td>1,622.00</td></tr> <tr><td>2023</td><td>2023-660000606</td><td>WHITETAIL LLC</td><td>93</td><td>163,925</td><td>0</td><td>15,538</td><td>1,543.00</td></tr> <tr><td>2022</td><td>2022-660000606</td><td>WHITETAIL LLC</td><td>93</td><td>134,528</td><td>0</td><td>14,798</td><td>1,468.00</td></tr> <tr><td>2021</td><td>2021-660000606</td><td>WHITETAIL LLC</td><td>93</td><td>143,627</td><td>0</td><td>15,799</td><td>1,593.00</td></tr> <tr><td>2020</td><td>2020-660000606</td><td>WHITETAIL LLC</td><td>93</td><td>141,427</td><td>0</td><td>15,557</td><td>1,519.00</td></tr> <tr><td>2019</td><td>2019-660000606</td><td>WHITETAIL LLC</td><td>93</td><td>136,534</td><td>0</td><td>15,019</td><td>1,496.00</td></tr> <tr><td>2018</td><td>2018-660000606</td><td>WHITETAIL LLC</td><td>93</td><td>127,374</td><td>0</td><td>13,662</td><td>1,362.00</td></tr> <tr><td>2017</td><td>2017-660000606</td><td>MCDANIEL, LINDA L REVOC TRUST</td><td>93</td><td>126,383</td><td>0</td><td>13,012</td><td>1,230.00</td></tr> <tr><td>2016</td><td>2016-660000606</td><td>MCDANIEL, LINDA L REVOC TRUST</td><td>93</td><td>123,342</td><td>0</td><td>12,392</td><td>1,218.00</td></tr> <tr><td>2015</td><td>2015-660000606</td><td>MCDANIEL, LINDA L REVOC TRUST</td><td>93</td><td>122,914</td><td>0</td><td>11,802</td><td>1,150.00</td></tr> <tr><td>2014</td><td>2014-660000606</td><td>MCDANIEL, LINDA L REVOC TRUST</td><td>93</td><td>123,875</td><td>0</td><td>11,240</td><td>1,077.00</td></tr> <tr><td>2013</td><td>2013-660000606</td><td>MCDANIEL, LINDA L REVOC TRUST</td><td>93</td><td>117,844</td><td>0</td><td>10,706</td><td>1,040.00</td></tr> </tbody> </table>										Tax Year	Statement Number	Billed Owner	Tax Area	Total Value	Exemptions	Taxable Value	Billed Tax	2025	2025-660000606	WHITETAIL LLC	93	194,951	0	17,130	1,594.00	2024	2024-660000606	WHITETAIL LLC	93	194,709	0	16,314	1,622.00	2023	2023-660000606	WHITETAIL LLC	93	163,925	0	15,538	1,543.00	2022	2022-660000606	WHITETAIL LLC	93	134,528	0	14,798	1,468.00	2021	2021-660000606	WHITETAIL LLC	93	143,627	0	15,799	1,593.00	2020	2020-660000606	WHITETAIL LLC	93	141,427	0	15,557	1,519.00	2019	2019-660000606	WHITETAIL LLC	93	136,534	0	15,019	1,496.00	2018	2018-660000606	WHITETAIL LLC	93	127,374	0	13,662	1,362.00	2017	2017-660000606	MCDANIEL, LINDA L REVOC TRUST	93	126,383	0	13,012	1,230.00	2016	2016-660000606	MCDANIEL, LINDA L REVOC TRUST	93	123,342	0	12,392	1,218.00	2015	2015-660000606	MCDANIEL, LINDA L REVOC TRUST	93	122,914	0	11,802	1,150.00	2014	2014-660000606	MCDANIEL, LINDA L REVOC TRUST	93	123,875	0	11,240	1,077.00	2013	2013-660000606	MCDANIEL, LINDA L REVOC TRUST	93	117,844	0	10,706	1,040.00
Tax Year	Statement Number	Billed Owner	Tax Area	Total Value	Exemptions	Taxable Value	Billed Tax																																																																																																																		
2025	2025-660000606	WHITETAIL LLC	93	194,951	0	17,130	1,594.00																																																																																																																		
2024	2024-660000606	WHITETAIL LLC	93	194,709	0	16,314	1,622.00																																																																																																																		
2023	2023-660000606	WHITETAIL LLC	93	163,925	0	15,538	1,543.00																																																																																																																		
2022	2022-660000606	WHITETAIL LLC	93	134,528	0	14,798	1,468.00																																																																																																																		
2021	2021-660000606	WHITETAIL LLC	93	143,627	0	15,799	1,593.00																																																																																																																		
2020	2020-660000606	WHITETAIL LLC	93	141,427	0	15,557	1,519.00																																																																																																																		
2019	2019-660000606	WHITETAIL LLC	93	136,534	0	15,019	1,496.00																																																																																																																		
2018	2018-660000606	WHITETAIL LLC	93	127,374	0	13,662	1,362.00																																																																																																																		
2017	2017-660000606	MCDANIEL, LINDA L REVOC TRUST	93	126,383	0	13,012	1,230.00																																																																																																																		
2016	2016-660000606	MCDANIEL, LINDA L REVOC TRUST	93	123,342	0	12,392	1,218.00																																																																																																																		
2015	2015-660000606	MCDANIEL, LINDA L REVOC TRUST	93	122,914	0	11,802	1,150.00																																																																																																																		
2014	2014-660000606	MCDANIEL, LINDA L REVOC TRUST	93	123,875	0	11,240	1,077.00																																																																																																																		
2013	2013-660000606	MCDANIEL, LINDA L REVOC TRUST	93	117,844	0	10,706	1,040.00																																																																																																																		



# Rogers

## Assessment Property Record Card for Tax Year 2026

Data provided by LISA DELOZIER County Assessor

Date 04/17/2026  
Time 12:32:34  
Page 2

Lot Data	Square-Foot - NBHD 1109 #1	Primary Image
<b>Lot Size</b> <b>Lot Count</b> 1 <b>Units Buildable</b> 1 <b>Non-Ag Acres</b> 2.1575 <b>Topography</b> <b>Street Access</b> <b>Utilities</b> <b>Amenities</b> 0  <b>Method</b> Square-Foot <b>Base Lot Value</b> 93,980.00 x .97 = 90,724 <b>Factor Value</b> <b>Adjustments</b> 0.8000 <b>Lot Value</b> 72,579		

Residential Data	
<b>Type</b>	1 Single Family Residence
<b>Condition</b>	3 - Average
<b>Quality</b>	3 - Average
<b>Architecture</b>	
<b>Style</b>	100% One Story
<b>Exterior Wall</b>	50% Veneer, Stone 50% Frame, Siding, Wood
<b>Base/Total Area</b>	1,446 / 1,446
<b>Style</b>	100% One Story
<b>HVAC</b>	100% Warmed & Cooled Air
<b>Roof Cover</b>	1 Composition Shingle
<b>Area on Slab</b>	1,446
<b>Fixture/RghIn</b>	11 /
<b>Bed/F/H Bath</b>	3 / 2.0 /
<b>Basement Area</b>	
<b>Garage Type</b>	594 Attached Garage - Unfinished
<b>Remodel</b>	
<b>Year/Eff Age</b>	1977 / 37

\\tsclient\T\LOGAN\LOGAN RESIDENTIAL VI\2023-2-21\IMG_007: 2/22/2023	
--	--

GRM Approach	
<b>GRM Code</b>	
<b>Gross Rent</b>	0.00
<b>Indicated Value</b>	

Multiple Regression			
<b>MRA Code</b>	1	Test	
<b>Adusted R</b>	0.8445		
<b>Indicated Value</b>	183,460	126.87	Per SqFt

Direct Comparables			
<b>Selection Model</b>	A	Adam Test	
<b>Adjustment Model</b>	1	2022 Residential	
<b>Comparables</b>	2		
<b>Indicated Value</b>	249,980		Per SqFt

Cost Approach				Manual : 01/2025			
<b>Base Cost</b>	109.13	<b>Total Misc Impr</b>	+ 7,485				
<b>Roofing Adj</b>	+ 4.83	<b>Garage Cost</b>	+ 18,194				
<b>Subfloor Adj</b>	+ -2.36	<b>Total RCN</b>	= 220,846				
<b>Heat/Cool Adj</b>	+ 12.64	<b>Depreciation ( 44%)</b>	- 97,172				
<b>Plumbing Adj</b>	+ 10.73	<b>Lump Sums</b>	+ 2,781				
<b>Basement Adj</b>	+ 0.00	<b>RCNLD</b>	= 126,455				
<b>Adj Base Cost</b>	= 134.97	<b>Lot Value</b>	+ 72,579				
<b>Total Area</b>	x 1,446	<b>Indicated Value</b>	= 199,034				
<b>Adjusted Cost</b>	= 195,167	<b>Value Per SqFt</b>	137.64				

Value Reconciliation			
<b>Selected Approach</b>	Cost Approach		
<b>Improvements</b>	126,455		
<b>Lot Value</b>	72,579		
<b>Indicated Value</b>	199,034	137.64	Per SqFt
<b>Agland Value</b>			
<b>Site Improvements</b>			
<b>Total Value</b>	199,034	137.64	Total Value Per SqFt

Miscellaneous Improvements								
Code	Description	Sketch ID	Size	Year	Units	Unit Cost	Depr	Value
FPR1	FIREPLACE - RESIDENTIAL 1 STORY	0		1	1	5,615.40		5,615
WODC	WOOD DECK - COVERED	1846	14x12		168	41.39	60%	2,781
PRCH	SLAB PORCH - COVERED	1847	14x5		70	26.71		1,870



# Rogers

## Assessment Property Record Card for Tax Year 2026

Data provided by LISA DELOZIER County Assessor

Date 04/17/2026

Time 12:32:34

Page 3

### Sketch Image

660000606

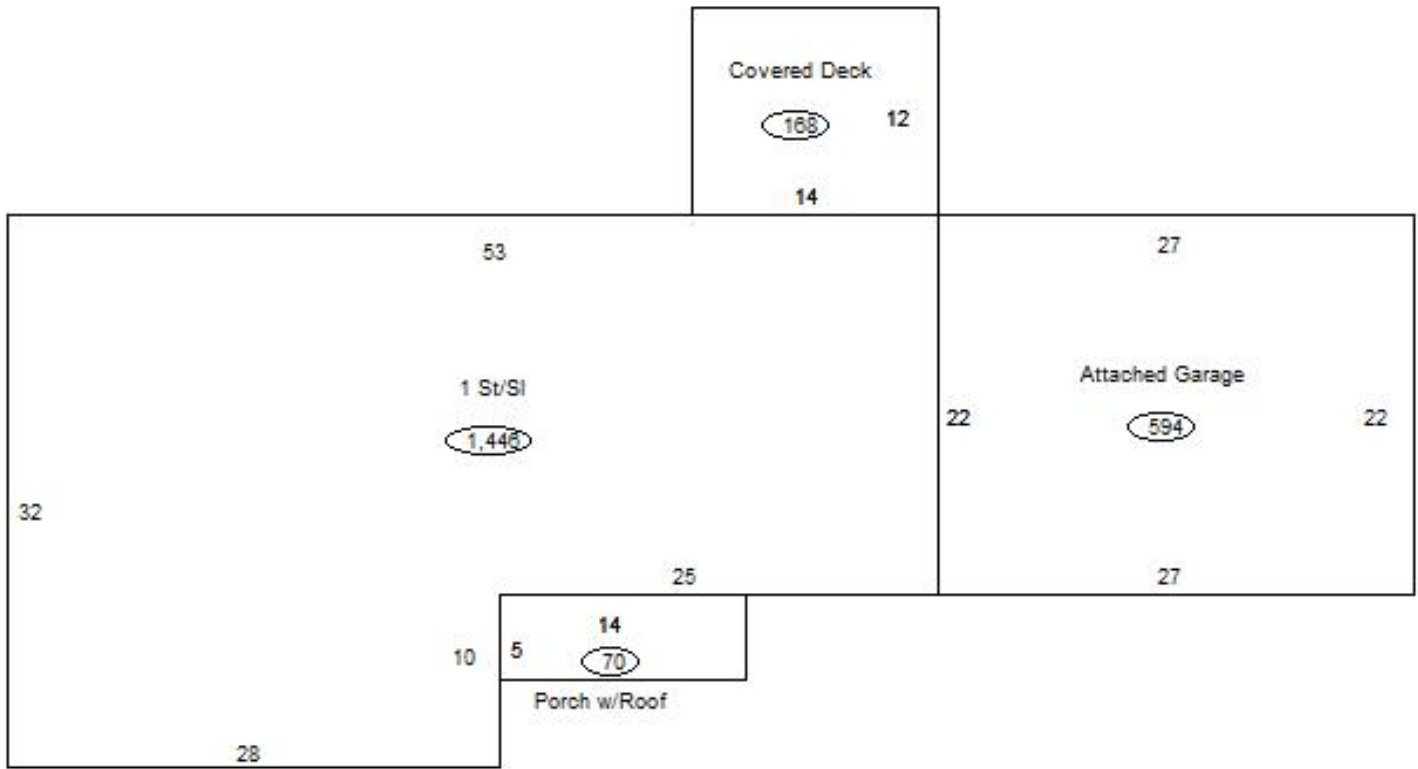

### Sketch Vector Information

Sequence	Code	Type	Built Over	Scale	Section Label	Base Area	Multiplier	Total Area
1	R	1	Slab	13	1 St/SI	1,446	1.000	1,446
2	G	1		13	Attached Garage	594	1.000	594
3	M	WODC		13	WODC	168	1.000	168
4	M	PRCH		13	SLBC	70	1.000	70
<b>Total Building Area</b>						1,446		1,446