



# Rogers

## Assessment Property Record Card for Tax Year 2026

Data provided by LISA DELOZIER County Assessor

Date 04/17/2026  
Time 03:15:04  
Page 1

Assessment Data					Primary Image																																																																																																																				
<b>Account</b> 660000619 <b>Parcel ID</b> 000000-00-0-00417-002-0002 <b>Cadastral ID</b> 01-21-16-00270 <b>Property Type</b> REAL - Real Property <b>Property Class</b> RRP VI Area 1 <b>Tax Area</b> 93 - JUSTUS/TRI-DISTRICT FIRE <b>Name ID</b> 271564 BLAIR, MICHEL D  19672 S RIDGEMONT DR CLAREMORE OK 74017-0000  <b>Parcel Location</b> <b>Situs</b> 19672 S RIDGEMONT DR <b>Subdivision</b> KINGS RIDGE ESTS 2 <b>Lot/Block</b> 0002 / 0002 <b>Parcel Size</b> 1 - Lots <b>Sec/Twn/Rng</b> 1 / 21 / 16 / 5 <b>Neighborhood</b> 1109 - R-V03-SW VERDIGRIS <b>School District</b> S009 - JUSTUS-TIAWAH SCHOOLS																																																																																																																									
<b>Legal Description</b> Lot/Long: 36.32428105 -95.55831967 LOT 2 BLOCK 2 KINGS RIDGE EST. 2																																																																																																																									
<b>Exemptions</b> <table border="1"> <thead> <tr> <th>Code</th> <th>Type</th> <th>Active</th> <th>Maximum</th> <th>Exemption</th> </tr> </thead> <tbody> <tr> <td>H</td> <td>Homestead</td> <td>Yes</td> <td>1,000</td> <td>1,000</td> </tr> </tbody> </table>					Code	Type	Active	Maximum	Exemption	H	Homestead	Yes	1,000	1,000	<b>Building Permits</b> <table border="1"> <thead> <tr> <th>Number</th> <th>Description</th> <th>Opened</th> <th>Closed</th> <th>Amount</th> </tr> </thead> <tbody> <tr> <td></td> <td></td> <td></td> <td></td> <td></td> </tr> </tbody> </table>					Number	Description	Opened	Closed	Amount																																																																																																	
Code	Type	Active	Maximum	Exemption																																																																																																																					
H	Homestead	Yes	1,000	1,000																																																																																																																					
Number	Description	Opened	Closed	Amount																																																																																																																					
<b>Parcel Valuation</b> <table border="1"> <thead> <tr> <th>Source</th> <th>REAL</th> <th>Fair Cash</th> <th>Capped</th> <th>Asmnt Level</th> <th>Assessed</th> <th>Levy Rate</th> <th>93.050</th> <th>Current Tax</th> </tr> </thead> <tbody> <tr> <td>Remove Cap</td> <td>2000</td> <td>Land Value 88,464</td> <td>33,234</td> <td>11%</td> <td>3,656</td> <td>Assessed</td> <td>17,364</td> <td>1,615.72</td> </tr> <tr> <td>Year Frozen</td> <td>0</td> <td>Improvements 147,063</td> <td>124,615</td> <td></td> <td>13,708</td> <td>Penalty</td> <td>0</td> <td></td> </tr> <tr> <td>Uncapped Value</td> <td>0</td> <td>Mobile Home 0</td> <td>0</td> <td></td> <td>0</td> <td>Exemption</td> <td>1,000</td> <td>-83.00</td> </tr> <tr> <td>TIF Project ID</td> <td>0</td> <td>Total Value 235,527</td> <td>157,849</td> <td></td> <td>17,364</td> <td>Total Taxable</td> <td>16,364</td> <td>1,533.00</td> </tr> </tbody> </table>					Source	REAL	Fair Cash	Capped	Asmnt Level	Assessed	Levy Rate	93.050	Current Tax	Remove Cap	2000	Land Value 88,464	33,234	11%	3,656	Assessed	17,364	1,615.72	Year Frozen	0	Improvements 147,063	124,615		13,708	Penalty	0		Uncapped Value	0	Mobile Home 0	0		0	Exemption	1,000	-83.00	TIF Project ID	0	Total Value 235,527	157,849		17,364	Total Taxable	16,364	1,533.00	<b>Sale History</b> <table border="1"> <thead> <tr> <th>Bk/Pg</th> <th>Grantor</th> <th>Date</th> <th>Price</th> <th>Code</th> </tr> </thead> <tbody> <tr> <td>2464/69</td> <td>BLAIR, MICHEL D &amp; ROBIN K</td> <td>04/01/2015</td> <td>0</td> <td>4</td> </tr> <tr> <td>1178/694</td> <td>BARY, STEVEN D</td> <td>06/25/1999</td> <td>96,000</td> <td>Yes</td> </tr> <tr> <td>1118/582</td> <td>BRASSFIELD, KARLTON L &amp;</td> <td>06/19/1998</td> <td>91,500</td> <td>No</td> </tr> <tr> <td>1002/511</td> <td>VANCE, IMOGENE G</td> <td>08/28/1995</td> <td>74,500</td> <td>Yes</td> </tr> </tbody> </table>					Bk/Pg	Grantor	Date	Price	Code	2464/69	BLAIR, MICHEL D & ROBIN K	04/01/2015	0	4	1178/694	BARY, STEVEN D	06/25/1999	96,000	Yes	1118/582	BRASSFIELD, KARLTON L &	06/19/1998	91,500	No	1002/511	VANCE, IMOGENE G	08/28/1995	74,500	Yes																																										
Source	REAL	Fair Cash	Capped	Asmnt Level	Assessed	Levy Rate	93.050	Current Tax																																																																																																																	
Remove Cap	2000	Land Value 88,464	33,234	11%	3,656	Assessed	17,364	1,615.72																																																																																																																	
Year Frozen	0	Improvements 147,063	124,615		13,708	Penalty	0																																																																																																																		
Uncapped Value	0	Mobile Home 0	0		0	Exemption	1,000	-83.00																																																																																																																	
TIF Project ID	0	Total Value 235,527	157,849		17,364	Total Taxable	16,364	1,533.00																																																																																																																	
Bk/Pg	Grantor	Date	Price	Code																																																																																																																					
2464/69	BLAIR, MICHEL D & ROBIN K	04/01/2015	0	4																																																																																																																					
1178/694	BARY, STEVEN D	06/25/1999	96,000	Yes																																																																																																																					
1118/582	BRASSFIELD, KARLTON L &	06/19/1998	91,500	No																																																																																																																					
1002/511	VANCE, IMOGENE G	08/28/1995	74,500	Yes																																																																																																																					
<b>Assessment History</b> <table border="1"> <thead> <tr> <th>Tax Year</th> <th>Statement Number</th> <th>Billed Owner</th> <th>Tax Area</th> <th>Total Value</th> <th>Exemptions</th> <th>Taxable Value</th> <th>Billed Tax</th> </tr> </thead> <tbody> <tr><td>2025</td><td>2025-660000619</td><td>BLAIR, MICHEL D</td><td>93</td><td>223,724</td><td>1000</td><td>15,857</td><td>1,486.00</td></tr> <tr><td>2024</td><td>2024-660000619</td><td>BLAIR, MICHEL D</td><td>93</td><td>210,104</td><td>1000</td><td>15,366</td><td>1,544.00</td></tr> <tr><td>2023</td><td>2023-660000619</td><td>BLAIR, MICHEL D</td><td>93</td><td>175,002</td><td>1000</td><td>14,890</td><td>1,494.00</td></tr> <tr><td>2022</td><td>2022-660000619</td><td>BLAIR, MICHEL D</td><td>93</td><td>140,249</td><td>1000</td><td>14,427</td><td>1,447.00</td></tr> <tr><td>2021</td><td>2021-660000619</td><td>BLAIR, MICHEL D</td><td>93</td><td>137,454</td><td>1000</td><td>14,120</td><td>1,440.00</td></tr> <tr><td>2020</td><td>2020-660000619</td><td>BLAIR, MICHEL D</td><td>93</td><td>138,311</td><td>1000</td><td>13,976</td><td>1,378.00</td></tr> <tr><td>2019</td><td>2019-660000619</td><td>BLAIR, MICHEL D</td><td>93</td><td>132,180</td><td>1000</td><td>13,540</td><td>1,362.00</td></tr> <tr><td>2018</td><td>2018-660000619</td><td>BLAIR, MICHEL D</td><td>93</td><td>135,815</td><td>1000</td><td>13,940</td><td>1,402.00</td></tr> <tr><td>2017</td><td>2017-660000619</td><td>BLAIR, MICHEL D</td><td>93</td><td>134,761</td><td>1000</td><td>13,824</td><td>1,320.00</td></tr> <tr><td>2016</td><td>2016-660000619</td><td>BLAIR, MICHEL D</td><td>93</td><td>131,720</td><td>1000</td><td>13,489</td><td>1,339.00</td></tr> <tr><td>2015</td><td>2015-660000619</td><td>BLAIR, MICHEL D</td><td>93</td><td>131,370</td><td>1000</td><td>13,219</td><td>1,302.00</td></tr> <tr><td>2014</td><td>2014-660000619</td><td>BLAIR, MICHEL D &amp; ROBIN K</td><td>93</td><td>133,776</td><td>1000</td><td>12,805</td><td>1,237.00</td></tr> <tr><td>2013</td><td>2013-660000619</td><td>BLAIR, MICHEL D &amp; ROBIN K</td><td>93</td><td>128,502</td><td>1000</td><td>12,403</td><td>1,214.00</td></tr> </tbody> </table>										Tax Year	Statement Number	Billed Owner	Tax Area	Total Value	Exemptions	Taxable Value	Billed Tax	2025	2025-660000619	BLAIR, MICHEL D	93	223,724	1000	15,857	1,486.00	2024	2024-660000619	BLAIR, MICHEL D	93	210,104	1000	15,366	1,544.00	2023	2023-660000619	BLAIR, MICHEL D	93	175,002	1000	14,890	1,494.00	2022	2022-660000619	BLAIR, MICHEL D	93	140,249	1000	14,427	1,447.00	2021	2021-660000619	BLAIR, MICHEL D	93	137,454	1000	14,120	1,440.00	2020	2020-660000619	BLAIR, MICHEL D	93	138,311	1000	13,976	1,378.00	2019	2019-660000619	BLAIR, MICHEL D	93	132,180	1000	13,540	1,362.00	2018	2018-660000619	BLAIR, MICHEL D	93	135,815	1000	13,940	1,402.00	2017	2017-660000619	BLAIR, MICHEL D	93	134,761	1000	13,824	1,320.00	2016	2016-660000619	BLAIR, MICHEL D	93	131,720	1000	13,489	1,339.00	2015	2015-660000619	BLAIR, MICHEL D	93	131,370	1000	13,219	1,302.00	2014	2014-660000619	BLAIR, MICHEL D & ROBIN K	93	133,776	1000	12,805	1,237.00	2013	2013-660000619	BLAIR, MICHEL D & ROBIN K	93	128,502	1000	12,403	1,214.00
Tax Year	Statement Number	Billed Owner	Tax Area	Total Value	Exemptions	Taxable Value	Billed Tax																																																																																																																		
2025	2025-660000619	BLAIR, MICHEL D	93	223,724	1000	15,857	1,486.00																																																																																																																		
2024	2024-660000619	BLAIR, MICHEL D	93	210,104	1000	15,366	1,544.00																																																																																																																		
2023	2023-660000619	BLAIR, MICHEL D	93	175,002	1000	14,890	1,494.00																																																																																																																		
2022	2022-660000619	BLAIR, MICHEL D	93	140,249	1000	14,427	1,447.00																																																																																																																		
2021	2021-660000619	BLAIR, MICHEL D	93	137,454	1000	14,120	1,440.00																																																																																																																		
2020	2020-660000619	BLAIR, MICHEL D	93	138,311	1000	13,976	1,378.00																																																																																																																		
2019	2019-660000619	BLAIR, MICHEL D	93	132,180	1000	13,540	1,362.00																																																																																																																		
2018	2018-660000619	BLAIR, MICHEL D	93	135,815	1000	13,940	1,402.00																																																																																																																		
2017	2017-660000619	BLAIR, MICHEL D	93	134,761	1000	13,824	1,320.00																																																																																																																		
2016	2016-660000619	BLAIR, MICHEL D	93	131,720	1000	13,489	1,339.00																																																																																																																		
2015	2015-660000619	BLAIR, MICHEL D	93	131,370	1000	13,219	1,302.00																																																																																																																		
2014	2014-660000619	BLAIR, MICHEL D & ROBIN K	93	133,776	1000	12,805	1,237.00																																																																																																																		
2013	2013-660000619	BLAIR, MICHEL D & ROBIN K	93	128,502	1000	12,403	1,214.00																																																																																																																		



# Rogers

## Assessment Property Record Card for Tax Year 2026

Data provided by LISA DELOZIER County Assessor

Date 04/17/2026  
 Time 03:15:04  
 Page 2

Lot Data	Square-Foot - NBHD 1109 #1	Primary Image
Lot Size		
Lot Count	1	
Units Buildable	1	
Non-Ag Acres	1.1197	
Topography		
Street Access		
Utilities		
Amenities	0	
	0	
Method	Square-Foot	
Base Lot Value	48,776.00 x 1.81 = 88,464	
Factor Value		
Adjustments	1.0000	
Lot Value	88,464	

Residential Data	
Type	1 Single Family Residence
Condition	3 - Average
Quality	2.5 - Fair
Architecture	
Style	100% One Story
Exterior Wall	30% Veneer, Stone 70% Frame, Siding, Wood
Base/Total Area	1,530 / 1,530
Style	100% One Story
HVAC	100% Warmed & Cooled Air
Roof Cover	1 Composition Shingle
Area on Slab	1,530
Fixture/RghIn	11 /
Bed/F/H Bath	3 / 2.0 /
Basement Area	
Garage Type	576 Attached Garage - Unfinished
Remodel	
Year/Eff Age	1978 / 36



\\tsclient\TLOGAN\LOGAN RESIDENTIAL VI\2023-2-21\IMG\_0081 2/22/2023

GRM Approach	
GRM Code	
Gross Rent	0.00
Indicated Value	

Multiple Regression			
MRA Code	1	Test	
Adjusted R	0.8445		
Indicated Value	197,844	129.31	Per SqFt

Direct Comparables			
Selection Model	A	Adam Test	
Adjustment Model	1	2022 Residential	
Comparables	1		
Indicated Value	184,630		Per SqFt

Cost Approach				Manual : 01/2025			
Base Cost	102.05	Total Misc Impr	+	8,913			
Roofing Adj	+ 4.49	Garage Cost	+	15,316			
Subfloor Adj	+ -1.15	Total RCN	=	217,101			
Heat/Cool Adj	+ 11.47	Depreciation ( 45%)	-	97,695			
Plumbing Adj	+ 9.20	Lump Sums	+	0			
Basement Adj	+ 0.00	RCNLD	=	119,406			
Adj Base Cost	= 126.06	Lot Value	+	88,464			
Total Area	x 1,530	Indicated Value	=	207,870			
Adjusted Cost	= 192,872	Value Per SqFt		135.86			

Value Reconciliation			
Selected Approach	Cost Approach		
Improvements	119,406		
Lot Value	88,464		
Indicated Value	207,870	135.86	Per SqFt
Agland Value			
Site Improvements	27,657		
Total Value	235,527	153.94	Total Value Per SqFt

Miscellaneous Improvements								
Code	Description	Sketch ID	Size	Year	Units	Unit Cost	Depr	Value
FPR1	FIREPLACE - RESIDENTIAL 1 STORY	0		1	1	5,095.98		5,096
PRCH	SLAB PORCH - COVERED	1898	9x7		63	24.07		1,516
PRCH	SLAB PORCH - COVERED	1899	12x8		96	23.97		2,301



# Rogers

## Assessment Property Record Card for Tax Year 2026

Data provided by LISA DELOZIER County Assessor

Date 04/17/2026  
 Time 03:15:05  
 Page 3

### Sketch Image

660000619

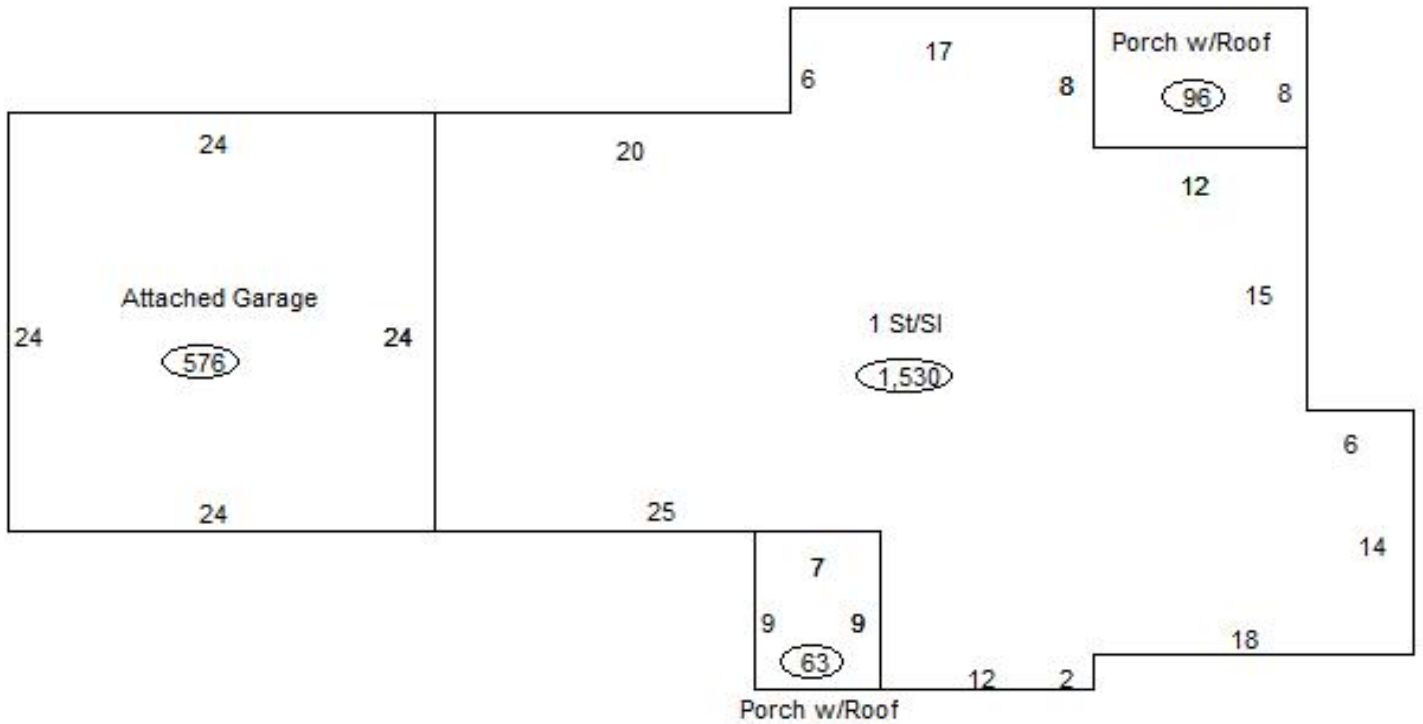

### Sketch Vector Information

Sequence	Code	Type	Built Over	Scale	Section Label	Base Area	Multiplier	Total Area
1	R	1	Slab	13	1 St/SI	1,530	1.000	1,530
2	G	1		13	Attached Garage	576	1.000	576
3	M	PRCH		13	SLBC	63	1.000	63
4	M	PRCH		13	SLBC	96	1.000	96
<b>Total Building Area</b>						1,530		1,530



# Rogers

## Assessment Property Record Card for Tax Year 2026

Data provided by LISA DELOZIER County Assessor

Date 04/17/2026  
 Time 03:15:05  
 Page 4

660000619

### Outbuildings/Site Improvements

Building Image	Code	Description	Dimensions	Floor	Roofing	Total Units
	UTIL	SHOP BUILDING	0x0x0			960
	Qual 2	Cond 3	Year	Eff Age		
	<b>Valuation Summary</b> Base Cost (31.28 x 960) 30,029		<b>Modifier Total</b>	<b>RCN</b> 30,029	<b>Depr (10% Phys/ % Func)</b> 3,003	<b>RCNLD</b> 27,026
	LT	LEAN-TO	0x0x0			240
	Qual 3	Cond 3	Year	Eff Age		
	<b>Valuation Summary</b> Base Cost (2.92 x 240) 701		<b>Modifier Total</b>	<b>RCN</b> 701	<b>Depr (10% Phys/ % Func)</b> 70	<b>RCNLD</b> 631