



Rogers

Assessment Property Record Card for Tax Year 2026

Data provided by LISA DELOZIER County Assessor

Date 04/17/2026
 Time 16:11:35
 Page 1

Assessment Data					Primary Image																																																																																																																				
Account 660000717 Parcel ID 000000-00-0-00072-001-0003 Cadastral ID 01-22-15-02030 Property Type REAL - Real Property Property Class RRP VI Area 4 Tax Area 11 - SEQUOYAH/NW FIRE Name ID 330998 PANKASKIE, KURTIS ANTHONY 9705 E MESA DR CLAREMORE OK 74017-0000 Parcel Location Situs 09705 E MESA DR Subdivision BRIARCLIFF ESTATES Lot/Block 0003 / 0001 Parcel Size 1 - Lots Sec/Twn/Rng 1 / 22 / 15 / 5 Neighborhood 1085 - R-V04-NW SEQUOYAH School District S006 - SEQUOYAH SCHOOLS																																																																																																																									
Legal Description Lot/Long: 36.41549770 -95.65567582																																																																																																																									
Building Permits					<table border="1"> <thead> <tr> <th>Number</th> <th>Description</th> <th>Opened</th> <th>Closed</th> <th>Amount</th> </tr> </thead> <tbody> <tr> <td colspan="5"> </td> </tr> </tbody> </table>					Number	Description	Opened	Closed	Amount																																																																																																											
Number	Description	Opened	Closed	Amount																																																																																																																					
Exemptions					Sale History																																																																																																																				
<table border="1"> <thead> <tr> <th>Code</th> <th>Type</th> <th>Active</th> <th>Maximum</th> <th>Exemption</th> </tr> </thead> <tbody> <tr> <td>H</td> <td>Homestead</td> <td>No</td> <td>1,000</td> <td></td> </tr> </tbody> </table>					Code	Type	Active	Maximum	Exemption	H	Homestead	No	1,000		<table border="1"> <thead> <tr> <th>Bk/Pg</th> <th>Grantor</th> <th>Date</th> <th>Price</th> <th>Code</th> </tr> </thead> <tbody> <tr> <td>/</td> <td>SCHIELE, NORMAN SCOTT &</td> <td>06/03/2020</td> <td>225,000</td> <td>YES</td> </tr> <tr> <td>1941/406</td> <td>US BANK NATL ASSOC</td> <td>02/25/2008</td> <td>101,500</td> <td>3</td> </tr> <tr> <td>1890/945</td> <td>PIERSOL, DAVID S</td> <td>08/03/2007</td> <td>0</td> <td>10</td> </tr> <tr> <td>1489/339</td> <td>STAUFFER, JAMES S JR</td> <td>06/17/2003</td> <td>147,000</td> <td>YES</td> </tr> </tbody> </table>					Bk/Pg	Grantor	Date	Price	Code	/	SCHIELE, NORMAN SCOTT &	06/03/2020	225,000	YES	1941/406	US BANK NATL ASSOC	02/25/2008	101,500	3	1890/945	PIERSOL, DAVID S	08/03/2007	0	10	1489/339	STAUFFER, JAMES S JR	06/17/2003	147,000	YES																																																																													
Code	Type	Active	Maximum	Exemption																																																																																																																					
H	Homestead	No	1,000																																																																																																																						
Bk/Pg	Grantor	Date	Price	Code																																																																																																																					
/	SCHIELE, NORMAN SCOTT &	06/03/2020	225,000	YES																																																																																																																					
1941/406	US BANK NATL ASSOC	02/25/2008	101,500	3																																																																																																																					
1890/945	PIERSOL, DAVID S	08/03/2007	0	10																																																																																																																					
1489/339	STAUFFER, JAMES S JR	06/17/2003	147,000	YES																																																																																																																					
Parcel Valuation																																																																																																																									
<table border="1"> <thead> <tr> <th>Source</th> <th>REAL</th> <th>Fair Cash</th> <th>Capped</th> <th>Asmnt Level</th> <th>Assessed</th> <th>Levy Rate</th> <th>102.332</th> <th>Current Tax</th> </tr> </thead> <tbody> <tr> <td>Remove Cap</td> <td>2021</td> <td>Land Value</td> <td>138,170</td> <td>81,021</td> <td>11%</td> <td>8,912</td> <td>Assessed</td> <td>28,895</td> <td>2,956.87</td> </tr> <tr> <td>Year Frozen</td> <td>0</td> <td>Improvements</td> <td>181,666</td> <td>181,666</td> <td></td> <td>19,983</td> <td>Penalty</td> <td>0</td> <td></td> </tr> <tr> <td>Uncapped Value</td> <td>0</td> <td>Mobile Home</td> <td>0</td> <td>0</td> <td></td> <td>0</td> <td>Exemption</td> <td>0</td> <td>0.00</td> </tr> <tr> <td>TIF Project ID</td> <td>0</td> <td>Total Value</td> <td>319,836</td> <td>262,687</td> <td></td> <td>28,895</td> <td>Total Taxable</td> <td>28,895</td> <td>2,957.00</td> </tr> </tbody> </table>		Source	REAL	Fair Cash	Capped	Asmnt Level	Assessed	Levy Rate	102.332	Current Tax	Remove Cap	2021	Land Value	138,170	81,021	11%	8,912	Assessed	28,895	2,956.87	Year Frozen	0	Improvements	181,666	181,666		19,983	Penalty	0		Uncapped Value	0	Mobile Home	0	0		0	Exemption	0	0.00	TIF Project ID	0	Total Value	319,836	262,687		28,895	Total Taxable	28,895	2,957.00																																																																							
Source	REAL	Fair Cash	Capped	Asmnt Level	Assessed	Levy Rate	102.332	Current Tax																																																																																																																	
Remove Cap	2021	Land Value	138,170	81,021	11%	8,912	Assessed	28,895	2,956.87																																																																																																																
Year Frozen	0	Improvements	181,666	181,666		19,983	Penalty	0																																																																																																																	
Uncapped Value	0	Mobile Home	0	0		0	Exemption	0	0.00																																																																																																																
TIF Project ID	0	Total Value	319,836	262,687		28,895	Total Taxable	28,895	2,957.00																																																																																																																
Assessment History																																																																																																																									
<table border="1"> <thead> <tr> <th>Tax Year</th> <th>Statement Number</th> <th>Billed Owner</th> <th>Tax Area</th> <th>Total Value</th> <th>Exemptions</th> <th>Taxable Value</th> <th>Billed Tax</th> </tr> </thead> <tbody> <tr><td>2025</td><td>2025-660000717</td><td>PANKASKIE, KURTIS ANTHONY</td><td>11</td><td>316,837</td><td>0</td><td>27,519</td><td>2,816.00</td></tr> <tr><td>2024</td><td>2024-660000717</td><td>PANKASKIE, KURTIS ANTHONY</td><td>11</td><td>328,067</td><td>0</td><td>26,209</td><td>2,691.00</td></tr> <tr><td>2023</td><td>2023-660000717</td><td>PANKASKIE, KURTIS ANTHONY</td><td>11</td><td>226,920</td><td>0</td><td>24,961</td><td>2,616.00</td></tr> <tr><td>2022</td><td>2022-660000717</td><td>PANKASKIE, KURTIS ANTHONY</td><td>11</td><td>232,604</td><td>0</td><td>25,586</td><td>2,699.00</td></tr> <tr><td>2021</td><td>2021-660000717</td><td>PANKASKIE, KURTIS ANTHONY</td><td>11</td><td>228,015</td><td>0</td><td>25,082</td><td>2,553.00</td></tr> <tr><td>2020</td><td>2020-660000717</td><td>PANKASKIE, KURTIS ANTHONY</td><td>11</td><td>197,198</td><td>1000</td><td>20,553</td><td>2,174.00</td></tr> <tr><td>2019</td><td>2019-660000717</td><td>SCHIELE, NORMAN SCOTT &</td><td>11</td><td>190,231</td><td>1000</td><td>19,925</td><td>2,079.00</td></tr> <tr><td>2018</td><td>2018-660000717</td><td>SCHIELE, NORMAN SCOTT &</td><td>11</td><td>198,396</td><td>1000</td><td>20,824</td><td>2,196.00</td></tr> <tr><td>2017</td><td>2017-660000717</td><td>SCHIELE, NORMAN SCOTT &</td><td>11</td><td>196,602</td><td>1000</td><td>20,418</td><td>2,103.00</td></tr> <tr><td>2016</td><td>2016-660000717</td><td>SCHIELE, NORMAN SCOTT &</td><td>11</td><td>191,115</td><td>1000</td><td>19,794</td><td>2,052.00</td></tr> <tr><td>2015</td><td>2015-660000717</td><td>SCHIELE, NORMAN SCOTT &</td><td>11</td><td>185,591</td><td>1000</td><td>19,189</td><td>2,006.00</td></tr> <tr><td>2014</td><td>2014-660000717</td><td>SCHIELE, NORMAN SCOTT &</td><td>11</td><td>187,087</td><td>1000</td><td>18,601</td><td>1,947.00</td></tr> <tr><td>2013</td><td>2013-660000717</td><td>SCHIELE, NORMAN SCOTT &</td><td>11</td><td>173,900</td><td>1000</td><td>18,030</td><td>1,855.00</td></tr> </tbody> </table>										Tax Year	Statement Number	Billed Owner	Tax Area	Total Value	Exemptions	Taxable Value	Billed Tax	2025	2025-660000717	PANKASKIE, KURTIS ANTHONY	11	316,837	0	27,519	2,816.00	2024	2024-660000717	PANKASKIE, KURTIS ANTHONY	11	328,067	0	26,209	2,691.00	2023	2023-660000717	PANKASKIE, KURTIS ANTHONY	11	226,920	0	24,961	2,616.00	2022	2022-660000717	PANKASKIE, KURTIS ANTHONY	11	232,604	0	25,586	2,699.00	2021	2021-660000717	PANKASKIE, KURTIS ANTHONY	11	228,015	0	25,082	2,553.00	2020	2020-660000717	PANKASKIE, KURTIS ANTHONY	11	197,198	1000	20,553	2,174.00	2019	2019-660000717	SCHIELE, NORMAN SCOTT &	11	190,231	1000	19,925	2,079.00	2018	2018-660000717	SCHIELE, NORMAN SCOTT &	11	198,396	1000	20,824	2,196.00	2017	2017-660000717	SCHIELE, NORMAN SCOTT &	11	196,602	1000	20,418	2,103.00	2016	2016-660000717	SCHIELE, NORMAN SCOTT &	11	191,115	1000	19,794	2,052.00	2015	2015-660000717	SCHIELE, NORMAN SCOTT &	11	185,591	1000	19,189	2,006.00	2014	2014-660000717	SCHIELE, NORMAN SCOTT &	11	187,087	1000	18,601	1,947.00	2013	2013-660000717	SCHIELE, NORMAN SCOTT &	11	173,900	1000	18,030	1,855.00
Tax Year	Statement Number	Billed Owner	Tax Area	Total Value	Exemptions	Taxable Value	Billed Tax																																																																																																																		
2025	2025-660000717	PANKASKIE, KURTIS ANTHONY	11	316,837	0	27,519	2,816.00																																																																																																																		
2024	2024-660000717	PANKASKIE, KURTIS ANTHONY	11	328,067	0	26,209	2,691.00																																																																																																																		
2023	2023-660000717	PANKASKIE, KURTIS ANTHONY	11	226,920	0	24,961	2,616.00																																																																																																																		
2022	2022-660000717	PANKASKIE, KURTIS ANTHONY	11	232,604	0	25,586	2,699.00																																																																																																																		
2021	2021-660000717	PANKASKIE, KURTIS ANTHONY	11	228,015	0	25,082	2,553.00																																																																																																																		
2020	2020-660000717	PANKASKIE, KURTIS ANTHONY	11	197,198	1000	20,553	2,174.00																																																																																																																		
2019	2019-660000717	SCHIELE, NORMAN SCOTT &	11	190,231	1000	19,925	2,079.00																																																																																																																		
2018	2018-660000717	SCHIELE, NORMAN SCOTT &	11	198,396	1000	20,824	2,196.00																																																																																																																		
2017	2017-660000717	SCHIELE, NORMAN SCOTT &	11	196,602	1000	20,418	2,103.00																																																																																																																		
2016	2016-660000717	SCHIELE, NORMAN SCOTT &	11	191,115	1000	19,794	2,052.00																																																																																																																		
2015	2015-660000717	SCHIELE, NORMAN SCOTT &	11	185,591	1000	19,189	2,006.00																																																																																																																		
2014	2014-660000717	SCHIELE, NORMAN SCOTT &	11	187,087	1000	18,601	1,947.00																																																																																																																		
2013	2013-660000717	SCHIELE, NORMAN SCOTT &	11	173,900	1000	18,030	1,855.00																																																																																																																		



Rogers

Assessment Property Record Card for Tax Year 2026

Data provided by LISA DELOZIER County Assessor

Date 04/17/2026
 Time 16:11:35
 Page 2

Lot Data		Square-Foot - NBHD 1085 #1	
Lot Size			
Lot Count			
Units Buildable	40103		
Non-Ag Acres	1.0142		
Topography			
Street Access			
Utilities			
Amenities	LAND QUALITY	0	
		0	
Method	Square-Foot		
Base Lot Value	44,177.00 x 3.13 = 138,170		
Factor Value			
Adjustments	1.0000		
Lot Value	138,170		

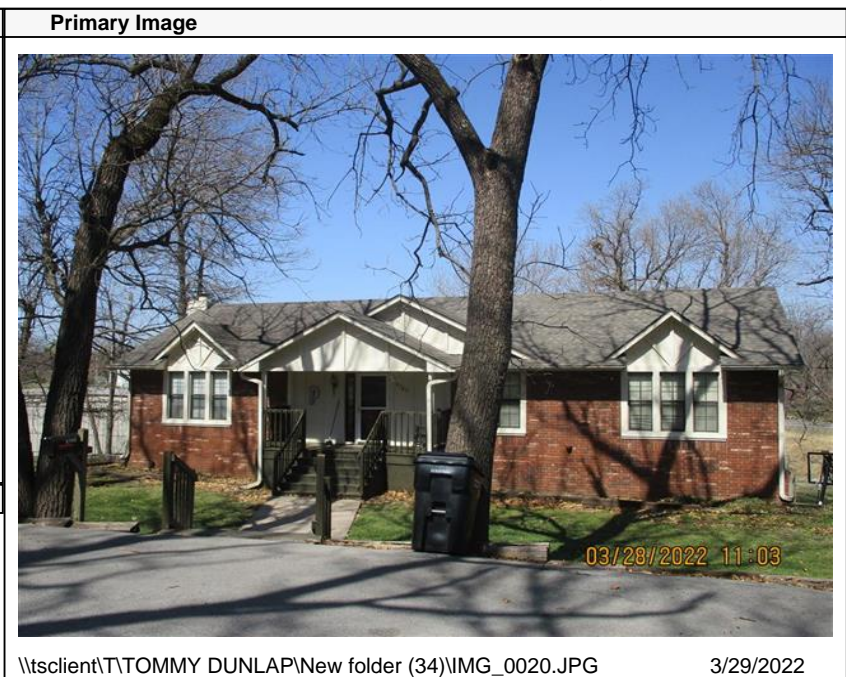

\\tsclient\T\TOMMY DUNLAP\New folder (34)\IMG_0020.JPG 3/29/2022

Residential Data	
Type	1 Single Family Residence
Condition	3 - Average
Quality	3 - Average
Architecture	
Style	100% 1 1/2 Story Finished
Exterior Wall	50% Veneer, Masonry 50% Frame, Siding, Wood
Base/Total Area	840 / 2,540
Style	100% 1 1/2 Story Finished
HVAC	100% Warmed & Cooled Air
Roof Cover	1 Composition Shingle
Area on Slab	840
Fixture/RghIn	14 /
Bed/F/H Bath	4 / 2.5 /
Basement Area	
Garage Type	840 Attached Garage - Unfinished
Remodel	
Year/Eff Age	1981 / 34

GRM Approach	
GRM Code	
Gross Rent	0.00
Indicated Value	

Multiple Regression			
MRA Code	1	Test	
Adusted R	0.8445		
Indicated Value	289,738	114.07	Per SqFt

Direct Comparables	
Selection Model	A Adam Test
Adjustment Model	1 2022 Residential
Comparables	
Indicated Value	

Cost Approach				Manual : 01/2025			
Base Cost	82.11	Total Misc Impr	+	22,136			
Roofing Adj	+ 1.81	Garage Cost	+	25,024			
Subfloor Adj	+ -0.85	Total RCN	=	309,771			
Heat/Cool Adj	+ 12.64	Depreciation (42%)	-	130,104			
Plumbing Adj	+ 7.68	Lump Sums	+	1,999			
Basement Adj	+ 0.00	RCNLD	=	181,666			
Adj Base Cost	= 103.39	Lot Value	+	138,170			
Total Area	x 2,540	Indicated Value	=	319,836			
Adjusted Cost	= 262,611	Value Per SqFt		125.92			

Value Reconciliation			
Selected Approach	Cost Approach		
Improvements	181,666		
Lot Value	138,170		
Indicated Value	319,836	125.92	Per SqFt
Agland Value			
Site Improvements			
Total Value	319,836	125.92	Total Value Per SqFt

Miscellaneous Improvements								
Code	Description	Sketch ID	Size	Year	Units	Unit Cost	Depr	Value
FPR1	FIREPLACE - RESIDENTIAL 1 STORY	0		1	1	5,615.40		5,615
PATO	SLAB PORCH - OPEN	2089	16x12		192	10.63		2,041
PATO	SLAB PORCH - OPEN	2090	38x20		760	8.60		6,536
PATO	SLAB PORCH - OPEN	2091	28x8		224	10.15		2,274
WODO	WOOD DECK - OPEN	2092	15x5		75	28.36	6%	1,999
PRCH	SLAB PORCH - COVERED	2093	36x6		216	26.25		5,670



Rogers

Assessment Property Record Card for Tax Year 2026

Data provided by LISA DELOZIER County Assessor

Date 04/17/2026

Time 16:11:35

Page 3

Sketch Image

660000717

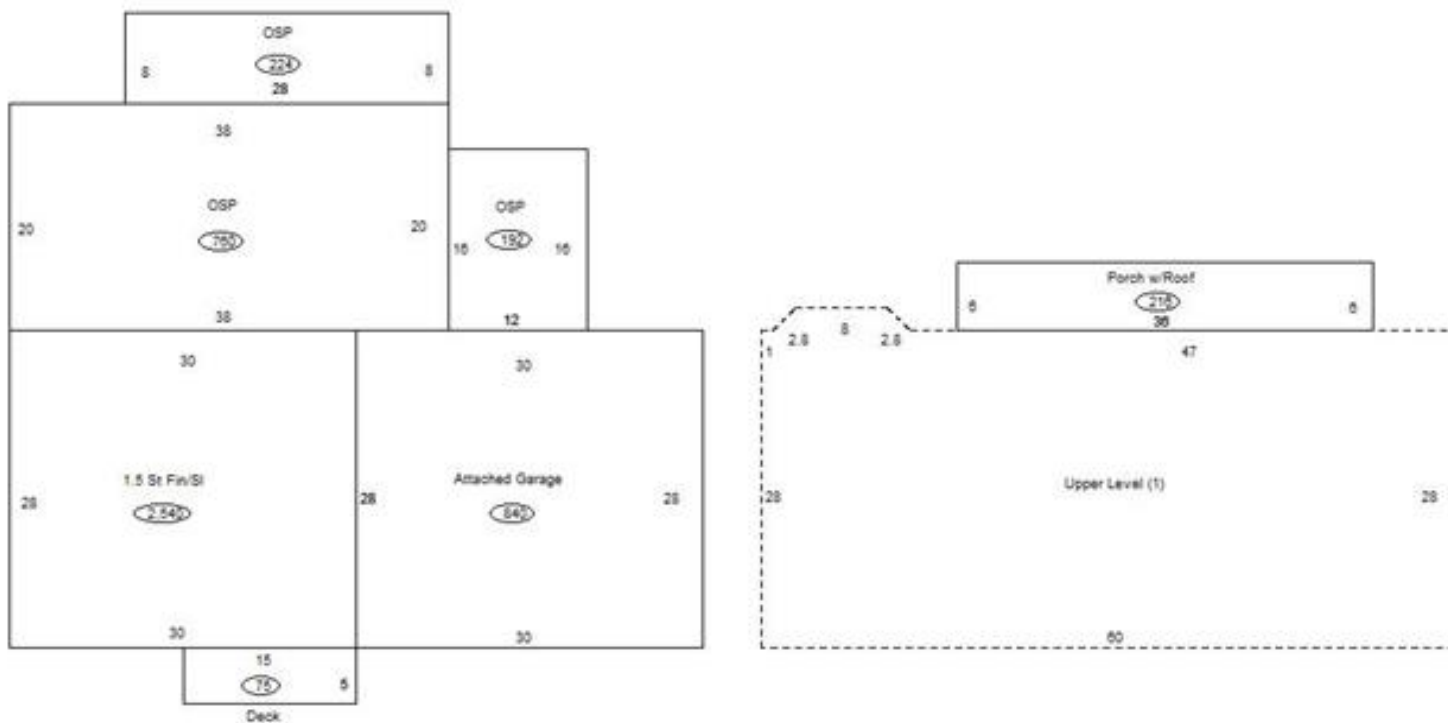

Sketch Vector Information

Sequence	Code	Type	Built Over	Scale	Section Label	Base Area	Multiplier	Total Area
1	R	5	Slab	13	1.5 St Fin/Sl	840	3.024	2,540
2	G	1		13	Attached Garage	840	1.000	840
3	M	PATO		13	Open Slab	192	1.000	192
4	M	PATO		13	Open Slab	760	1.000	760
5	M	PATO		13	Open Slab	224	1.000	224
6	M	WODO		13	WODO	75	1.000	75
7	M	PRCH		13	SLBC	216	1.000	216
8	U	^UL		13	Upper Level (1)	1,700	1.000	1,700
Total Building Area						840		2,540